

(+) DENOTES LOCATION OF WELL ON U.S.G.S. TOPOGRAPHIC MAP

N

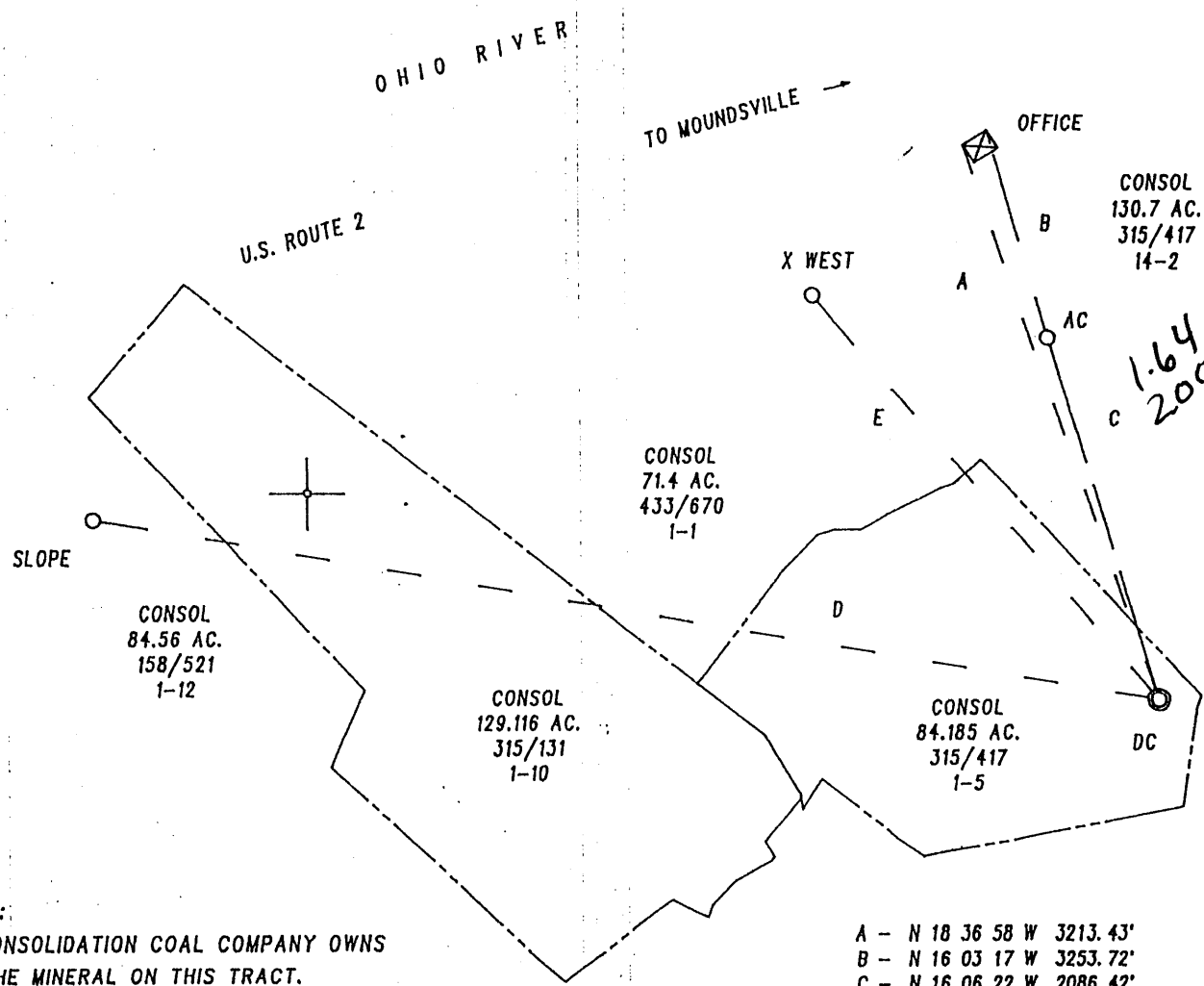

NOTE :

- 1) CONSOLIDATION COAL COMPANY OWNS THE MINERAL ON THIS TRACT.
- 2) THIS WELL IS AN EXISTING VENTILATION BORE-HOLE BEING CONVERTED TO A CBM GOB WELL.

- A - N 18 36 58 W 3213.43'
- B - N 16 03 17 W 3253.72'
- C - N 16 06 22 W 2086.42'
- D - N 80 03 27 W 5861.16'
- E - N 39 29 27 W 2903.88'

FILE NO. 02-IRE-04  
 DRAWN BY : R.A. KITZMILLER  
 SCALE : 1 : 1000'  
 MIN. DEGREE OF ACCURACY 1 / 200'  
 PROVEN SOURCE OF ELEVATION : \_\_\_\_\_  
 \_\_\_\_\_  
 GPS

I THE UNDERSIGNED, HEREBY CERTIFY THAT THIS PLAT IS CORRECT TO THE BEST OF MY KNOWLEDGE AND BELIEF AND SHOWS ALL THE INFORMATION REQUIRED BY LAW AND THE REGULATIONS ISSUED AND PRESCRIBED BY THE DIVISION OF ENVIRONMENTAL PROTECTION.

(SIGNED) Robert A. Kitzmiller  
 Professional Surveyor No. 835

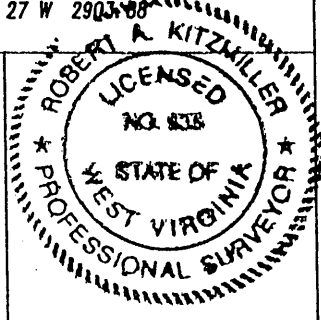

WV. DEPT. OF ENVIRONMENTAL PROTECTION  
 OFFICE OF OIL AND GAS DIVISION  
 1356 HANSFORD STREET  
 CHARLESTON, WV. 25301

DATE JUNE 19, 2002  
 OPERATOR'S WELL NO. DC  
 API WELL NO. 47-051-869C  
 STATE COUNTY PERMIT NO.

WELL TYPE: OIL  GAS  CBM  LIQUID INJECTION  WASTE DISPOSAL   
 IF "GAS", PRODUCTION  STORAGE  DEEP  SHALLOW   
 LOCATION: ELEVATION 680' WATERSHED HOG RUN OF THE OHIO RIVER  
 DISTRICT FRANKLIN COUNTY MARSHALL  
 QUADRANGLE POWATAN POINT NEAREST TOWN MOUNDSVILLE  
 SURFACE OWNER CONSOLIDATION COAL COMPANY ACREAGE 84.185 AC.  
 OIL & GAS ROYALTY OWNER \* See Note LEASE ACREAGE \_\_\_\_\_  
 LEASE NO. \_\_\_\_\_

PROPOSED WORK: DRILL  CONVERT  DRILL DEEPER  REDRILL  FRACTURE OR STIMULATE   
 PLUG OFF OLD FORMATION  PERFORATE NEW FORMATION   
 OTHER PHYSICAL CHANGE IN WELL (SPECIFY) EXISTING VENTILATION BOREHOLE BEING CONVERTED  
 PLUG AND ABANDON CLEAN OUT AND REPLUG  TO GOB WELL.  
 TARGET FORMATION PITTSBURGH ESTIMATED DEPTH 1162'  
 WELL OPERATOR CNX GAS COMPANY LLC. (NORTH) DESIGNATED AGENT EDWIN L. MERRIFIELD  
 ADDRESS 1800 WASHINGTON ROAD ADDRESS 116 1/2 HUNSAKER STREET  
PITTSBURGH, PA. 15421-1421 FAIRMONT, WV. 26554

PRECISION SURVEYS FORM IV-6

MARSH COUNTY PERMIT NO. 869C

(Ireland Mine CBM 391) 6-6