

**REFERENCES**

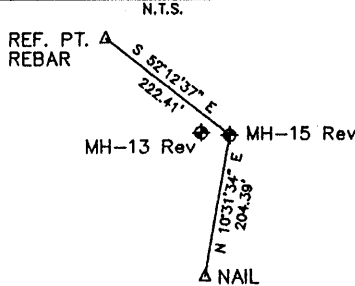

FILE No. 0259-01

DRAWING NAME Site 3 Well Plats Revised 03-23-04

Drawing Number Well MH-15 Rev

SCALE 1"=750'

MINIMUM DEGREE OF ACCURACY 1:2500

PROVEN SOURCE OF ELEVATION GPS - GLOBAL POSITIONING SYSTEM

I THE UNDERSIGNED, HEREBY CERTIFY THAT THIS PLAT IS CORRECT TO THE BEST OF MY KNOWLEDGE AND BELIEF AND SHOWS ALL THE INFORMATION REQUIRED BY LAW AND THE REGULATIONS ISSUED AND PRESCRIBED BY THE DEPARTMENT OF MINES.

(SIGNED) [Signature]  
R.P.E. 12418 R.P.S.

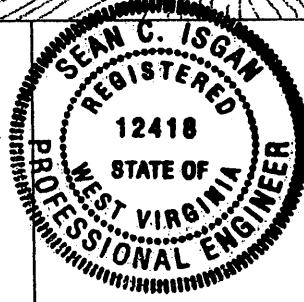

**STATE OF WEST VIRGINIA  
DIVISION OF ENVIRONMENTAL PROTECTION  
OFFICE OF OIL AND GAS  
NITRO, WV**

DATE 03/15/04  
OPERATOR'S WELL NO. MH-15 Rev  
API WELL NO. 47 - 051 - 00927-C  
STATE COUNTY PERMIT

WELL TYPE: OIL  GAS  CBM LIQUID INJECTION  WASTED DISPOSAL   
(IF "GAS") PRODUCTION  STORAGE  DEEP  SHALLOW   
LOCATION: ELEVATION 934.0 WATER SHED PENNSYLVANIA FORK FISH CREEK  
DISTRICT LIBERTY COUNTY MARSHALL  
QUADRANGLE LITTLETON, WV

SURFACE OWNER CONSOLIDATION COAL COMPANY ACREAGE 17.836  
CBM ROYALTY OWNER CONSOLIDATION COAL COMPANY LEASE ACREAGE \_\_\_\_\_  
LEASE No. \_\_\_\_\_

PROPOSED WORK: DRILL  CONVERT  DRILL DEEPER  FRACTURE OR STIMULATE  PLUG OFF OLD FORMATION  PERFORATE NEW FORMATION  OTHER PHYSICAL CHANGE IN WELL (SPECIFY) \_\_\_\_\_

PLUS AND ABANDON  CLEAN OUT AND REPLUG   
TARGET FORMATION PITTSBURGH SEAM ESTIMATED DEPTH 745'±  
WELL OPERATOR CNX Gas Company, LLC VICE-PRESIDENT - OPERATIONS Joe Aman - Manager  
ADDRESS 1800 Washington Road ADDRESS 1800 Washington Road  
Pittsburgh, PA 15241 Pittsburgh, PA 15241

State of West Virginia  
Department of Environmental Protection  
Office of Oil and Gas

*MP*

Well Operator's Report of Well Work

Farm name: Consolidation Coal Co. Operator Well No.: DOE MH-15

LOCATION: Elevation: 934 Quadrangle: Littleton, WV

District: Liberty County: Marshall

Latitude: 10889 Feet South of 39 Deg. 45 Min. 00 Sec.

Longitude: 10889 Feet West of 80 Deg. 30 Min. 00 Sec.

Company: CNX Gas Company, LLC

	Casing & Tubing	Used in drilling	Left in well	Cement Fill Up (# of Sacks)
Address: 1800 Washington Road	13-3/8"	30'	30'	GRTD
Pittsburgh, PA 15241	9-5/8"	300'	300'	100 Sacks
Agent: Joseph P. Aman	5-1/2"	520'	520'	90 Sacks
Inspector: Terry Urban				
Date Permit Issued: 05/18/04				
Date Well Work Commenced: 7/24/04				
Date Well Work Completed: 8/15/04				
Verbal Plugging: N/A				
Date Permission granted on: 5/19/04				
Rotary Cable <u>Rig</u>				
Total Depth (feet): 699.00'				
Fresh Water Depth (ft.): 300'				
Salt Water Depth (ft.): N/A				
Is coal being mined in area (N/Y)? No				
Coal Depths (ft.): 586', 693'				

RECEIVED  
Office of Oil & Gas  
Office of Chief  
SEP 27 2004  
WV Department of Environmental Protection

OPEN FLOW DATA

Producing formation Pittsburgh depth (ft) 693' - 699'

Gas: Initial open flow 0 MCF/d Oil: Initial open flow \_\_\_\_\_ Bbl/d

Final open flow \_\_\_\_\_ MCF/d Final open flow \_\_\_\_\_ Bbl/d

Time of open flow between initial and final tests \_\_\_\_\_ Hours

Static rock Pressure \_\_\_\_\_ psig (surface pressure) after \_\_\_\_\_ Hours

Second producing formation \_\_\_\_\_ Pay zone depth (ft) \_\_\_\_\_

Gas: Initial open flow \_\_\_\_\_ MCF/d Oil: Initial open flow \_\_\_\_\_ Bbl/d

Final open flow \_\_\_\_\_ MCF/d Final open flow \_\_\_\_\_ Bbl/d

Time of open flow between initial and final tests \_\_\_\_\_ Hours

Static rock Pressure \_\_\_\_\_ psig (surface pressure) after \_\_\_\_\_ Hours

NOTE: ON BACK OF THIS FORM PUT THE FOLLOWING: 1). DETAILS OF PERFORATED INTERVALS, FRACTURING OR STIMULATING, PHYSICAL CHANGE, ETC. 2). THE WELL LOG WHICH IS A SYSTEMATIC DETAILED GEOLOGICAL RECORD OF ALL FORMATIONS, INCLUDING COAL ENCOUNTERED BY THE WELLBORE.

Gas Well DOE MH-15 (API No. 47-510-0927) is a horizontal well for CNX Gas Company, LLC. Refer to the attached information for additional information.

Signed: *Geoff Fanning*  
By: Geoff Fanning, Drill Foreman  
Date: 9/23/04

MARS 6927



**ATTACHMENT A**

**Marshall County CBM Well No. MH-15 Drill Log**

<b>Depth</b>	<b>Description</b>
0-30	Top
30-432	Sand/Shale
432-445	Coal/Shale
445-699(TD)	Shale/Sand