

REFERENCES
N.T.S.

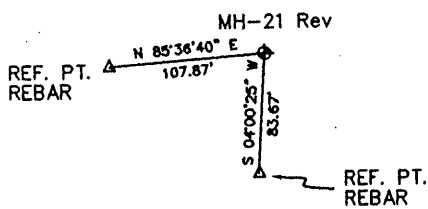

Note: THE WELL DOES NOT FALL WITHIN 100' OF THE LEASE BOUNDARY.

FILE No. 0259-01
 DRAWING NAME Site 3 Well Plats
 Drawing Number Well MH-21 Rev
 SCALE 1"=750'
 MINIMUM DEGREE OF ACCURACY 1:2500
 PROVEN SOURCE OF ELEVATION GPS - GLOBAL POSITIONING SYSTEM

I THE UNDERSIGNED, HEREBY CERTIFY THAT THIS PLAT IS CORRECT TO THE BEST OF MY KNOWLEDGE AND BELIEF AND SHOWS ALL THE INFORMATION REQUIRED BY LAW AND THE REGULATIONS ISSUED AND PRESCRIBED BY THE DEPARTMENT OF MINES.

(SIGNED) [Signature]
 R.P.E. 12418 R.P.S.

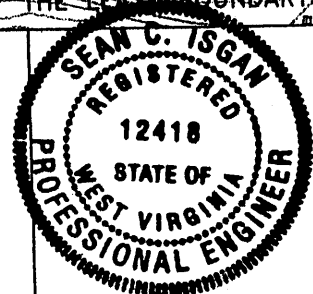

**STATE OF WEST VIRGINIA
 DIVISION OF ENVIRONMENTAL PROTECTION
 OFFICE OF OIL AND GAS
 NITRO, WV**

DATE 03/15/04
 OPERATOR'S WELL NO. MH-21 Rev
 API WELL NO. 47-051-00931C
 STATE COUNTY PERMIT

WELL TYPE: OIL GAS CBM LIQUID INJECTION WASTED DISPOSAL
 (IF "GAS") PRODUCTION STORAGE DEEP SHALLOW
 LOCATION: ELEVATION 930.0 WATER SHED PENNSYLVANIA FORK FISH CREEK
 DISTRICT LIBERTY COUNTY MARSHALL
 QUADRANGLE LITTLETON, WV

SURFACE OWNER CONSOLIDATION COAL COMPANY ACREAGE 17.836
 CBM ROYALTY OWNER CONSOLIDATION COAL COMPANY LEASE ACREAGE

LEASE No.

PROPOSED WORK: DRILL CONVERT DRILL DEEPER FRACTURE OR STIMULATE PLUG OFF OLD FORMATION PERFORATE NEW FORMATION OTHER PHYSICAL CHANGE IN WELL (SPECIFY)

PLUS AND ABANDON CLEAN OUT AND REPLUG
 TARGET FORMATION UPPER FREEPORT ESTIMATED DEPTH 1340'±
 WELL OPERATOR CNX Gas Company, LLC VICE-PRESIDENT - OPERATIONS Joe Aman - Manager
 ADDRESS 1800 Washington Road ADDRESS 1800 Washington Road
Pittsburgh, PA 15241 Pittsburgh, PA 15241

MARS 0931