



west virginia department of environmental protection

Office of Oil and Gas
601 57th Street, S.E.
Charleston, WV 25304
(304) 926-0450
fax: (304) 926-0452

Austin Caperton, Cabinet Secretary
www.dep.wv.gov

Wednesday, August 28, 2019
WELL WORK PLUGGING PERMIT
Coal Bed Methane Well Plugging

CONSOLIDATION COAL COMPANY
1 BRIDGE STREET

MONONGAH, WV 265540000

Re: Permit approval for MC122A
47-051-01131-00-00

This well work permit is evidence of permission granted to perform the specified well work at the location described on the attached pages and located on the attached plat, subject to the provisions of Chapter 22 of the West Virginia Code of 1931, as amended, and all rules and regulations promulgated thereunder, and to any additional specific conditions and provisions outlined in the pages attached hereto. Notification shall be given by the operator to the Oil and Gas Inspector at least 24 hours prior to the construction of roads, locations, and/or pits for any permitted work. In addition, the well operator shall notify the same inspector 24 hours before any actual well work is commenced and prior to running and cementing casing. Spills or emergency discharges must be promptly reported by the operator to 1-800-642-3074 and to the Oil and Gas Inspector.

Upon completion of the plugging well work, the above named operator will reclaim the site according to the provisions of WV Code 22-6-30. Please be advised that form WR-38, Affidavit of Plugging and Filling Well, is to be submitted to this office within 90 days of completion of permitted well work, as should form WR-34 Discharge Monitoring Report within 30 days of discharge of pits, if applicable. Failure to abide by all statutory and regulatory provisions governing all duties and operations hereunder may result in suspension or revocation of this permit and, in addition, may result in civil and/or criminal penalties being imposed upon the operators.

Per 35 CSR 4-5.2.g this permit will expire in two (2) years from the issue date unless permitted well work is commenced. If there are any questions, please feel free to contact me at (304) 926- 0450.

James A. Martin
Chief

Operator's Well Number: MC122A
Farm Name: BONNIE WENDT
U.S. WELL NUMBER: 47-051-01131-00-00
Coal Bed Methane Well Plugging
Date Issued: 8/28/2019

Promoting a healthy environment.

PERMIT CONDITIONS

West Virginia Code §22-6-11 allows the Office of Oil and Gas to place specific conditions upon this permit. Permit conditions have the same effect as law. Failure to adhere to the specified permit conditions may result in enforcement action.

CONDITIONS

1. All pits must be lined with a minimum of 20 mil thickness synthetic liner.
2. In the event of an accident or explosion causing loss of life or serious personal injury in or about the well or while working on the well, the well operator or its contractor shall give notice, stating the particulars of the accident or explosion, to the oil and gas inspector and the Chief within twenty-four (24) hours.
3. Well work activities shall not constitute a hazard to the safety of persons.

1) Date December 18, 2018
2) Operator's
Well No. MC-122A
3) API Well No. 47-051 - 01131

STATE OF WEST VIRGINIA
DEPARTMENT OF ENVIRONMENTAL PROTECTION
OFFICE OF OIL AND GAS

APPLICATION FOR A PERMIT TO PLUG AND ABANDON

- 4) Well Type: Oil ____ / Gas X / Liquid injection ____ / Waste disposal ____ /
(If "Gas, Production ____ or Underground storage ____) Deep ____ / Shallow X
- 5) Location: Elevation 1275.22 Watershed unnamed tributary to Middle Grave Creek
District Webster County Marshall Quadrangle Majorsville, WV 7.5'
- 6) Well Operator Consolidation Coal Company 7) Designated Agent Dave Roddy
Address 1 Bridge Street Address 1 Bridge Street
Monongah, WV 26554 Monongah, WV 26554
- 8) Oil and Gas Inspector to be notified 9) Plugging Contractor
Name James Nicholson Name _____
Address PO BOX 44 Address _____
Moundsville, WV 26041 _____

10) Work Order: The work order for the manner of plugging this well is as follows:

See Exhibit No. 1

THIS IS THE ACCESS WELL (MC-122A) TO CBM WELL (MC-122).
IT HAS NO CASING THROUGH THE COAL AND IT WILL BE
FILLED WITH CLASS A CEMENT FROM THE TOP OF THE
PITTSBURGH COAL SEAM TO THE SURFACE. SET MONUMENT.

OK gmm

Notification must be given to the district oil and gas inspector 24 hours before permitted work can commence.

Work order approved by inspector _____ Date _____

Exhibit Number 1

Consolidation Coal Company in WV will utilize the following methods to plug CBM wells.

CBM wells are a directionally drilled well with horizontal wellbores through the Pittsburgh coal seam. The wellbores through the coal will be water infused for first intersection of the laterals. Then the lateral system will be cemented/grouted. The vertical wellbore will be cleaned out to the total depth or attainable bottom (PBTD). The well sump, 7" casing, and packer will be pulled if possible. This proposed method of plugging the wellbore will apply to that portion of the wellbore from the top of the coal seam to be mined to the surface. All Casings will be removed and at no time will more than a single string be left in the wellbore.

All casing will be removed so that only a single string will be left in the wellbore, if it cannot be removed. Intact and uncemented casings as determined by electronic logging shall be perforated, ripped, or milled at no greater than 100' intervals to the top of the casing. A borehole survey will be conducted to determine the top and bottom of the coal seam to be mined. In addition, starting at a point 5' below through 5' above the coal to be mined, any metal casing shall be ripped, cut or perforated on no greater than a 5' interval. Before or after mine through this well will be plugged with cement to the surface from a point at or above the Pittsburg Coal with a solid plug.

State of West Virginia
Department of Environmental Protection
Office of Oil and Gas

Well Operator's Report of Well Work

Farm name: FITZSIMMONS, JUANTA Operator Well No.: MC122A

LOCATION: Elevation: 1275.22' Quadrangle: MAJORSVILLE WV-PA 7.5'

District: WEBSTER County: MARSHALL
Latitude: 12,431 Feet South of 39' Deg. 52' Min. 57.48' Sec.
Longitude: 9,325' Feet West of 80' Deg. 36' Min. 58.80' Sec.

Company: CNX Gas Company, LLC

	Casing & Tubing	Used in drilling	Left in well	Cement Fill Up (# of Sacks)
Address: 2481 John Nash BLVD	9 5/8'	42.0'	42.0'	SAND IN
Bluefield Wv 24701	7'	531'	531'	95 SKS
Agent: Les Arrington				
Inspector: Bill Hatfield				
Date Permit Issued: 5/02/08				
Date Well Work Commenced: 6/19/08				
Date Well Work Completed: 7/20/08				
Verbal Plugging:				
Date Permission granted on:				
Rotary Cable <u>Rig</u>				
Total Depth (feet): 850'				
Fresh Water Depth (ft.): 300'				
Salt Water Depth (ft.): N/A				
Is coal being mined in area (N/Y)? No				
Coal Depths (ft.): 845'-850'				

RECEIVED
Office of Oil & Gas

JAN 16 2009

WV Department of
Environmental Protection

OPEN FLOW DATA

Producing formation Pittsburgh COAL SEAM depth (ft) 845'-850'
Gas: Initial open flow _____ MCF/d Oil: Initial open flow _____ Bbl/d
Final open flow _____ MCF/d Final open flow _____ Bbl/d
Time of open flow between initial and final tests _____ Hours
Static rock Pressure _____ psig (surface pressure) after _____ Hours

Second producing formation _____ Pay zone depth (ft) _____
Gas: Initial open flow _____ MCF/d Oil: Initial open flow _____ Bbl/d
Final open flow _____ MCF/d Final open flow _____ Bbl/d
Time of open flow between initial and final tests _____ Hours
Static rock Pressure _____ psig (surface pressure) after _____ Hours

NOTE: ON BACK OF THIS FORM PUT THE FOLLOWING: 1). DETAILS OF PERFORATED INTERVALS, FRACTURING OR STIMULATING, PHYSICAL CHANGE, ETC. 2). THE WELL LOG WHICH IS A SYSTEMATIC DETAILED GEOLOGICAL RECORD OF ALL FORMATIONS, INCLUDING COAL ENCOUNTERED BY THE WELLBORE.

Gas Well DOE MC122A (API No. 47-5101131) is a horizontal well for CNX Gas Company, LLC. Refer to the attached information for additional information.

Signed: Geoff Lanning
By: Geoff Lanning Drilling Manager
Date: 1/9/09

FEB 13 2009

MARS 11/31C

ATTACHMENT A**Marshall County CBM Well No. MC-122A Drill Log**

API #47-5101131

Depth	Description
5'	FILL & DIRT
5'-15'	SAND-BRUN
15'-25'	SAND WHT.
25'-39'	SHALE
39'- 105'	SAND
105'-195'	SHALE
195'-290'	RR
290'-375'	SAND
375'-450'	RR
450'-545'	SHALE

FIGURE 1

CNX GAS COMPANY LLC

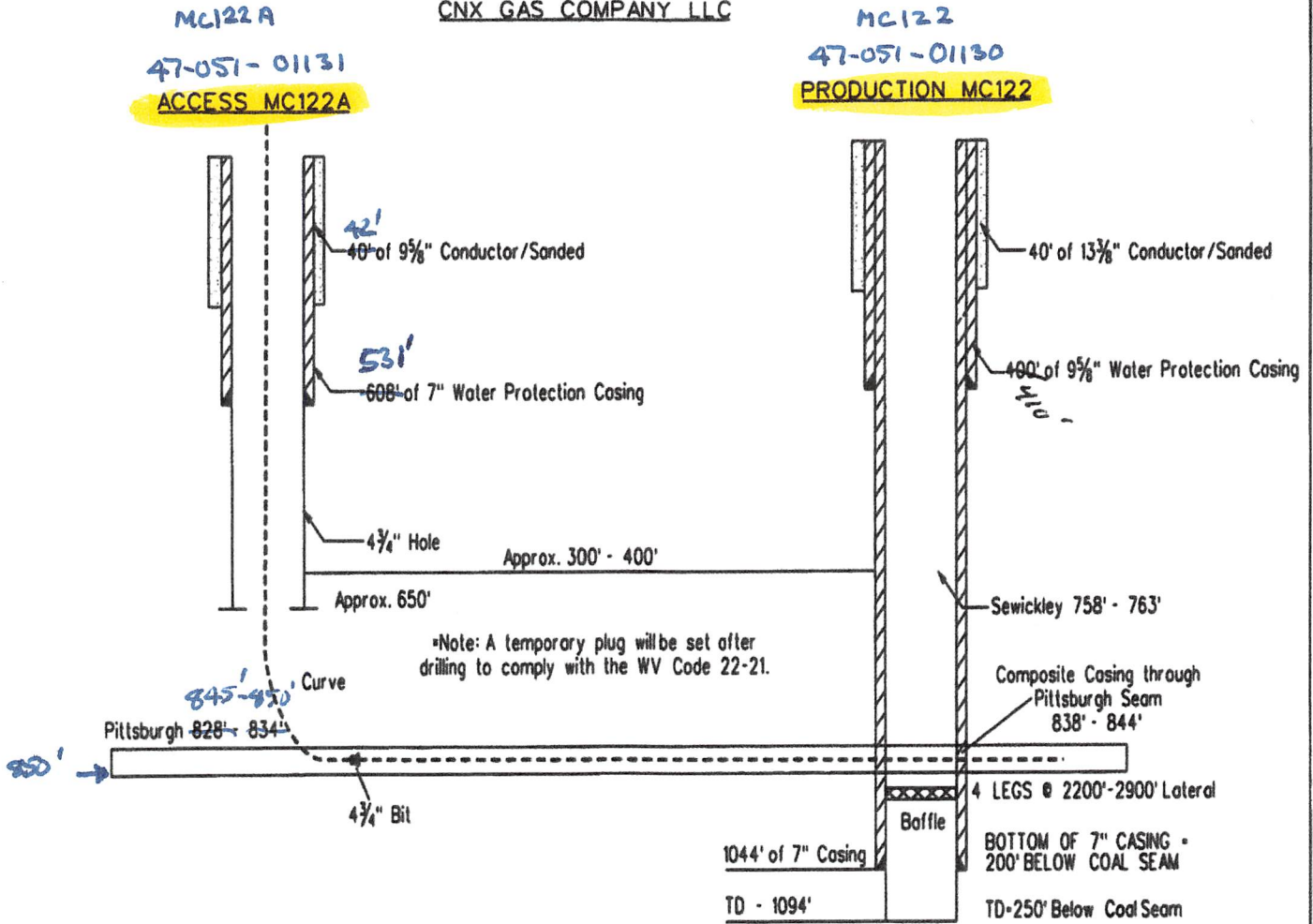

Note: A temporary plug will be set after drilling to comply with the WV Code 22-21.

NOTE: Additional casing string may be used depending on hole conditions

NOT TO SCALE

WW-4A
Revised 6-07

1) Date: 12/18/18
2) Operator's Well Number
MC-122A
3) API Well No.: 47 - 051 - 01131

STATE OF WEST VIRGINIA
DEPARTMENT OF ENVIRONMENTAL PROTECTION, OFFICE OF OIL AND GAS
NOTICE OF APPLICATION TO PLUG AND ABANDON A WELL

4) Surface Owner(s) to be served:	5) (a) Coal Operator
(a) Name <u>Bonnie Wendt</u>	Name <u>Consolidation Coal Co.</u>
Address <u>11037 Waynesburg Pike</u>	Address <u>1 Bridge Street</u>
<u>Cameron, WV 26033</u>	<u>Monongah, WV 26554</u>
(b) Name _____	(b) Coal Owner(s) with Declaration
Address _____	Name _____
	Address _____
(c) Name _____	Name _____
Address _____	Address _____
6) Inspector <u>James Nicholson</u>	(c) Coal Lessee with Declaration
Address <u>PO Box 44</u>	Name _____
<u>Moundsville, WV 26041</u>	Address _____
Telephone <u>(304) 552-3874</u>	

TO THE PERSONS NAMED ABOVE: You should have received this Form and the following documents:

- (1) The application to Plug and Abandon a Well on Form WW-4B, which sets out the parties involved in the work and describes the well its and the plugging work order; and
- (2) The plat (surveyor's map) showing the well location on Form WW-6.

The reason you received these documents is that you have rights regarding the application which are summarized in the instructions on the reverses side. However, you are not required to take any action at all.

Take notice that under Chapter 22-6 of the West Virginia Code, the undersigned well operator proposes to file or has filed this Notice and Application and accompanying documents for a permit to plug and abandon a well with the Chief of the Office of Oil and Gas, West Virginia Department of Environmental Protection, with respect to the well at the location described on the attached Application and depicted on the attached Form WW-6. Copies of this Notice, the Application, and the plat have been mailed by registered or certified mail or delivered by hand to the person(s) named above (or by publication in certain circumstances) on or before the day of mailing or delivery to the Chief.

	Well Operator	<u>Consolidation Coal Company</u>
	By:	<u>Jay Hores</u>
	As:	<u>Project Engineer</u>
	Address	<u>6126 Energy Road</u>
	Telephone	<u>Moundsville, WV 26041</u> <u>(304) 843-3565</u>

Subscribed and sworn before me this 20 day of December 2018
Christian K. Warfield Notary Public
My Commission Expires June 10, 2024

Oil and Gas Privacy Notice

The Office of Oil and Gas processes your personal information, such as name, address and phone number, as a part of our regulatory duties. Your personal information may be disclosed to other State agencies or third parties in the normal course of business or as needed to comply with statutory or regulatory requirements, including Freedom of Information Act requests. Our office will appropriately secure your personal information. If you have any questions about our use of your personal information, please contact DEP's Chief Privacy Officer at depprivacyofficer@wv.gov.

WW-9
(5/16)

API Number 47 - 051 - 01131
Operator's Well No. MC-122A

STATE OF WEST VIRGINIA
DEPARTMENT OF ENVIRONMENTAL PROTECTION
OFFICE OF OIL AND GAS
FLUIDS/ CUTTINGS DISPOSAL & RECLAMATION PLAN

Operator Name Consolidation Coal Company OP Code 10950

Watershed (HUC 10) Unnamed tributary to Middle Grave Creek Quadrangle Majorsville, WV 7.5'

Do you anticipate using more than 5,000 bbls of water to complete the proposed well work? Yes No

Will a pit be used? Yes No

If so, please describe anticipated pit waste: _____

Will a synthetic liner be used in the pit? Yes No If so, what ml.? _____

Proposed Disposal Method For Treated Pit Wastes:

- Land Application (if selected provide a completed form WW-9-GPP)
- Underground Injection (UIC Permit Number _____)
- Reuse (at API Number _____)
- Off Site Disposal (Supply form WW-9 for disposal location)
- Other (Explain Tanks, See attached letter)

Will closed loop system be used? If so, describe: Yes, Gel circulated from tank thru well bore and returned to the tank

Drilling medium anticipated for this well (vertical and horizontal)? Air, freshwater, oil based, etc. Gel or cement

-If oil based, what type? Synthetic, petroleum, etc. _____

Additives to be used in drilling medium? Betonite, Bicarbonate of Soda

Drill cuttings disposal method? Leave in pit, landfill, removed offsite, etc. Shaker cuttings buried on site

-If left in pit and plan to solidify what medium will be used? (cement, lime, sawdust) N/A

-Landfill or offsite name/permit number? N/A

Permittee shall provide written notice to the Office of Oil and Gas of any load of drill cuttings or associated waste rejected at any West Virginia solid waste facility. The notice shall be provided within 24 hours of rejection and the permittee shall also disclose where it was properly disposed.

I certify that I understand and agree to the terms and conditions of the GENERAL WATER POLLUTION PERMIT issued on April 1, 2016, by the Office of Oil and Gas of the West Virginia Department of Environmental Protection. I understand that the provisions of the permit are enforceable by law. Violations of any term or condition of the general permit and/or other applicable law or regulation can lead to enforcement action.

I certify under penalty of law that I have personally examined and am familiar with the information submitted on this application form and all attachments thereto and that, based on my inquiry of those individuals immediately responsible for obtaining the information, I believe that the information is true, accurate, and complete. I am aware that there are significant penalties for submitting false information, including the possibility of fine or imprisonment.

Company Official Signature Jay Hores
Company Official (Typed Name) Jay Hores
Company Official Title Project Engineer

Subscribed and sworn before me this 20 day of December

Christian K. Warfield Notary

My commission expires June 10, 2024

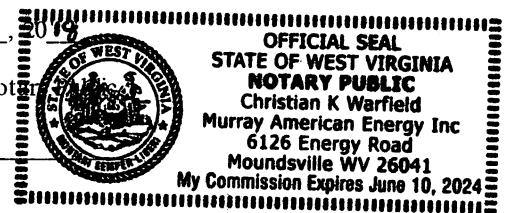

Proposed Revegetation Treatment: Acres Disturbed 1 Prevegetation pH _____

Line 3 Tons/acre or to correct to pH 6.0

Fertilizer type 10-20-20 or equivalent

Fertilizer amount 500 lbs/acre

Mulch 2 Tons/acre

Seed Mixtures

Temporary

Permanent

Seed Type lbs/acre

Seed Type lbs/acre

Seed Mix in accordance with WVDEP Oil
and Gas, Erosion and Sediment Control
Field Manual

Seed Mix in accordance with WVDEP Oil
and Gas, Erosion and Sediment Control
Field Manual

Attach:

Maps(s) of road, location, pit and proposed area for land application (unless engineered plans including this info have been provided). If water from the pit will be land applied, provide water volume, include dimensions (L, W, D) of the pit, and dimensions (L, W), and area in acres, of the land application area.

Photocopied section of involved 7.5' topographic sheet.

Plan Approved by: _____

Comments: _____

Title: _____ Date: _____

Field Reviewed? () Yes () No

N/A

STATE OF WEST VIRGINIA
DEPARTMENT OF ENVIRONMENTAL PROTECTION
OFFICE OF OIL AND GAS
GROUNDWATER PROTECTION PLAN

Operator Name: Consolidation Coal Company

Watershed (HUC 10): Unnamed tributary to Middle Grave Creek Quad: Majorsville, WV 7.5'

Farm Name: _____

1. List the procedures used for the treatment and discharge of fluids. Include a list of all operations that could contaminate the groundwater.

N/A

2. Describe procedures and equipment used to protect groundwater quality from the list of potential contaminant sources above.

3. List the closest water body, distance to closest water body, and distance from closest Well Head Protection Area to the discharge area.

4. Summarize all activities at your facility that are already regulated for groundwater protection.

5. Discuss any existing groundwater quality data for your facility or an adjacent property.

N/A

WW-9- GPP
Rev. 5/16

Page 2 of 2
API Number 47 - 051 - 01131
Operator's Well No. MC-122A

6. Provide a statement that no waste material will be used for deicing or fill material on the property.

7. Describe the groundwater protection instruction and training to be provided to the employees. Job procedures shall provide direction on how to prevent groundwater contamination.

8. Provide provisions and frequency for inspections of all GPP elements and equipment.

Signature: _____

Date: _____

TYPICAL DRAWING OF WELL PLUGGING SITE PLAN

CONSOLIDATION COAL COMPANY
NORTHERN WEST VIRGINIA
OPERATIONS

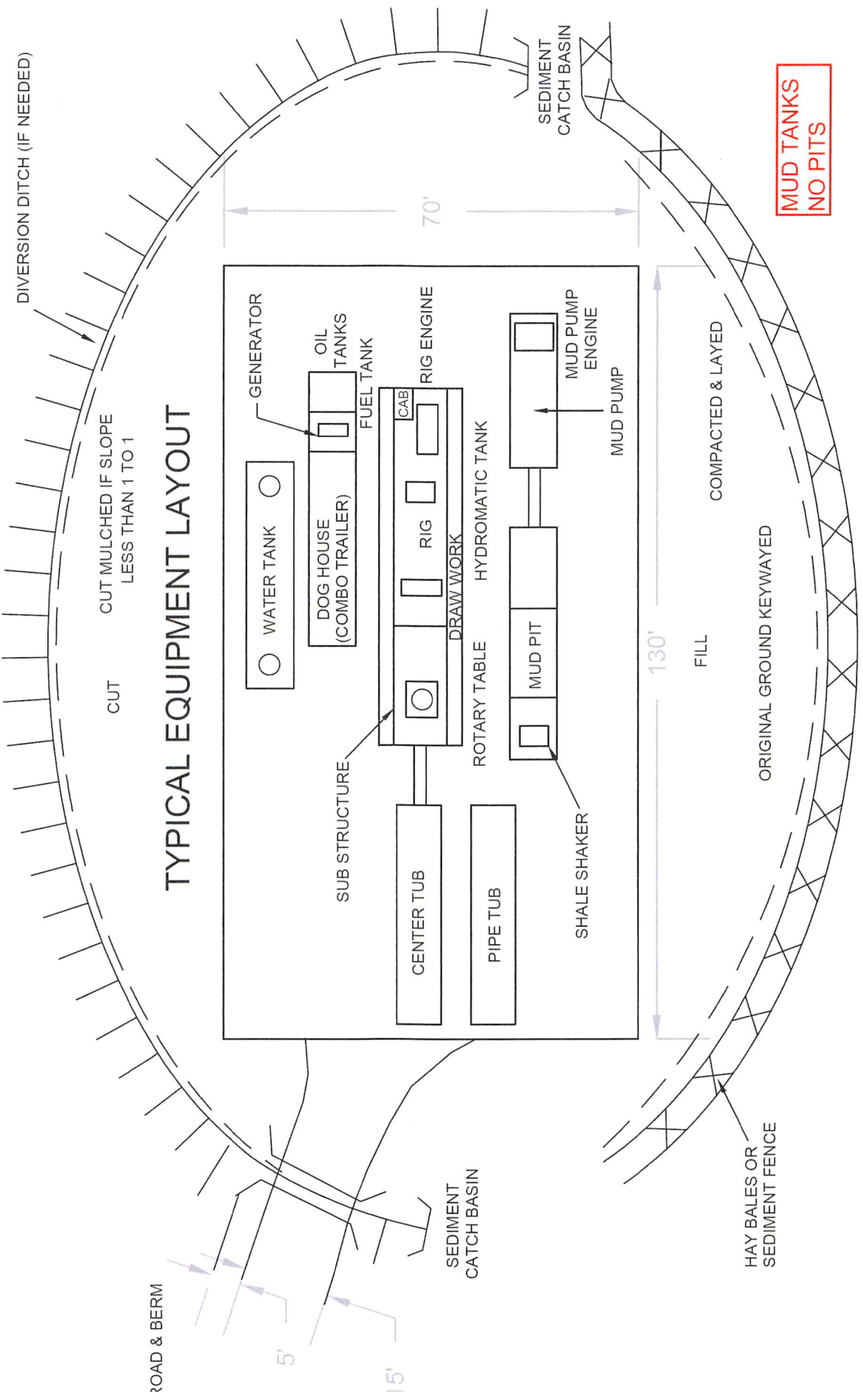

TYPICAL EQUIPMENT LAYOUT

MUD TANKS
NO PITS

ROAD & BERM

5'

15'

SEDIMENT
CATCH BASIN

70'

SEDIMENT
CATCH BASIN

130'

FILL

COMPACTED & LAYED

ORIGINAL GROUND KEYWAYED

HAY BALES OR
SEDIMENT FENCE

DIVERSION DITCH (IF NEEDED)

CUT MULCHED IF SLOPE
LESS THAN 1 TO 1

CUT

WW-7
8-30-06



West Virginia Department of Environmental Protection
Office of Oil and Gas
WELL LOCATION FORM: GPS

API: 47-051-01131 WELL NO.: MC-122A

FARM NAME: Wendt

RESPONSIBLE PARTY NAME: Consolidation Coal Company

COUNTY: Marshall DISTRICT: Webster

QUADRANGLE: Majorsville, WV-PA 7.5'

SURFACE OWNER: Bonnie Wendt

ROYALTY OWNER: _____

UTM GPS NORTHING: 4414801.12

UTM GPS EASTING: 532805.63 GPS ELEVATION: 388.69

The Responsible Party named above has chosen to submit GPS coordinates in lieu of preparing a new well location plat for a plugging permit or assigned API number on the above well. The Office of Oil and Gas will not accept GPS coordinates that do not meet the following requirements:

1. Datum: NAD 1983, Zone: 17 North, Coordinate Units: meters, Altitude: height above mean sea level (MSL) – meters.
2. Accuracy to Datum – 3.05 meters
3. Data Collection Method:

Survey grade GPS : Post Processed Differential _____
Real-Time Differential

Mapping Grade GPS _____ : Post Processed Differential _____
Real-Time Differential _____

4. **Letter size copy of the topography map showing the well location.**

I the undersigned, hereby certify this data is correct to the best of my knowledge and belief and shows all the information required by law and the regulations issued and prescribed by the Office of Oil and Gas.

Jeffrey W. Mangrum
Signature

Well Permitting Manager
Title

22 March 2019
Date

WW-7
8-30-06



West Virginia Department of Environmental Protection
Office of Oil and Gas
WELL LOCATION FORM: GPS

API: 47-051-01131 WELL NO.: MC-122A

FARM NAME: Wendt

RESPONSIBLE PARTY NAME: Murray Energy Corporation

COUNTY: Marshall DISTRICT: Webster

QUADRANGLE: Majorsville, WV-PA 7.5'

SURFACE OWNER: Bonnie Wendt

ROYALTY OWNER: _____

UTM GPS NORTHING: 4414801.12 (1275.22')

UTM GPS EASTING: 532805.63 GPS ELEVATION: 388.69

The Responsible Party named above has chosen to submit GPS coordinates in lieu of preparing a new well location plat for a plugging permit or assigned API number on the above well. The Office of Oil and Gas will not accept GPS coordinates that do not meet the following requirements:

1. Datum: NAD 1983, Zone: 17 North, Coordinate Units: meters, Altitude: height above mean sea level (MSL) – meters.
2. Accuracy to Datum – 3.05 meters
3. Data Collection Method:

Survey grade GPS : Post Processed Differential _____

Real-Time Differential

Mapping Grade GPS _____ : Post Processed Differential _____

Real-Time Differential _____

4. **Letter size copy of the topography map showing the well location.**

I the undersigned, hereby certify this data is correct to the best of my knowledge and belief and shows all the information required by law and the regulations issued and prescribed by the Office of Oil and Gas.

Jeffrey A. Musgrave
Signature

Well Permitting Manager
Title

20 December 2018
Date



WELL LOCATION
UTM 17-NAD83
 N:4414801.12
 E:532805.63
NAD27, WV NORTH
 N:505509.52
 E:1686668.79
LAT/LOG DATUM-WGS84
 LAT:39°52'57.48"
 LON:80°36'58.80"
MINE COORDINATES
 N:-52135.046
 E:80876.314

LOCATION MAP
 DECEMBER 20, 2018

Blue Mountain
 10125 MASON DIXON HIGHWAY
 BURTON, WV 26562
 PHONE: (304) 662-6486

MC-122A
 MAJORSVILLE QUADRANGLE
 WEST VIRGINIA

SCALE 1" = 2000'
 0' 2000' 4000' 6000'



Latitude: 39°55'00"

Longitude: 80°35'00"

NOTES:

1. There are no dwellings within 200' of proposed well.
2. Proposed well is greater than 100' from the mineral line
3. It is not the purpose or intention of this plat to represent surveyed locations of the surface or mineral parcels depicted hereon. The location of the boundary lines, as shown, are based on record deed descriptions, field evidence found and/or tax map position, unless otherwise noted.



- LEGEND (WELLS WITHIN 2500')
- ☀ - ACTIVE
 - ⬤ - ABANDONED
 - ⊛ - PLUGGED
 - - NEVER DRILLED
 - ⊙ - UNDER CONSTRUCTION
 - ⊕ - NEW WELL

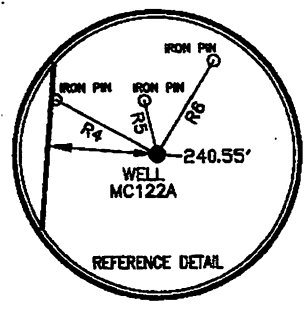

COORDINATES:
9,325' WEST (80°36'58.80")
12,431' SOUTH (39°52'57.48")

LINE	BEARING	DISTANCE
L1	S 05°12'58" W	1376.63'
L2	N 84°05'54" W	635.93'
L3	N 04°54'06" E	1349.70'
L4	S 86°30'49" E	641.59'

LINE	BEARING	DISTANCE
R1	N 29°53'20" E	948.93'
R2	S 32°23'08" E	649.19'
R3	S 30°21'08" W	559.78'
R4	N 61°05'53" W	252.51'
R5	N 12°31'05" W	121.39'
R6	N 31°32'19" E	240.77'



Blue Mountain Engineering
11023 MASON DIXON HIGHWAY
BURTON, WV 28562
PHONE: (304) 662-8486

FILE #: MC122A
DRAWING #: MC122A
SCALE: 1" = 1000'
MINIMUM DEGREE OF ACCURACY: 1/2500
PROVEN SOURCE OF ELEVATION: U.S.G.S. MONUMENT THOMAS 1498.81'

I, THE UNDERSIGNED, HEREBY CERTIFY THAT THIS PLAT IS CORRECT TO THE BEST OF MY KNOWLEDGE AND BELIEF AND SHOWS ALL THE INFORMATION REQUIRED BY LAW AND THE REGULATIONS ISSUED AND PRESCRIBED BY THE DEPARTMENT OF ENVIRONMENTAL PROTECTION.

Signed: _____
R.P.E.: _____ L.L.S.: P.S. No. 2000

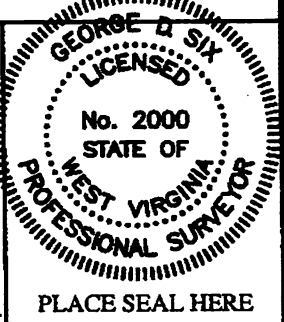

(+) DENOTES LOCATION OF WELL ON UNITED STATES TOPOGRAPHIC MAPS WVDEP
OFFICE OF OIL & GAS
601 57TH STREET
CHARLESTON, WV 25304



DATE: MARCH 20, 2008
OPERATOR'S WELL #: MC122A
API WELL #: 47 51 01131
STATE COUNTY PERMIT

Well Type: Oil Waste Disposal Production Deep
 Gas Liquid Injection Storage Shallow

WATERSHED: UNNAMED TRIBUTARY TO MIDDLE GRAVE CREEK ELEVATION: 1275.22'

COUNTY/DISTRICT: MARSHALL/WEBSTER QUADRANGLE: MAJORSVILLE, WV-PA 7.5'

SURFACE OWNER: JUANITA FITZSIMMONS ACREAGE: 20.00±
OIL & GAS ROYALTY OWNER: SEE ATTACHED ACREAGE: 20.00±

DRILL CONVERT DRILL DEEPER REDRILL FRACTURE OR STIMULATE
PLUG OFF OLD FORMATION PERFORATE NEW FORMATION PLUG & ABANDON
CLEAN OUT & REPLUG OTHER CHANGE (SPECIFY): _____

TARGET FORMATION: PITTSBURGH/SEWICKLEY ESTIMATED DEPTH: 834'±

WELL OPERATOR: CNX Gas Company LLC DESIGNATED AGENT: JOHN H. JOHNSTON
Address: 2481 JOHN NASH BLVD. Address: BANK ONE CENTER, PO BOX 1588
City: BLUEFIELD State: WV Zip Code: 24701 City: CHARLESTON State: WV Zip Code: 25326-1598

MARS 1/31

Well is located on topo map 12,431 feet south of Latitude: 39° 55' 00"

WELL LOCATION
UTM 17-NAD83
N:4414801.12
E:532805.63
NAD27, WV NORTH
N:505509.52
E:1686668.79
LAT/LON DATUM-WGS84
LAT:39°52'57.48"
LN:80°36'58.80"
MINE COORDINATES
N:-52135.046
E:80876.314



Well is located on topo map 9,325 feet west of Longitude: 80° 35' 00"

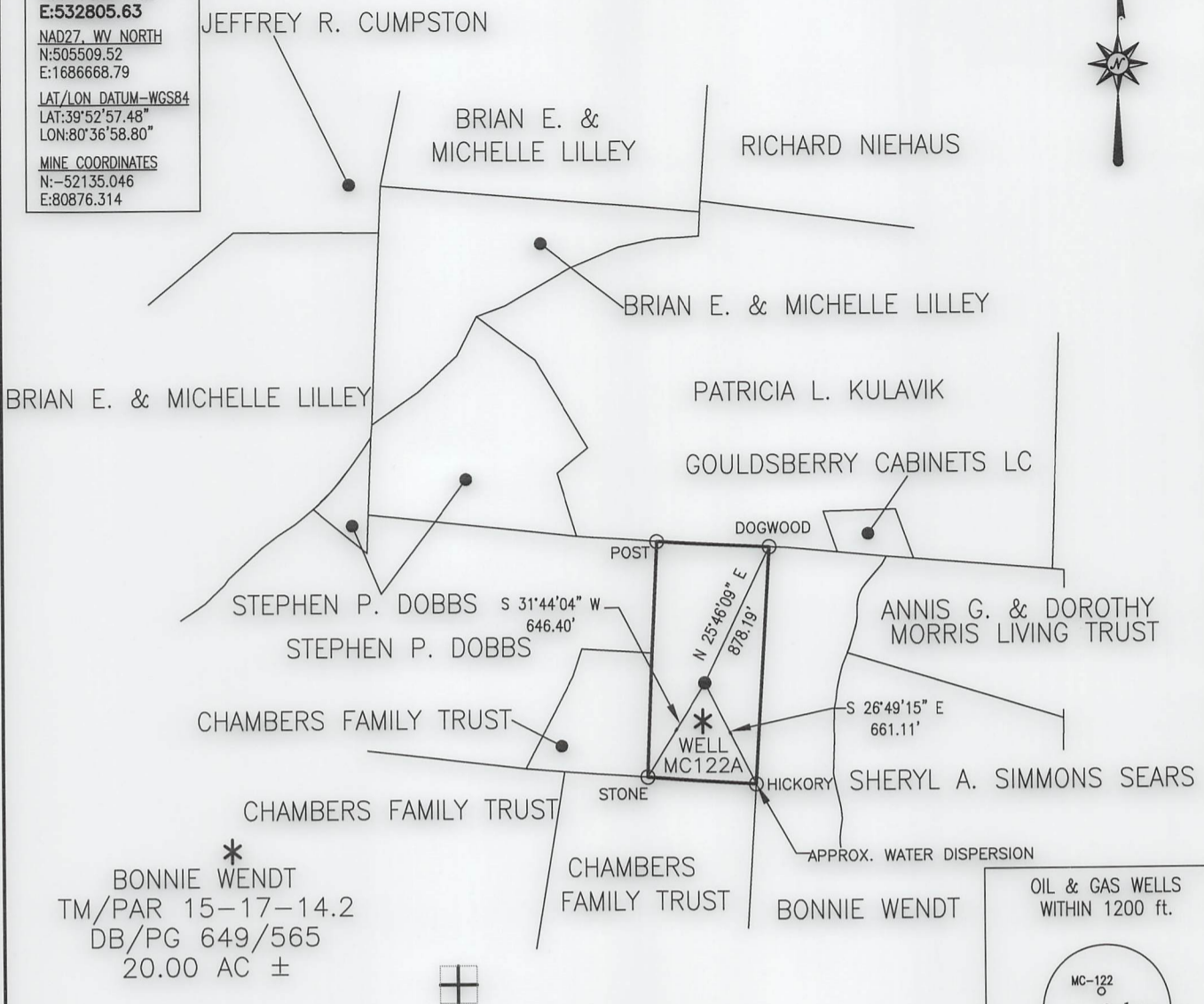

*
 BONNIE WENDT
 TM/PAR 15-17-14.2
 DB/PG 649/565
 20.00 AC ±

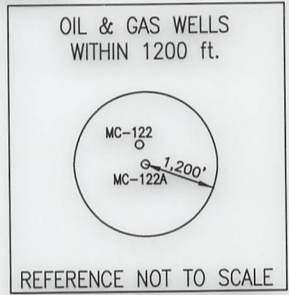

Blue Mountain
 10125 MASON DIXON HIGHWAY
 BURTON, WV 26562
 PHONE: (304) 662-6486

NOTE:
 It is not the purpose or intention of this plat to represent surveyed locations of the surface or mineral parcels depicted hereon. The location of the boundary lines, as shown, are based on record deed descriptions, field evidence found and/or tax map position, unless otherwise noted.

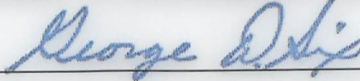

FILE #: MC-122A
 DRAWING #: MC-122A
 SCALE: 1" = 1000'
 MINIMUM DEGREE
 OF ACCURACY: 1/2500
 PROVEN SOURCE
 OF ELEVATION: U.S.G.S. MONUMENT
 THOMAS 1498.81'

I, THE UNDERSIGNED, HEREBY CERTIFY THAT THIS
 PLAT IS CORRECT TO THE BEST OF MY KNOWLEDGE AND
 BELIEF AND SHOWS ALL THE INFORMATION REQUIRED BY
 LAW AND THE REGULATIONS ISSUED AND PRESCRIBED BY
 THE DEPARTMENT OF ENVIRONMENTAL PROTECTION.

Signed: 

R.P.E.: _____ L.L.S.: P.S. No. 2000

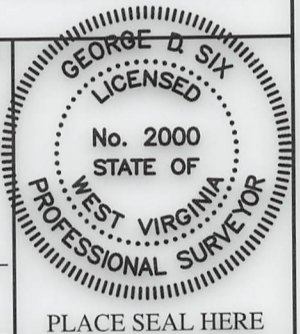

(+) DENOTES LOCATION OF WELL ON
 UNITED STATES TOPOGRAPHIC MAPS
 WVDEP
 OFFICE OF OIL & GAS
 601 57TH STREET
 CHARLESTON, WV 25304



DATE: DECEMBER 20, 2018
 OPERATOR'S WELL #: MC-122A
 API WELL #: 47 51 01131 P
 STATE COUNTY PERMIT

Well Type: Oil Waste Disposal Production Deep
 Gas Liquid Injection Storage Shallow

WATERSHED: MIDDLE GRAVE CREEK - GRAVE CREEK ELEVATION: 1275.22'

COUNTY/DISTRICT: MARSHALL/WEBSTER QUADRANGLE: MAJORSVILLE, WV-PA 7.5'

SURFACE OWNER: BONNIE WENDT ACREAGE: 20.00±

OIL & GAS ROYALTY OWNER: _____ ACREAGE: _____

DRILL CONVERT DRILL DEEPER REDRILL FRACTURE OR STIMULATE
 PLUG OFF OLD FORMATION PERFORATE NEW FORMATION PLUG & ABANDON
 CLEAN OUT & REPLUG OTHER CHANGE (SPECIFY): _____

TARGET FORMATION: PITTSBURGH/SEWICKLEY ESTIMATED DEPTH: 834'±

WELL OPERATOR MURRAY ENERGY CORPORATION DESIGNATED AGENT DAVID RODDY
 Address 6126 ENERGY DRIVE Address 6126 ENERGY DRIVE
 City MOUNDSVILLE State WV Zip Code 26041 City MOUNDSVILLE State WV Zip Code 26041