

Latitude: 39°47'30"

Longitude: 80°40'00"

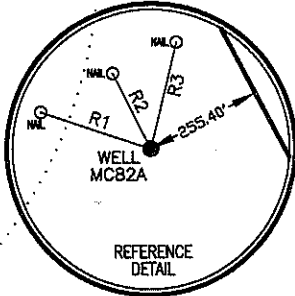

- LEGEND
(WELLS WITHIN 2500')
- ☀ - ACTIVE
 - - ABANDONED
 - ✱ - PLUGGED
 - - NEVER DRILLED
 - ⊗ - UNDER CONSTRUCTION
 - ⊕ - NEW WELL

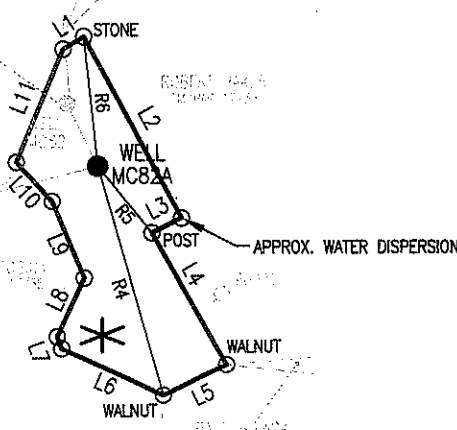

PAUL BOBICK
TM/PAR 17/35
DB/PG 607/691
21.97 ACRES ±

NOTES:

1. There are no dwellings within 200' of proposed well.
2. Proposed well is greater than 100' from the mineral line
3. It is not the purpose or intention of this plat to represent surveyed locations of the surface or mineral parcels depicted hereon. The location of the boundary lines, as shown, are based on record deed descriptions, field evidence found and/or tax map position, unless otherwise noted.

LINE	BEARING	DISTANCE
L1	N 58°51'40" E	123.75'
L2	S 28°08'38" E	1062.00'
L3	S 63°35'25" W	171.30'
L4	S 29°36'07" E	784.00'
L5	S 64°07'59" W	363.09'
L6	N 65°10'01" W	580.79'
L7	N 20°10'01" W	66.00'
L8	N 24°49'59" E	332.48'
L9	N 22°40'01" W	429.00'
L10	N 42°25'01" W	273.07'
L11	N 22°49'59" E	633.27'

LINE	BEARING	DISTANCE
R1	N 71°34'47" W	251.60'
R2	N 27°02'36" W	183.25'
R3	N 13°23'55" E	236.31'
R4	S 16°01'27" E	1232.06'
R5	S 39°05'20" E	443.34'
R6	N 05°48'20" W	671.97'



Blue Mountain Engineering
11023 MASON DIXON HIGHWAY
BURTON, WV 26562
PHONE: (304) 662-6486

COORDINATES:
1,450' WEST (80°40'18.33")
13,238' SOUTH (39°45'19.35")

FILE #: MC82A
DRAWING #: MC82A
SCALE: 1" = 1000'
MINIMUM DEGREE OF ACCURACY: 1/2500
PROVEN SOURCE OF ELEVATION: U.S.G.S. MONUMENT THOMAS 1498.81'

I, THE UNDERSIGNED, HEREBY CERTIFY THAT THIS PLAT IS CORRECT TO THE BEST OF MY KNOWLEDGE AND BELIEF AND SHOWS ALL THE INFORMATION REQUIRED BY LAW AND THE REGULATIONS ISSUED AND PRESCRIBED BY THE DEPARTMENT OF ENVIRONMENTAL PROTECTION.

Signed: _____
R.P.E.: _____ L.L.S.: P.S. No. 2000

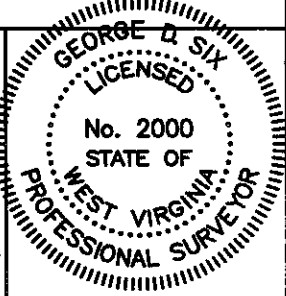

(+) DENOTES LOCATION OF WELL ON UNITED STATES TOPOGRAPHIC MAPS WVDEP
OFFICE OF OIL & GAS
601 57TH STREET
CHARLESTON, WV 25304



DATE: FEBRUARY 11, 2009
OPERATOR'S WELL #: MC82A
API WELL #: 47. 51 01248C

Well Type: Oil Waste Disposal Production Deep
 Gas Liquid Injection Storage Shallow

STATE COUNTY PERMIT
CANCELLED

WATERSHED: UNNAMED TRIBUTARY TO LICK RUN ELEVATION: 1438.11'

COUNTY/DISTRICT: MARSHALL/MEADE QUADRANGLE: GLEN EASTON, WV 7.5'

SURFACE OWNER: PAUL BOBICK ACREAGE: 21.97±

OIL & GAS ROYALTY OWNER: SEE ATTACHED ACREAGE: 21.97±

DRILL CONVERT DRILL DEEPER REDRILL FRACTURE OR STIMULATE
PLUG OFF OLD FORMATION PERFORATE NEW FORMATION PLUG & ABANDON
CLEAN OUT & REPLUG OTHER CHANGE (SPECIFY): _____

TARGET FORMATION: PITTSBURGH ESTIMATED DEPTH: 1210'±

WELL OPERATOR: CNX Gas Company LLC DESIGNATED AGENT: JOHN H. JOHNSTON
Address: 2481 JOHN NASH BLVD. Address: BANK ONE CENTER, PO BOX 1588
City: BLUEFIELD State: WV Zip Code: 24701 City: CHARLESTON State: WV Zip Code: 25302