

Latitude: 39°45'00"

Longitude: 80°40'00"

NOTES:

1. There are no dwellings within 200' of proposed well.
2. Proposed well is greater than 100' from the mineral line.
3. It is not the purpose or intention of this plat to represent surveyed locations of the surface or mineral parcels depicted hereon. The location of the boundary lines, as shown, are based on record deed descriptions, field evidence found and/or tax map position, unless otherwise noted.

LEGEND (WELLS WITHIN 2500')

- ☉ - ACTIVE
- ☼ - ABANDONED
- ☼ - PLUGGED
- - NEVER DRILLED
- ⊗ - UNDER CONSTRUCTION
- ⊗ - NEW WELL

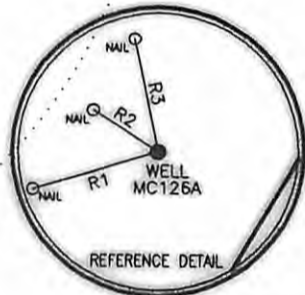

REFERENCE LINES		
LINE	BEARING	DISTANCE
R1	S 73°01'39" W	280.04'
R2	N 57°17'23" W	165.61'
R3	N 12°02'28" W	249.09'

LINE	BEARING	DISTANCE
L1	S 60°00'00" E	432.90'
L2	S 79°55'02" E	129.07'



Blue Mountain Engineering
 11023 MASON DIXON HIGHWAY
 BURTON, WV 26562
 PHONE: (304) 682-6486

COORDINATES:
 8,829' WEST (80°41'52.48")
 10,130' SOUTH (39°43'20.13")

THOMAS J. FOX
 TM/PAR 22/10
 DB/PG 635/454
 91.21 ACRES ±

FILE #: MC126A
 DRAWING #: MC126A
 SCALE: 1" = 1000'
 MINIMUM DEGREE OF ACCURACY: 1/2500
 PROVEN SOURCE OF ELEVATION: U.S.G.S. MONUMENT THOMAS 1498.81'

I, THE UNDERSIGNED, HEREBY CERTIFY THAT THIS PLAT IS CORRECT TO THE BEST OF MY KNOWLEDGE AND BELIEF AND SHOWS ALL THE INFORMATION REQUIRED BY LAW AND THE REGULATIONS ISSUED AND PRESCRIBED BY THE DEPARTMENT OF ENVIRONMENTAL PROTECTION.

Signed: *George D. Six*
 R.P.E.: _____ L.L.S.: P.S. No. 2000

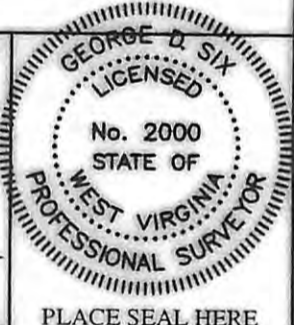

(+) DENOTES LOCATION OF WELL ON UNITED STATES TOPOGRAPHIC MAPS WVDEP
 OFFICE OF OIL & GAS
 601 57TH STREET
 CHARLESTON, WV 25304

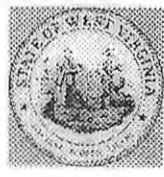

DATE: FEBRUARY 23, 2009
 OPERATOR'S WELL #: MC126A
 API WELL #: 47 51 01252C
 STATE COUNTY PERMIT

Well Type: Oil Waste Disposal Production Deep
 Gas Liquid Injection Storage Shallow

CANCELLED

WATERSHED: BARK CAMP RUN ELEVATION: 1330.61'
 COUNTY/DISTRICT: MARSHALL/MEADE QUADRANGLE: WILEYVILLE, WVA 7.5'
 SURFACE OWNER: THOMAS J. FOX ACREAGE: 91.21±
 OIL & GAS ROYALTY OWNER: SEE ATTACHED ACREAGE: 91.21±

DRILL CONVERT DRILL DEEPER REDRILL FRACTURE OR STIMULATE
 PLUG OFF OLD FORMATION PERFORATE NEW FORMATION PLUG & ABANDON
 CLEAN OUT & REPLUG OTHER CHANGE (SPECIFY): _____

TARGET FORMATION: PITTSBURGH ESTIMATED DEPTH: 1,128'±
 WELL OPERATOR CNX Gas Company LLC DESIGNATED AGENT JOHN H. JOHNSTON
 Address 2481 JOHN NASH BLVD. Address BANK ONE CENTER, PO BOX 1588
 City BLUEFIELD State WV Zip Code 24701 City CHARLESTON State WV Zip Code 25326-1598

08/30/2013