

REFERENCE LINES
RL #1
N 88°30'45" E 415'

GEORGE HAUGHT  
38.30 TOTAL ACRES  
LEASE NUMBERS  
1-265775-001  
1-265775-002  
1-265775-003  
1-265775-004  
1-265775-005  
TAX MAP AND PARCEL  
13-6-51.1

SERAFIN T. AND  
MARTHA G. ORTIZ  
50 TOTAL ACRES  
LEASE NUMBER  
1-305154-000  
TAX MAP AND PARCEL  
13-6-49

PROPERTY OWNER	TOTAL ACRES	TAX MAP AND PARCEL	LEASE NUMBER
A. SHARAT C BANAR ET UX	0.46	13-110-10	1-542738-000
B. PAUL MICHAEL BAUER ET UX	0.45	13-110-9	1-342704-000
C. WILLIAM A GAMES ET UX	0.25	13-110-15	1-312294-000
D. MARK P HINERMAN	0.27	13-110-14	1-312493-000
E. DONALD E BURKEY	0.24	13-110-19	
F. RICHARD R YOUNG ET UX	0.24	13-110-18	
G. MARTIN Y C TSE ET UX	0.25	13-110-17	1-312665-000
H. BYRON W FILBEN ET UX	0.25	13-110-27	
I. BRENDA J ANDLINGER	0.25	13-110-28	
J. MARK A KERWOOD ET UX	0.33	13-110-10	1-312375-002
K. JOHN F & ALEXA A BUSHOVISKY	0.33	13-110-9	1-312375-003
L. MARK C JR & MELANIE L COFFIELD	0.34	13-110-11	
M. DAVID H POLINSKI ET UX	0.28	13-110-12	
N. BRYAN E & KAREN L HILT	0.24	13-110-20	
O. DUSTIN D & ASHLEY A AIKEN	0.26	13-110-26	
P. JERRY D COOK ET UX	0.44	13-110-6	1-312336-000
Q. DAVID P FLAKER ET UX	0.33	13-110-15	
R. CHRISTIE L RITTLE	0.32	13-110-16	1-312385-000
S. CHARLES W TERRILL ET UX	0.26	13-110-25	1-312426-000
T. JAMES B BOSWORTH ET UX	0.68	13-110-1	1-312375-001
U. JAMES B BOSWORTH ET UX	0.56	13-110-2	
V. JOHN F JURA ET UX	0.52	13-110-3	
W. JOHN F JURA ET UX	0.33	13-110-6	1-312375-006

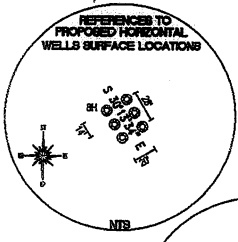
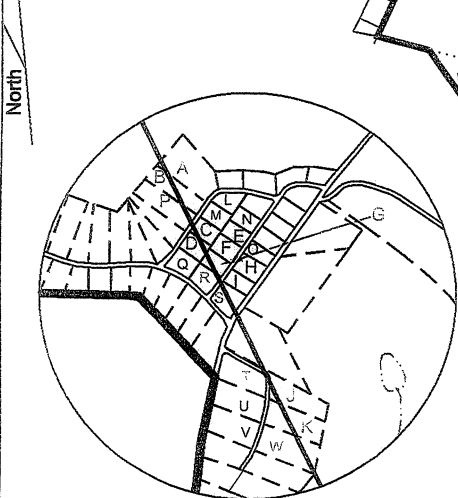

BRADLEY C. BURROUGH  
1.32 TOTAL ACRES  
LEASE NUMBER  
1-312478-000  
TAX MAP AND PARCEL  
13-11-27.2

DOROTHY KAY  
PRENAT  
6.3 TOTAL ACRES  
TAX MAP AND PARCEL  
13-11-28

RUTH ANN KELLER AND  
DAVID J. COOK  
173.061 TOTAL ACRES  
LEASE NUMBER  
1-274384-001  
1-274384-002  
TAX MAP AND PARCEL  
13-6-50

RODNEY D. AND  
TRIMOTHY D. BLANEY  
40.52 TOTAL ACRES  
LEASE NUMBER  
1-280287-001  
1-280287-002  
TAX MAP AND PARCEL  
13-11-27.1

ROBERT K. CLARK  
1.97 TOTAL ACRES  
TAX MAP AND PARCEL  
13-11-27.6

HERMAN R. AND  
PATRICIA A. MULDREW  
29.097 TOTAL ACRES  
LEASE NUMBER  
1-280337-000  
TAX MAP AND PARCEL  
13-11-27

MARSHALL LAND LLC.  
119.52 TOTAL ACRES  
TAX MAP AND PARCEL  
13-10-2

TOP HOLE (NAD 83)	TP (NAD 83)
N) 545255.4 E) 1630233.9 LAT.) 39°59'26.7" LONG.) 80°42'26.3" DEC. LAT.) 39.990746 DEC. LONG.) 80.707311	N) 545266.2 E) 1630648.7 LAT.) 39°59'26.8" LONG.) 80°42'21.0" DEC. LAT.) 39.990791 DEC. LONG.) 80.705831
TOP HOLE (NAD 27)	TP (NAD 27)
N) 545218.9 E) 1661689.7 LAT.) 39°59'26.4" LONG.) 80°42'27.0" DEC. LAT.) 39.990673 DEC. LONG.) 80.707507	N) 545229.7 E) 1662084.4 LAT.) 39°59'26.6" LONG.) 80°42'21.7" DEC. LAT.) 39.990717 DEC. LONG.) 80.706028
KOP (NAD 83)	BOTTOM HOLE (NAD 83)
N) 545715.6 E) 1630429.5 LAT.) 39°59'31.3" LONG.) 80°42'23.9" DEC. LAT.) 39.992017 DEC. LONG.) 80.706635	N) 541007.3 E) 1632725.9 LAT.) 39°58'45.0" LONG.) 80°41'53.6" DEC. LAT.) 39.979177 DEC. LONG.) 80.698215
KOP (NAD 27)	BOTTOM HOLE (NAD 27)
N) 545679.1 E) 1661865.2 LAT.) 39°59'31.0" LONG.) 80°42'24.6" DEC. LAT.) 39.991943 DEC. LONG.) 80.706831	N) 540970.8 E) 1664161.6 LAT.) 39°58'44.8" LONG.) 80°41'54.3" DEC. LAT.) 39.979103 DEC. LONG.) 80.698412

**REFERENCE NOTES**  
Boundaries as shown taken from deeds, tax maps and field locations. A full boundary survey is not expressed nor implied. All bearings are based on true north. Ownership taken from public records Marshall County, West Virginia MAY 2011  
State Plane Coordinates & NAD 83 Lat/Long by differential submeter mapping grade GPS  
Drafted by: E.A.M.

FILE #: CHE 077  
DRAWING #: 1685  
SCALE: 1"=1200'  
MINIMUM DEGREE OF ACCURACY: 1/200  
PROVEN SOURCE: SUBMETER MAPPING  
OF ELEVATION: GRADE GPS

I, THE UNDERSIGNED, HEREBY CERTIFY THAT THIS PLAT IS CORRECT TO THE BEST OF MY KNOWLEDGE AND BELIEF AND SHOWS ALL THE INFORMATION REQUIRED BY LAW AND THE REGULATIONS ISSUED AND PRESCRIBED BY THE DEPARTMENT OF ENVIRONMENTAL PROTECTION.  
Signed:   
L.L.S. #2124 : Ernest J. Benchek III

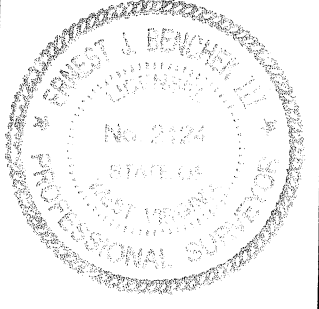

(+) DENOTES LOCATION OF WELL ON UNITED STATES TOPOGRAPHIC MAPS  
WVDEP  
OFFICE OF OIL & GAS  
601 57TH STREET  
CHARLESTON, WV 25304

Well Type:  Oil  Waste Diposal  Production  Deep  
 Gas  Liquid Injection  Storage  Shallow

WATERSHED: UPPER OHIO SOUTH  
ELEVATION: 1,280'

COUNTY/DISTRICT: MARSHALL / UNION  
QUADRANGLE: MOUNDSVILLE, WV.

SURFACE OWNER: SERAFIN T. AND MARTHA G. ORTIZ  
ACREAGE: 50 +/-

OIL & GAS ROYALTY OWNER: SERAFIN T. AND MARTHA G. ORTIZ  
ACREAGE: 577.868 +/-

LEASE NUMBERS:

DRILL  CONVERT  DRILL DEEPER  REDRILL  FRACTURE OR STIMULATE   
PLUG OFF FORMATION  PERFORATE NEW FORMATION  PLUG & ABANDON   
CLEAN OUT & REPLUG  OTHER CHANGE  (SPECIFY):

TARGET FORMATION: MARCELLUS  
ESTIMATED DEPTH: TVD: 6,200' TMD: 15,219'

WELL OPERATOR : CHESAPEAKE APPALACHIA, LLC.  
DESIGNATED AGENT : ERIC B. GILLESPIE

ADDRESS: PO BOX 18496  
ADDRESS: Po Box 6070

CITY: OKLAHOMA CITY STATE: OK ZIP CODE: 73154-0496  
CITY: CHARLESTON STATE: WV ZIP CODE: 25301

DATE: AUGUST 22, 2011

OPERATOR'S WELL #: SERAFIN ORTIZ MSH 8H

API WELL #: 47 51 01509H  
STATE COUNTY PERMIT

