

bottom hole 80°34'03.4" (80.567611)

top hole 80°33'57.88" (80.566079)

As Drilled

SIVERT, ET AL 203.749 ACRE LEASE

NORTH

Mueller

Robinson

Robinson

UTM NAD 83
top hole
N: 4411674.1
E: 537118.0
bottom hole
N: 4410717
E: 537010

WV NORTH NAD. 83
N: 495048.741
E: 1669212.464

McELROY MINE
COORD.
N: -62442.607
E: 94996.667

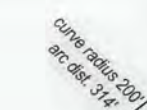
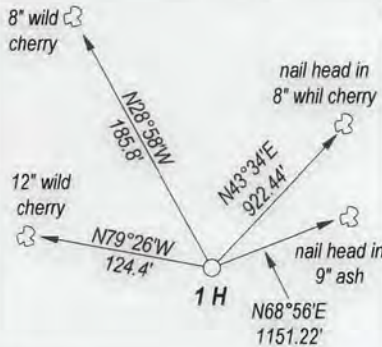

S02°W 1868'

S02°W 858'

bottom hole

S78°E 681'

S86°11'E

S86°11'E 822'

1583'

222'

S85°40'E

539'

1428

2500

1100 CBM

bore hole

South 2900' true north

bottom hole

Robinson

County

Route 64

Simmons

Mueller

Koch

Sivert

Dempewolf

Mueller

Mueller

Mueller

1 H

EL. 1438'

West 190° true north

N20°36'W

1449'

N56°10'E 1413'

Winland

fence inter.

80°32'30"

S03°52'E 3628'

10700'

6900'

10700'

7570'

10700'

top hole 39°51'15.41" (39.854281)

bottom hole 39°50'44.3" (39.845639)

LATITUDE

LONGITUDE

George L. Sivert & Antoinette M. Sivert
109.479 acre surface

FILE NO. _____
DRAWING NO. _____
SCALE 1" = 1000'
MINIMUM DEGREE OF ACCURACY 1 : 200
PROVEN SOURCE OF ELEVATION GPS
OBSERVATION

I, THE UNDERSIGNED, HEREBY CERTIFY THAT THIS PLAT IS CORRECT TO THE BEST OF MY KNOWLEDGE AND BELIEF AND SHOWS ALL THE INFORMATION REQUIRED BY LAW AND THE REGULATIONS ISSUED AND PRESCRIBED BY THE DEPARTMENT OF ENERGY.

(SIGNED)

PROFESSIONAL SURVEYOR: 551



STATE OF WEST VIRGINIA DEPARTMENT OF ENERGY DIVISION OF OIL AND GAS

DATE APRIL 2ND, 2013
OPERATORS WELL NO. SIVERT 1H

API 47 - 051 - 01668
STATE COUNTY PERMIT

WELL TYPE: OIL GAS LIQUID INJECTION WASTE DISPOSAL
(IF GAS) PRODUCTION STORAGE DEEP SHALLOW

LOATION: ELEVATION 1438' WATER SHED NORTH FORK OF GRAVE CREEK
DISTRICT CAMERON COUNTY MARSHALL QUADRANGLE CAMERON

SURFACE OWNER GEORGE L. SIVERT & ANTOINETTE M. SIVERT ACREAGE 109.479
OIL & GAS ROYALTY SIVERT, ET AL LEASE AC 203.749

PROPOSED WORK: DRILL CONVERT DRILL DEEPER REDRILL
FRACTURE OR STIMULATE PLUG OFF OLD FORMATION
PERFORATE NEW FORMATION
OTHER PHYSICAL CHANGE IN WELL
PLUG AND ABANDON CLEAN OUT AND REPLUG

TARGET FORMATION MARCELLUS SHALE ESTIMATED DEPTH 7200'

WELL OPERATOR TRANS ENERGY, INC. DESIGNATED AGENT LOREN BAGLEY
ADDRESS P. O. BOX 393 ADDRESS P. O. BOX 393
ST. MARYS, WV 26170 ST. MARYS, WV 26170

FORM WW - 6

COUNTY NAME

PREMIT

05/06/2016