

top hole 80°33'58.08" (80.566132) 6905'  
 bottom hole 80°33'56.1" (80.565583) 6700'

**SIVERT, ET AL  
 203.749 ACRE LEASE**

LATITUDE 39°52'30"

LONGITUDE 80°32'30"

NORTH

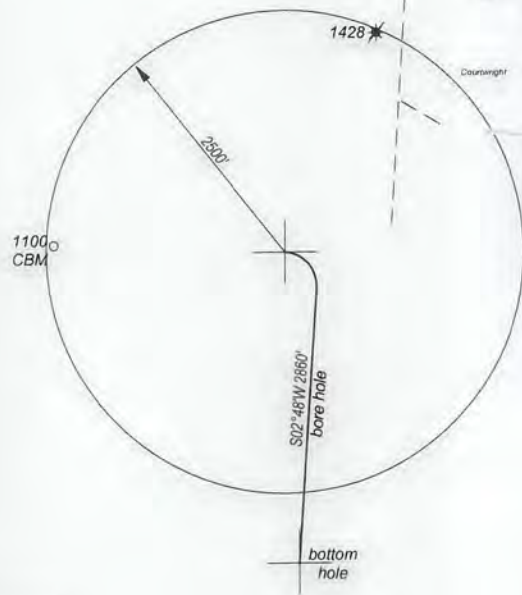

UTM NAD 83  
 top hole  
 N: 4411675.1  
 E: 537113.537  
 bottom hole  
 N: 4410717  
 E: 537010

WV NORTH NAD. 83  
 N: 495052.098  
 E: 1669197.844

McELROY MINE  
 COORD.  
 N: -62439.448  
 E: 94982.003

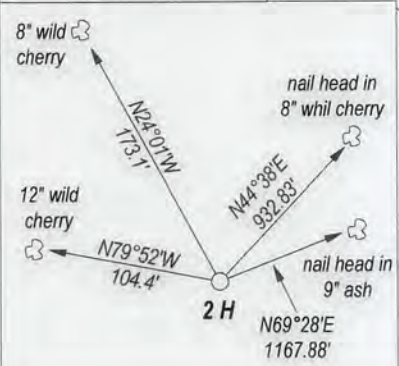

RECEIVED  
 Office of Oil and Gas  
 JUNE 13 2013  
 WV Department of Energy  
 Environmental Protection

No existing wells within 500' feet of lateral  
 No water wells within 250' of top hole  
 No buildings of any kind within 625' of top hole

*Handwritten notes:*  
 0.22  
 8.33  
 13

top hole 39°51'15.44" (39.854290)  
 bottom hole 39°50'43.5" (39.845417)

FILE NO. \_\_\_\_\_  
 DRAWING NO. \_\_\_\_\_  
 SCALE 1" = 2500'  
 MINIMUM DEGREE OF ACCURACY 1 : 200  
 PROVEN SOURCE OF ELEVATION GPS  
 OBSERVATION

I, THE UNDERSIGNED, HEREBY CERTIFY THAT THIS PLAT IS CORRECT TO THE BEST OF MY KNOWLEDGE AND BELIEF AND SHOWS ALL THE INFORMATION REQUIRED BY LAW AND THE REGULATIONS ISSUED AND PRESCRIBED BY THE DEPARTMENT OF ENERGY.

(SIGNED) *[Signature]*  
 PROFESSIONAL SURVEYOR: 551



**STATE OF WEST VIRGINIA  
 DEPARTMENT OF ENERGY  
 DIVISION OF OIL AND GAS**

DATE AUGUST 21ST, 2013  
 OPERATORS WELL NO. SIVERT 2H

**API 47 - 051 - 01670**  
 STATE COUNTY PERMIT

WELL TYPE: OIL  GAS  LIQUID INJECTION \_\_\_\_\_ WASTE DISPOSAL \_\_\_\_\_  
 (IF GAS) PRODUCTION  STORAGE \_\_\_\_\_ DEEP \_\_\_\_\_ SHALLOW

LOATION: ELEVATION 1438' WATER SHED NORTH FORK OF GRAVE CREEK  
 DISTRICT CAMERON COUNTY MARSHALL QUADRANGLE CAMERON

SURFACE OWNER GEORGE M. SIVERT & ANTOINETTE M. SIVERT ACREAGE 109.479  
 OIL & GAS ROYALTY SIVERT, ET AL LEASE AC. 203.749

PROPOSED WORK: DRILL  CONVERT \_\_\_\_\_ DRILL DEEPER \_\_\_\_\_ REDRILL \_\_\_\_\_  
 FRACTURE OR STIMULATE \_\_\_\_\_ PLUG OFF OLD FORMATION \_\_\_\_\_  
 PERFORATE NEW FORMATION \_\_\_\_\_  
 OTHER PHYSICAL CHANGE IN WELL \_\_\_\_\_  
 PLUG AND ABANDON \_\_\_\_\_ CLEAN OUT AND REPLUG \_\_\_\_\_

TARGET FORMATION MARCELLUS SHALE ESTIMATED DEPTH 7200'

WELL OPERATOR TRANS ENERGY, INC. DESIGNATED AGENT LOREN BAGLEY  
 ADDRESS P. O. BOX 393 ADDRESS P. O. BOX 393  
ST. MARYS, WV 26170 ST. MARYS, WV 26170

FORM WW - 6

COUNTY NAME \_\_\_\_\_  
 PERMIT \_\_\_\_\_

05/06/2016