

Well is located on topo map 674' feet south of Latitude: 39° 52' 30"

SURFACE HOLE LOCATION (SHL)	APPROX. LANDING POINT	BOTTOM HOLE LOCATION (BHL)
UTM 17-NAD83 N:4413726.07 E:526314.63 NAD83, WV NORTH N:502374.93 E:1633873.87	UTM 17-NAD83 N:4414092.72 E:526505.54 NAD83, WV NORTH N:503567.61 E:1634520.55	UTM 17-NAD83 N:4414906.48 E:525852.83 NAD83, WV NORTH N:506273.76 E:1632423.31



- NOTES:
1. There are no water wells or developed springs within 250' of proposed well.
 2. There are no existing buildings within 625' of proposed well.
 3. Proposed well is greater than 100' from perennial stream, wetland, pond, reservoir or lake.
 4. There are no native trout streams within 300' of proposed well.
 5. Proposed well is greater than 1000' from surface/groundwater intake or public water supply.
 6. It is not the purpose or intention of this plat to represent surveyed locations of the surface or mineral parcels depicted hereon. The location of the boundary lines, as shown, are based on record deed descriptions, field evidence found and/or tax map position, unless otherwise noted.

LEGEND

- ⊕ - TOPO MAP POINT
- ☼ - WELL
- - ALL ARE POINTS UNLESS OTHERWISE NOTED.
- ⊙ - WATER SOURCE
- - MINERAL TRACT BOUNDARY
- - - - - PARCEL LINES
- - - - - WELL REFERENCE
- — — — — PROPOSED HORIZONTAL WELL
- — — — — ROAD
- - - - - STREAM CENTER LINE

WELLS WITHIN 3000'

- - EXISTING WELLS
- ⊙ - PLUGGED WELLS



PARCEL	LESSOR
A	BARBARA P. FRANCIS
B	BARBARA P. FRANCIS
C	JOSEPH D. & NELLIE B. PARRIOTT
D	JOSEPH D. & NELLIE B. PARRIOTT

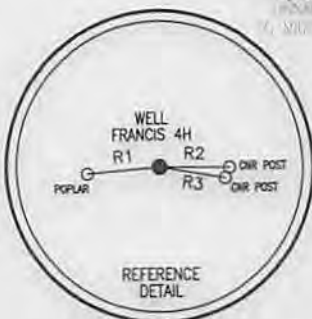

LINE	BEARING	DISTANCE
R1	S 85°21'21" W	152.34'
R2	S 89°14'41" E	145.75'
R3	S 80°04'10" E	138.44'
R4	N 25°43'01" W	2911.42'
R5	N 08°24'20" W	2084.49'
R6	N 47°48'42" E	2523.24'

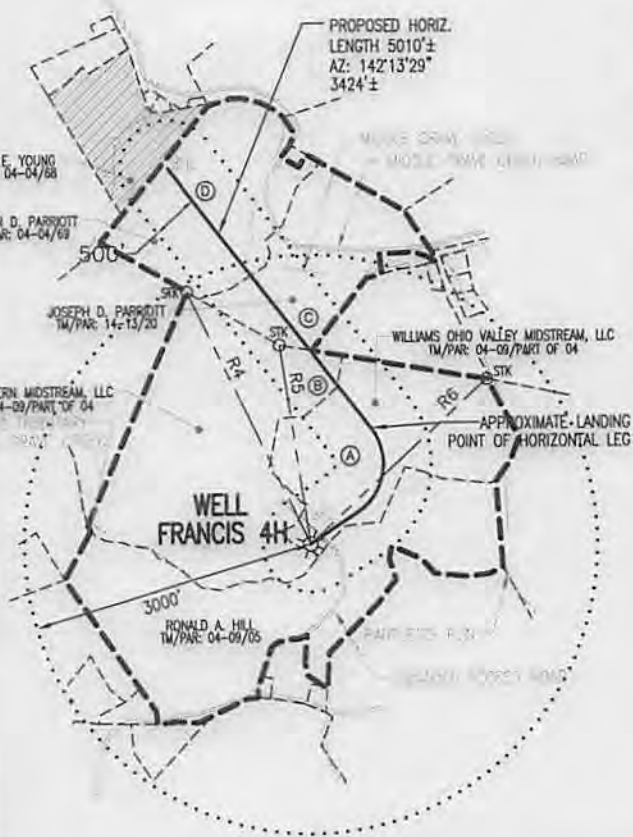

Well is located on topo map 7.191' feet west of Longitude: 80° 40' 00"

Blue Mountain Inc.
11023 MASON DIXON HIGHWAY
BURTON, WV 26562
PHONE: (304) 662-6486

FILE #: FRANCIS 4H
DRAWING #: FRANCIS 4H
SCALE: 1" = 2000'
MINIMUM DEGREE OF ACCURACY: 1/2500
PROVEN SOURCE OF ELEVATION: U.S.G.S. MONUMENT THOMAS 1498.81'

I, THE UNDERSIGNED, HEREBY CERTIFY THAT THIS PLAT IS CORRECT TO THE BEST OF MY KNOWLEDGE AND BELIEF AND SHOWS ALL THE INFORMATION REQUIRED BY LAW AND THE REGULATIONS ISSUED AND PRESCRIBED BY THE DEPARTMENT OF ENVIRONMENTAL PROTECTION.

Signed: *[Signature]*
R.P.E.: _____ L.L.S.: P.S. No. 2000

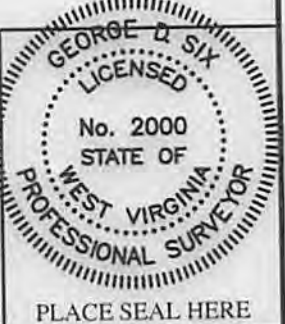

(+) DENOTES LOCATION OF WELL ON UNITED STATES TOPOGRAPHIC MAPS WVDEP
OFFICE OF OIL & GAS
601 57TH STREET
CHARLESTON, WV 25304



DATE: FEBRUARY 3, 2014
OPERATOR'S WELL #: FRANCIS 4H
API WELL #: 47 51 61712 HGA
STATE COUNTY PERMIT

Well Type: Oil Waste Disposal Production Deep
 Gas Liquid Injection Storage Shallow

WATERSHED: MIDDLE GRAVE CREEK ELEVATION: 1260.14'
COUNTY/DISTRICT: MARSHALL / CLAY QUADRANGLE: GLEN EASTON, WV 7.5'
SURFACE OWNER: WILLIAMS OHIO VALLEY MIDSTREAM, LLC ACREAGE: 70.41±
OIL & GAS ROYALTY OWNER: BARBARA P. FRANCIS ACREAGE: 398.065±

DRILL CONVERT DRILL DEEPER REDRILL FRACTURE OR STIMULATE
PLUG OFF OLD FORMATION PERFORATE NEW FORMATION PLUG & ABANDON
CLEAN OUT & REPLUG OTHER CHANGE (SPECIFY): _____

TARGET FORMATION: MARCELLUS ESTIMATED DEPTH: TVD: 6,512'± TMD: 10,788'±
WELL OPERATOR: CHEVRON APPALACHIA, LLC DESIGNATED AGENT: KENNETH E. TAWNEY
Address: 800 MOUNTAIN VIEW DRIVE Address: 500 LEE STREET, EAST SUITE 1600
City: SMITHFIELD State: PA Zip Code: 15478 City: CHARLESTON State: WV Zip Code: 25301-3202

03/21/2014



Copyright © 2013 National Geographi

SITE USGS LOCATION MAP

SCALE: 1" = 500'

MSK
10/2/2013

ju
10/2/13

Office of Oil and Gas
OCT 28 2013



USGS SITE LOCATION MAP
Project Number: 1444-2013
Drawing Date: 10/02/2013
Scale: 1" = 500'
Title: EX-1

FRANCIS WELL SITE
FORK RIDGE ROAD, MARSHALL COUNTY
MOUNDSVILLE, WEST VIRGINIA
PREPARED FOR:
CHEVRON APPALACHIA, LLC
800 MOUNTAIN VIEW DRIVE
SMITHFIELD, PA 15478

Date	No.	REVISION RECORD
-	01	
-	02	
-	03	
-	04	
-	05	
-	06	
-	07	
-	08	

WV Department of Environmental Protection
GATEWAY
Consulting Engineers & Surveyors
400 Holiday Drive, Suite 300 Pittsburgh, PA 15220
Phone (412) 921-4000 • Fax (412) 921-9960
• Belle, PA (724) 287-1000 • Washington, PA (724) 228-1000