

SURFACE HOLE LOCATION
UTM 17-NAD 83 N) 4419292.79 E) 541045.66
NAD 27, WV NORTH N) 519796.20 E) 1713953.76
LANDING POINT LOCATION
UTM 17-NAD 83 N) 4419027.07 E) 540806.90
NAD 27, WV NORTH N) 518937.36 E) 1713155.71
BOTTOM HOLE LOCATION
UTM 17-NAD 83 N) 4417703.84 E) 541766.84
NAD 27, WV NORTH N) 514542.41 E) 1716233.08

REFERENCE NOTES
Boundaries as shown taken from deeds, tax maps and field locations. A full boundary survey is not expressed nor implied. All bearings are based on true north. Ownership taken from public records Ohio County, West Virginia MARCH 2013
State Plane Coordinates & NAD 83 Lat/Long by differential submeter mapping grade GPS
Drafted by: E.A.M.

FILE #: NOB 001
DRAWING #: 2266
SCALE: PLAT - 1"=1600'
TICK MARK - 1"=2000'
MINIMUM DEGREE OF ACCURACY: 1/200
PROVEN SOURCE OF ELEVATION: SUBMETER MAPPING GRADE GPS

I, THE UNDERSIGNED, HEREBY CERTIFY THAT THIS PLAT IS CORRECT TO THE BEST OF MY KNOWLEDGE AND BELIEF AND SHOWS ALL THE INFORMATION REQUIRED BY LAW AND THE REGULATIONS ISSUED AND PRESCRIBED BY THE DEPARTMENT OF ENVIRONMENTAL PROTECTION.

Signed: _____
L.L.S. #2124 : Ernest J. Benchek III

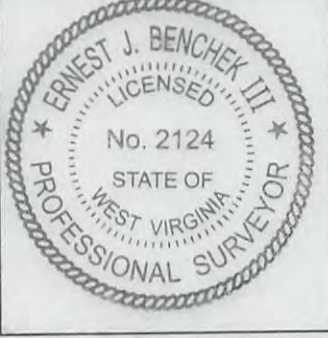

(+) DENOTES LOCATION OF WELL ON UNITED STATES TOPOGRAPHIC MAPS WVDEP
OFFICE OF OIL & GAS
601 57TH STREET
CHARLESTON, WV 25304

Well Type: Oil Waste Diposal Production Deep
 Gas Liquid Injection Storage Shallow

WATERSHED: DUNKARD FORK **HUC 10**
COUNTY/DISTRICT: MARSHALL / WEBSTER
SURFACE OWNER: TIM M. TURLEY AND TAMMY JENKINS
OIL & GAS ROYALTY OWNER: TIM M. TURLEY AND TAMMY JENKINS
LEASE NUMBERS: _____

DATE: AUGUST 21, 2013
OPERATOR'S WELL #: WEB22 KHS
API WELL #: 47 51 **01724H6A**
STATE COUNTY PERMIT

ELEVATION: 1,325'
QUADRANGLE: MAJORSVILLE WV-PA
ACREAGE: 137.42 +/-
ACREAGE: 890.394 +/-

DRILL CONVERT DRILL DEEPER REDRILL FRACTURE OR STIMULATE
PLUG OFF FORMATION PERFORATE NEW FORMATION PLUG & ABANDON
CLEAN OUT & REPLUG OTHER CHANGE (SPECIFY): _____

TARGET FORMATION: MARCELLUS
WELL OPERATOR: NOBLE ENERGY, INC.
ADDRESS: 333 TECHNOLOGY DRIVE SUITE 116
CITY: CANONSBURG **STATE:** PA **ZIP CODE:** 15317

ESTIMATED DEPTH: TVD: 6,913' TMD: 12,942'
DESIGNATED AGENT: STEVEN M. GREEN
ADDRESS: 500 VIRGINIA STREET EAST
CITY: CHARLESTON **STATE:** WV **ZIP CODE:** 25301

01/17/2014

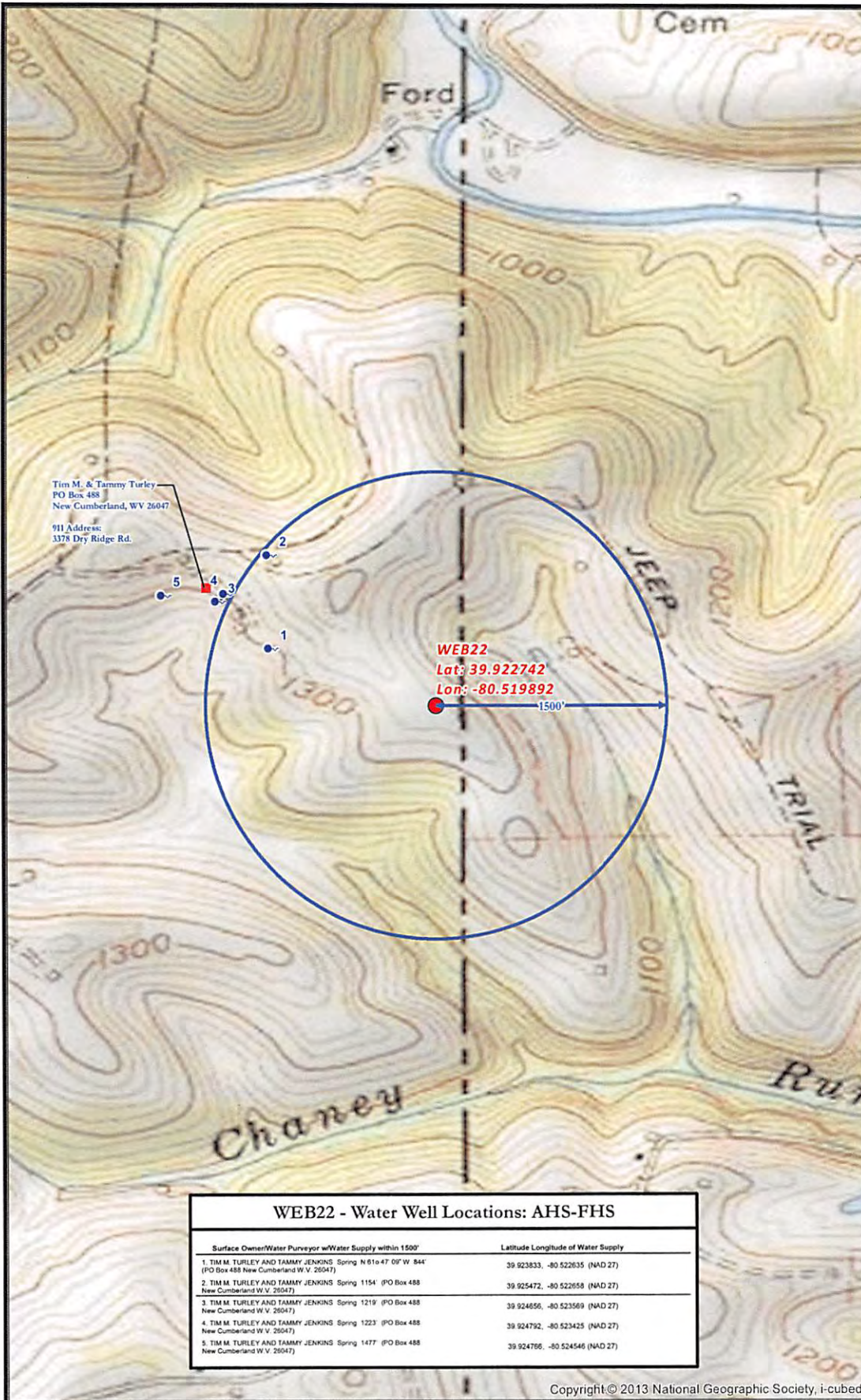

Tim M. & Tammy Turley
 PO Box 488
 New Cumberland, WV 26047
 911 Address:
 3378 Dry Ridge Rd.

WEB22
 Lat: 39.922742
 Lon: -80.519892

Surface Owner/Water Purveyor w/Water Supply within 1500'	Latitude Longitude of Water Supply
1. TIM M. TURLEY AND TAMMY JENKINS Spring N 61o 47' 00" W 844' (PO Box 488 New Cumberland W.V. 26047)	39 923833, -80 522635 (NAD 27)
2. TIM M. TURLEY AND TAMMY JENKINS Spring 1154' (PO Box 488 New Cumberland W.V. 26047)	39 925472, -80 522658 (NAD 27)
3. TIM M. TURLEY AND TAMMY JENKINS Spring 1219' (PO Box 488 New Cumberland W.V. 26047)	39 924856, -80 523569 (NAD 27)
4. TIM M. TURLEY AND TAMMY JENKINS Spring 1223' (PO Box 488 New Cumberland W.V. 26047)	39 924792, -80 523425 (NAD 27)
5. TIM M. TURLEY AND TAMMY JENKINS Spring 1477' (PO Box 488 New Cumberland W.V. 26047)	39 924766, -80 524546 (NAD 27)

Copyright © 2013 National Geographic Society, i-cubed

WEB22 SITE SAFETY PLAN
 - WATER WELLS PROXIMITY -

■ 911 Address
● Spring
● Well Pad
W Water Well

0 375 750 1,500 Feet

Scale 1" = 750'

Projection: NAD_1927_StatePlane_Vest_Virginia_North_FIPS_4301
 Units: Foot US

noble energy

Date: 7/18/2013
 Author: Christopher Glover

Disclaimer: All data is licensed for use by Noble Energy Inc. use only.

6/6