

GENERAL NOTES:

1. THE LOCATION OF BOUNDARY LINES SHOWN HEREON ARE BASED ON RECORD DEED, PLATS, AND TAX MAPS BEST FIT TO FOUND FIELD EVIDENCE AND AERIAL PHOTOS, UNLESS OTHERWISE NOTED.
2. THIS PLAT DOES NOT REPRESENT AN ACTUAL BOUNDARY SURVEY OF THE INDIVIDUAL PARCELS.
3. THERE ARE NO EXISTING WATER WELLS OR DEVELOPED SPRINGS WITHIN 250' OF PROPOSED WELL.
4. PROPOSED WELL IS GREATER THAN 100' FROM PERENNIAL STREAM, WETLAND, POND, RESERVOIR OR LAKE.
5. THERE ARE NO NATIVE TROUT STREAMS WITHIN 300' OF PROPOSED WELL.
6. THERE ARE TWO DWELLINGS LOCATED WITHIN 650' OF PROPOSED WELLBORE, DISTANCE AS SHOWN ABOVE.
7. THE SURROUNDING LANDS ARE BEING SERVED BY PUBLIC WATER BY THE GRAND VIEW DOOLIN WATER SYSTEM PROVIDED BY MARSHALL COUNTY PUBLIC HEALTH AND SANITATION DIVISION.
8. NO PRODUCING DEEP WELLS WITHIN 3,000 FT. OF WELL BORE

LEGEND

- PROPOSED GAS WELL
- PROPOSED BORE TIE LINE
- OIL & GAS LEASE BOUNDARY
- PROPERTY LINE
- STREAM LINE
- BUFFER LINE
- UNIT BOUNDARY
- GAS WELL
- PLUGGED GAS WELL

FILE #: 093842010

DRAWING #: 093842010_SV-Plat

SCALE: PLAT & TICK: 1" = 2,000'

MINIMUM DEGREE OF ACCURACY: 1/2,500

PROVEN SOURCE OF ELEVATION: NGS (CORS)

I, THE UNDERSIGNED, HEREBY CERTIFY THAT THIS PLAT IS CORRECT TO THE BEST OF MY KNOWLEDGE AND BELIEF AND SHOWS ALL THE INFORMATION REQUIRED BY LAW AND THE RULES ISSUED AND PRESCRIBED BY THE DEPARTMENT OF ENVIRONMENTAL PROTECTION.

SIGNED: [Signature]

R.P.R.: _____ L.L.S.: 2241



(+) DENOTES LOCATION OF WELL ON UNITED STATES TOPOGRAPHIC MAPS

WVDEP
OFFICE OF OIL & GAS
601 57TH STREET
CHARLESTON, WV 25304

WELL TYPE: OIL GAS WASTE DISPOSAL LIQUID INJECTION PRODUCTION STORAGE DEEP SHALLOW

WATERSHED: FISH CREEK

COUNTY/DISTRICT: MARSHALL / FRANKLIN

SURFACE OWNER: CONSOLIDATION COAL COMPANY

OIL & GAS ROYALTY OWNER: CNX GAS COMPANY LLC and NOBLE ENERGY, INC.

CONVERT DRILL DEEPER REDRILL FRACTURE OR STIMULATE PERFORATE NEW FORMATION PLUG & ABANDON

DRILL PLUG OFF OLD FORMATION CLEAN OUT & REPLUG OTHER CHANGE (SPECIFY): _____

TARGET FORMATION: UTICA and POINT PLEASANT

ESTIMATED DEPTH: TVD: 10,412±ft. TMD: 20,115±ft.

WELL OPERATOR: NOBLE ENERGY, INC.

DESIGNATED AGENT: STEVE M. GREEN

ADDRESS: 333 TECHNOLOGY DRIVE, SUITE 116

ADDRESS: 500 VIRGINIA STREET EAST, UNITED CENTER SUITE 500

CITY: CANONSBURG STATE: PA ZIP CODE: 15317

CITY: CHARLESTON STATE: WV ZIP CODE: 25301

DATE: NOVEMBER 05, 2014

OPERATOR'S WELL #: MND 06 HHS

API WELL #: 47 051 01732

STATE COUNTY PERMIT

ELEVATION: 719.9'-DESIGN (NAVD 88)

QUADRANGLE: POWHATAN POINT, OHIO-W.VA

ACREAGE: 136.587±

ACREAGE: 136.587±

H6A M6D2

11/21/2014

WELL: MND 06 HHS
QUAD: POWHATAN POINT, OHIO-W.VA.

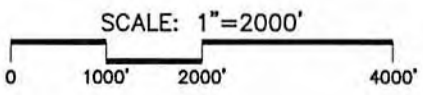
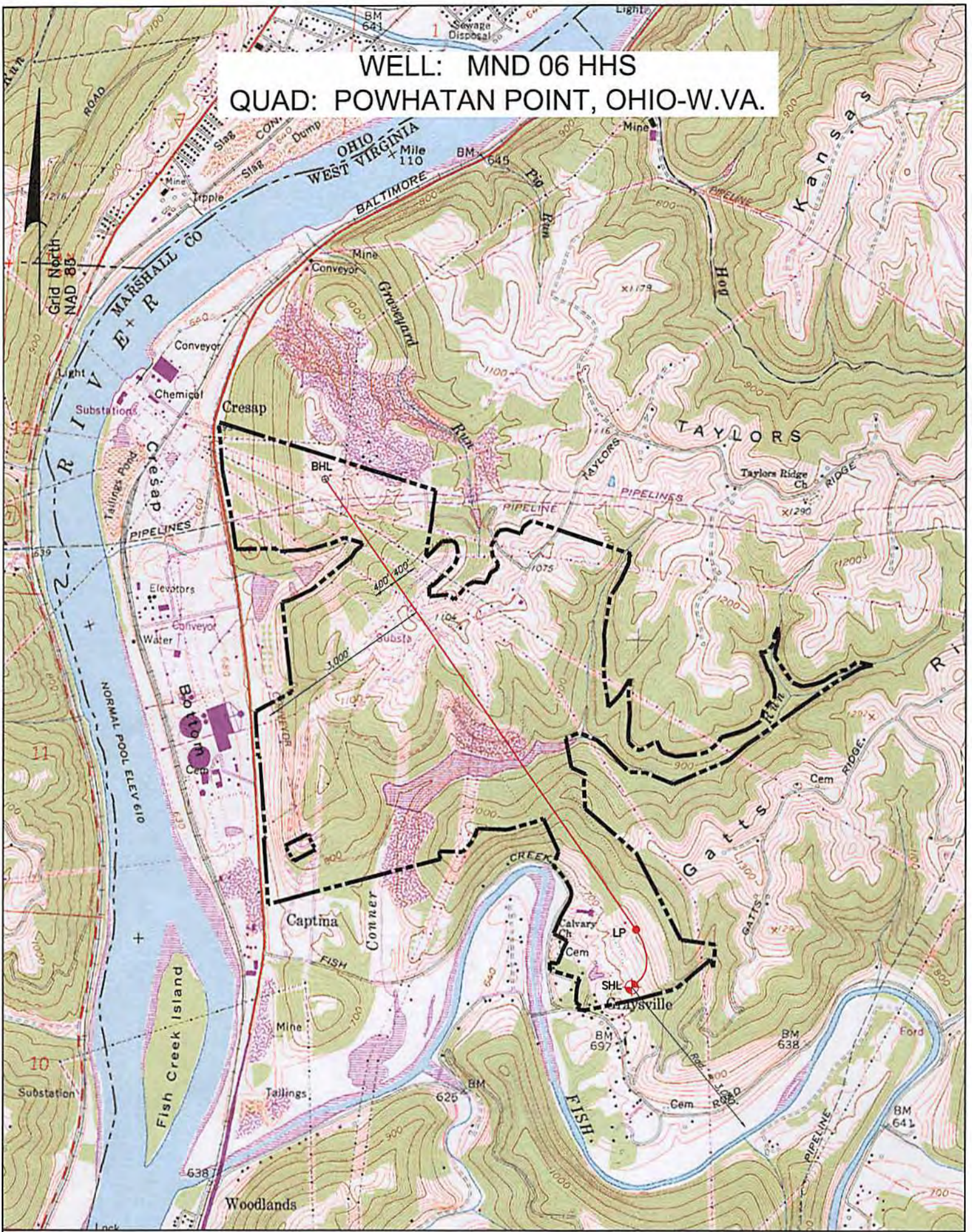

GENERAL NOTE:
 THE PURPOSE OF THIS PLAT IS FOR THE LOCATION OF PROPOSED GAS WELLS AND DOES NOT REPRESENT A CLOSED BOUNDARY SURVEY. PROPERTY LINES AND OWNERS WERE OBTAINED FROM VARIOUS FIELD EVIDENCE, TAX RECORDS AND AERIAL MAPPING.

LEGEND

- PROPOSED GAS WELL
- PROPOSED BOTTOM HOLE
- PROPOSED BORE
- EXTERNAL LEASE LINE

SURFACE LOCATION (SHL)	LANDING POINT (LP)	BOTTOM HOLE LOCATION (BHL)
(NAD 83) N) 482,544.4' E) 1,605,726.0' LAT.) 39°49'03.6" LONG.) 80°47'29.6" DEC. LAT.) 39.817669° DEC. LONG.) 80.791553°	(NAD 83) N) 483,495.7' E) 1,605,794.4' LAT.) 39°49'13.0" LONG.) 80°47'28.9" DEC. LAT.) 39.820283° DEC. LONG.) 80.791358°	(NAD 83) N) 490,940.6' E) 1,600,581.4' LAT.) 39°50'25.8" LONG.) 80°48'37.1" DEC. LAT.) 39.840512° DEC. LONG.) 80.810302°
(NAD 27) N) 482,508.3' E) 1,637,163.3' LAT.) 39°49'03.3" LONG.) 80°47'30.3" DEC. LAT.) 39.817593° DEC. LONG.) 80.791741°	(NAD 27) N) 483,445.96' E) 1,637,231.8' LAT.) 39°49'12.7" LONG.) 80°47'29.6" DEC. LAT.) 39.820207° DEC. LONG.) 80.791546°	(NAD 27) N) 490,904.6' E) 1,632,018.8' LAT.) 39°50'25.6" LONG.) 80°48'37.8" DEC. LAT.) 39.840437° DEC. LONG.) 80.810490°
(UTM NAD 83) N) 4,407,541.33m E) 517,840.20m	(UTM NAD 83) N) 4,407,831.48m E) 517,856.22m	(UTM NAD 83) N) 4,410,073.08m E) 516,230.16m

Applicant / Well Operator Name NOBLE ENERGY, INC.	Well(Farm) Name MND06	Well # HHS	Serial #
Address 333 TECHNOLOGY DRIVE, SUITE 116, CANONSBURG, PA 15317	County - Code MARSHALL - 051	District FRANKLIN	
Surface Landowner / Lessor CONSOLIDATION COAL COMPANY	USGS 7 1/2 Quadrangle Map Name POWHATAN POINT, OHIO-W.VA	Scale: 1" = 2,000'	11/21/2014