

Well is located on topo map 1,133 feet south of Latitude: 39° 55' 00"

AS DRILLED PLAT

SEE PAGE 2 FOR SURFACE OWNERS

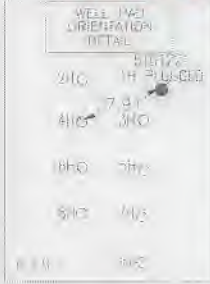

BOTTOM HOLE LOCATION (BHL)
 UTM 17-NAD83
 N:4420092.48
 E:527900.80
 NAD83, WV NORTH
 N:523179.28
 E:1639427.61

AS DRILLED BOTTOM HOLE LOCATION (BHL)
 UTM 17-NAD83(M)
 N:4420096.55
 E:527905.44
 NAD83, WV NORTH
 N:523192.37
 E:1639443.72

PARCEL	LESSOR
A	JOHN J. & RENEE HART
B	CARL W. & BRIDGETT L. YOHO
C	DONN R. & LOIS W. DOWLER
D	DONN R. & LOIS W. DOWLER
E	DONN R. & LOIS W. DOWLER
F	DONN R. & LOIS W. DOWLER
G	DONN R. & LOIS W. DOWLER
H*	CARL W. & BRIDGETT L. YOHO

LINE	BEARING	DISTANCE
1	N 74°52'06" E	22.22'
2	S 70°28'12" E	21.16'
3	S 41°04'05" E	194.59'
4	S 58°58'03" W	145.22'
5	S 15°17" W	1640.74'
6	E 41°44'20" E	2068.91'

03/29/2019

- NOTES:
- There are no water wells or developed springs within 250' of proposed well.
 - Proposed well is greater than 100' from perennial stream, wetland, pond, reservoir or lake.
 - There are no native trout streams within 300' of proposed well.
 - Proposed well is greater than 1000' from surface/groundwater intake or public water supply.
 - It is not the purpose or intention of this plat to represent surveyed locations of the surface or mineral parcels depicted hereon. The location of the boundary lines, as shown, are based on record deed descriptions, field evidence found and/or tax map position, unless otherwise noted.

LEGEND

- TOPO MAP POINT
- WELL
- ALL ARE POINTS UNLESS OTHERWISE NOTED.
- MINERAL TRACT BOUNDARY
- PARCEL LINES
- WELL REFERENCE
- AS-DRILLED LATERAL
- PROPOSED HORIZONTAL WELL
- ROAD
- STREAM CENTER LINE
- LESSORS
- SURFACE OWNERS
- GAS WELLS**
 - EXISTING WELLS
 - PLUGGED WELLS

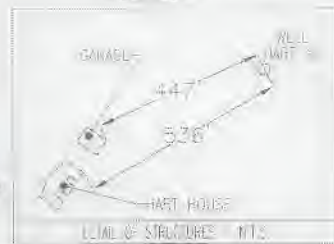

Blue Mountain Inc.
 11023 MASON DIXON HIGHWAY
 BURTON, WV 26562
 PHONE: (304) 662-6486

I, THE UNDERSIGNED, HEREBY CERTIFY THAT THIS PLAT IS CORRECT TO THE BEST OF MY KNOWLEDGE AND BELIEF AND SHOWS ALL THE INFORMATION REQUIRED BY LAW AND THE REGULATIONS ISSUED AND PRESCRIBED BY THE DEPARTMENT OF ENVIRONMENTAL PROTECTION.

Signed: *[Signature]*

R.P.E.: _____ L.L.S.: P.S. No. 2000

GEORGE D. SIX
 LICENSED
 No. 2000
 STATE OF
 WEST VIRGINIA
 PROFESSIONAL SURVEYOR

PLACE SEAL HERE

FILE #: HART 4H AS-DRILLED

DRAWING #: HART 4H AS-DRILLED

SCALE: 1" = 2000'

MINIMUM DEGREE OF ACCURACY: 1/2500

PROVEN SOURCE OF ELEVATION: U.S.G.S. MONUMENT THOMAS 1498.81'

(+) DENOTES LOCATION OF WELL ON UNITED STATES TOPOGRAPHIC MAPS WVDEP

OFFICE OF OIL & GAS
 601 57TH STREET
 CHARLESTON, WV 25304

DATE: APRIL 28, 2016

OPERATOR'S WELL #: HART 4H AS-DRILLED

API WELL #: 47 51 01750
 STATE COUNTY PERMIT

WELL TYPE: Oil Waste Disposal Production Deep
 Gas Liquid Injection Storage Shallow

WATERSHED: MIDDLE GRAVE CREEK - GRAVE CREEK ELEVATION: 1329.17'

COUNTY/DISTRICT: MARSHALL / WASHINGTON QUADRANGLE: MOUNDSVILLE, WV 7.5'

SURFACE OWNER: JOHN J. & RENEE HART ACREAGE: 108.550±

OIL & GAS ROYALTY OWNER: JOHN J. & RENEE HART ACREAGE: 490.687±

DRILL CONVERT DRILL DEEPER REDRILL FRACTURE OR STIMULATE
 PLUG OFF OLD FORMATION PERFORATE NEW FORMATION PLUG & ABANDON
 CLEAN OUT & REPLUG OTHER CHANGE (SPECIFY): _____

TARGET FORMATION: MARCELLUS ESTIMATED DEPTH: TVD: 6,584.80'± TMD: 14,318'±

WELL OPERATOR CHEVRON APPALACHIA, LLC DESIGNATED AGENT KENNETH E. TAWNEY

Address 800 MOUNTAIN VIEW DRIVE Address 500 LEE STREET, EAST SUITE 1600

City SMITHFIELD State PA Zip Code 15478 City CHARLESTON State WV Zip Code 25301-3202

HART 4H

03/29/2019

	SURFACE OWNER	DIST-TM/PAR
1	WILLIAM H. III & LINDA BARDALL	14-7/41
2	MARSHALL COUNTY 4-H LEADERS	14-7/40
3	JOHN R. REGAN & CONNIE L. THOMAS	14-6/1
4	JOHN W. & MARY A. MILLER	14-6/41
5	JEFFREY L. & JANET L. ALLEN	14-6/40
6	JOHN R. REGAN & CONNIE THOMAS	14-6/2
7	JEFFREY L. & JANET L. ALLEN	14-6/38
8	JEFFREY L. & JANET L. ALLEN	14-6/39
9	DANIEL R. WOOD - SHAWN ALLMAN	14-6/2.1
10	JOHN R. REGAN & CONNIE L. THOMAS	14-6/3
11	ROBERT R. & KATHY D. BROWN	14-6/3.4
12	JOHN R. REGAN & CONNIE L. THOMAS	14-6/3.3
13	BERRIDGE L. ALLEN ET UX	14-6/38.3
14	BERRIDGE L. ALLEN ET UX	14-6/38.1
15	BERRIDGE L. ALLEN ET UX	14-6/38.2
16	JEFFREY L. & JANET L. ALLEN	14-6/37
17	MARC A. MOLOSKI ET UX	14-6/3.1
18	MARC MOLOSKI	14-6/34.4
19	MARY LOU RUBINI	14-6/41.1
20	DENNIS BLAKE ET UX	14-10/10
21	CARL W. & BRIDGETT L. YOHO	14-6/35
22	GARY V. SINGER ET UX	14-6/34.7
23	GARY V. SINGER ET UX	14-6/34.9
24	BONNIE L. & GARY V. SINGER	14-6/34.8
25	GARY A. STROPE	14-6/34.10
26	JAMES D. & DONNA J. DRAKE	14-6/34
27	JENNIFER B. READ	14-6/34.5
28	JOHN J. II & JENNA E. HART	14-10/11
29	DENNIS & MICHELLE S. BLAKE	14-10/11.3
30	JAMES E. BLAKE	14-10/11.1
31	JOHN J. HART ET UX	14-6/36
32	CARL W. YOHO ET AL	14-6/35.1
33	CARL W. & BRIDGETT L. YOHO	14-6/28
34	JERRY S. WHORTON ET UX	14-6/29.1
35	RODNEY J. & CARRIE L. FONNER	14-6/29
36	MARTIN D. FONNER JR. ET UX	14-6/29.2
37	CARL W. & BRIDGETT L. YOHO	14-6/28.1
38	JAMES E. CURRY	14-10/13
39	JOHN J. HART ET UX	14-10/14
40	JOHN J. & RENEE HART	14-10/19.1
41	JEFFREY D. & DENISE A. CRAMER	14-6/27
42	JEFFREY D. & DENISE A. CRAMER	14-10/20
43	JAMES E. CURRY	14-10/15
44	JOHN J. & RENEE HART	14-10/19
45	JOHN J. HART ET UX	14-10/18
46	HEIKKI & TRISHA YEAGER	15-15/8.6
47	JOHN A. BIERCE II ET UX	15-15/3

SURFACE HOLE LOCATION (SHL)
UTM 17-NAD83
N:4418221.51
E:529491.96
NAD83_WW NORTH
N:516952.37
E:1644547.00

AS DRILLED
SURFACE HOLE LOCATION (SHL)
UTM 17-NAD83(M)
N:4418221.51
E:529491.96
NAD83_WW NORTH
N:516952.37
E:1644547.00

APPROX. LANDING POINT
UTM 17-NAD83
N:4418299.57
E:529503.87
NAD83_WW NORTH
N:517207.87
E:1644590.37

AS DRILLED
APPROX. LANDING POINT
UTM 17-NAD83(M)
N:4418438.75
E:529381.82
NAD83_WW NORTH
N:517671.30
E:1644197.50

BOTTOM HOLE LOCATION (BHL)
UTM 17-NAD83
N:4420092.48
E:527900.60
NAD83_WW NORTH
N:523179.28
E:1639427.61

AS DRILLED
BOTTOM HOLE LOCATION (BHL)
UTM 17-NAD83(M)
N:4420096.55
E:527905.44
NAD83_WW NORTH
N:523192.37
E:1639443.72

APRIL 28, 2016