

# AS DRILLED PLAT

BHL is located on topo map 14,520 feet south of Latitude: 39° 55' 00"  
 SHL is located on topo map 6,599 feet south of Latitude: 39° 52' 30"

**PERMITTED**  
**BOTTOM HOLE LOCATION (BHL)**  
 UTM 17-NAD83(M)  
 N:4414117.69  
 E:524780.96  
 NAD 83, WV NORTH  
 N:503744.14  
 E:1528862.73  
 LAT/LON DATUM-NAD83  
 LAT:39.876747  
 LON:-80.710208

**AS-DRILLED**  
**BOTTOM HOLE LOCATION (BHL)**  
 UTM 17-NAD83(M)  
 N:4414124.26  
 E:524785.91  
 NAD 83, WV NORTH  
 N:503765.26  
 E:1528889.15  
 LAT/LON DATUM-NAD83  
 LAT:39.876806  
 LON:-80.710117

**LEGEND**

- TOPO MAP POINT
- WELL
- ALL ARE POINTS UNLESS OTHERWISE NOTED.
- MINERAL TRACT BOUNDARY
- PARCEL LINES
- WELL REFERENCE
- PROPOSED HORIZONTAL WELL
- ROAD
- STREAM CENTER LINE
- LESSORS
- SURFACE OWNERS

**GAS WELLS**

- EXISTING WELLS
- PLUGGED WELLS

**Blue Mountain Inc.**  
 11023 MASON DIXON HIGHWAY  
 BURTON, WV 26562  
 PHONE: (304) 662-6486

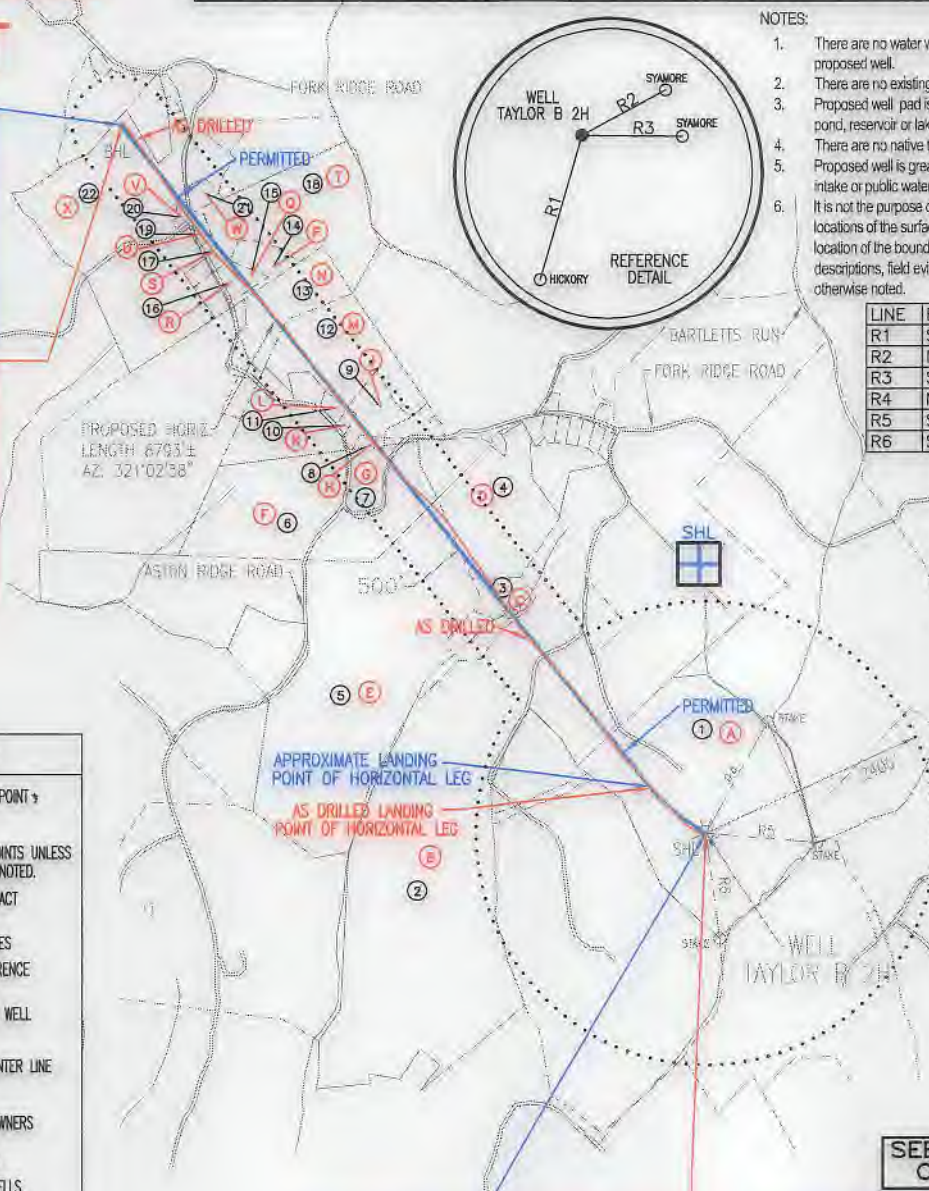

LINE	BEARING	DISTANCE
R1	S 16°11'27" W	258.87'
R2	N 61°56'22" E	165.39'
R3	S 89°27'09" E	174.99'
R4	N 29°35'41" E	1317.61'
R5	S 85°18'52" E	1166.36'
R6	S 07°26'41" E	1095.83'

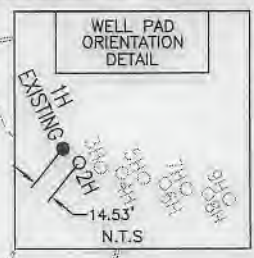

SEE PAGE 2 FOR SURFACE OWNERS AND LESSORS

**PERMITTED**  
**SURFACE HOLE LOCATION (SHL)**  
 UTM 17-NAD83(M)  
 N:4411919.48  
 E:526680.74  
 NAD 83, WV NORTH  
 N:496426.52  
 E:1634976.25  
 LAT/LON DATUM-NAD83  
 LAT:39.856883  
 LON:-80.688083

**AS-DRILLED**  
**SURFACE HOLE LOCATION (SHL)**  
 UTM 17-NAD83(M)  
 N:4411919.48  
 E:526680.74  
 NAD 83, WV NORTH  
 N:496426.52  
 E:1634976.25  
 LAT/LON DATUM-NAD83  
 LAT:39.856883  
 LON:-80.688083

**PERMITTED**  
**APPROX. LANDING POINT**  
 UTM 17-NAD83(M)  
 N:4412062.45  
 E:526499.90  
 NAD 83, WV NORTH  
 N:496905.60  
 E:1634390.69  
 LAT/LON DATUM-NAD83  
 LAT:39.858178  
 LON:-80.690192

**AS-DRILLED**  
**APPROX. LANDING POINT**  
 UTM 17-NAD83(M)  
 N:4412058.75  
 E:526508.71  
 NAD 83, WV NORTH  
 N:496892.97  
 E:1634419.38  
 LAT/LON DATUM-NAD83  
 LAT:39.858144  
 LON:-80.690089

BHL is located on topo map 500 feet west of Longitude: 80° 42' 30"  
 SHL is located on topo map 6,012 feet west of Longitude: 80° 40' 00"

FILE #: TAYLOR B 2H - AS-DRILLED  
 DRAWING #: TAYLOR B 2H - AS-DRILLED  
 SCALE: 1" = 2000'  
 MINIMUM DEGREE OF ACCURACY: 1/2500  
 PROVEN SOURCE OF ELEVATION: U.S.G.S. MONUMENT THOMAS 1498.81'

I, THE UNDERSIGNED, HEREBY CERTIFY THAT THIS PLAT IS CORRECT TO THE BEST OF MY KNOWLEDGE AND BELIEF AND SHOWS ALL THE INFORMATION REQUIRED BY LAW AND THE REGULATIONS ISSUED AND PRESCRIBED BY THE DEPARTMENT OF ENVIRONMENTAL PROTECTION.

Signed: *George D. Six*  
 R.P.E.: \_\_\_\_\_ L.L.S.: P.S. No. 2000



(+) DENOTES LOCATION OF WELL ON UNITED STATES TOPOGRAPHIC MAPS WVDEP  
 OFFICE OF OIL & GAS  
 601 57TH STREET  
 CHARLESTON, WV 25304

WELL Type:  Oil  Waste Disposal  Production  Deep  Gas  Liquid Injection  Storage  Shallow

WATERSHED: MIDDLE GRAVE CREEK-GRAVE CREEK ELEVATION: 1222.00'

COUNTY/DISTRICT: MARSHALL / CLAY QUADRANGLE: GLEN EASTON, WV 7.5'

SURFACE OWNER: WILLIAMS OHIO VALLEY MIDSTREAM LLC ACREAGE: 91.93±

OIL & GAS ROYALTY OWNER: LEE R. & SHERRI L. TAYLOR ACREAGE: 723.983±

DRILL  CONVERT  DRILL DEEPER  REDRILL  FRACTURE OR STIMULATE  PLUG OFF OLD FORMATION

PERFORATE NEW FORMATION  PLUG & ABANDON  CLEAN OUT & REPLUG  OTHER CHANGE

(SPECIFY): AS-DRILLED PLAT

TARGET FORMATION: MARCELLUS ESTIMATED DEPTH: TVD: 6,533'± TMD: 15,752.95'±

WELL OPERATOR: CHEVRON APPALACHIA, LLC DESIGNATED AGENT: KENNETH E. TAWNEY  
 Address: 700 CHERRINGTON PARKWAY Address: 500 LEE STREET, EAST SUITE 1600  
 City: CORAOPOLIS State: PA Zip Code: 15108 City: CHARLESTON State: WV Zip Code: 25301-3202

DATE: MARCH 12, 2018  
 OPERATOR'S WELL #: TAYLOR B 2H - AS-DRILLED  
 API WELL #: 47 51 01793  
 STATE COUNTY PERMIT

# AS DRILLED PLAT

# TAYLOR B 2H PAGE 2 OF 2

04/05/2019

	SURFACE OWNER	DIST-TM/PAR
1	WILLIAMS OHIO VALLEY MIDSTREAM LLC	4-10/20
2	WILLIAMS OHIO VALLEY MIDSTREAM LLC	4-10/21
3	WILLIAM ROGER STANDIFORD ET UX	4-9/23.8
4	WILLIAM R. STANDIFORD ET UX	4-9/23.3
5	LEWIS A. ASTON, JR. ET UX	4-10/6
6	LEWIS A. ASTON, JR. ET UX	4-9/13
7	WILLIAM R. & LINDA L. STANDIFORD	4-9/14
8	WILLIAM R. & LINDA L. STANDIFORD	4-9/15
9	HARLEY L. GATTS II ET UX	4-9/7.3
10	HARLEY L. GATTS ET UX	4-9/7.1
11	*HARLEY L. II & PATRICIA GATTS	4-9/7.4
12	HARLEY L. II & PATRICIA L. GATTS	4-9/7
13	JAMES R. BUCHANAN JR.	4-9/8
14	CAROL LYNN MINOR ET VIR	4-9/2.6
15	JAMES L. KOONCE ET AL	4-9/2.14
16	MARTHA J. & JAMES KOONCE ET AL	4-9/2.10
17	ROGER W. & JODY L. LOSH	4-9/2.11
18	GUERRY J. & SUZANNE K. SCHUMAN	4-9/2.15
19	ROGER W. & JODY L. LOSH	4-9/2.13
20	JEFFREY LOWELL RYAN	4-9/2.16
21	GUERRY J. & SUZANNE K. SCHUMAN	4-9/2.9
22	JEFFREY L. RYAN	4-9/2.5

	LESSOR
A	LEE R. & SHERRI L. TAYLOR
B	LEE R. & SHERRI L. TAYLOR
C	WILLIAM ROGER STANDIFORD
D	WILLIAM ROGER STANDIFORD
E	LEWIS A. JR. & CATHY ASTON
F	LEWIS A. JR. & CATHY ASTON
G	WILLIAM ROGER STANDIFORD
H	WILLIAM ROGER STANDIFORD, ET AL
J	HARLEY L. GATTS, ET AL
K	HARLEY L. GATTS, ET AL
L	*HARLEY L. GATTS, ET AL
M	HARLEY L. GATTS, ET AL
N	JAMES R. BUCHANAN JR.
P	RANDY L. & CAROL L. MINOR
Q	JAMES L. & MARTHA J. KOONCE
R	JAMES L. & MARTHA J. KOONCE
S	ROGER W. & JODY L. LOSH
T	GUERRY J. & SUZANNE K. SCHUMAN
U	ROGER W. & JODY L. LOSH
V	JEFFREY L. RYAN
W	GUERRY J. & SUZANNE K. SCHUMAN
X	JEFFREY L. RYAN

\* - DENOTES PARCEL WITHIN 30 FEET OF PLANNED WELL BORE

PERMITTED SURFACE HOLE LOCATION (SHL)
UTM 17-NAD83(M)
N:4411919.48
E:526680.74
NAD 83, WV NORTH
N:496426.52
E:1634976.25
LAT/LON DATUM-NAD83
LAT:39.856883
LON:-80.688083

PERMITTED APPROX. LANDING POINT
UTM 17-NAD83(M)
N:4412062.45
E:526499.90
NAD 83, WV NORTH
N:496905.60
E:1634390.69
LAT/LON DATUM-NAD83
LAT:39.858178
LON:-80.690192

PERMITTED BOTTOM HOLE LOCATION (BHL)
UTM 17-NAD83(M)
N:4414117.69
E:524780.96
NAD 83, WV NORTH
N:503744.14
E:1628862.73
LAT/LON DATUM-NAD83
LAT:39.876747
LON:-80.710208

AS-DRILLED SURFACE HOLE LOCATION (SHL)
UTM 17-NAD83(M)
N:4411919.48
E:526680.74
NAD 83, WV NORTH
N:496426.52
E:1634976.25
LAT/LON DATUM-NAD83
LAT:39.856883
LON:-80.688083

AS-DRILLED APPROX. LANDING POINT
UTM 17-NAD83(M)
N:4412058.75
E:526508.71
NAD 83, WV NORTH
N:496892.97
E:1634419.38
LAT/LON DATUM-NAD83
LAT:39.858144
LON:-80.690089

AS-DRILLED BOTTOM HOLE LOCATION (BHL)
UTM 17-NAD83(M)
N:4414124.26
E:524788.91
NAD 83, WV NORTH
N:503765.26
E:1628889.16
LAT/LON DATUM-NAD83
LAT:39.876808
LON:-80.710117