



---

west virginia department of environmental protection

---

Office of Oil and Gas  
601 57<sup>th</sup> Street, S.E.  
Charleston, WV 25304  
(304) 926-0450  
fax: (304) 926-0452

Jim Justice, Governor  
Austin Caperton, Cabinet Secretary  
[www.dep.wv.gov](http://www.dep.wv.gov)

Friday, May 19, 2017  
NOTICE OF PERMIT CANCELLATION  
Horizontal 6A / Horizontal 6A Well - 1

NOBLE ENERGY, INC. (A)  
1000 NOBLE ENEGY DRIVE

CANONSBURG, PA 15317

Re: Permit cancellation for SHL 27 EHS  
47-051-01822-00-00

The FINAL INSPECTION REPORT for the CANCELLED PERMIT, issued for U.S. Well Number 47-051-01822-00-00, has been received by the Office of Oil and Gas. The permit has been cancelled as of 1/14/2015.

If there are any questions, please feel free to contact me at (304) 926- 0450.

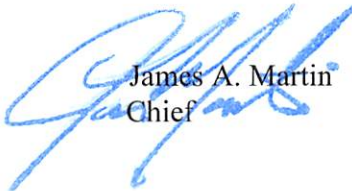

James A. Martin  
Chief

Operator's Well Number: SHL 27 EHS  
Farm Name: WARD, STEVE & ED  
U.S. WELL NUMBER: 47-051-01822-00-00  
Horizontal 6A / Horizontal 6A Well - 1  
Date Cancelled: 1/14/2015

Promoting a healthy environment.

05/19/2017

Well is located on topo map 15.131 feet south of Latitude: 40° 00' 00"

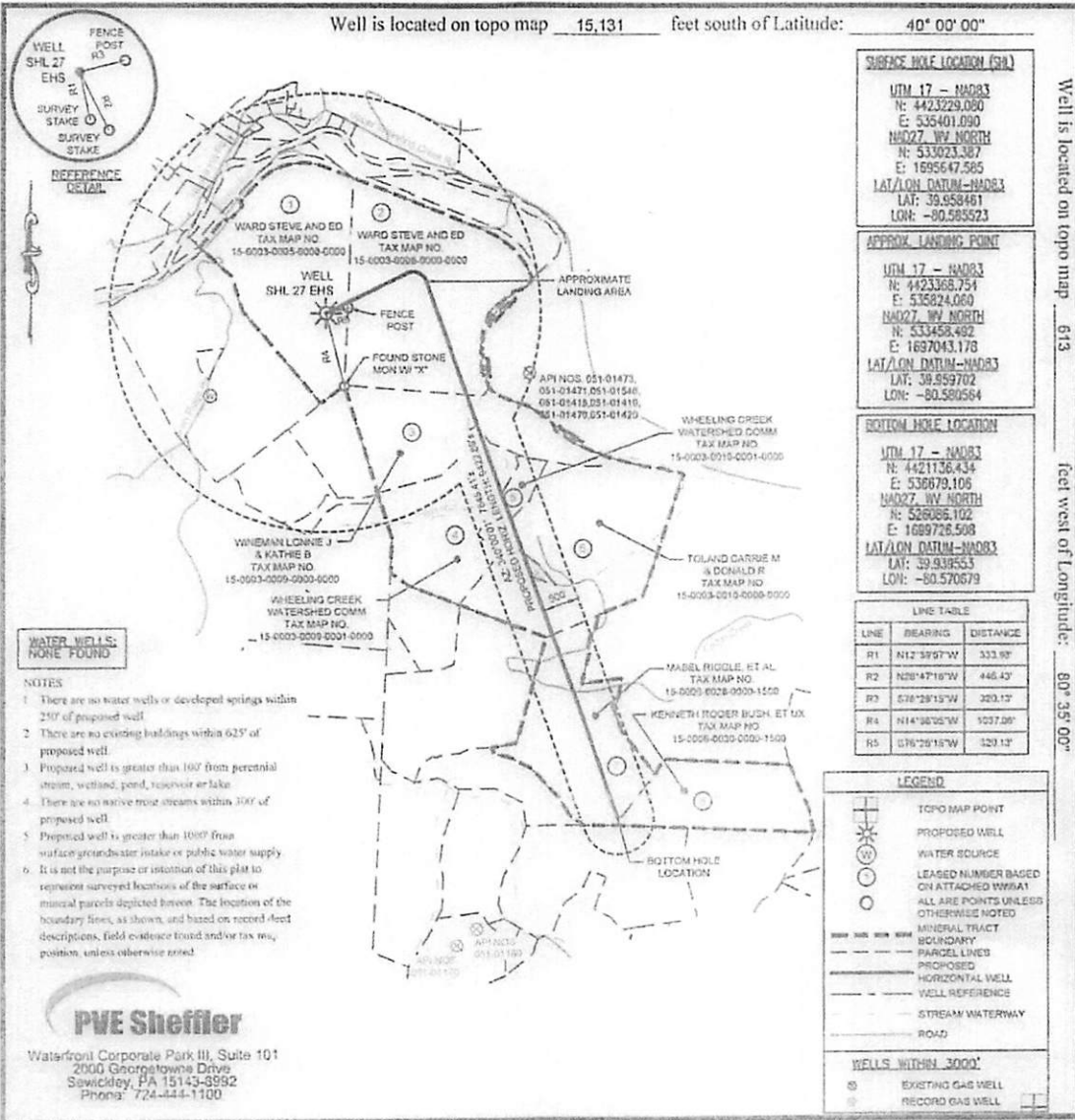

WATER WELLS:  
NONE FOUND

- NOTES
1. There are no water wells or developed springs within 250' of proposed well.
  2. There are no existing buildings within 625' of proposed well.
  3. Proposed well is greater than 100' from perennial stream, wetland, pond, reservoir or lake.
  4. There are no native trout streams within 300' of proposed well.
  5. Proposed well is greater than 100' from surface groundwater intake or public water supply.
  6. It is not the purpose or intention of this plat to represent surveyed locations of the surface or mineral parcels depicted herein. The location of the boundary lines, as shown, and based on record deed descriptions, field evidence found and/or tax map position, unless otherwise noted.

**PVE Sheffler**  
Waterfront Corporate Park III, Suite 101  
2000 Georgetown Drive  
Sawickley, PA 15143-8992  
Phone: 724-444-1100

**SURFACE HOLE LOCATION (SHL)**  
UTM 17 - NAD83  
N: 4423229.080  
E: 535401.090  
NAD27 WV NORTH  
N: 533023.387  
E: 1695647.585  
LAT/LON DATUM=NAD83  
LAT: 39.958461  
LON: -80.585523

**APPROX. LANDING POINT**  
UTM 17 - NAD83  
N: 4423368.754  
E: 535824.060  
NAD27 WV NORTH  
N: 533458.482  
E: 1697043.178  
LAT/LON DATUM=NAD83  
LAT: 39.959702  
LON: -80.580564

**BOTTOM HOLE LOCATION**  
UTM 17 - NAD83  
N: 4421136.434  
E: 536679.106  
NAD27 WV NORTH  
N: 526086.102  
E: 1689726.508  
LAT/LON DATUM=NAD83  
LAT: 39.939553  
LON: -80.570679

LINE TABLE

LINE	BEARING	DISTANCE
R1	N12°39'57"W	333.95'
R2	N28°47'16"W	446.43'
R3	S78°29'15"W	329.13'
R4	N14°30'25"W	1037.00'
R5	S76°20'16"W	329.13'

- LEGEND**
- TOPO MAP POINT
  - PROPOSED WELL
  - WATER SOURCE
  - LEASED NUMBER BASED ON ATTACHED WRAY
  - ALL ARE POINTS UNLESS OTHERWISE NOTED
  - MINERAL TRACT BOUNDARY
  - PARCEL LINES
  - PROPOSED
  - HORIZONTAL WELL
  - WELL REFERENCES
  - STREAM WATERWAY
  - ROAD

**WELLS WITHIN 3000'**

- EXISTING GAS WELL
- RECORD GAS WELL

Well is located on topo map 613 feet west of Longitude: 80° 35' 00"

FILE # SHL 27 EHS  
DRAWING # SHL 27 EHS  
SCALE: 1"=2000'  
MINIMUM DEGREE OF ACCURACY: 1/2500  
PROVEN SOURCE OF ELEVATION: USGS MONUMENT U 124: 951.16'

I, THE UNDERSIGNED, HEREBY CERTIFY THAT THIS PLAT IS CORRECT TO THE BEST OF MY KNOWLEDGE AND BELIEF AND SHOWS ALL THE INFORMATION REQUIRED BY LAW AND THE REGULATIONS ISSUED AND PRESCRIBED BY THE DEPARTMENT OF ENVIRONMENTAL PROTECTION.

SIGNED: *Charles Douglas Davidson*  
R.P.E.: \_\_\_\_\_ L.L.S.: P.S. NO. 819



(+) DENOTES LOCATION OF WELL ON UNITED STATES TOPOGRAPHIC MAPS WVDEP OFFICE OF OIL & GAS 601 57TH STREET CHARLESTON, WV 25304



DATE: OCTOBER 16, 2014 - REV. JANUARY 6, 2015  
OPERATOR'S WELL #: SHL 27 EHS  
API WELL # 47 051 01822 H04  
STATE COUNTY PERMIT

Well Type:  Oil  Waste Disposal  Production  Deep  Gas  Liquid Injection  Storage  Shallow

WATERSHED: WHEELING CREEK ELEVATION: 1,158.6'  
COUNTY/DISTRICT: MARSHALL / WEBSTER QUADRANGLE: MAJORSVILLE W VA  
SURFACE OWNER: STEVE WARD AND ED WARD ACREAGE: 122.47  
OIL & GAS ROYALTY OWNER: BOUNTY MINERALS, LLC ACREAGE: 122.47

DRILL  CONVERT  DRILL DEEPER  REDRILL  FRACTURE OR STIMULATE   
PLUG OFF OLD FORMATION  PERFORATE NEW FORMATION  PLUG AND ABANDON   
C/FAN OUT & RRPLUG  OTHER CHANGE  (SPECIFY)

TARGET FORMATION: MARCELLUS ESTIMATED DEPTH: 1VD ± 52' ± TMD: 15,843±  
WELL OPERATOR: NOBLE ENERGY, INC. DESIGNATED AGENT: STEVEN M. GREEN  
Address: 333 TECHNOLOGY DRIVE, SUITE 118 Address: 500 VIRGINIA STREET EAST, UNITED CENTER SUITE 500  
City: GAYNSBURG State: PA Zip Code: 15317 City: CHARLESTON State: WV Zip Code: 25301

**CANCELED**

05/19/2017