

**SURFACE HOLE LOCATION (SHL)**

UTM 17 - NAD83  
 N: 4411119.020  
 E: 519310.999  
 NAD27, WV NORTH  
 N: 494167.750  
 E: 1642185.640  
 LAT/LON DATUM - NAD83  
 LAT: 39.849872  
 LON: -80.774263

**APPROX. LANDING POINT**

UTM 17 - NAD83  
 N: 4411268.254  
 E: 519211.205  
 NAD27, WV NORTH  
 N: 494662.940  
 E: 1641866.350  
 LAT/LON DATUM - NAD83  
 LAT: 39.851218  
 LON: -80.775425

**BOTTOM HOLE LOCATION**

UTM 17 - NAD83  
 N: 4412770.655  
 E: 518121.339  
 NAD27, WV NORTH  
 N: 499652.900  
 E: 1638372.340  
 LAT/LON DATUM - NAD83  
 LAT: 39.864779  
 LON: -80.788124

**WATER WELLS:  
 NONE FOUND**

**NOTES:**

- There are no water wells or developed springs within 250' of proposed well.
- There are no existing buildings within 625' of proposed well.
- Proposed well is greater than 100' from perennial stream, wetland, pond, reservoir or lake.
- There are no native trout streams within 300' of proposed well.
- Proposed well is greater than 1000' from surface/groundwater intake or public water supply.
- It is not the purpose or intention of this plat to represent surveyed locations of the surface or mineral parcels depicted hereon. The location of the boundary lines, as shown, and based on record deed descriptions, field evidence found and/or tax map position, unless otherwise noted.

**PVE Sheffler**  
 Engineering • Surveying • Design  
 Waterfront Corporate Park III, Suite 101  
 2000 Georgetown Drive  
 Sewickley, PA 15143-8992  
 Phone: 724-444-1100



Well is located on topo map 9154 feet south of Latitude: 39° 52' 30"

LINE	BEARING	DISTANCE
R1	S16°11'22"W	276.16'
R2	S57°17'29"W	144.94'
R3	N15°10'14"E	117.28'
R4	S89°30'51"E	2217.54'
R5	N14°42'25"W	801.56'

**LEGEND**

- TOPO MAP POINT
- PROPOSED WELL
- WATER SOURCE
- LEASED NUMBER BASED ON ATTACHED WWSA1 ALL ARE POINTS UNLESS OTHERWISE NOTED
- MINERAL TRACT BOUNDARY
- PARCEL LINES
- PROPOSED HORIZONTAL WELL
- WELL REFERENCE
- STREAM WATERWAY
- ROAD
- EXISTING GAS WELL



Well is located on topo map 9154 feet west of Longitude: 80° 45' 00"

FILE #: MND 01 KHS  
 DRAWING #: MND 01 KHS  
 SCALE: 1"=1500'  
 MINIMUM DEGREE OF ACCURACY: 1/2500  
 PROVEN SOURCE OF ELEVATION: U.S.G.S. MONUMENT H 138: 638.58'

I, THE UNDERSIGNED, HEREBY CERTIFY THAT THIS PLAT IS CORRECT TO THE BEST OF MY KNOWLEDGE AND BELIEF AND SHOWS ALL THE INFORMATION REQUIRED BY LAW AND THE REGULATIONS ISSUED AND PRESCRIBED BY THE DEPARTMENT OF ENVIRONMENTAL PROTECTION.

SIGNED: [Signature]  
 R.P.E.: 18766 L.L.S.: P.S. NO. \_\_\_\_\_

STATE OF WEST VIRGINIA  
 JAMES BEAUREGARD  
 18766  
 STATE OF WEST VIRGINIA  
 PLACE SEAL HERE

(+) DENOTES LOCATION OF WELL ON UNITED STATES TOPOGRAPHIC MAPS  
 WVDEP  
 OFFICE OF OIL & GAS  
 601 57TH STREET  
 CHARLESTON, WV 25304

DATE: FEBRUARY 12, 2015 - REV FEBRUARY 24, 2015  
 OPERATOR'S WELL #: MND 01 KHS  
 API WELL # 47 051 01834  
 STATE COUNTY PERMIT

Well Type:  Oil  Waste Disposal  Production  Deep  
 Gas  Liquid Injection  Storage  Shallow

WATERSHED: SHORT CREEK-OHIO RIVER ELEVATION: 1150.46'  
 COUNTY/DISTRICT: MARSHALL / CLAY QUADRANGLE: POWHATAN POINT, W. VA./OHIO  
 SURFACE OWNER: CONSOLIDATION COAL COMPANY/ MURRAY ENERGY ACREAGE: 126.99  
 OIL & GAS ROYALTY OWNER: CNX GAS COMPANY, LLC, ET AL. ACREAGE: 126.99

DRILL  CONVERT  DRILL DEEPER  REDRILL  FRACTURE OR STIMULATE   
 PLUG OFF OLD FORMATION  PERFORATE NEW FORMATION  PLUG AND ABANDON   
 CLEAN OUT & REPLUG  OTHER CHANGE  (SPECIFY) \_\_\_\_\_

TARGET FORMATION: MARCELLUS ESTIMATED DEPTH: TVD: 6,360' ± TMD: 13,252' ±  
 WELL OPERATOR: NOBLE ENERGY, INC. DESIGNATED AGENT: JESSICA ALSOP  
 Address: 1000 NOBLE ENERGY DRIVE Address: 301 GOLDEN EAGLE DRIVE  
 City CANNONSBURG State PA Zip Code 15317 City MORGANTOWN State WV Zip Code 26508

05/29/2015

Well is located on topo map 9154 feet south of Latitude: 39° 52' 30"

Well is located on topo map 6.815 feet west of Longitude: 80° 45' 00"

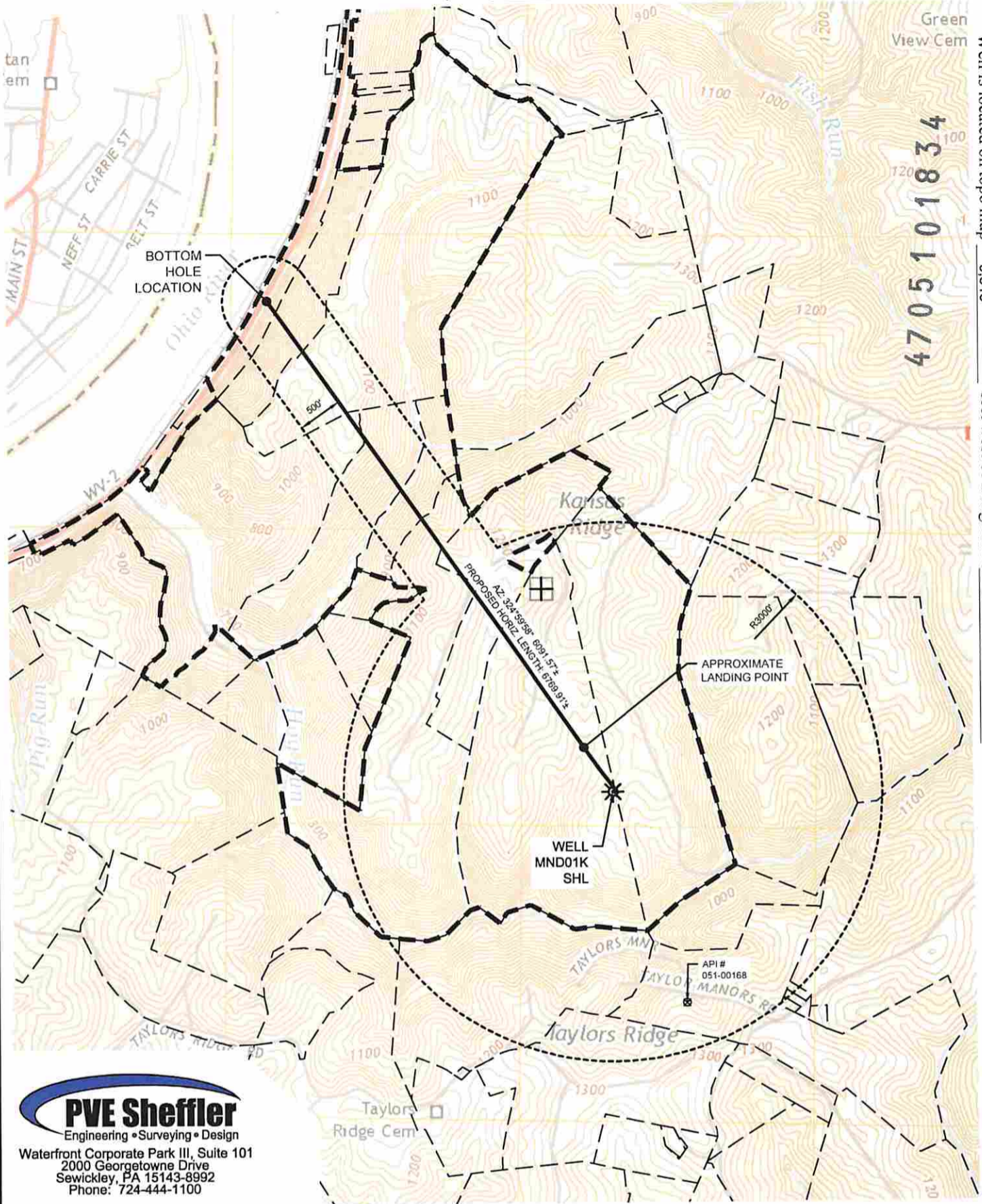

**PVE Sheffler**  
 Engineering • Surveying • Design  
 Waterfront Corporate Park III, Suite 101  
 2000 Georgetowne Drive  
 Sewickley, PA 15143-8992  
 Phone: 724-444-1100

(+) DENOTES LOCATION OF WELL ON UNITED STATES TOPOGRAPHIC MAPS WVDEP OFFICE OF OIL & GAS 601 57TH STREET CHARLESTON, WV 25304



DATE: FEBRUARY 13, 2015  
 OPERATOR'S WELL #: MND 01 KHS  
 API WELL # 47 051  
 STATE COUNTY PERMIT

Received  
 Office of Oil & Gas  
 MAR 13 2015

Well Type:  Oil  Waste Disposal  Production  Deep  
 Gas  Liquid Injection  Storage  Shallow

WATERSHED: SHORT CREEK-OHIO RIVER ELEVATION: 1150.46'  
 COUNTY/DISTRICT: MARSHALL / CLAY QUADRANGLE: POWHATAN POINT, W. VA./OHIO  
 SURFACE OWNER: CONSOLIDATION COAL COMPANY/ MURRAY ENERGY ACREAGE: 126.99  
 OIL & GAS ROYALTY OWNER: CNX GAS COMPANY, LLC, ET AL. ACREAGE: 126.99

DRILL  CONVERT  DRILL DEEPER  REDRILL  FRACTURE OR STIMULATE   
 PLUG OFF OLD FORMATION  PERFORATE NEW FORMATION  PLUG AND ABANDON   
 CLEAN OUT & REPLUG  OTHER CHANGE  (SPECIFY)

TARGET FORMATION: MARCELLUS ESTIMATED DEPTH: TVD: 6,360' ± TMD: 42,002' ±  
 WELL OPERATOR: NOBLE ENERGY, INC. DESIGNATED AGENT: STEVEN M. GREEN  
 Address: 1000 NOBLE ENERGY DRIVE Address: 500 VIRGINIA STREET EAST, UNITED CENTER SUITE 590  
 City CANNONBURG State PA Zip Code 15317 City CHARLESTON State WV Zip 25301

05/29/2015