

Well is located on topo map 9183 feet south of Latitude: 39° 52' 30"

SURFACE HOLE LOCATION (SH)
 UTM 17 - NAD83
 N: 4411110.412
 E: 519307.924
 NAD27, WY NORTH
 N: 494139.670
 E: 1642175.080
 LAT/LON DATUM=NAD83
 LAT: 39.849794
 LON: -80.774299

APPROX. LANDING POINT
 UTM 17 - NAD83
 N: 4411045.618
 E: 518920.986
 NAD27, WY NORTH
 N: 493948.290
 E: 1640901.820
 LAT/LON DATUM=NAD83
 LAT: 39.849219
 LON: -80.778824

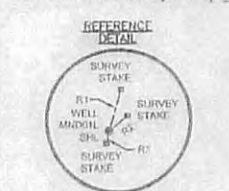

LEG TABLE

LINE	BEARING	DISTANCE
R1	S15°42'21"W	306.64
R2	S51°14'18"W	166.89
R3	N11°16'25"E	87.49
R4	S68°44'21"E	2317.89
R5	N15°09'06"W	771.27



BOTTOM HOLE LOCATION
 UTM 17 - NAD83
 N: 4412439.971
 E: 517809.500
 NAD27, WY NORTH
 N: 498579.390
 E: 1637659.090
 LAT/LON DATUM=NAD83
 LAT: 39.861804
 LON: -80.790609

WATER WELLS:
 NONE FOUND

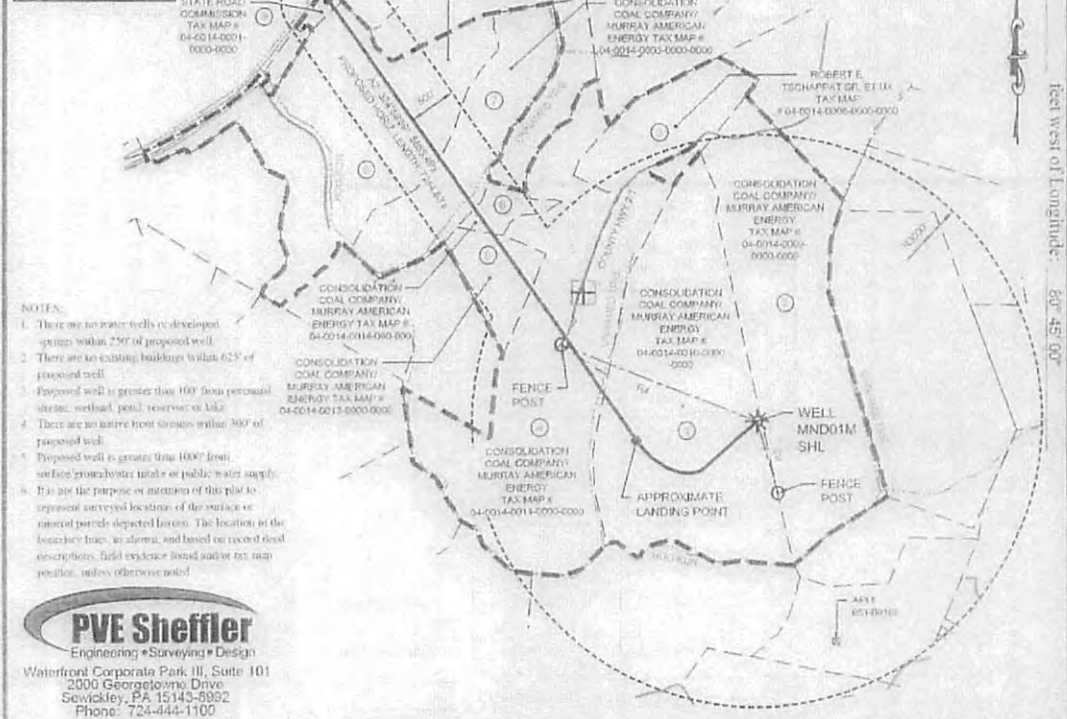

- NOTES:**
- There are no water wells or developed springs within 250' of proposed well.
 - There are no existing buildings within 625' of proposed well.
 - Proposed well is greater than 100' from personal stream, wetland, pond, reservoir or lake.
 - There are no native trout streams within 300' of proposed well.
 - Proposed well is greater than 1000' from surface promaster intake or public water supply.
 - It is the purpose or intention of this plat to represent surveyed locations of the surface or mineral parcels depicted herein. The location of the boundary lines, as shown, and based on record deed descriptions, field evidence found and/or tax map position, unless otherwise noted.

PVE Sheffler
 Engineering • Surveying • Design
 Waterfront Corporate Park III, Suite 101
 2000 Georgetown Drive
 Sewickley, PA 15143-8992
 Phone: 724-444-1100

FILE #: MND 01 MHS
 DRAWING #: MND 01 MHS
 SCALE: 1"=1500'
 MINIMUM DEGREE OF ACCURACY: 1/2500
 PROVEN SOURCE OF ELEVATION: U.S.G.S. MONUMENT H 138 636.55'

I, THE UNDERSIGNED, HEREBY CERTIFY THAT THIS PLAT IS CORRECT TO THE BEST OF MY KNOWLEDGE AND BELIEF AND SHOWS ALL THE INFORMATION REQUIRED BY LAW AND THE REGULATIONS ISSUED AND PRESCRIBED BY THE DEPARTMENT OF ENVIRONMENTAL PROTECTION.

SIGNED: *[Signature]*
 R.P.E.: 18766 L.L.S.: P.S. NO.

(+) DENOTES LOCATION OF WELL ON UNITED STATES TOPOGRAPHIC MAPS
 WVDEP
 OFFICE OF OIL & GAS
 601 57TH STREET
 CHARLESTON, WV 25304

Well Type: Oil Waste Disposal Production Deep
 Gas Liquid Injection Storage Shallow

WATERSHED: SHORT CREEK-OHIO RIVER
 COUNTY/DISTRICT: MARSHALL / CLAY
 SURFACE OWNER: CONSOLIDATION COAL COMPANY / MURRAY ENERGY
 OIL & GAS ROYALTY OWNER: CNX GAS COMPANY, LLC ET AL

DRILL CONVERT DRILL DEEPER REDRILL FRACTURE OR STIMULATE
 PLUG OFF OLD FORMATION PERFORATE NEW FORMATION PLUG AND ABANDON
 CLEAN OUT & REPLUG OTHER CHANGE (SPECIFY)

TARGET FORMATION: MARCELLUS
 WELL OPERATOR: NOBLE ENERGY, INC.
 Address: 1000 NOBLE ENERGY DRIVE
 City: CANNONBURG State: PA Zip Code: 15317

DATE: FEBRUARY 12, 2015 - REV FEBRUARY 24, 2015

OPERATOR'S WELL #: MND 01 MHS
 API WELL #: 47 051 01839
 STATE COUNTY PERMIT

ELEVATION: 1150.62'
 QUADRANGLE: POWHATAN POINT, W. VA., OHIO
 ACREAGE: 126.99

ESTIMATED DEPTH: TVD: 6,360 ± TMD: 12,000 ±
 DESIGNATED AGENT: JESSICA ALSOP
 Address: 501 GOLDEN EAGLE DRIVE
 City: MORGANTOWN State: WV Zip Code: 26505

RECEIVED
 Office of Oil and Gas
 AUG 01 2017
 WV Department of
 Environmental Protection

Well is located on topo map 9183 feet west of Longitude: 80° 45' 00"