

SURFACE HOLE

11,225'

Latitude: 39°45'00"

BOTTOM HOLE

3,697'

JACKSON SURVEYING INC.

P.O. Box 1460
677 W. Main St.
Clarksburg, WV 26302
304-623-5851

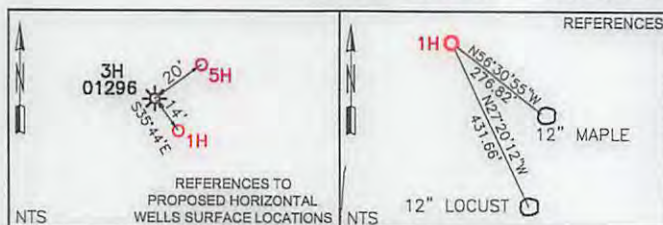
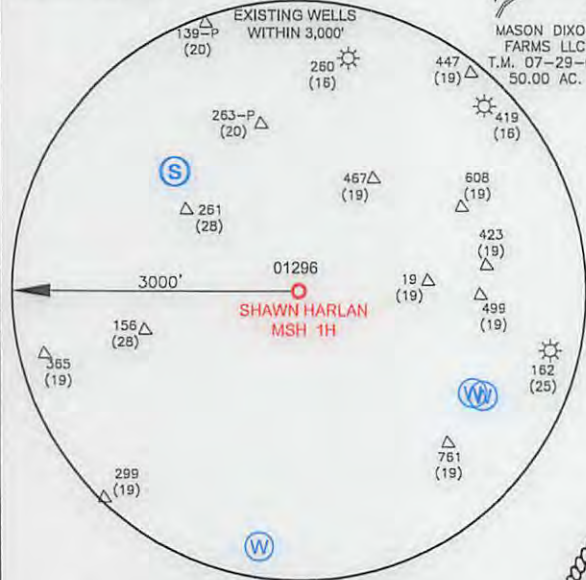

Table with 2 columns: LOCATION (SURFACE HOLE LOCATION (SHL) and BOTTOM HOLE LOCATION (BHL)) and COORDINATES (UTM NORTHING/EASTING).

ROYALTY OWNERS FOR (1): JANET E. WILBUR A/K/A JANET T. WILBUR, A/K/A JANET E. TEAGARDEN WILBUR, DAVID A. TEAGARDEN, EVA T. STALKER (EVA T. STALKER, TRUSTEE OF THE EVA T. STALKER TRUST, DATED DECEMBER 28, 1989), JEANNE G. DECLUE (THE JEANNE GOVRO DE CLUE, REVOCABLE LIVING TRUST UDT JULY 9, 2001), STEPHEN E. JUSTMAN, HAYHURST COMPANY (CHESTNUT HOLDINGS, INC.), JACK HAMMERS, PAUL HAMMERS, TWILA ORA WHIPKEY (TWILA ORA WHIPKEY TRUST DATED 8/25/1999, WESBANCO BANK WHEELING, TRUSTEE), TONI JO MASON, ERICA M. MASON, O.E. BURGE (ONWARD E. BURGE, SARAH L. BURGE AND STEPHEN W. BURGE, TRUSTEES OF THE ONWARD E. BURGE TRUST DATED JUNE 21, 2010 & SARAH L. BURGE, ONWARD E. BURGE AND STEPHEN W. BURGE, TRUSTEES OF THE SARAH L. BURGE TRUST DATED JUNE 21, 2010), A.L. EVANS AND RACHEL EVANS, (DONNA K. ALLEN, MARY LOU KITTELBERGER, DEBRA A. LKAVEC AND JOHN D. LKAVEC, NANCY JO BLOCK, CHAD E. LONGFELLOW, HOLLY A. LONGFELLOW, TRACY L. BARNEY, LLOYD R. EVANS, GLORIA STINE, ROBERT W. CUBBAGE, CLIFFORD CUBBAGE, ROBERT W. CUBBAGE, KAREN CUBBAGE, DALE E. WORKMAN, SANDRA E. RUSH, ERMA NELDA JEFFERSON, LAURA K. BAKER, DEBORAH A. COLLINS, PATTY D. JEFFERSON, JOYCE L. LAMB, STACY L. LYONS CARLA CARSWELL DAVIS, MEL TODD CARSWELL, JENNIFER CARSWELL BRIERE, FRANK K. BONACICH, JR., JEAN J. MEIER, HOWARD RAY FURBEE, ROBERT DALE FURBEE, DOROTHY EVANS, ELLEN G. KIRKBRIDE, DARLENE KAY ALBORN, MARLENE FAY WAGMILLER, ELMER DEAN EVANS, JACK HAMMERS, PAUL HAMMERS, TWILA ORA WHIPKEY TRUST DATED 8/25/1999, WESBANCO BANK WHEELING, TRUSTEE, TONI JO MASON, ERICA MASON, O.E. BURGE AND SARAH LOU BURGE, H/W AND STEPHEN BURGE, CHESTNUT HOLDINGS).



SCALE 1"=2000'

I, THE UNDERSIGNED, HEREBY CERTIFY THAT THIS PLAT IS CORRECT TO THE BEST OF MY KNOWLEDGE AND BELIEF AND SHOWS ALL THE INFORMATION REQUIRED BY LAW AND REGULATIONS ISSUED AND PRESCRIBED BY THE DEPARTMENT OF ENVIRONMENTAL PROTECTION.

David L Jackson

P.S. 708

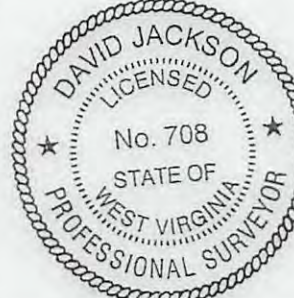

- A- BOARD OF EDUCATION T.M. 07-29-03 0.587 AC.
B- JEFFREY A. STERN & MARK C. STERN T.M. 07-29-04.1 1.00 AC.
C- MASON DIXON FARMS, LLC T.M. 07-18-13 126.00 AC.
D- MASON DIXON FARMS, LLC T.M. 07-18-04 13.26 AC.

NOTES ON SURVEY

- 1. NO DWELLINGS OR AGRICULTURAL BUILDINGS GREATER THAN 2,500 SQUARE FEET WITHIN 625 FEET OF PROPOSED CENTER OF PAD.
2. NO WATER WELLS OR DEVELOPED SPRINGS WITHIN 250 FEET OF PROPOSED WELL.
3. ALL WELLS WITHIN 500' OF THE HORIZONTAL LEG ARE SHOWN ON THIS PLAT BASED UPON INFORMATION TAKEN FROM DEP MAPPING, WELL PLATS AND AERIAL PHOTOS.
4. COORDINATES SYSTEM IS UTM, NAD 83 DATUM, ZONE 17, U.S. FOOT AND WELL COORDINATES ESTABLISHED USING SURVEY GRADE GPS.

PLAT SCALE 1"=2000'

COMPANY: SWN Production Company, LLC

STATE OF WEST VIRGINIA logo and WVDEP OFFICE OF OIL & GAS address: 601 57TH STREET CHARLESTON, WV 25034

MINIMUM DEGREE OF ACCURACY: 1/200
PROVEN SURVEY SOURCE OF GRADE GPS ELEVATION: (NAVD 88, US FT)

SHAWN HARLAN MSH
OPERATOR'S WELL #: 1H
API WELL #: 47 051 01881
STATE COUNTY PERMIT

WELL TYPE: OIL [] WASTE DISPOSAL [] PRODUCTION [X] DEEP [] GAS [X] LIQUID INJECTION [] STORAGE [] SHALLOW [X]
WATERSHED: LAUREL RUN OF UPPER OHIO SOUTH
DISTRICT: LIBERTY COUNTY: MARSHALL
SURFACE OWNER: SCOTT L. HARLAN AND SHAWN HARLAN
OIL & GAS ROYALTY OWNER: SEE NOTE 5
DRILL [X] DRILL DEEPER [] REDRILL [] FRACTURE OR STIMULATE [] PLUG OFF OLD FORMATION [] PERFORATE NEW FORMATION [X]
CONVERT [] PLUG & ABANDON [] CLEAN OUT & REPLUG [] OTHER CHANGE [] (SPECIFY)
TARGET FORMATION: MARCELLUS ESTIMATED DEPTH: 7,183 1/8 12,191.64 TMD

WELL OPERATOR: SWN PRODUCTION COMPANY, LLC DESIGNATED AGENT: DEE SOUTHALL
ADDRESS: P.O. BOX 1300 ADDRESS: P.O. BOX 1300
CITY: JANE LEW STATE: WV ZIP CODE: 26378 CITY: JANE LEW STATE: WV ZIP CODE: 26378

Table with 2 columns: REVISIONS (ADDED OIL & GAS ROYALTY OWNER, REVISED OWNERSHIPS FOR 6A1 08-04-2016) and DATE (07-29-2016)

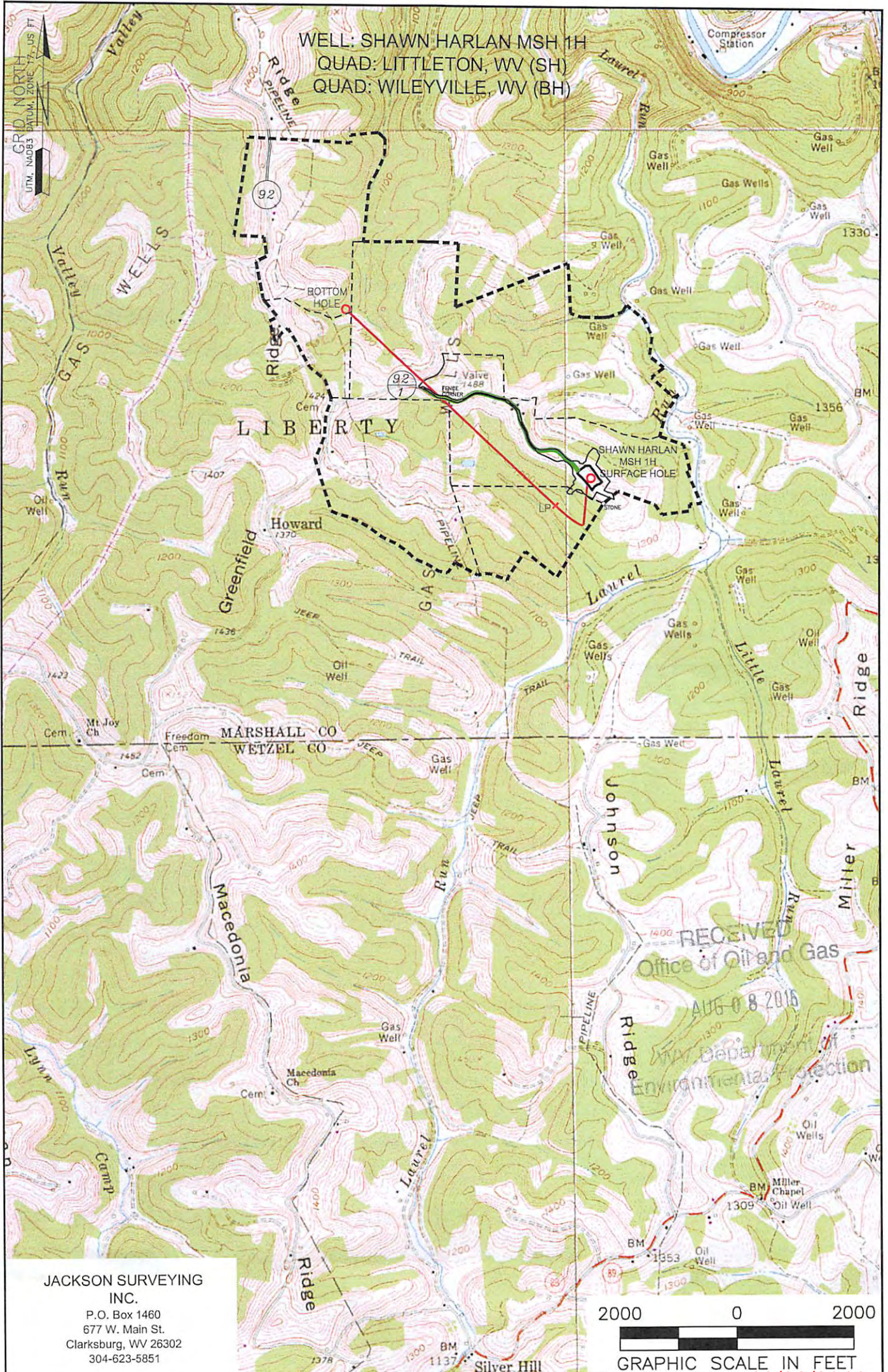

NOTE:
 THE PURPOSE OF THIS PLAT IS FOR THE LOCATION OF PROPOSED GAS WELLS AND DOES NOT REPRESENT A CLOSED BOUNDARY SURVEY. PROPERTY LINES AND OWNERS WERE OBTAINED FROM VARIOUS FIELD EVIDENCE, TAX RECORDS, AND AERIAL MAPPING.

10/28/2016

LEGEND:
 - - - - - LEASE BOUNDARY

Applicant/Well Operator Name SWN PRODUCTION COMPANY, LLC	Well (Farm) Name SHAWN HARLAN MSH 1H	Well# 1H
Address PO BOX 1300 JANE LEW, WV 26378	County MARSHALL	District LIBERTY
Surface Landowner/ Lessor MICHAEL A. DUNN ET UX	USGS 7 1/2 Quadrangle Map Name LITTLETON (SH) & WILEYVILLE (BH)	