

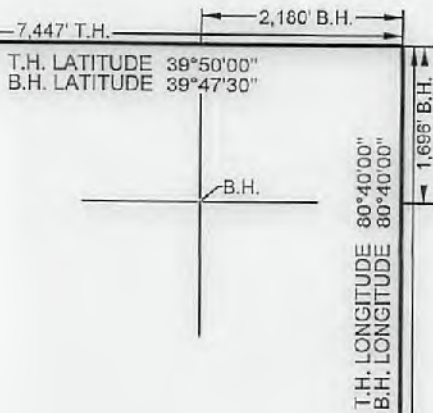

**HEAVEN HILL 3 LEASE  
WELL 5HM  
TUG HILL OPERATING**



(S.P.C. NORTH ZONE) (UTM(M) ZONE 17 NORTH)		
NAD'83 S.P.C.(FT)	N. 478,871.18	E. 1,633,313.44
NAD'83 GEO.	LAT-(N) 39.808633	LONG-(W) 80.693174
NAD'83 UTM (M)	N. 4,408,562.70	E. 526,263.54
LANDING POINT		
NAD'83 S.P.C.(FT)	N. 477,463.4	E. 1,634,847.7
NAD'83 GEO.	LAT-(N) 39.804824	LONG-(W) 80.687647
NAD'83 UTM (M)	N. 4,408,141.8	E. 526,738.1
BOTTOM HOLE		
NAD'83 S.P.C.(FT)	N. 470,926.5	E. 1,636,477.3
NAD'83 GEO.	LAT-(N) 39.787010	LONG-(W) 80.674425
NAD'83 UTM (M)	N. 4,404,168.6	E. 527,877.2



**REFERENCES**

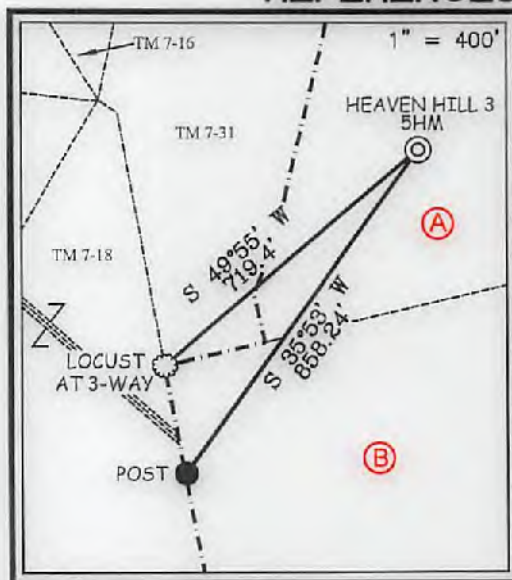

**NOTES ON SURVEY**

1. NO WATER WELLS WERE FOUND WITHIN 250' OF PROPOSED GAS WELL. NO AGRICULTURAL BUILDINGS ≥ 2500 SQ. FT. OR DWELLINGS WERE FOUND WITHIN 625' OF THE CENTER OF PROPOSED WELL PAD.
2. WELL SPOT CIRCLE & TOPO MARK SCALE IS 1"=2000'



I THE UNDERSIGNED, HEREBY CERTIFY THAT THIS PLAT IS CORRECT TO THE BEST OF MY KNOWLEDGE AND BELIEF AND SHOWS ALL THE INFORMATION REQUIRED BY LAW AND THE REGULATIONS ISSUED AND PRESCRIBED BY THE DIVISION OF ENVIRONMENTAL PROTECTION.

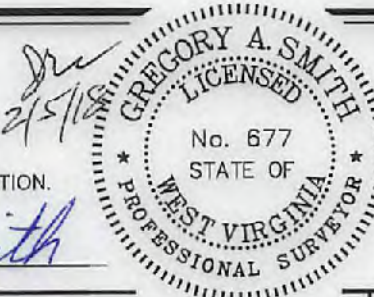

P.S. 677 *Gregory A. Smith*

(+) DENOTES LOCATION OF WELL ON UNITED STATES TOPOGRAPHIC MAPS.  
 DATE JUNE 30, 20 17  
 REVISED FEBRUARY 2, 20 18  
 OPERATORS WELL NO. HEAVEN HILL 3-5HM  
 API WELL NO. 47-051-01948 *#to A MOD*  
 STATE COUNTY PERMIT

MINIMUM DEGREE OF ACCURACY 1 / 2500 FILE NO. 8654P5HMR.dwg  
 HORIZONTAL & VERTICAL CONTROL DETERMINED BY DGPS (SURVEY GRADE TIE TO CORS NETWORK) SCALE 1" = 2000'

STATE OF WEST VIRGINIA  
 DIVISION OF ENVIRONMENTAL PROTECTION  
 OFFICE OF OIL AND GAS

WELL TYPE: OIL  GAS  LIQUID INJECTION  WASTE DISPOSAL  IF "GAS" PRODUCTION  STORAGE  DEEP  SHALLOW

LOCATION: ELEVATION GROUND = 1,342.20' PROPOSED = 1,326.35' WATERSHED LOWER BOWMAN RUN OF FISH CREEK (HUC 10)  
 DISTRICT MEADE COUNTY MARSHALL QUADRANGLE GLEN EASTON 7.5'

SURFACE OWNER RICKY L. WHITLATCH ACREAGE 72.82±  
 ROYALTY OWNER RICKY L. WHITLATCH, ET AL - SEE WW-6A1 ACREAGE 72.82±

PROPOSED WORK: DRILL  CONVERT  DRILL DEEPER  REDRILL  FRACTURE OR STIMULATE  PLUG OFF OLD FORMATION  PERFORATE NEW FORMATION  PLUG AND ABANDON  CLEAN OUT AND REPLUG  OTHER

PHYSICAL CHANGE IN WELL (SPECIFY) \_\_\_\_\_ TARGET FORMATION MARCELLUS  
 ESTIMATED DEPTH TVD: 6,876' / TMD: 14,866'

WELL OPERATOR TUG HILL OPERATING, LLC DESIGNATED AGENT DIANNA STAMPER  
 ADDRESS 1320 SOUTH UNIVERSITY DRIVE, SUITE 500 ADDRESS CT CORPORATION SYSTEM  
FORT WORTH, TX 76107 ADDRESS 5400 D BIG TYLER ROAD  
CHARLESTON, WV 25313

03/02/2018

COUNTY NAME PERMIT