

BHL is located on topo map 2,708 feet south of Latitude: 39° 52' 30"
 SHL is located on topo map 2,705 feet south of Latitude: 39° 52' 30"

BHL is located on topo map 3,180 feet west of Longitude: 80° 45' 00"
 SHL is located on topo map 3,178 feet west of Longitude: 80° 45' 00"

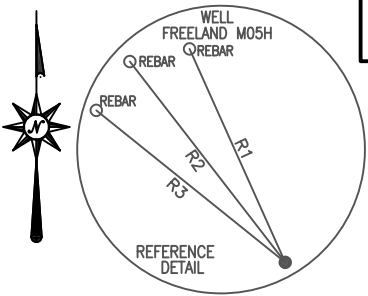

LINE	BEARING	DISTANCE
R1	N 25°09'34" W	217.31'
R2	N 38°39'45" W	236.71'
R3	N 52°06'26" W	227.05'
R4	N 40°22'58" W	1652.77'
R5	S 20°45'47" E	1811.52'
R6	N 71°48'19" E	1173.79'

	SURFACE OWNER	DIST-TM/PAR
1	JOSEPH L. FREELAND ET UX	4-7/21
	LESSOR	DIST-TM/PAR
A	JOSEPH FREELAND ET UX	4-7/21

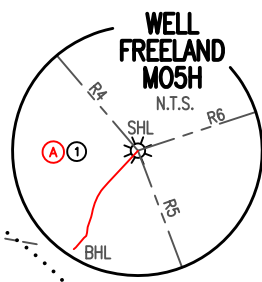

LEGEND	
	- TOPO MAP POINT
	- WELL
	- ALL ARE POINTS UNLESS OTHERWISE NOTED.
	- MINERAL TRACT BOUNDARY
	- PARCEL LINES
	- WELL REFERENCE
	- ROAD
	- STREAM CENTER LINE
	- LESSORS
	- SURFACE OWNERS
	- AS-DRILLED
GAS WELLS	
	- EXISTING WELLS
	- PLUGGED WELLS

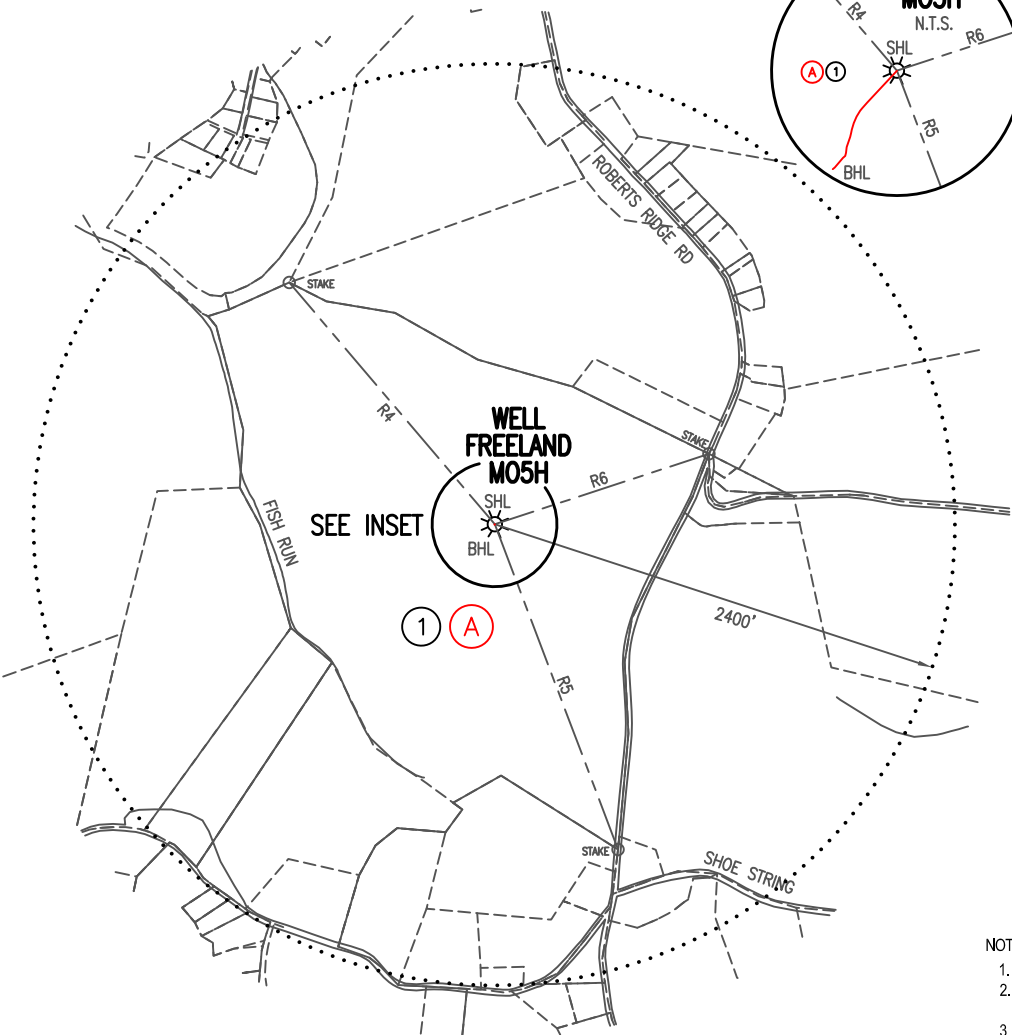

AS-DRILLED LOCATIONS UTM 17-NAD83(M)
SURFACE HOLE LOCATION (SHL)
N:4412875.28 E:520416.36
APPROX LANDING POINT (LP)
N:N/A E:N/A
BOTTOM HOLE LOCATION (BHL)
N:4412874.48 E:520415.86

- NOTES:
- There are no water wells or developed springs within 250' of proposed well.
 - Proposed well is greater than 100' from perennial stream, wetland, pond, reservoir or lake.
 - There are no native trout streams within 300' of proposed well.
 - Proposed well is greater than 1000' from surface groundwater intake or public water supply.
 - It is not the purpose or intention of this plat to represent surveyed locations of the surface or mineral parcels depicted hereon. The location of the boundary lines, as shown, are based on record deed descriptions, field evidence found and/or tax map position, unless otherwise noted.
 - There are no existing buildings within 625' of proposed well.

THRASHER
 THE THRASHER GROUP, INC.
 600 WHITE OAKS BLVD.
 BRIDGEPORT, WV 26330
 PHONE 304-624-4108

**AS-DRILLED
 PLAT**

FILE #: FREELAND M05H - AS-DRILLED
 DRAWING #: FREELAND M05H - AS-DRILLED
 SCALE: 1" = 2000'
 MINIMUM DEGREE OF ACCURACY: 1/2500
 PROVEN SOURCE OF ELEVATION: U.S.G.S. MONUMENT THOMAS 1498.81'

I, THE UNDERSIGNED, HEREBY CERTIFY THAT THIS PLAT IS CORRECT TO THE BEST OF MY KNOWLEDGE AND BELIEF AND SHOWS ALL THE INFORMATION REQUIRED BY LAW AND THE REGULATIONS ISSUED AND PRESCRIBED BY THE DEPARTMENT OF ENVIRONMENTAL PROTECTION.

Signed:
 R.P.E.: _____ L.L.S.: P.S. No. 2346



(+) DENOTES LOCATION OF WELL ON UNITED STATES TOPOGRAPHIC MAPS WVDEP
 OFFICE OF OIL & GAS
 601 57TH STREET
 CHARLESTON, WV 25304



DATE: OCT 8, 2021
 OPERATOR'S WELL #: FREELAND M05H - AS-DRILLED
 API WELL #: 47 51 2148
 STATE COUNTY PERMIT

Well Type: Oil Waste Disposal Production Deep Gas Liquid Injection Storage Shallow

WATERSHED: SHORT CREEK-OHIO RIVER ELEVATION: 1274.00'

COUNTY/DISTRICT: MARSHALL / CLAY QUADRANGLE: POWHATAN POINT, WV 7.5'

SURFACE OWNER: JOSEPH L. FREELAND ET UX ACREAGE: 104.22±

OIL & GAS ROYALTY OWNER: JOSEPH FREELAND ET UX ACREAGE: 104.22±

DRILL CONVERT DRILL DEEPER REDRILL FRACTURE OR STIMULATE PLUG OFF OLD FORMATION
 PERFORATE NEW FORMATION PLUG & ABANDON CLEAN OUT & REPLUG OTHER CHANGE

(SPECIFY): _____

TARGET FORMATION: MARCELLUS ESTIMATED DEPTH: TVD: N/A TMD: 635.00'±

WELL OPERATOR CHEVRON APPALACHIA, LLC DESIGNATED AGENT JOSEPH C. MALLOW
 Address 700 CHERRINGTON PARKWAY Address 115 PROFESSIONAL PLACE, PO BOX 280
 City CORAOPOLIS State PA Zip Code 15108 City BRIDGEPORT State WV Zip Code 26330

BHL is located on topo map 2,708 feet south of Latitude: 39° 52' 30"
 SHL is located on topo map 2,705 feet south of Latitude: 39° 52' 30"

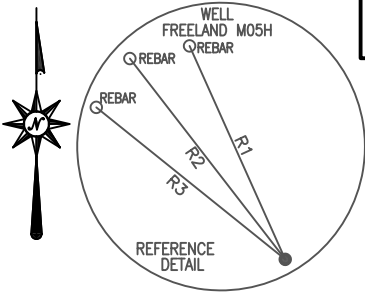

LINE	BEARING	DISTANCE
R1	N 25°09'34" W	217.31'
R2	N 38°39'45" W	236.71'
R3	N 52°06'26" W	227.05'
R4	N 40°22'58" W	1652.77'
R5	S 20°45'47" E	1811.52'
R6	N 71°48'19" E	1173.79'

	SURFACE OWNER	DIST-TM/PAR
1	JOSEPH L. FREELAND ET UX	4-7/21
	LESSOR	DIST-TM/PAR
A	JOSEPH FREELAND ET UX	4-7/21

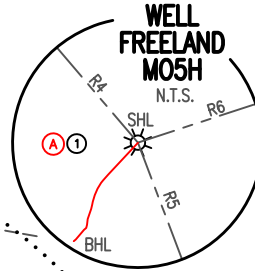

LEGEND	
	- TOPO MAP POINT
	- WELL
	- ALL ARE POINTS UNLESS OTHERWISE NOTED.
	- MINERAL TRACT BOUNDARY
	- PARCEL LINES
	- WELL REFERENCE
	- ROAD
	- STREAM CENTER LINE
	- LESSORS
	- SURFACE OWNERS
	- AS-DRILLED
GAS WELLS	
	- EXISTING WELLS
	- PLUGGED WELLS

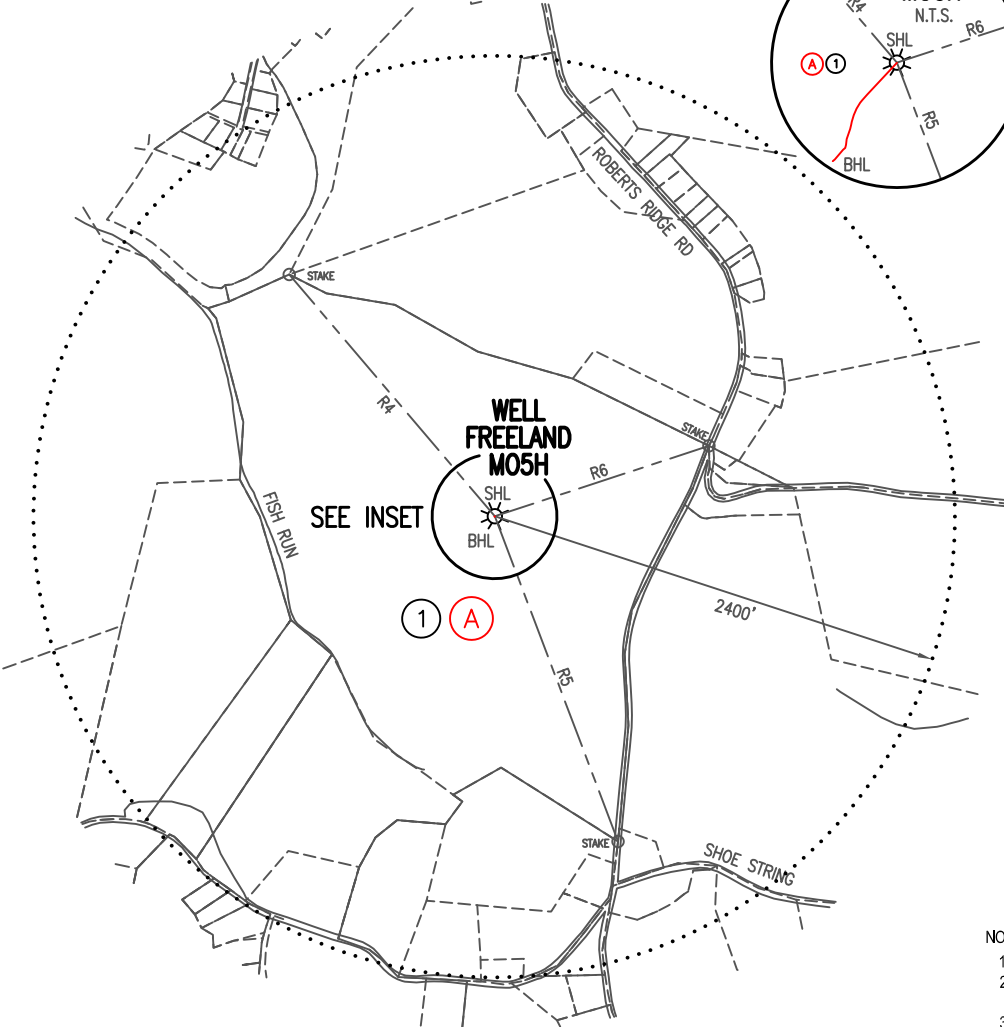

AS-DRILLED LOCATIONS UTM 17-NAD83(M)
SURFACE HOLE LOCATION (SHL)
N:4412875.28 E:520416.36
APPROX LANDING POINT (LP)
N:N/A E:N/A
BOTTOM HOLE LOCATION (BHL)
N:4412874.48 E:520415.86

NOTES:

- There are no water wells or developed springs within 250' of proposed well.
- Proposed well is greater than 100' from perennial stream, wetland, pond, reservoir or lake.
- There are no native trout streams within 300' of proposed well.
- Proposed well is greater than 1000' from surface groundwater intake or public water supply.
- It is not the purpose or intention of this plat to represent surveyed locations of the surface or mineral parcels depicted hereon. The location of the boundary lines, as shown, are based on record deed descriptions, field evidence found and/or tax map position, unless otherwise noted.
- There are no existing buildings within 625' of proposed well.

THRASHER

THE THRASHER GROUP, INC.
600 WHITE OAKS BLVD.
BRIDGEPORT, WV 26330
PHONE 304-624-4108

**AS-DRILLED
PLAT**

FILE #: FREELAND M05H - AS-DRILLED
 DRAWING #: FREELAND M05H - AS-DRILLED
 SCALE: 1" = 2000'
 MINIMUM DEGREE OF ACCURACY: 1/2500
 PROVEN SOURCE OF ELEVATION: U.S.G.S. MONUMENT THOMAS 1498.81'

I, THE UNDERSIGNED, HEREBY CERTIFY THAT THIS PLAT IS CORRECT TO THE BEST OF MY KNOWLEDGE AND BELIEF AND SHOWS ALL THE INFORMATION REQUIRED BY LAW AND THE REGULATIONS ISSUED AND PRESCRIBED BY THE DEPARTMENT OF ENVIRONMENTAL PROTECTION.

Signed:

R.P.E.:

L.L.S.: P.S. No. 2346



(+) DENOTES LOCATION OF WELL ON UNITED STATES TOPOGRAPHIC MAPS WVDEP
 OFFICE OF OIL & GAS
 601 57TH STREET
 CHARLESTON, WV 25304



DATE: OCT 8, 2021

OPERATOR'S WELL #: FREELAND M05H - AS-DRILLED

API WELL #: 47 51 2148
 STATE COUNTY PERMIT

Well Type: Oil Waste Disposal Production Deep Gas Liquid Injection Storage Shallow

WATERSHED: SHORT CREEK-OHIO RIVER ELEVATION: 1274.00'

COUNTY/DISTRICT: MARSHALL / CLAY QUADRANGLE: POWHATAN POINT, WV 7.5'

SURFACE OWNER: JOSEPH L. FREELAND ET UX ACREAGE: 104.22±

OIL & GAS ROYALTY OWNER: JOSEPH FREELAND ET UX ACREAGE: 104.22±

DRILL CONVERT DRILL DEEPER REDRILL FRACTURE OR STIMULATE PLUG OFF OLD FORMATION

PERFORATE NEW FORMATION PLUG & ABANDON CLEAN OUT & REPLUG OTHER CHANGE

(SPECIFY):

TARGET FORMATION: MARCELLUS ESTIMATED DEPTH: TVD: N/A TMD: 635.00'±

WELL OPERATOR CHEVRON APPALACHIA, LLC DESIGNATED AGENT JOSEPH C. MALLOW

Address 700 CHERRINGTON PARKWAY Address 115 PROFESSIONAL PLACE, PO BOX 280

City CORAOPOLIS State PA Zip Code 15108 City BRIDGEPORT State WV Zip Code 26330

BHL is located on topo map 3,180 feet west of Longitude: 80° 45' 00"
 SHL is located on topo map 3,178 feet west of Longitude: 80° 45' 00"