

State of West Virginia
Department of Environmental Protection - Office of Oil and Gas
Well Operator's Report of Well Work

RECEIVED
Office of Oil and Gas

APR - 5 2022

WV Department of
Environmental Protection

API 47-051-02155 County Marshall District Washington
Quad Moundsville Pad Name Hines Field/Pool Name N/A
Farm name Donald Hines et UX Well Number Hines M01H
Operator (as registered with the OOG) EQT CHAP LLC
Address 400 Woodcliff Drive City Canonsburg State PA Zip 15317

As Drilled location NAD 83/UTM Attach an as-drilled plat, profile view, and deviation survey
Top hole Northing 4,417,409.86 Easting 525,699.32
Landing Point of Curve Northing _____ Easting _____
Bottom Hole Northing 4,417,535.38 Easting 525,796.90

Elevation (ft) 1125' GL Type of Well New Existing Type of Report Interim Final
Permit Type Deviated Horizontal Horizontal 6A Vertical Depth Type Deep Shallow
Type of Operation Convert Deepen Drill Plug Back Redrilling Rework Stimulate
Well Type Brine Disposal CBM Gas Oil Secondary Recovery Solution Mining Storage Other _____
Type of Completion Single Multiple Fluids Produced Brine Gas NGL Oil Other _____
Drilled with Cable Rotary
Drilling Media Surface hole Air Mud Fresh Water Intermediate hole Air Mud Fresh Water Brine
Production hole Air Mud Fresh Water Brine
Mud Type(s) and Additive(s)

Date permit issued 02/22/2019 Date drilling commenced 03/19/2019 Date drilling ceased 05/05/2019
Date completion activities began _____ Date completion activities ceased _____
Verbal plugging (Y/N) N Date permission granted N/A Granted by N/A

Please note: Operator is required to submit a plugging application within 5 days of verbal permission to plug

Freshwater depth(s) ft 365 Open mine(s) (Y/N) depths N
Salt water depth(s) ft 1039,1595,1632 Void(s) encountered (Y/N) depths N
Coal depth(s) ft 365,655 Cavern(s) encountered (Y/N) depths N
Is coal being mined in area (Y/N) Y

Reviewed by

Reviewed by:
MJK 5/11/22
05/27/2022

API 47-051 - 02155 Farm name Donald Hines et UX Well number Hines M01H

CASING STRINGS	Hole Size	Casing Size	Depth (GL)	New or Used	Grade wt/ft	Basket Depth(s) (GL)	Did cement circulate (Y/N) * Provide details below*
Conductor	30"	20"	50'	NEW	X-52 78.6#	N/A	Y
Surface	17-1/2"	13-3/8"	447'	NEW	J-55 54.5#	N/A	Y
Coal							
Intermediate 1	12-3/8"	9-5/8"	2024'	NEW	L-80 40#	N/A	Y
Intermediate 2							
Intermediate 3							
Production						N/A	N
Tubing							
Packer type and depth set							

Comment Details _____
No issues during cement job.

CEMENT DATA	Class/Type of Cement	Number of Sacks	Slurry wt (ppg)	Yield (ft ³ /sks)	Volume (ft ³)	Cement Top (GL)	WOC (hrs)
Conductor	CLASS A	N/A	N/A	N/A	N/A	0	8+
Surface	CLASS A	448	15.6	1.19	533	0	8
Coal							
Intermediate 1	CLASS A	687	15.6	1.19	817	0	8
Intermediate 2							
Intermediate 3							
Production							
Tubing							

Drillers TD (ft) 5594' Loggers TD (ft) N/A
Deepest formation penetrated MARCELLUS Plug back to (ft) N/A
Plug back procedure _____

Kick off depth (ft) 707'

Check all wireline logs run caliper density deviated/directional induction
 neutron resistivity gamma ray temperature sonic

Well cored Yes No Conventional Sidewall Were cuttings collected Yes No

DESCRIBE THE CENTRALIZER PLACEMENT USED FOR EACH CASING STRING _____
CONDUCTOR- NONE
SURFACE- ON SHOE TRACK AND EVERY 500' TO SURFACE
INTERMEDIATE: ON SHOE TRACK AND EVERY 500' FEET TO SURFACE

WAS WELL COMPLETED AS SHOT HOLE Yes No DETAILS _____

WAS WELL COMPLETED OPEN HOLE? Yes No DETAILS _____

WERE TRACERS USED Yes No TYPE OF TRACER(S) USED _____

API 47- 051 - 02155 Farm name Donald Hines et UX Well number Hines M01H

PERFORATION RECORD

Stage No.	Perforation date	Perforated from MD ft.	Perforated to MD ft.	Number of Perforations	Formation(s)

Please insert additional pages as applicable.

STIMULATION INFORMATION PER STAGE

Complete a separate record for each stimulation stage.

Stage No.	Stimulations Date	Ave Pump Rate (BPM)	Ave Treatment Pressure (PSI)	Max Breakdown Pressure (PSI)	ISIP (PSI)	Amount of Proppant (lbs)	Amount of Water (bbls)	Amount of Nitrogen/other (units)

Please insert additional pages as applicable.

API 47- 051 - 02155 Farm name Donald Hines et UX Well number Hines M01H

<u>PRODUCING FORMATION(S)</u>	<u>DEPTHS</u>
	TVD MD

Please insert additional pages as applicable.

GAS TEST Build up Drawdown Open Flow OIL TEST Flow Pump

SHUT-IN PRESSURE Surface _____ psi Bottom Hole _____ psi DURATION OF TEST _____ hrs

OPEN FLOW Gas _____ mcfpd Oil _____ bpd NGL _____ bpd Water _____ bpd GAS MEASURED BY Estimated Orifice Pilot

LITHOLOGY/ FORMATION	TOP DEPTH IN FT NAME TVD	BOTTOM DEPTH IN FT TVD	TOP DEPTH IN FT MD	BOTTOM DEPTH IN FT MD	DESCRIBE ROCK TYPE AND RECORD QUANTITY AND TYPE OF FLUID (FRESHWATER, BRINE, OIL, GAS, H ₂ S, ETC)
	0		0		

Please insert additional pages as applicable.

Drilling Contractor Highlands Drilling LLC
Address 900 Virginia Street East City Charleston State WV Zip 25301

Logging Company Baker Hughes
Address 400 Technology Dr Suite 100 City Canonsburg State PA Zip 15317

Cementing Company BJ Services
Address 1036 East Main Street City Bridgeport State WV Zip 26330

Cementing Company _____
Address _____ City + State _____ Zip _____

Please insert additional pages as applicable.

Completed by Derek Ridgway Telephone 412-395-3139
Signature  11/18/2021 Title Managing Director of Drilling Date 11/18/2021

Submittal of Hydraulic Fracturing Chemical Disclosure Information Attach copy of FRACFOCUS Registry

05/27/2022

API 47- 051 - 02155 Farm name Donald Hines et UX Well number Hines M01H

Drilling Contractor Precision Drilling
Address 10350 Richmond Ave. Suite 700 City Houston State TX Zip 77042

Logging Company Scientific Drilling International
Address 124 Vista Drive City Charleroi State PA Zip 15022

Logging Company _____
Address _____ City _____ State _____ Zip _____

Drilling Contractor _____
Address _____ City _____ State _____ Zip _____

Well# Hines M01H Final Formations API# 47-051-02155

Formation Name	Drill Top MD (ftGRD)	Drill Top (TVD) (ftGRD)	Drill Btm MD (ftGRD)	Drill Btm (TVD) (ftGRD)
Sand/Shale	1	1	365	365
Waynesburg Coal	365	365	368	368
Sand/Shale	368	368	655	655
Pittsburgh Coal	655	655	661	661
Sand/Shale	661	661	1,595	1,595
Big Lime	1,595	1,595	1,657	1,657
Sand/Shale	1,657	1,657	1,831	1,831
Burgoon	1,831	1,831	1,984	1,984
Sand/Shale	1,984	1,984	2,198	2,198
Berea	2,198	2,198	2,219	2,219
Sand/Shale	2,219	2,219	2,455	2,453
Gordon	2,455	2,453	2,530	2,526
Sand/Shale	2,530	2,526	4,977	4,320
Elk	4,977	4,320	4,978	4,321
Sand/Shale	4,978	4,321	5,594	5,528

BHL is located on topo map 3,361 feet south of Latitude: 39° 55' 00"
 SHL is located on topo map 4,373 feet south of Latitude: 39° 55' 00"

SEE PAGE 2 FOR SURFACE OWNERS AND LESSORS

LINE	BEARING	DISTANCE
R1	S 00°49'04" E	227.18'
R2	S 19°56'29" W	223.81'
R3	S 63°37'54" W	174.84'
R4	N 77°21'39" E	2078.26'
R5	S 89°57'09" E	2337.22'
R6	S 65°32'24" E	1423.94'

NOTES:

1. There are no water wells or developed springs within 250' of proposed well.
2. Proposed well is greater than 100' from perennial stream, wetland, pond, reservoir or lake.
3. There are no native trout streams within 300' of proposed well.
4. Proposed well is greater than 1000' from surface groundwater intake or public water supply.
5. It is not the purpose or intention of this plat to represent surveyed locations of the surface or mineral parcels depicted hereon. The location of the boundary lines, as shown, are based on record deed descriptions, field evidence found and/or tax map position, unless otherwise noted.
6. There are no existing buildings within 625' of proposed well.

BHL is located on topo map 8,907 feet west of Longitude: 80° 40' 00"
 SHL is located on topo map 9,228 feet west of Longitude: 80° 40' 00"

WELL PAD ORIENTATION DETAIL

M01H	M14H	U15H	U28H
M02H	M13H	U18H	U27H
M03H	M12H	U17H	U26H
M04H	M11H	U16H	U25H
M05H	M10H	U15H	U24H
M06H	M09H	U14H	U23H
M07H	M08H	U13H	U22H
M08H	M07H	U12H	U21H
M09H	M06H	U11H	U20H
M10H	M05H	U10H	U19H
M11H	M04H	U09H	U18H
M12H	M03H	U08H	U17H
M13H	M02H	U07H	U16H
M14H	M01H	U06H	U15H

LEGEND

- ⊕ - TOPO MAP POINT
- ⊙ - WELL
- - ALL ARE POINTS UNLESS OTHERWISE NOTED
- MINERAL TRACT BOUNDARY
- PARCEL LINES
- WELL REFERENCE
- ROAD
- STREAM CENTER LINE
- Ⓐ - LESSORS
- Ⓛ - SURFACE OWNERS
- AS-DRILLED

GAS WELLS

- ⊙ - EXISTING WELLS
- ⊙ - PLUGGED WELLS

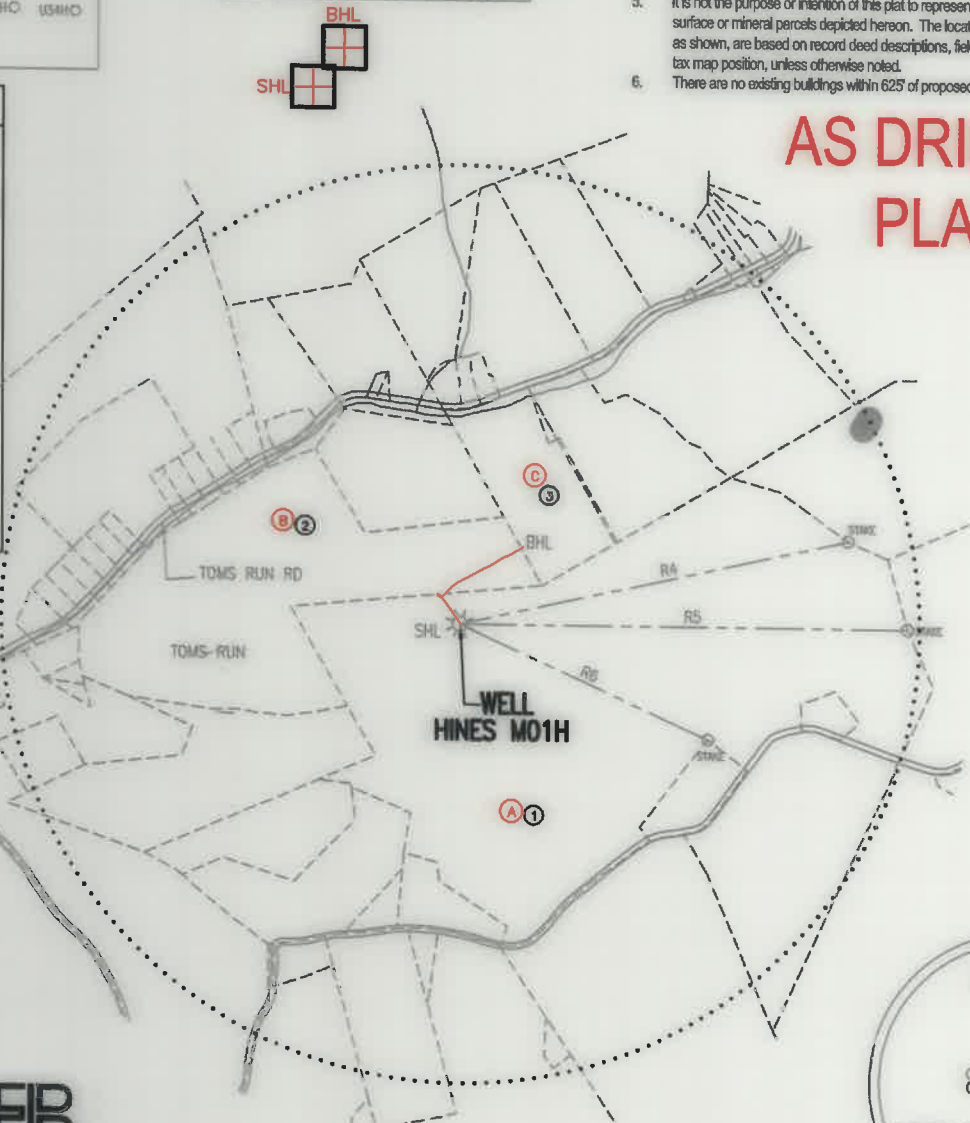

AS DRILLED PLAT

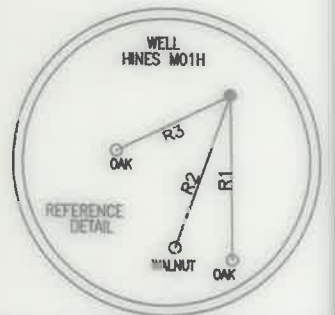

AS-DRILLED LOCATIONS UTM 17-WAD83(N)

SURFACE HOLE LOCATION (SHL)
N:4417409.86
E:525699.32
APPROX LANDING POINT (LP)
N:N/A
E:N/A
BOTTOM HOLE LOCATION (BHL)
N:4417535.38
E:525796.90

THRASHER

THE THRASHER GROUP, INC.
 600 WHITE OAKS BLVD.
 BRIDGEPORT, WV 26330
 PHONE 304-624-4108

FILE #: HINES M01H - AS DRILLED
 DRAWING #: HINES M01H - AS DRILLED
 SCALE: 1" = 1000'
 MINIMUM DEGREE OF ACCURACY: 1/2500
 PROVEN SOURCE OF ELEVATION: U.S.G.S. MONUMENT THOMAS 1498.81'

I, THE UNDERSIGNED, HEREBY CERTIFY THAT THIS PLAT IS CORRECT TO THE BEST OF MY KNOWLEDGE AND BELIEF AND SHOWS ALL THE INFORMATION REQUIRED BY LAW AND THE REGULATIONS ISSUED AND PRESCRIBED BY THE DEPARTMENT OF ENVIRONMENTAL PROTECTION.

Signed: *Joseph H. Lowther*
 R.P.E.: _____ L.L.S.: P.S. No. 2346



(+) DENOTES LOCATION OF WELL ON UNITED STATES TOPOGRAPHIC MAPS WVDEP
 OFFICE OF OIL & GAS
 601 57TH STREET
 CHARLESTON, WV 25304



DATE: DECEMBER 13, 2021
 OPERATOR'S WELL #: HINES M01H - AS DRILLED
 API WELL #: 47 51 2155
 STATE COUNTY PERMIT

Well Type: Oil Waste Disposal Production Deep Gas Liquid Injection Storage Shallow

WATERSHED: MIDDLE GRAVE CREEK-GRAVE CREEK ELEVATION: 1125.45'

COUNTY/DISTRICT: MARSHALL / WASHINGTON QUADRANGLE: MOUNDSVILLE, WV 7.5'

SURFACE OWNER: DONALD HINES ET UX ACREAGE: 114.934±

OIL & GAS ROYALTY OWNER: DONALD HINES ET UX ACREAGE: 163.51± **05/27/2022**

DRILL CONVERT DRILL DEEPER REDRILL FRACTURE OR STIMULATE PLUG OFF OLD FORMATION

PERFORATE NEW FORMATION PLUG & ABANDON CLEAN OUT & REPLUG OTHER CHANGE

(SPECIFY): AS-DRILLED PLAT

TARGET FORMATION: MARCELLUS ESTIMATED DEPTH: TVD: 5,553± TMD: 5,619±

WELL OPERATOR: EQT CHAP, LLC DESIGNATED AGENT: JOSEPH C. MALLOW

Address: 400 WOODCLIFF DRIVE Address: 427 MIDSTATE DRIVE

City: CANONSBURG State: PA Zip Code: 15317 City: CLARKSBURG State: WV Zip Code: 26301

HINES M01H

PAGE 2 OF 2

AS DRILLED PLAT

	SURFACE OWNER	DIST-TM/PAR
1	DONALD HINES ET UX	14-12/30
2	ARNIE N. GOODNIGHT ET UX	14-12/25
3	DAVID EDWARD KNUTH ET UX	14-12/27

	LESSOR	DIST-TM/PAR
A	DONALD HINES ET UX	14-12/30
B	LYNN ELLEN COOK	14-12/25
	WILLIAM F. RULONG	
	CHARLES BURTON RULONG	
	GARY MORRISON	
	ELIZABETH Y. MORRISON	
	ROGER GLEN RULONG	
	LIMESTONE PRESBYTERIAN CHURCH TRUSTEES	
	CLYDE DOWLER ET UX	
	DRU ELLA FOX	
	LAURA J. REYES	
	DALE FRANCIS FURBEE	
	HAROLD DEAN FURBEE	
	JOHN T. MORRIS	
	ETHEL M. RULONG	
	RICHARD J. RULONG	
ROBERT L. RULONG		
TERRY LEE RULONG		
TRACEY LYNN RULONG		
C	EULALIA MAE SIMMONS	14-12/27

AS-DRILLED LOCATIONS UTM 17-NAD83(M)
SURFACE HOLE LOCATION (SHL)
N:4417409.86 E:525699.32
APPROX LANDING POINT (LP)
N:N/A E:N/A
BOTTOM HOLE LOCATION (BHL)
N:4417535.38 E:525796.90

05/27/2022

THRASHER

THE THRASHER GROUP, INC.
600 WHITE OAKS BLVD.
BRIDGEPORT, WV 26330
PHONE 304-624-4108

* - DENOTES PARCEL WITHIN 30 FEET OF PLANNED WELL BORE

DECEMBER 13, 2021