

BHL is located on topo map 3,361 feet south of Latitude: 39° 55' 00"
 SHL is located on topo map 4,373 feet south of Latitude: 39° 55' 00"

SEE PAGE 2 FOR SURFACE OWNERS AND LESSORS

LINE	BEARING	DISTANCE
R1	S 00°49'04" E	227.18'
R2	S 19°56'29" W	223.81'
R3	S 63°37'54" W	174.84'
R4	N 77°21'39" E	2078.26'
R5	S 89°57'09" E	2337.22'
R6	S 65°32'24" E	1423.94'

NOTES:

1. There are no water wells or developed springs within 250' of proposed well.
2. Proposed well is greater than 100' from perennial stream, wetland, pond, reservoir or lake.
3. There are no native trout streams within 300' of proposed well.
4. Proposed well is greater than 1000' from surface groundwater intake or public water supply.
5. It is not the purpose or intention of this plat to represent surveyed locations of the surface or mineral parcels depicted hereon. The location of the boundary lines, as shown, are based on record deed descriptions, field evidence found and/or tax map position, unless otherwise noted.
6. There are no existing buildings within 625' of proposed well.

BHL is located on topo map 8,907 feet west of Longitude: 80° 40' 00"
 SHL is located on topo map 9,228 feet west of Longitude: 80° 40' 00"

WELL PAD ORIENTATION DETAIL

M01H	M14H	U15H	U28H
M02H	M13H	U18H	U27H
M03H	M12H	U17H	U26H
M04H	M11H	U16H	U25H
M05H	M10H	U15H	U24H
M06H	M09H	U14H	U23H
M07H	M08H	U13H	U22H
M08H	M07H	U12H	U21H
M09H	M06H	U11H	U20H
M10H	M05H	U10H	U19H
M11H	M04H	U09H	U18H
M12H	M03H	U08H	U17H
M13H	M02H	U07H	U16H
M14H	M01H	U06H	U15H

LEGEND

- ⊕ - TOPO MAP POINT
- ⊙ - WELL
- - ALL ARE POINTS UNLESS OTHERWISE NOTED
- MINERAL TRACT BOUNDARY
- PARCEL LINES
- WELL REFERENCE
- ROAD
- STREAM CENTER LINE
- Ⓐ - LESSORS
- Ⓛ - SURFACE OWNERS
- AS-DRILLED

GAS WELLS

- ⊙ - EXISTING WELLS
- ⊙ - PLUGGED WELLS

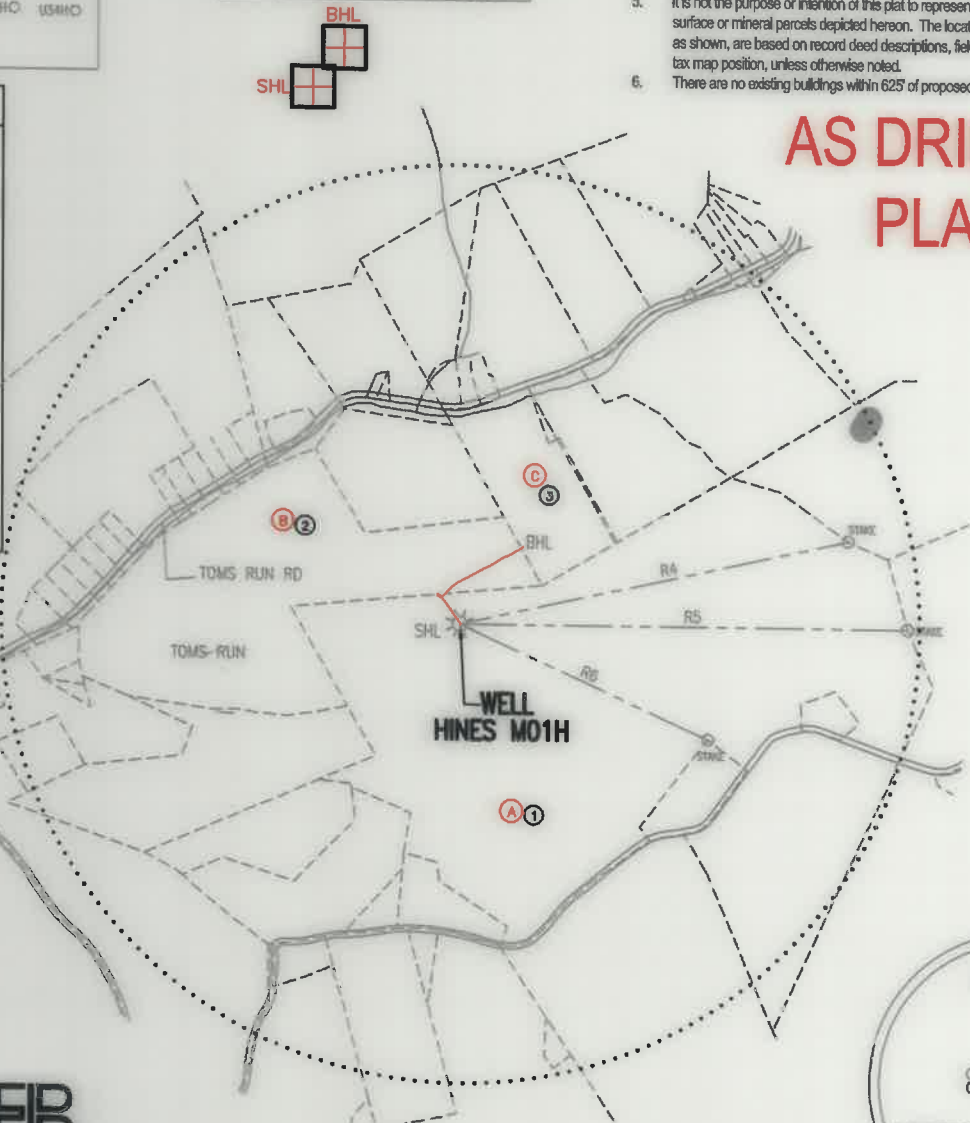

AS DRILLED PLAT

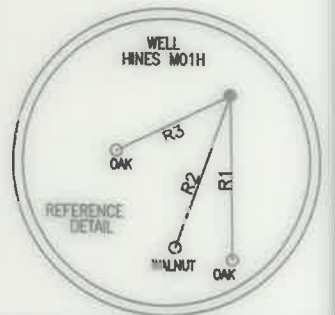

AS-DRILLED LOCATIONS UTM 17-WAD83(N)	
SURFACE HOLE LOCATION (SHL)	
N:4417409.86	E:525699.32
APPROX LANDING POINT (LP)	
N:N/A	E:N/A
BOTTOM HOLE LOCATION (BHL)	
N:4417535.38	E:525796.90

THRASHER

THE THRASHER GROUP, INC.
 600 WHITE OAKS BLVD.
 BRIDGEPORT, WV 26330
 PHONE 304-624-4108

FILE #: HINES M01H - AS DRILLED
 DRAWING #: HINES M01H - AS DRILLED
 SCALE: 1" = 1000'
 MINIMUM DEGREE OF ACCURACY: 1/2500
 PROVEN SOURCE OF ELEVATION: U.S.G.S. MONUMENT THOMAS 1498.81'

I, THE UNDERSIGNED, HEREBY CERTIFY THAT THIS PLAT IS CORRECT TO THE BEST OF MY KNOWLEDGE AND BELIEF AND SHOWS ALL THE INFORMATION REQUIRED BY LAW AND THE REGULATIONS ISSUED AND PRESCRIBED BY THE DEPARTMENT OF ENVIRONMENTAL PROTECTION.

Signed: *Joseph H. Lowther*
 R.P.E.: _____ L.L.S.: P.S. No. 2346



(+) DENOTES LOCATION OF WELL ON UNITED STATES TOPOGRAPHIC MAPS WVDEP
 OFFICE OF OIL & GAS
 601 57TH STREET
 CHARLESTON, WV 25304



DATE: DECEMBER 13, 2021
 OPERATOR'S WELL #: HINES M01H - AS DRILLED
 API WELL #: 47 51 2155
 STATE COUNTY PERMIT

Well Type: Oil Waste Disposal Production Deep Gas Liquid Injection Storage Shallow

WATERSHED: MIDDLE GRAVE CREEK-GRAVE CREEK ELEVATION: 1125.45'

COUNTY/DISTRICT: MARSHALL / WASHINGTON QUADRANGLE: MOUNDSVILLE, WV 7.5'

SURFACE OWNER: DONALD HINES ET UX ACREAGE: 114.934±

OIL & GAS ROYALTY OWNER: DONALD HINES ET UX ACREAGE: 163.51± 05/27/2022

DRILL CONVERT DRILL DEEPER REDRILL FRACTURE OR STIMULATE PLUG OFF OLD FORMATION

PERFORATE NEW FORMATION PLUG & ABANDON CLEAN OUT & REPLUG OTHER CHANGE

(SPECIFY): AS-DRILLED PLAT

TARGET FORMATION: MARCELLUS ESTIMATED DEPTH: TVD: 5,553± TMD: 5,619±

WELL OPERATOR: EQT CHAP, LLC DESIGNATED AGENT: JOSEPH C. MALLOW

Address: 400 WOODCLIFF DRIVE Address: 427 MIDSTATE DRIVE

City: CANONSBURG State: PA Zip Code: 15317 City: CLARKSBURG State: WV Zip Code: 26301

HINES M01H

PAGE 2 OF 2

AS DRILLED PLAT

	SURFACE OWNER	DIST-TM/PAR
1	DONALD HINES ET UX	14-12/30
2	ARNIE N. GOODNIGHT ET UX	14-12/25
3	DAVID EDWARD KNUTH ET UX	14-12/27

	LESSOR	DIST-TM/PAR
A	DONALD HINES ET UX	14-12/30
B	LYNN ELLEN COOK	14-12/25
	WILLIAM F. RULONG	
	CHARLES BURTON RULONG	
	GARY MORRISON	
	ELIZABETH Y. MORRISON	
	ROGER GLEN RULONG	
	LIMESTONE PRESBYTERIAN CHURCH TRUSTEES	
	CLYDE DOWLER ET UX	
	DRU ELLA FOX	
	LAURA J. REYES	
	DALE FRANCIS FURBEE	
	HAROLD DEAN FURBEE	
	JOHN T. MORRIS	
	ETHEL M. RULONG	
RICHARD J. RULONG		
ROBERT L. RULONG		
TERRY LEE RULONG		
TRACEY LYNN RULONG		
C	EULALIA MAE SIMMONS	14-12/27

AS-DRILLED LOCATIONS UTM 17-NAD83(M)
SURFACE HOLE LOCATION (SHL)
N:4417409.86 E:525699.32
APPROX LANDING POINT (LP)
N:N/A E:N/A
BOTTOM HOLE LOCATION (BHL)
N:4417535.38 E:525796.90

05/27/2022

THRASHER

THE THRASHER GROUP, INC.
600 WHITE OAKS BLVD.
BRIDGEPORT, WV 26330
PHONE 304-624-4108

* - DENOTES PARCEL WITHIN 30 FEET OF PLANNED WELL BORE

DECEMBER 13, 2021