

**KEITH STERN S LEASE
UTICA UNIT - 631.99 AC±
WELL 19HU
TUG HILL OPERATING**

T.H. LATITUDE 39°47'30"
B.H. LATITUDE 39°47'30"

T.H. LATITUDE 39°47'30"
B.H. LATITUDE 39°47'30"

(S.P.C. NORTH ZONE) (UTM(M) ZONE 17 NORTH)

NAD'83 S.P.C.(FT)	N. 466,555.46	E. 1,633,457.30
NAD'83 GEO.	LAT-(N) 39.774830	LONG-(W) 80.692080
NAD'83 UTM (M)	N. 4,402,811.38	E. 526,370.07

LANDING POINT

NAD'83 S.P.C.(FT)	N. 465,865.3	E. 1,635,205.1
NAD'83 GEO.	LAT-(N) 39.772999	LONG-(W) 80.685830
NAD'83 UTM (M)	N. 4,402,610.0	E. 526,906.1

BOTTOM HOLE

NAD'83 S.P.C.(FT)	N. 459,969.6	E. 1,638,437.2
NAD'83 GEO.	LAT-(N) 39.756931	LONG-(W) 80.674058
NAD'83 UTM (M)	N. 4,400,830.3	E. 527,920.7

T.H. LONGITUDE 80°40'00"
B.H. LONGITUDE 80°40'00"

MAP/PARCEL	ADJOINING SURFACE OWNER LIST	ACRES
9-13-11.1	SAMUEL & HEATHER SUHODOLSKI	0.49
9-13-14	MARGARET K. FOX - LIFE	3.00
9-14-1.1	MICHAEL L. ALVAREZ	1.6
9-14-1.2	KENNETH N. & TERESA A. SMERTNECK	1.02
9-14-2	MICHAEL L. ALVAREZ	0.75
9-14-3	MICHAEL L. ALVAREZ	NORTH P/O 3 PCLS
9-14-4	MICHAEL L. ALVAREZ	3 PCLS & 1/8 AC.
9-14-5	MICHAEL L. ALVAREZ	200 X 60 PCL
9-14-6	MICHAEL L. ALVAREZ	120 X 200 PCL
9-14-7	JOHN T. ERAZMUS, III	0.25
9-14-8	JOHNNY C. HOLCOMB & JOHNNY C. HOLCOMB, II	2/5 AC.
9-14-9	JOHN E. DUFFY, ET UX	2/5 AC.
9-14-10	ROBERT I. DUFFY - LIFE	25/100 AC.
9-14-11.1	PATRICK J. SCHELLHASE EST - TRUST	7.617
9-14-11.2	LOYE A. BLAKE	4.00
9-14-26	PATRICK J. SCHELLHASE EST - TRUST	12.588
9-14-27	PATRICK J. SCHELLHASE EST - TRUST	3.004
9-14-28	CHARLES R. SCHELLHASE, ET UX	3.029
9-14-45	GEORGE R. TAYLOR, ET UX	10.98
9-14-46.1	MARHA JANE FAZZARO	1.512
9-15-40	ROBERT WILLIAM BERISFORD	13.50
9-15-41	CHARLES RICHARD MCCOY, ET UX	4.50
9-15-42	ROBERT MATHEW MASON	2.63

T.H. A.D.

NOTES ON SURVEY

- NO WATER WELLS WERE FOUND WITHIN 250' OF PROPOSED GAS WELL. NO AGRICULTURAL BUILDINGS ≥ 2500 SQ. FT. OR DWELLINGS WERE FOUND WITHIN 625' OF THE CENTER OF PROPOSED WELL PAD.
- WELL SPOT CIRCLE & TOPO MARK SCALE ARE 1"=2000'
- PROPOSED LATERAL OR TOP HOLE OF KEITH STERN S-19HU IS WITHIN 3000' OF THE TOP HOLES OR LATERALS OF THE FOLLOWING: PROPOSED KEITH STERN N-13HU, 14HU, 15HU & 16HU, PROPOSED KEITH STERN S-17HU & 18HU, PROPOSED KNOB CREEK N-13HU, PROPOSED KNOB CREEK S-16HU, & PROPOSED HEAVEN HILL 3-6HU, AS-DRILLED DATA PROVIDED BY TUG HILL OPERATING, LLC.
- PLAT UPDATED TO SHOW AS-DRILLED PATH.

REFERENCES

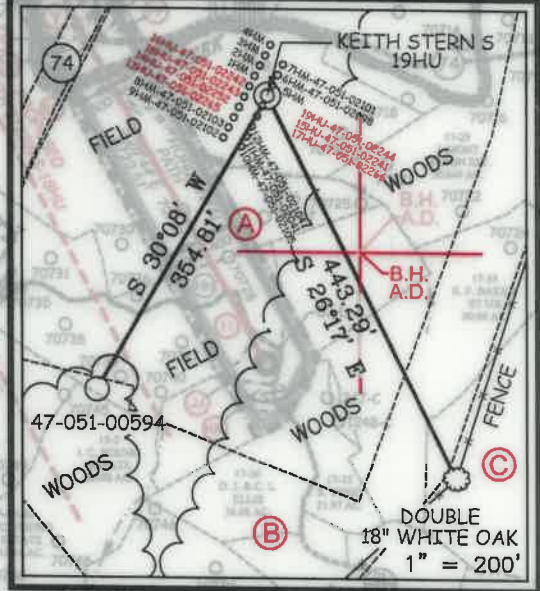

12,661' B.H. A.D.

AS DRILLED COORDINATES FOR WELL NO. 19HU

(S.P.C. NORTH ZONE) (UTM(M) ZONE 17 NORTH)

NAD'83 S.P.C.(FT)	N. 466,555.46	E. 1,633,457.30
NAD'83 GEO.	LAT-(N) 39.774830	LONG-(W) 80.692080
NAD'83 UTM (M)	N. 4,402,811.38	E. 526,370.07

LANDING POINT

NAD'83 S.P.C.(FT)	N. 465,865.3	E. 1,635,205.1
NAD'83 GEO.	LAT-(N) 39.772999	LONG-(W) 80.685830
NAD'83 UTM (M)	N. 4,402,610.0	E. 526,906.1

BOTTOM HOLE

NAD'83 S.P.C.(FT)	N. 459,969.6	E. 1,638,437.2
NAD'83 GEO.	LAT-(N) 39.756931	LONG-(W) 80.674058
NAD'83 UTM (M)	N. 4,400,830.3	E. 527,917.6

TAX	PARCEL	ACRES
A	TH EXPLORATION, LLC	10.05
B	TH EXPLORATION, LLC	10.05
C	TH EXPLORATION, LLC	10.05
D	TH EXPLORATION, LLC	10.05
E	TH EXPLORATION, LLC	10.05
F	TH EXPLORATION, LLC	10.05
G	TH EXPLORATION, LLC	10.05
H	TH EXPLORATION, LLC	10.05
I	TH EXPLORATION, LLC	10.05
J	TH EXPLORATION, LLC	10.05
K	TH EXPLORATION, LLC	10.05
L	TH EXPLORATION, LLC	10.05
M	TH EXPLORATION, LLC	10.05
N	TH EXPLORATION, LLC	10.05
O	TH EXPLORATION, LLC	10.05
P	TH EXPLORATION, LLC	10.05
Q	TH EXPLORATION, LLC	10.05
R	TH EXPLORATION, LLC	10.05
S	TH EXPLORATION, LLC	10.05
T	TH EXPLORATION, LLC	10.05
U	TH EXPLORATION, LLC	10.05
V	TH EXPLORATION, LLC	10.05
W	TH EXPLORATION, LLC	10.05
X	TH EXPLORATION, LLC	10.05
Y	TH EXPLORATION, LLC	10.05
Z	TH EXPLORATION, LLC	10.05
AA	MARGARET K. FOX - LIFE	3.00
BB	MICHAEL L. ALVAREZ	1.6
CC	KENNETH N. & TERESA A. SMERTNECK	1.02
DD	MICHAEL L. ALVAREZ	0.75
EE	MICHAEL L. ALVAREZ	NORTH P/O 3 PCLS
FF	MICHAEL L. ALVAREZ	3 PCLS & 1/8 AC.
GG	MICHAEL L. ALVAREZ	200 X 60 PCL
HH	MICHAEL L. ALVAREZ	120 X 200 PCL
II	JOHN T. ERAZMUS, III	0.25
JJ	JOHNNY C. HOLCOMB & JOHNNY C. HOLCOMB, II	2/5 AC.
KK	JOHN E. DUFFY, ET UX	2/5 AC.
LL	ROBERT I. DUFFY - LIFE	25/100 AC.
MM	PATRICK J. SCHELLHASE EST - TRUST	7.617
NN	LOYE A. BLAKE	4.00
OO	PATRICK J. SCHELLHASE EST - TRUST	12.588
PP	PATRICK J. SCHELLHASE EST - TRUST	3.004
QQ	CHARLES R. SCHELLHASE, ET UX	3.029
RR	GEORGE R. TAYLOR, ET UX	10.98
SS	MARHA JANE FAZZARO	1.512
TT	ROBERT WILLIAM BERISFORD	13.50
UU	CHARLES RICHARD MCCOY, ET UX	4.50
VV	ROBERT MATHEW MASON	2.63



I THE UNDERSIGNED, HEREBY CERTIFY THAT THIS PLAT IS CORRECT TO THE BEST OF MY KNOWLEDGE AND BELIEF AND SHOWS ALL THE INFORMATION REQUIRED BY LAW AND THE REGULATIONS ISSUED AND PRESCRIBED BY THE DIVISION OF ENVIRONMENTAL PROTECTION.

P.S. 849 *C. Victor Moyers*

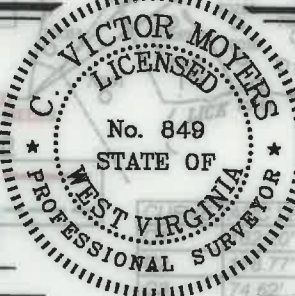

(+) DENOTES LOCATION OF WELL ON UNITED STATES TOPOGRAPHIC MAPS.

DATE JULY 9 20 20

REVISED _____ 20 _____

OPERATORS WELL NO. KEITH STERN S-19HU

API WELL NO. 47 - 051 - 2244

STATE STATE COUNTY COUNTY PERMIT PERMIT

MINIMUM DEGREE OF ACCURACY 1 / 2500

FILE NO. 8811P19HUAD.dwg

HORIZONTAL & VERTICAL CONTROL DETERMINED BY DGPS (SURVEY GRADE TIE TO CORS NETWORK)

SCALE 1" = 2000'

STATE OF WEST VIRGINIA
DIVISION OF ENVIRONMENTAL PROTECTION
OFFICE OF OIL AND GAS

WELL TYPE: OIL GAS INJECTION WASTE DISPOSAL "GAS" PRODUCTION STORAGE DEEP SHALLOW

LOCATION: GROUND = 745.00' PROPOSED = 744.65'

DISTRICT MEADE COUNTY MARSHALL QUADRANGLE GLEN EASTON 7.5'

SURFACE OWNER TH EXPLORATION, LLC ACREAGE 10.05±

ROYALTY OWNER ISAAC CROW, ET AL - SEE WW-8A1 ACREAGE 10.05±

PROPOSED WORK: DRILL CONVERT DRILL DEEPER REDRILL FRACTURE OR STIMULATE PLUG AND ABANDON CLEAN OUT AND REPLUG OTHER

PHYSICAL CHANGE IN WELL (SPECIFY) 2244 TARGET FORMATION POINT PLEASANT

ESTIMATED DEPTH TVD: 11,404' / TMD: 18,538'

WELL OPERATOR TUG HILL OPERATING, LLC ADDRESS 1320 SOUTH UNIVERSITY DRIVE, SUITE 500 FORT WORTH, TX 76107

DESIGNATED AGENT DIANNA STAMPER CT CORPORATION SYSTEM ADDRESS 5400 D BIG TYLER ROAD CHARLESTON, WV 25313

COUNTY NAME PERMIT

**KEITH STERN S LEASE
UTICA UNIT - 631.99 AC ±
WELL 19HU
TUG HILL OPERATING**



12 Vanhorn Drive | P.O. Box 150 | Glenville, WV 26351 | 304.462.5634
1412 Kanawha Boulevard, East | Charleston, WV 25301 | 304.346.3952
254 East Beckley Bypass | Beckley, WV 25801 | 304.255.5296
slsvw.com

NO.	Lease ID	Tag	Parcel	Grantor, Lessor, Etc.	Deed Book/Page
1	10*15605	A	9-14-24.1	ISAAC CROW ET UX	74 394
2	10*15605	B	9-14-24	ISAAC CROW ET UX	74 394
3	10*15509	C	9-14-20	WILLIAM K STERN AND BETTY L STERN	718 320
4	10*23458	D	WV - FISH CREEK	WEST VIRGINIA DIVISION OF NATURAL RESOURCES	1019 373
5	10*15812	E	9-14-23	WILLIAM K STERN AND BETTY L STERN	687 220
6	10*16436	E	9-14-23	REAGAN D YEATTS AND CHRISTOPHER M YEATTS	961 339
7	10*18269	E	9-14-23	GENELDA MASON	942 460
8	10*18299	E	9-14-23	CAROL L BOBBY AND DONALD J BOBBY	929 281
9	10*18354	E	9-14-23	DEBORAH L TURLEY	931 352
10	10*18355	E	9-14-23	JUDITH F TEMPLE AND LOUIS I TEMPLE	931 350
11	10*18356	E	9-14-23	LARRY W ALLEY	931 348
12	10*18357	E	9-14-23	DEBORAH SUE KYLE	931 346
13	10*18358	E	9-14-23	SHARLA ROLLINS AND GARY ROLLINS	931 358
14	10*18419	E	9-14-23	CARLA MAE ALLEY	932 539
15	10*18420	E	9-14-23	VICTOR E ALLEY JR AND DEBRA A ALLEY	932 582
16	10*18421	E	9-14-23	DONNA JUNE STRAIT AND GARY E STRAIT	932 588
17	10*18429	E	9-14-23	GEORGE L DUNN AND NANCY MARIE DUNN	932 601
18	10*18430	E	9-14-23	JAMES DUNN AND DONNA K DUNN	932 604
19	10*18432	E	9-14-23	ROSEMARIE BERISFORD	932 572
20	10*18484	E	9-14-23	BRENDA REED	933 107
21	10*18485	E	9-14-23	BARBARA JO BEVERIDGE	933 109
22	10*18490	E	9-14-23	STACY L BARNHART	933 123
23	10*18491	E	9-14-23	LORI A FARMER AND DANIEL K FARMER	933 131
24	10*18512	E	9-14-23	CHRISTINA NESTELL AND CHARLES E NESTELL III	933 565
25	10*18515	E	9-14-23	WILLIAM P DAUBE	933 573
26	10*18518	E	9-14-23	SUSAN I BAKER	933 580
27	10*18520	E	9-14-23	CHRISTOPHER SAUDERS	933 584
28	10*18612	E	9-14-23	NANNETTE BERLETCH	932 542
29	10*18617	E	9-14-23	SHEILA SIMMONS AND JEFFREY R SIMMONS	934 613
30	10*18644	E	9-14-23	FRANK A STORCH JR AND SUSAN STORCH	936 149
31	10*18645	E	9-14-23	SANDRA SUE HALL AND DAVID HALL	936 155
32	10*18647	E	9-14-23	PETER G STORCH AND LAURIE L STORCH	936 152
33	10*18648	E	9-14-23	LAWRENCE E CHIAPPETTA AND PATRICIA A CHIAPPETTA	936 161
34	10*18649	E	9-14-23	RODNEY K BANE AND CATHIE J BANE	936 164
35	10*18652	E	9-14-23	BECKY LANDRIS	936 172
36	10*18653	E	9-14-23	DALE R ALLEY	936 174
37	10*18673	E	9-14-23	RACHEL THORNE AND FRED THORNE JR	938 574
38	10*18674	E	9-14-23	JOHN T CRISWELL AND CATHERINE A CRISWELL	938 579
39	10*18675	E	9-14-23	JEFFREY BRYAN CRISWELL	938 582
40	10*18676	E	9-14-23	JENNIFER SHAWN GLOVER	938 576
41	10*18677	E	9-14-23	PATRICIA DOFKA	938 585
42	10*18678	E	9-14-23	WILLIAM LINSLEY CRISWELL	938 588
43	10*18763	E	9-14-23	VAUGHN HONE SR & LINDA MARIE HONE	938 225
44	10*18766	E	9-14-23	TOM ALLEY	938 223
45	10*18797	E	9-14-23	DORRETTA RUSH	937 622
46	10*18808	E	9-14-23	PATRICIA KIRCHNER	937 644
47	10*18809	E	9-14-23	JUDITH C LORADITCH	937 647
48	10*19392	E	9-14-23	RODNEY W RUSH AND CRYSTAL D RUSH	940 336
49	10*19400	E	9-14-23	BULA F YOST	940 342
50	10*19405	E	9-14-23	ANN MARIE STEVENS AND CURTIS STEVENS	939 287
51	10*19417	E	9-14-23	SYLVIA R SPALENY AND ROBERT A SPALENY	939 595
52	10*19423	E	9-14-23	KEITH W STORCH AND DEBORAH A STORCH	934 600
53	10*19477	E	9-14-23	DEBORAH A MILLER	941 320
54	10*19479	E	9-14-23	DENISE WILLIAMSON	941 329
55	10*19510	E	9-14-23	REED O MILLER	933 571
56	10*19525	E	9-14-23	AUGUSTUS R MCMAHON III AND MICHELE M MCMAHON TRUSTEES OF THE AUGUSTUS R MCMAHON III LIVING TRUST	943 509
57	10*19527	E	9-14-23	AUGUSTUS RUSH MCMAHON III TRUSTEE OF THE PAMELA J MCMAHON REVOCABLE TRUST	953 339
58	10*19530	E	9-14-23	SHAROL K CASADA	943 1
59	10*19531	E	9-14-23	DELBERT D RUSH AND BETTY RUTH RUSH	942 615
60	10*19625	E	9-14-23	DURR SUCKEL & ELIZABETH SUCKEL	944 150
61	10*19626	E	9-14-23	LAURIE R BROWN	944 153
62	10*19676	E	9-14-23	RONALD W REINBEAU	944 456
63	10*19677	E	9-14-23	NEIL SCHAFER AND CHRISTAL L SHAFER	944 147
64	10*19681	E	9-14-23	TIMOTHY LEE COLLEY	944 140
65	10*19683	E	9-14-23	TERESA ALLEY	944 145
66	10*19686	E	9-14-23	KAREN J AND MICHAEL E BRUGGEMAN	944 142
67	10*19712	E	9-14-23	CHAZ AARON COLLEY AND DANA COLLINS	957 139
68	10*19723	E	9-14-23	REID ELATTRACHE AND TONYA ELATTRACHE	957 131
69	10*19859	E	9-14-23	ELIZABETH A STARC	945 603
70	10*19860	E	9-14-23	ALICIA N STARC	945 601
71	10*19861	E	9-14-23	JOSEPH F STARC JR AND DONNA STARC	945 605
72	10*19862	E	9-14-23	STACY R BENNETT	945 608
73	10*19864	E	9-14-23	JOE Y KELLER JR AND SHARON MARIE KELLER	945 610
74	10*19935	E	9-14-23	SARA E STARC	948 553
75	10*19936	E	9-14-23	SHERWOOD MASON NILA JUNE MASON	948 255
76	10*19940	E	9-14-23	EMMA JO CRISWELL	948 551
77	10*21028	E	9-14-23	BRENDA GILBERT	951 159
78	10*21094	E	9-14-23	KATHERINE DEGROOT AND DANIEL DEGROOT	951 151
79	10*21111	E	9-14-23	DONNA G AND PAUL L CHMELYSKI	951 154
80	10*21209	E	9-14-23	CHARLES R WILLIAMSON JR	951 157
81	10*21228	E	9-14-23	CHARLES F HORNER & LORRAINE G HORNER	952 434
82	10*21229	E	9-14-23	TARA E CAUSEY	952 432
83	10*21395	E	9-14-23	DANIEL L LANDRIS AND JOAN L LANDRIS	956 625
84	10*21396	E	9-14-23	MICHAEL D ZUCKER	956 647
85	10*21441	E	9-14-23	JOSEPH A MURPHY AND VIRGINIA ANNE MURPHY	956 631
86	10*21443	E	9-14-23	ROBERT L LANDRIS AND LIBERTY JANE LANDRIS	956 628
87	10*21490	E	9-14-23	DANIEL E WILLIAMSON AND HEATHER R WILLIAMSON	957 153
88	10*21493	E	9-14-23	DENZIL ALLEY JR	958 64
89	10*21497	E	9-14-23	KATHLEEN G WILLIAMSON	957 324
90	10*21837	E	9-14-23	WILLIAM BRYAN COLLEY	959 627
91	10*21873	E	9-14-23	MICHAEL WAYNE ALLEY AND LINDA ALLEY	953 501
92	10*21961	E	9-14-23	JOHN WILLIAMSON JR	960 24
93	10*21972	E	9-14-23	CATHERINE I AND ERNEST M SILVERIO	960 586
94	10*21979	E	9-14-23	CHARLES C SEAMON	954 340
95	10*21991	E	9-14-23	THE JOANN REILLY TRUST KIMBERLY MAEZ TRUSTEE	953 341
96	10*21997	E	9-14-23	MICHAEL SAUDERS AND AMI SAUDERS	953 505
97	10*22004	E	9-14-23	RALPH EDWARD WILLIAMSON	953 507
98	10*22037	E	9-14-23	JOSHUA W SEAMON	953 503

RECEIVED
Office of Oil and Gas

SEP 30 2022

WV Department of
Environmental Protection

FILE NO. 8811P19HUAD.dwg
KEITH STERN S-19HU-REV1
DATE JULY 9, 20 20
REVISED _____, 20 _____
OPERATORS WELL NO. KEITH STERN S-19HU
API WELL NO. 47 — 051 — 2244
STATE COUNTY PERMIT

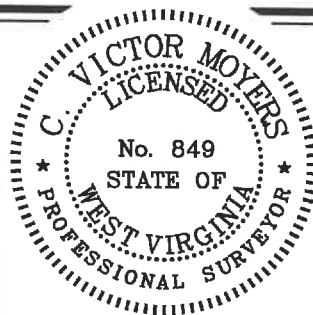

STATE OF WEST VIRGINIA
DIVISION OF ENVIRONMENTAL PROTECTION
OFFICE OF OIL AND GAS



P.S. 849

C. Victor Moyers

COUNTY NAME _____
PERMIT _____

WELL OPERATOR TUG HILL OPERATING, LLC
ADDRESS 1320 SOUTH UNIVERSITY DRIVE, SUITE 500
FORT WORTH, TX 76107

DESIGNATED AGENT DIANNA STAMPER
ADDRESS CT CORPORATION SYSTEM
5400 D BIG TYLER ROAD
CHARLESTON, WV 25313

KEITH STERN S LEASE
UTICA UNIT - 631.99 AC ±
WELL 19HU
TUG HILL OPERATING



12 Vanhorn Drive | P.O. Box 150 | Glenville, WV 26351 | 304.462.5634
1412 Kanawha Boulevard, East | Charleston, WV 25301 | 304.346.3952
254 East Beckley Bypass | Beckley, WV 25801 | 304.255.5296
slswv.com

Table with columns for well ID, acreage, status, date, owner name, and acreage. Lists various well owners and their associated acreage for well 19HU.

RECEIVED
Office of Oil and Gas
SEP 30 2022
WV Department of
Environmental Protection

FILE NO. 8811P19HUAD.dwg
KEITH STERN S-19HU-REV1
DATE JULY 9, 20 20
REVISED, 20
OPERATORS WELL NO. KEITH STERN S-19HU
API WELL NO. 47 - 051 - 2244
NO. STATE COUNTY PERMIT

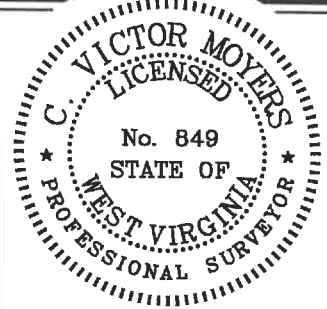

STATE OF WEST VIRGINIA
DIVISION OF ENVIRONMENTAL PROTECTION
OFFICE OF OIL AND GAS
10/21/2022
P.S. 849
C. Victor Moyers

COUNTY NAME
PERMIT

WELL OPERATOR TUG HILL OPERATING, LLC ADDRESS 1320 SOUTH UNIVERSITY DRIVE, SUITE 500 FORT WORTH, TX 76107
DESIGNATED AGENT DIANNA STAMPER CT CORPORATION SYSTEM ADDRESS 5400 D BIG TYLER ROAD CHARLESTON, WV 25313

KEITH STERN S LEASE
UTICA UNIT - 631.99 AC ±
WELL 19HU
TUG HILL OPERATING



12 Vanhorn Drive | P.O. Box 150 | Glenville, WV 26351 | 304.462.5634
1412 Kanawha Boulevard, East | Charleston, WV 25301 | 304.346.3952
254 East Beckley Bypass | Beckley, WV 25801 | 304.255.5296
slswv.com

Table with 7 columns: ID, Well ID, Status, Date, Name, ID, ID. Lists leaseholders and their associated well IDs and status.

RECEIVED
Office of Oil and Gas
SEP 30 2022
WV Department of
Environmental Protection

FILE NO. 8811P19HUAD.dwg
KEITH STERN S-19HU-REV1
DATE JULY 9, 20 20
REVISED, 20
OPERATORS WELL NO. KEITH STERN S-19HU
API WELL NO. 47 — 051 — 2244
STATE COUNTY PERMIT

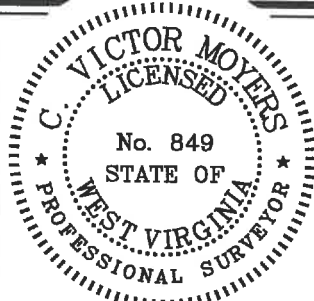

STATE OF WEST VIRGINIA
DIVISION OF ENVIRONMENTAL PROTECTION
OFFICE OF OIL AND GAS
10/21/2022

P.S. 849 *C. Victor Moyers*

WELL OPERATOR TUG HILL OPERATING, LLC ADDRESS 1320 SOUTH UNIVERSITY DRIVE, SUITE 500 FORT WORTH, TX 76107
DESIGNATED AGENT DIANNA STAMPER CT CORPORATION SYSTEM ADDRESS 5400 D BIG TYLER ROAD CHARLESTON, WV 25313

COUNTY NAME
PERMIT

KEITH STERN S LEASE
UTICA UNIT - 631.99 AC ±
WELL 19HU
TUG HILL OPERATING



12 Vanhorn Drive | P.O. Box 150 | Glenville, WV 26351 | 304.462.5634
1412 Kanawha Boulevard, East | Charleston, WV 25301 | 304.346.3952
254 East Beckley Bypass | Beckley, WV 25801 | 304.255.5296
slsw.com

Table with columns for well ID, acreage, status, date, owner name, and acreage. Contains 1096 rows of lease data.

RECEIVED
Office of Oil and Gas
SEP 30 2022
WV Department of
Environmental Protection

FILE NO. 8811P19HUAD.dwg
KEITH STERN S-19HU-REV1
DATE JULY 9, 20 20
REVISED, 20
OPERATORS WELL NO. KEITH STERN S-19HU
API WELL NO. 47 — 051 — 2244
STATE COUNTY PERMIT

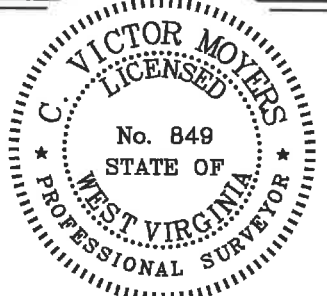

STATE OF WEST VIRGINIA
DIVISION OF ENVIRONMENTAL PROTECTION
OFFICE OF OIL AND GAS
10/21/2022

P.S. 849 C. Victor Moyers

WELL OPERATOR TUG HILL OPERATING, LLC ADDRESS 1320 SOUTH UNIVERSITY DRIVE, SUITE 500 FORT WORTH, TX 76107
DESIGNATED AGENT DIANNA STAMPER CT CORPORATION SYSTEM ADDRESS 5400 D BIG TYLER ROAD CHARLESTON, WV 25313

COUNTY NAME PERMIT