

HILLROCK LEASE WELL S-15HU 635.5719± ACRES

TOP HOLE LATITUDE: 39°45'00"

BOTTOM HOLE LATITUDE: 39°45'00"

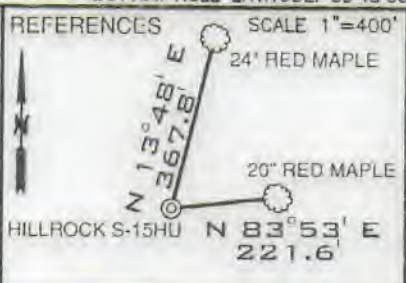
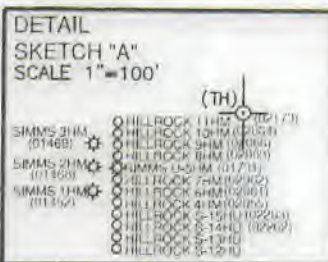

GRID NORTH

NOTES

- BORE PATH BASED ON GRID NORTH
- NO WELL OR WELLS WITHIN 250' OF WELL WERE FOUND; NO LATERALS WITHIN 625' OF PAD CENTER UNLESS OTHERWISE INDICATED
- OWNER DEED TAKEN FROM PUBLIC RECORDS OF MARSHALL COUNTY, WV IN MARCH 2019. COORDINATE SYSTEM WITH THIS PLAT IS BASED UPON THE FEDERAL GPS MEASUREMENTS.
- WELL LOCATION REFERENCE ARE BASED UPON THE MAGNETIC MERIDIAN.
- ALL DEEP WELLS SHOWN ON THIS PLAT.

LINE	BEARING	DISTANCE
L1	N 32°48' W	2088.64'
L2	S 33°04' E	1890.22'
L3	S 84°03' E	1234.89'
L4	S 77°56' E	1758.41'

LEGEND

- LEASE TRACTS
- SURFACE TRACTS
- WELL LATERAL
- POINT PLEASANT LEGS
- UNIT BOUNDARY
- (A) LEASE # (SEE 6A1 FORM)
- 400' BORE PATH OFFSET
- 500' WELL BORE OFFSET

CURVE	CHORD BEARING	CHORD LENGTH	RADIUS	ARC LENGTH
C1	S 81°00' E	48.45'	448.88'	48.47'
C2	S 68°24' E	84.37'	289.28'	84.67'
C3	S 53°51' E	152.61'	677.36'	152.93'
C4	S 41°48' E	285.87'	1285.05'	286.46'
C5	S 32°31' E	267.91'	2124.03'	268.09'

(*) DENOTES LOCATION ON UNITED STATES TOPOGRAPHIC MAPS

SURFACE HOLE
UTM, NAD83, ZONE 17
IN METERS
N) 4,399,573.47
E) 519,682.83

LANDING POINT 1
UTM, NAD83, ZONE 17
IN METERS
N) 4,399,267.41
E) 520,764.23

BOTTOM HOLE
UTM, NAD83, ZONE 17
IN METERS
N) 4,397,286.48
E) 521,907.91

I, THE UNDERSIGNED, HEREBY CERTIFY THAT THIS PLAT IS CORRECT TO THE BEST OF MY KNOWLEDGE AND BELIEF AND SHOWS ALL THE INFORMATION REQUIRED BY LAW AND THE RULES ISSUED AND PRESCRIBED BY THE DEPARTMENT OF ENVIRONMENTAL PROTECTION

David L Jackson

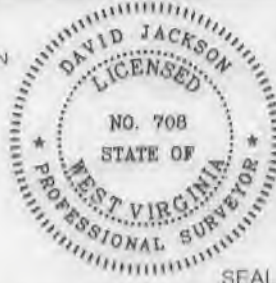

FILE NUMBER _____
DRAWING NUMBER: HILLROCK_S-15HU_REV 1
SCALE: 1" = 2000'
MINIMUM DEGREE OF ACCURACY: 1/200
PROVEN SOURCE OF ELEVATION: SUBMETER MAPPING
GRADE GPS

JACKSON SURVEYING INC.
P.O. Box 1460
Charleston, WV 26302
304-623-5851

WVDEP
OFFICE OF OIL & GAS
601 57TH STREET, SE
CHARLESTON, WV 25304

DATE: AUGUST 07, 2019
REVISED DATE: SEPTEMBER 14, 2020
OPERATORS WELL NO. HILLROCK S-15HU
API WELL NO. 47-051-02263 ^{Deep} _{MOD}
STATE WV COUNTY MARSHALL PERMIT _____

LOCATION ELEVATION 1219.5' WATERSHED (HUC 10) FISH CREEK
DISTRICT FRANKLIN COUNTY MARSHALL
QUADRANGLE NEW MARTINSVILLE 7.5' LEASE NUMBER SEE WW-6A1 Form

SURFACE OWNER TERRY E. & DEBORAH SIMMS ACREAGE 123.09
OIL & GAS ROYALTY OWNER TERRY E. & DEBORAH L. SIMMS, ET AL LEASE ACREAGE 123.09
PROPOSED WORK: DRILL CONVERT DRILL DEEPER REDRILL FRACTURE OR STIMULATE PLUG OFF OLD FORMATION
PERFORATE NEW FORMATION OTHER PHYSICAL CHANGE (SPECIFY) _____
PLUG & ABANDON CLEAN OUT & REPLUG
TARGET FORMATION POINT PLEASANT ESTIMATED DEPTH TVD: 11,527' TMD: 19,880'
WELL OPERATOR TUG HILL OPERATING, LLC DESIGNATED AGENT DIANNA STAMPER
CT CORPORATION SYSTEM
ADDRESS 1320 SOUTH UNIVERSITY DRIVE, SUITE 500 ADDRESS 5400 D BIG TYLER ROAD
FORT WORTH, TX 76107 CHARLESTON, WV 25313

COUNTY NAME

PERMIT

**HILLROCK LEASE
WELL S-15HU
635.5719± ACRES**

Number	TAX MAP-PARCEL	SURFACE OWNER	ACRES
S1	05-24-5.4	Thomas V. Tuttle, et ux	38.224
S2	05-24-5.3	Thomas V. Tuttle, et ux	8.543
S3	05-25-01	Michael L. Mason	35.43
S4	05-25-13	William M. Ferda, Jr. & Stephanie Palicka	16.014
S5	05-25-13.2	David A. Klug	5.89
S6	05-25-12.1	Kent & Betty Mason	15.0
S7	05-25-12	Marion Parsons Jr., et al	85.16
S8	05-25-11.4	Edward W. Klug, et ux	32.787
S9	05-25-11.2	James W. Klug	114.305
S10	05-25-11.1	Edward W. Klug & Dianna Klug	2.343
S11	12-03-44	James A. & Jo C. Estep	1.10
S12	12-03-47	Wetzal County Emergency Ambulance	0.50
S13	12-03-43	Adam W. Ferrell & Brittany M. Loy	1.97
S14	12-03-42	J. M. Klug	2.617
S15	05-23-06	James A. Channing, et al	48.0
S16	05-18-21	Curtis E. & Michelle J. Hall	43.119
S17	05-18-20	Wayne E. Channing, et al	75.60
S18	05-18-31	Kenneth E. Rastall	6.94
S19	05-18-32	Kenneth E. Rastall	5.335
S20	05-17-12	James A. & Jill C. Corley	3.33
S21	05-17-12.1	Williams Ohio Valley Midstream, LLC	1.67
S22	05-17-10	James A. Corley, et al	92.61
S23	05-17-9.3	James A. Corley, et ux	12.478
S24	05-17-9.4	Vicki L. Bowen	60.3
S25	05-24-1	Linda L. Hendrickson & Donald Ray Pickering	175.0
S26	05-24-5.2	James D. Watkins, et ux	3.151
S27	05-24-5.1	James D. Watkins, et ux	4.60
S28	05-23-7.1	Lisa Ann Nelson	0.549
S29	05-23-7.2	Lisa Ann Nelson	6.354
S30	05-24-5.5	Linda Lou Tagg	17.194
S31	05-24-5	Robert C. Francis et ux (Life)	145.788
S32	05-24-3.2	T.H. Exploration II, LLC	49.0
S33	05-24-3.1	T.H. Exploration II, LLC	5.50
S34	05-25-2.2	John G. Klug, Sr. et ux	10.0
S35	05-25-2	James W. Klug	122.3
S36	05-25-2.1	Nancy Jackson	1.0
S37	05-25-3	S.D. Fertitta, et ux	181.548
S38	05-25-3.1	S.D. Fertitta, et ux	3.022
S39	05-25-14.1	Judith L. Weigand	65.0
S40	05-24-04	Terry E. Simms, et ux	84.05
S41	05-25-1.4	Samantha J. & Philip A. Namluk	24.44
S42	05-25-1.3	Michael E. & Annie A. Chapman	26.2
S43	05-25-1.2	William Jr. & Andrea J. Dubiel	20.10
S44	05-25-1.1	Ryan A. & Jacqueline E. Layman	9.79
S45	05-25-13.3	William M. Sr. & Cynthia A. Ferda	17.21

Number	TAX MAP-PARCEL	SURFACE OWNER	ACRES
S46	05-25-1.5	Ryan J. Bratton	21.35
S47	05-25-10	Terry L. & Tammy J. Kirkland as Trustees of the Terry L. & Tammy J. Kirkland Living Trust	18.75
S48	05-25-10.1	Terry L. & Tammy J. Kirkland (Life)	5.250
S49	12-03-41	Carl L. Kirkland	4.102
S50	12-03-41.1	Terry L. & Tammy J. Kirkland as Trustees of the Terry L. & Tammy J. Kirkland Living Trust	74.138
S51	12-03-04	Albert L. & Mary Hohman et al	85.0
S52	12-03-02	Robert Lee & Diana G. Smith	2.48
S53	12-03-4.3	Joseph P. & Barbara A. Cain	3.619
S54	12-03-4.6	Steven P. Wayman	1.009
S55	12-03-4.5	Hazel M. Blair	0.451
S56	12-03-01	James W. Klug	0.375
S57	12-03-4.7	Joseph P. & Barbara A. Cain	67.3
S58	12-02-14	David L. Cunningham	56.23
S59	12-02-14.2	John G. Jr. & Geraldine M. Rogers	25.1
S60	12-02-14.1	Sammy J. Greathouse, Jr. Sammy J. Greathouse, Sr. (L/E)	18.67
S61	05-25-16.1	David L. Cunningham	6.34
S62	05-25-16.2	Rodney J. Loy	1.087
S63	05-25-13.4	Parsons Cemetery	0.38
S64	05-25-14	Roy F. Yoho	23.0
S65	05-25-16	Craig R. & Ashley Ferrell	23.5
S66	05-25-17	Craig R. & Ashley Ferrell	22.790
S67	05-25-18	Joseph Johnson, et ux (Life)	37.746
S68	05-25-19	Joseph Johnson, et ux (Life)	1.973
S69	05-25-20.3	James A. & Jo C. Estep	4.49
S70	05-25-20.2	James M. Zombotti	1.347
S71	05-25-20.1	James M. Zombotti	2.746
S72	05-23-11	Roy F. Yoho	9.475
S73	05-23-11.7	Bryan L. Huggins	1.835
S74	05-23-11.5	Roy F. Yoho	2.25
S75	05-23-11.3	Colin R. Yoho	11.29
S76	05-23-11.6	T.H. Exploration II, LLC & Atinum Marcellus I, LLC	0.094
S77	05-23-11.2	Evelyn Hudson	1.154
S78	05-23-11.4	Evelyn Hudson	10.879
S79	05-23-11.1	John H. & Sonya D. Holliday	46.482
S80	05-23-13.1	James R. & Pamela J. Ferrell	0.7625
S81	05-23-12	Mark A. Yoho	3.05
S82	05-23-13	Linda D. Greathouse	14.24
S83	05-23-9.1	John W. Van Orden et ux	23.376
S84	05-23-9.2	Linda D. Greathouse	25.58
S85	05-23-9.4	Jackson R. Sr. & Deanna L. Davis	2.087
S86	05-23-9.3	Linda D. Greathouse	17.5
S87	05-23-14	Dominion Transmission, Inc.	59.5
S88	05-23-08	Carl David & Suzanne L. Guseman	29.5
S89	05-23-8.1	William & Virginia Roupe	34.0
S90	05-23-11.8	Zachary R. Stevey	7.0



P.S. 708 *David L Jackson*



OPERATOR'S
WELL #: HILLROCK S-15HU
DISTRICT: Franklin
COUNTY: Marshall
STATE: WV
API: 047-051-02263 **MDD**
Deep Well

WELL PLAT
PAGE 2 OF 3
DATE: 08/07/2019
REVISED DATE:
9/14/2020

**HILLROCK LEASE
WELL S-15HU
635.5719± ACRES**

Lease ID	Tags	Parcel	Grantor, Lessor, Etc.	Deed Book	Page
10*14140	A	5-23-7	TERRY E SIMMS AND DEBORAH L SIMMS	666	529
10*14126	B	5-17-11	SHARON MIDCAP	697	152
10*14126	C	5-17-11.1	SHARON MIDCAP	697	152
10*14138	D	5-24-1	LINDA AND DONALD HENDRICKSON	666	528
10*14130	E	5-23-7.1	JANE ELLEN MARCUM ET AL	708	185
10*14797	F	5-24-5.1	ORVILLE YOUNG ET AL	800	598
10*14797	G	5-24-5.2	ORVILLE YOUNG ET AL	800	598
10*14130	H	5-23-7.2	JANE ELLEN MARCUM ET AL	708	185
10*14797	I	5-24-5.5	ORVILLE YOUNG ET AL	800	598
10*14797	J	5-24-5	ORVILLE YOUNG ET AL	800	598
10*14558	K	5-24-6	KLOVA ANN MORRIS ET AL	765	434
10*14462	L	5-24-4	JERRY ELDON RICHMOND ET AL	744	57
10*14786	M	5-25-20	TWILA O WHIPKEY EL AL	799	61
10*14728	N	5-25-1.4	IRIS K MOELLENDICK ET AL	839	509
10*14068	O	5-24-3.1	ROHN JEAN MARTIN ET AL	666	552
10*14525	P	5-25-2.2	IMA LEE YOHO	757	192
10*14728	Q	5-25-1.3	IRIS K MOELLENDICK ET AL	839	509
10*14661	R	5-25-1.2	ANDREA & WILLIAM DUBIEL JR ET AL	777	563
10*14728	S	5-25-1.1	IRIS K MOELLENDICK ET AL	839	509
10*14728	T	5-25-1	IRIS K MOELLENDICK ET AL	839	509
10*14728	U	5-25-13	IRIS K MOELLENDICK ET AL	839	509
10*14728	V	5-25-1.5	IRIS K MOELLENDICK ET AL	839	509
10*14664	W	5-25-13.3	CHRISTINA L MILLER ET AL	779	496
10*14525	X	5-25-2	IMA LEE YOHO	757	192
10*14525	Y	5-25-2.1	IMA LEE YOHO	757	192
10*14524	Z	5-25-3	IMA LEE YOHO	757	194
10*14926	AA	5-25-12	NILA JUNE MASON ET AL	842	394
10*18120	BB	5-25-12.1	KENT & BETTY MASON	927	75
10*22496	CC	5-25-11.2	JAMES W KLUG	923	543
10*22984	DD	12-3-47	WETZEL COUNTY EMERGENCY AMBULANCE AUTHORITY INC	209A	748
10*24576	EE	12-3-43	ADAM W FERRELL AND BRITTANY M FERRELL	218A	837
10*22496	FF	12-3-42	JAMES W KLUG	923	543



P.S. David L Jackson
708



TUG HILL
OPERATING

OPERATOR'S
WELL #: HILLROCK S-15HU
DISTRICT: Franklin
COUNTY: Marshall
STATE: WV
API: 047-051-02263 MID
Deep Well

WELL PLAT
PAGE 3 OF 3
DATE: 08/07/2019
REVISED DATE:
9/14/2020