

MCMASTERS LEASE
WELL N-11HU
608.7765± ACRES

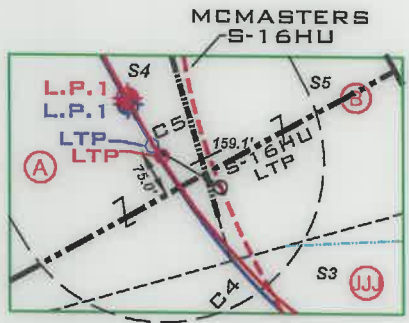

(+)DENOTES LOCATION ON UNITED STATES TOPOGRAPHIC MAPS

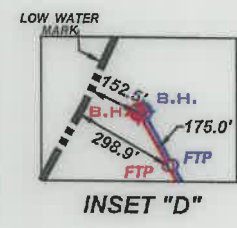
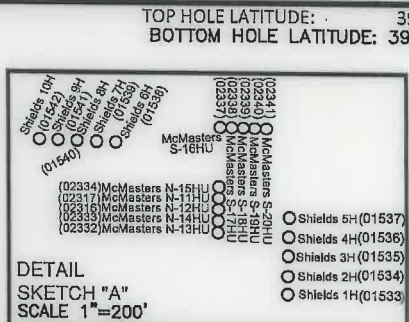
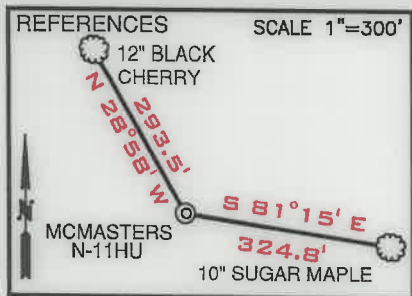
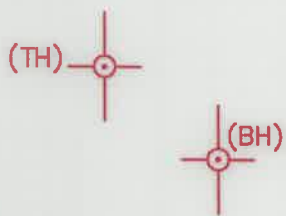

LINE	BEARING	DISTANCE
L1	N 71°01' W	1424.78'
L2	S 41°00' W	1285.15'
L3	S 47°39' W	1509.71'

SURFACE HOLE	
UTM. NAD83, ZONE 17 IN METERS	
N)	4,401,152.77
E)	518,196.99
LANDING POINT 1	
UTM. NAD83, ZONE 17 IN METERS	
N)	4,400,942.91
E)	517,583.81
BOTTOM HOLE	
UTM. NAD83, ZONE 17 IN METERS	
N)	4,405,476.62
E)	514,976.37

- NOTES
- BORE PATH BASED ON GRID NORTH.
 - NO WATER WELLS WITHINS 130 250' OF WELL WERE FOUND. NO DWELLINGS WITHIN 825' OF PAD CENTER WERE FOUND.
 - OWNERSHIP TAKEN FROM PUBLIC RECORDS OF MARSHALL COUNTY, WV IN MARCH, 2019. COORDINATES AND WELL TIES BASED UPON DIFFERENTIAL GPS MEASUREMENTS.
 - WELL LOCATION REFERENCES ARE BASED UPON THE MAGNETIC MERIDIAN.
 - ALL DEEP WELLS SHOWN ON THIS PLAT.
 - BOUNDARIES ALONG ROADWAYS ARE BASED UPON MEMORANDUM BY DICKIE, MCCAMEY & CHILCOTE, P.C. FILE 0058304.0401147

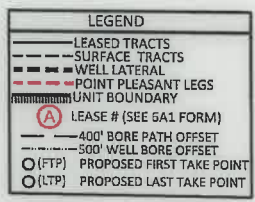

CURVE	CHORD BEARING	CHORD LENGTH	RADIUS	ARC LENGTH
C1	S 59°26' W	81.76'	93.38'	84.63'
C2	S 48°43' W	39.95'	77.44'	40.41'
C3	S 47°02' W	172.00'	320.79'	174.13'
C4	S 75°27' W	136.40'	162.88'	140.75'
C5	N 69°38' W	124.09'	242.82'	125.48'
C6	N 48°55' W	178.88'	735.56'	179.33'
C7	N 39°23' W	287.04'	1795.07'	287.35'
C8	N 30°20' W	230.39'	1879.13'	230.54'

FILE NUMBER _____
DRAWING NUMBER: MCMASTERS_N-11HU_REV4
SCALE 1" = 2000'
MINIMUM DEGREE OF ACCURACY 1/200
PROVEN SOURCE OF ELEVATION SUBMETER MAPPING
GRADE GPS

I, THE UNDERSIGNED, HEREBY CERTIFY THAT THIS PLAT IS CORRECT TO THE BEST OF MY KNOWLEDGE AND BELIEF AND SHOWS ALL THE INFORMATION REQUIRED BY LAW AND THE RULES ISSUED AND PRESCRIBED BY THE DEPARTMENT OF ENVIRONMENTAL PROTECTION

P.S. 708

David L Jackson

JACKSON SURVEYING INC.
P.O. Box 1460
Clarksburg, WV 26302
304-623-5851

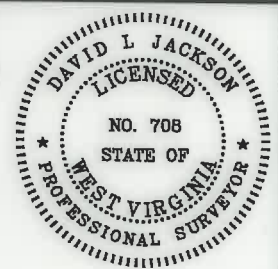

WVDEP
OFFICE OF OIL & GAS
601 57TH STREET, SE
CHARLESTON, WV 25304

DATE: OCTOBER 05, 2022
OPERATORS WELL NO. MCMASTERS N-11HU
API WELL NO. 47-051-02317
STATE COUNTY PERMIT

WELL TYPE: OIL ___ GAS X LIQUID INJECTION ___ WASTE DISPOSAL ___
(IF "GAS") PRODUCTION X STORAGE ___ DEEP X SHALLOW ___
LOCATION ELEVATION 1207.75' WATERSHED (HUC 10) FISH CREEK (HUC-10)
DISTRICT FRANKLIN COUNTY MARSHALL
QUADRANGLE POWHATAN POINT 7.5' LEASE NUMBER SEE WW-6A1 FORM

SURFACE OWNER ROBERT L. SHIELDS, ET AL ACREAGE 104.13/2024
OIL & GAS ROYALTY OWNER ROBERT L. SHIELDS, ET AL LEASE ACREAGE 104.11
PROPOSED WORK: DRILL ___ CONVERT ___ DRILL DEEPER ___ REDRILL ___ FRACTURE OR STIMULATE ___ PLUG OFF OLD FORMATION ___
PERFORATE NEW FORMATION ___ OTHER PHYSICAL CHANGE (SPECIFY) ASDRILLED
TARGET FORMATION POINT PLEASANT ESTIMATED DEPTH TVD: 10,887' TMD: 29,043'
WELL OPERATOR TUG HILL OPERATING, LLC DESIGNATED AGENT DARREN BROWN, CT CORP
ADDRESS 1320 SOUTH UNIVERSITY DRIVE, SUITE 500 FORT WORTH, TX 76107 ADDRESS 5098 WASHINGTON STREET WEST, SUITE 407 CHARLESTON, WV 25313-1561

COUNTY NAME PERMIT

MCMASTERS LEASE
WELL N-11HU
608.7765± ACRES

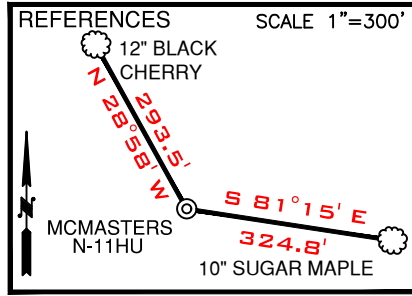

TOP HOLE LATITUDE: 39°47'30"
BOTTOM HOLE LATITUDE: 39°50'00"

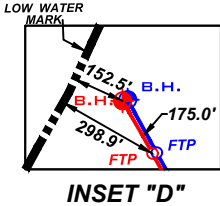
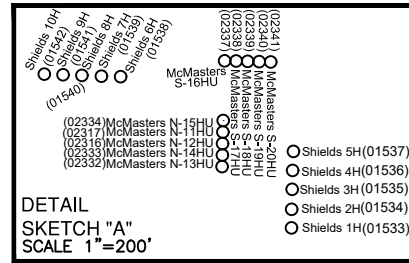

ASDRILLED LEG
PERMITTED LEG

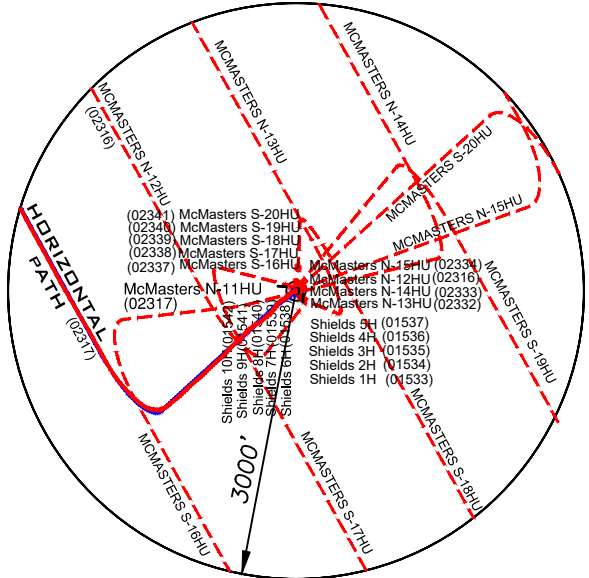
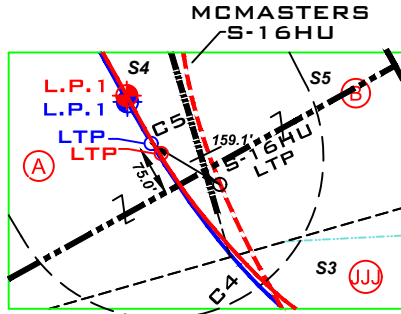

(+) DENOTES LOCATION ON UNITED STATES TOPOGRAPHIC MAPS

INSET "C" NTS

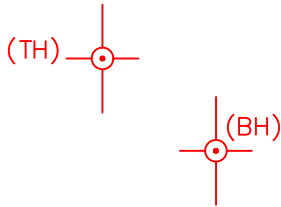

LINE	BEARING	DISTANCE
L1	N 71°01' W	1424.78'
L2	S 41°00' W	1285.15'
L3	S 47°39' W	1509.71'

SURFACE HOLE	
UTM. NAD83, ZONE 17 IN METERS	
N)	4,401,152.77
E)	518,196.99
LANDING POINT 1	
UTM. NAD83, ZONE 17 IN METERS	
N)	4,400,942.91
E)	517,583.81
BOTTOM HOLE	
UTM. NAD83, ZONE 17 IN METERS	
N)	4,405,476.62
E)	514,976.37

NOTES

- 1. BORE PATH BASED ON GRID NORTH.
- 2. NO WATER WELLS WITHIN 250' OF WELL WERE FOUND, NO DWELLINGS WITHIN 625' OF PAD CENTER WERE FOUND.
- 3. OWNERSHIP TAKEN FROM PUBLIC RECORDS OF MARSHALL COUNTY, WV IN MARCH, 2019. COORDINATES AND WELL TIES BASED UPON DIFFERENTIAL GPS MEASUREMENTS.
- 4. WELL LOCATION REFERENCES ARE BASED UPON THE MAGNETIC MERIDIAN.
- 5. ALL DEEP WELLS SHOWN ON THIS PLAT.
- 6. BOUNDARIES ALONG ROADWAYS ARE BASED UPON MEMORANDUM BY DICKIE, MCCAMEY & CHILCOTE, P.C. FILE 0058304.0401147

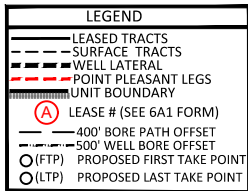

CURVE	CHORD BEARING	CHORD LENGTH	RADIUS	ARC LENGTH
C1	S 59°26' W	81.76'	93.38'	84.63'
C2	S 48°43' W	39.95'	77.44'	40.41'
C3	S 47°03' W	172.00'	320.79'	174.13'
C4	S 75°27' W	136.40'	162.68'	140.75'
C5	N 69°38' W	124.09'	242.82'	125.48'
C6	N 48°55' W	178.88'	735.58'	179.33'
C7	N 39°23' W	287.04'	1795.07'	287.35'
C8	N 30°20' W	230.39'	1879.13'	230.54'

FILE NUMBER _____
DRAWING NUMBER: MCMASTERS_N-11HU_REV4
SCALE 1" = 2000'
MINIMUM DEGREE OF ACCURACY 1/200
PROVEN SOURCE OF ELEVATION SUBMETER MAPPING GRADE GPS

I, THE UNDERSIGNED, HEREBY CERTIFY THAT THIS PLAT IS CORRECT TO THE BEST OF MY KNOWLEDGE AND BELIEF AND SHOWS ALL THE INFORMATION REQUIRED BY LAW AND THE RULES ISSUED AND PRESCRIBED BY THE DEPARTMENT OF ENVIRONMENTAL PROTECTION

P.S. 708

David L Jackson

JACKSON SURVEYING INC.
P.O. Box 1460
Clarksburg, WV 26302
304-623-5851

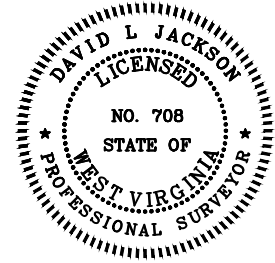

WVDEP
OFFICE OF OIL & GAS
601 57TH STREET, SE
CHARLESTON, WV 25304

DATE: OCTOBER 05, 2022
OPERATORS WELL NO. MCMASTERS N-11HU
API WELL NO. 47-051-02317
STATE COUNTY PERMIT

WELL TYPE: OIL ___ GAS X LIQUID INJECTION ___ WASTE DISPOSAL ___
(IF "GAS") PRODUCTION X STORAGE ___ DEEP X SHALLOW ___
LOCATION ELEVATION 1207.75' WATERSHED (HUC 10) FISH CREEK (HUC-10)
DISTRICT FRANKLIN COUNTY MARSHALL
QUADRANGLE POWHATAN POINT 7.5' LEASE NUMBER SEE WW-6A1 FORM

SURFACE OWNER ROBERT L. SHIELDS, ET AL ACREAGE 104.11
OIL & GAS ROYALTY OWNER ROBERT L. SHIELDS, ET AL LEASE ACREAGE 104.11
PROPOSED WORK: DRILL ___ CONVERT ___ DRILL DEEPER ___ REDRILL ___ FRACTURE OR STIMULATE ___ PLUG OFF OLD FORMATION ___
PERFORATE NEW FORMATION ___ OTHER PHYSICAL CHANGE (SPECIFY) ASDRILLED
TARGET FORMATION POINT PLEASANT ESTIMATED DEPTH TVD: 10,887' TMD: 29,043'
WELL OPERATOR TUG HILL OPERATING, LLC DESIGNATED AGENT DARREN BROWN, CT CORP
ADDRESS 1320 SOUTH UNIVERSITY DRIVE, SUITE 500 FORT WORTH, TX 76107 ADDRESS 5098 WASHINGTON STREET WEST, SUITE 407 CHARLESTON, WV 25313-1561

COUNTY NAME
PERMIT

12/13/2024

form. wwg

MCMASTERS LEASE WELL N-11HU 608.7765± ACRES

LEGEND

- LEASED TRACTS
- SURFACE TRACTS
- WELL LATERAL
- POINT PLEASANT LEGS
- UNIT BOUNDARY
- LEASE # (SEE 6A1 FORM)
- 400' BORE PATH OFFSET
- 500' WELL BORE OFFSET
- (FTP) PROPOSED FIRST TAKE POINT
- (LTP) PROPOSED LAST TAKE POINT

SCALE 1" = 2000'

- ASDRILLED LEG
- PERMITTED LEG

SURFACE HOLE UTM. NAD83, ZONE 17 IN METERS
N) 4,401,152.69 E) 518,197.09
LANDING POINT 1 UTM. NAD83, ZONE 17 IN METERS
N) 4,400,938.84 E) 517,584.21
BOTTOM HOLE UTM. NAD83, ZONE 17 IN METERS
N) 4,405,477.65 E) 514,980.86

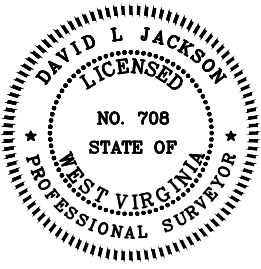
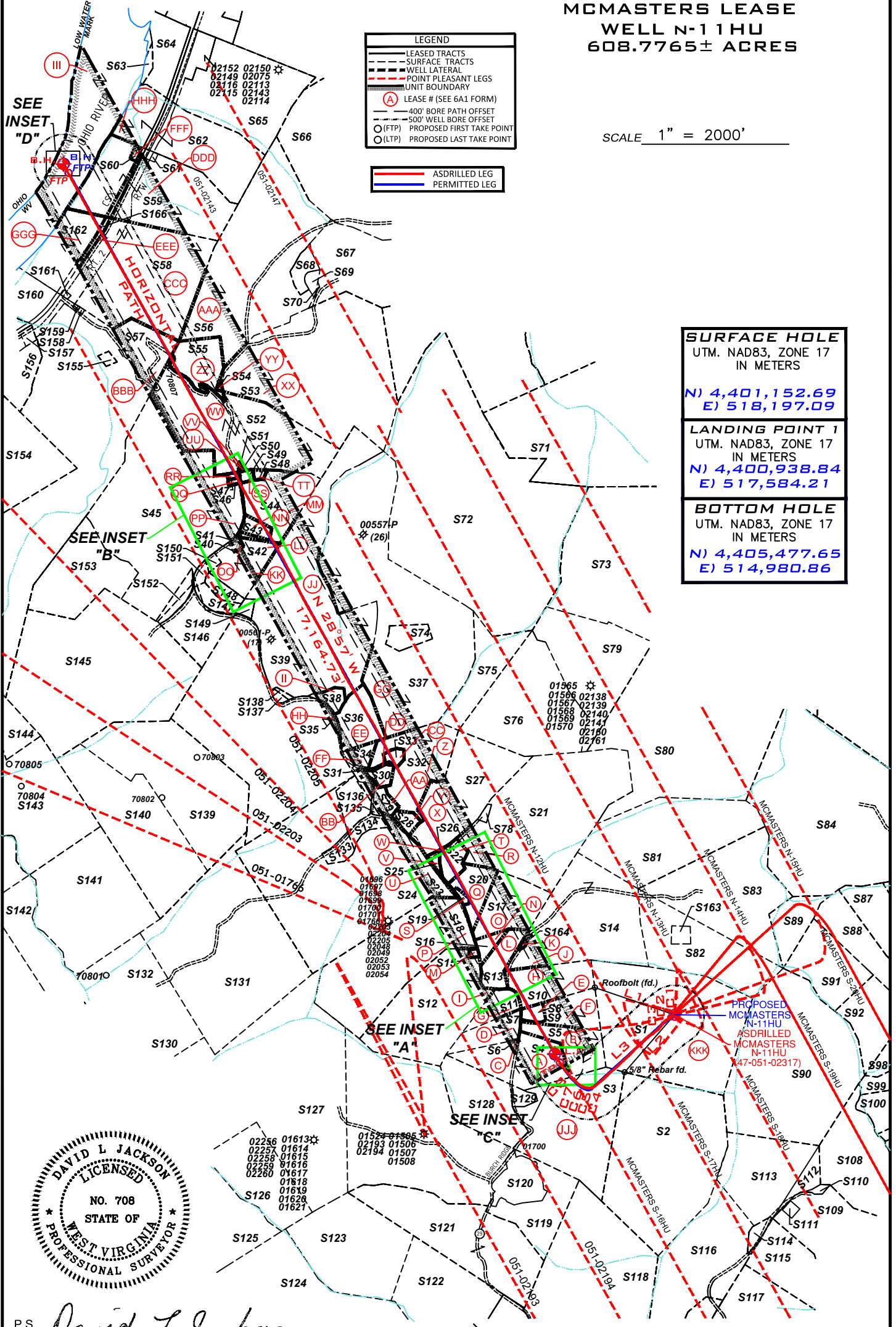

P.S. 708 *David L Jackson*

12/13/2024



TUG HILL
OPERATING

OPERATOR'S
WELL #: MCMASTERS N-11HU
DISTRICT: Franklin
COUNTY: Marshall
STATE: WV
API #: 47-051-02317

WELL PLAT
PAGE 2 OF 4
DATE: 10/05/2022

PG 3 OF 4 MCMASTERS LEASE
WELL N-11HU
608.7765± ACRES

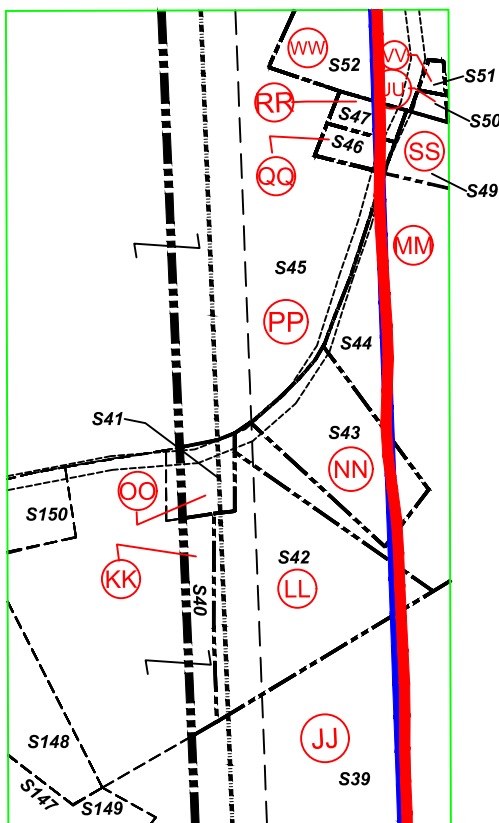

INSET
"B"

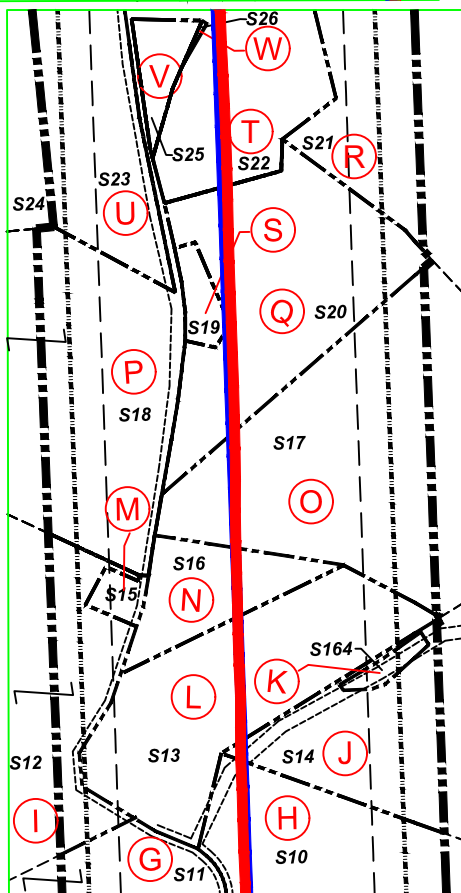

INSET
"A"

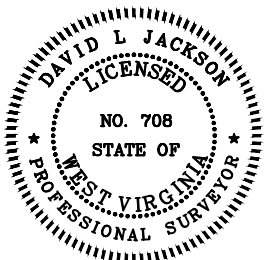

P.S.
708

David L Jackson

Number	TAX MAP -PARCEL	ADJOINER OWNER	ACRES
S1	KKK 05-18-02	Robert L. Shields, Et Al	104.11
S2	05-18-24	Duane Brunn	102.0
S3	JJJ 05-19-18	Mark E. Yoho, Et Ux	55.948
S4	A 05-19-24	Mark E. Yoho	15.436
S5	B 05-19-17	Mark A. Yoho	15.263
S6	C 05-19-25	David E. Yoho & Mark E. Yoho	9.976
S7	D 05-19-26	Roger J. & Beth E. James	9.977
S8	E 05-19-16.1	Robert L. & Rebecca A. Shields	2.307
S9	F 05-19-16	Robert L. Shields & Donald Shields	11.612
S10	H 05-19-14	James & Sherry Beegle	18.356
S11	G 05-19-27	David E. Yoho & Mark E. Yoho	7.041
S12	I 05-19-28	David E. Yoho & Mark E. Yoho	56.899
S13	L 05-19-31	Charles F. & Diana L. Haynes	8.779
S14	J 05-18-01	Diana Henry Haynes & Carol C. Henry	62.908
S15	M 05-19-32	Jasper N. Burch, Et Al-Trustees	0.397
S16	N 05-19-30.1	Eric R.W. & Ashley A. Huggins	2.911
S17	O 05-19-30	Ernie & Tammy Anderson	19.037
S18	P 05-19-19	Russell Blake, Et Ux	66.4
S19	S 05-19-15	Carly Herran	0.72
S20	Q 05-19-29	Ernie L. & Tammy L. Anderson	10.961
S21	R 05-19-13	Rona Lee Rice & Charles Franklin Mccardle	94.925
S22	T 05-19-12	Ernie L. Anderson, Et Ux	5.33
S23	U 05-19-09	Penny Elaine Ashcraft	10.44
S24	05-19-20	Wilbert H. Bungard, Et Ux	114.989
S25	V 05-19-10	Ernie L. Anderson, Et Ux	0.8125
S26	W 05-19-11	Ernie L. Anderson, Et Ux	0.08
S27	X 05-19-08	CNX Gas Company LLC	40.0
S28	Y 05-19-7.5	Adam T. & Jesse L. Anderson	2.64
S29	AA 05-19-7.1	Robert L. Shields, Et Ux	3.399
S30	BE 05-19-7.2	Olan Rutan	2.783
S31	DD 05-19-7.3	Olan V. Rutan	0.341
S32	Z 05-19-07	Olan V. Rutan, Et Ux	32.4801
S33	CC 05-19-7.4	Olan V. Rutan, Et Ux	1.787
S34	FF 05-19-06	Belinda Kay Meadows, Rebecca Ann Shields & Olan V. Rutan	5.1099
S35	HH 05-19-05	Margirene Keefe	126.03
S36	EE 05-14-11	Dale R. Gallaher, Et Al	12.0
S37	GG 05-14-12	Dale R. Gallaher, Et Al	135.10
S38	II 05-14-10.4	Adam R. & Jesse L. Robinson	3.343
S39	JJ 05-14-10	Wanda P. Rine, Life	107.372
S40	KK 05-14-09	Walter W. Streight Jr. Et Ux	9.311
S41	OO 05-14-19	Brian A. & Charlotte Mull	0.92
S42	LL 05-14-9.5	Maria T. Flores	6.024
S43	NN 05-14-9.1	Maria T. Flores	2.882
S44	MM 05-14-9.2	Maria T. Flores	25.0
S45	PP 05-14-05	Donna K. & Leroy Anderson	110.5
S46	QQ 05-12-19	Joni Lyn Leon	0.457
S47	RR 05-12-20	Joni Lyn Leon	0.457
S48	TT 05-12-17	Joni Lyn Leon	0.752
S49	SS 05-12-18	Joni Lyn Leon	1.018
S50	UU 05-12-16.1	Gary E. Gibson, Et Al	0.146
S51	VV 05-12-16	Gary E. Gibson, Et Al	0.104
S52	WW 05-12-21	Edward L. Gibson-Life	73.436
S53	XX 05-12-14	Linda Hamilton, Et Al	117.495
S54	YY 05-12-15	Woodland Hill Church of God TRS	0.375
S55	ZZ 05-12-21.1	Robert W. Jr. & Wendy L. Riggerbach	14.222
S56	AAA 05-12-07	Robert WM Riggerbach, Et Ux	104.231
S57	BBB 05-12-23	CNX Land Resources Inc.	236.1
S58	CCC 05-12-06	CNX Land Resources Inc.	70.81
S59	DDD 05-12-05	CNX Land Resources Inc.	61.883
S60	FFF 05-12-04	CNX Land Resources Inc.	0.93
S61	05-12-5.1	CNX Land Resources Inc.	0.52
S62	HHH 05-12-03	CNX Land Resources Inc.	62.30
S63	05-12-01	United States of America	1.68
S64	05-12-2.1	Consolidation Coal Company/ Murray Energy	22.0
S65	05-12-02	CNX Land Resources Inc.	60.68
S66	05-12-08	Anita Ray Miller-Life	100.35
S67	05-12-13	Linda Hamilton, Et Al	41.887
S68	05-12-7.2	Raymond K. Miller	4.66
S69	05-12-7.1	Raymond K. Miller	1.609
S70	05-12-13.1	Raymond K. Miller	0.113
S71	05-11-15	Lionel L. Persinger, Et Ux	93.0
S72	05-14-13	Ralph D. & Sally Jane Hoyt	222.18
S73	05-15-01	Marcus Sharp & Anglea R. Schlabach	121.0
S74	05-14-12.1	Henry Wilson Plunkert Jr.	5.0
S75	05-14-14	Robert L. Shields, Et Al	29.05
S76	05-14-15	Robert L. Shields, Et Al	53.0
S78	05-19-13.1	Donald Shields	0.80
S79	05-15-15	Robert L. Shields, Et Al	49.0
S80	05-15-12	John David Petrock & Thomas Andrew Petrock	150.23
S81	05-15-11	Diana Henry Haynes & Carol Henry	65.59
S82	05-18-03	Olan V. & Patricia E. Rutan	43.677
S83	05-18-04	Olan & Patricia Rutan	65.89
S84	05-15-10	Mark Stanley Ruckman	153.75
S85	05-18-11.1	Edward Lee Burge, Jr.	18.0
S86	05-18-15	Edward Lee Burge, Jr.	2.495
S87	05-18-15.4	Edward Lee Burge, Jr.	22.34
S88	05-18-15.3	Charles Yeater	26.44
S89	05-18-05	Terry Melott	8.14
S90	05-18-23	XCL Midstream Operating LLC	110.0
S91	05-18-06	Charles Yeater	26.0
S92	05-18-07	Charles Yeater	24.22

12/13/2024



OPERATOR'S
WELL #: MCMASTERS N-11HU
DISTRICT: Franklin
COUNTY: Marshall
STATE: WV
API #: 47-051-02317

WELL PLAT
PAGE 3 OF 4
DATE: 10/05/2022

PG 4 OF 4 MCMASTERS LEASE
WELL N-11HU
608.7765± ACRES

Table with columns: Lease ID, Tag, Parcel, Grantor, Lessor, Etc., Deed Book/Page. Lists various land parcels and their owners.

Table with columns: Number, TAX MAP -PARCEL, ADJOINER OWNER, ACRES. Lists adjacent parcels and their owners.

* Co-tenancy utilization - At least 7 mineral owners in tract. At least 75% of the royalty owners have executed a lease

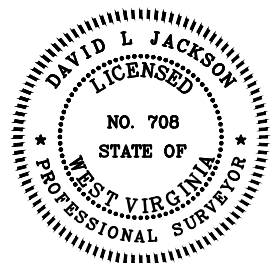

P.S. 708

David L Jackson

12/13/2024



OPERATOR'S
WELL #: McMasters N11-HU
DISTRICT: Franklin
COUNTY: Marshall
STATE: WV
API #: 47-051-02317

WELL PLAT
PAGE 4 OF 4
DATE: 10/05/2022