

(TH) 10,615'

(BH) 9,433'

**MCMASTERS LEASE  
WELL N-11HU  
608.7765± ACRES**

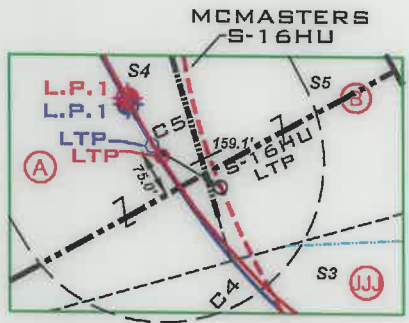
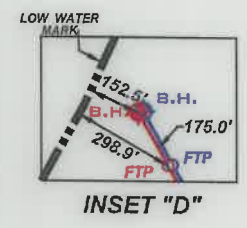
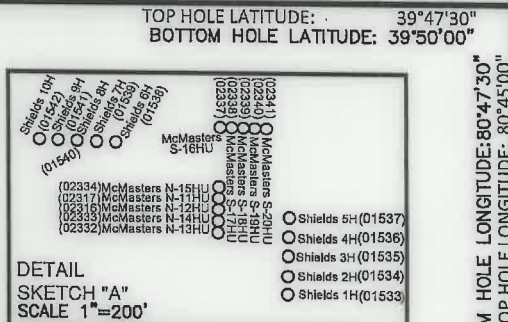
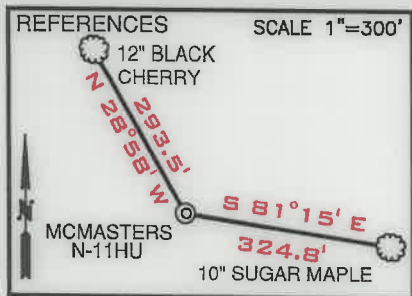

(+) DENOTES LOCATION ON UNITED STATES TOPOGRAPHIC MAPS

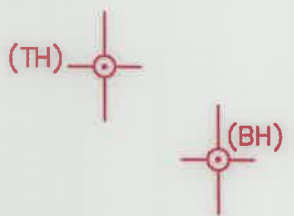

LINE	BEARING	DISTANCE
L1	N 71°01' W	1424.78'
L2	S 41°00' W	1285.15'
L3	S 47°39' W	1509.71'

SURFACE HOLE UTM. NAD83, ZONE 17 IN METERS	
N)	4,401,152.77
E)	518,196.99
LANDING POINT 1 UTM. NAD83, ZONE 17 IN METERS	
N)	4,400,942.91
E)	517,583.81
BOTTOM HOLE UTM. NAD83, ZONE 17 IN METERS	
N)	4,405,476.62
E)	514,976.37

- NOTES
- BORE PATH BASED ON GRID NORTH.
  - NO WATER WELLS WITHIN 130 250' OF WELL WERE FOUND. NO DWELLINGS WITHIN 825' OF PAD CENTER WERE FOUND.
  - OWNERSHIP TAKEN FROM PUBLIC RECORDS OF MARSHALL COUNTY, WV IN MARCH, 2019. COORDINATES AND WELL TIES BASED UPON DIFFERENTIAL GPS MEASUREMENTS.
  - WELL LOCATION REFERENCES ARE BASED UPON THE MAGNETIC MERIDIAN.
  - ALL DEEP WELLS SHOWN ON THIS PLAT.
  - BOUNDARIES ALONG ROADWAYS ARE BASED UPON MEMORANDUM BY DICKIE, MCCAMEY & CHILCOTE, P.C. FILE 0058304.0401147

LEGEND

- LEASE TRACTS
- SURFACE TRACTS
- WELL LATERAL
- POINT PLEASANT LEGS
- UNIT BOUNDARY
- LEASE # (SEE 5A1 FORM)
- 400' BORE PATH OFFSET
- 500' WELL BORE OFFSET
- (FTP) PROPOSED FIRST TAKE POINT
- (LTP) PROPOSED LAST TAKE POINT

CURVE	CHORD BEARING	CHORD LENGTH	RADIUS	ARC LENGTH
C1	S 59°26' W	81.76'	93.38'	84.63'
C2	S 48°43' W	39.95'	77.44'	40.41'
C3	S 47°02' W	172.00'	320.79'	174.13'
C4	S 75°27' W	136.40'	162.88'	140.75'
C5	N 69°38' W	124.09'	242.82'	125.48'
C6	N 48°55' W	178.88'	735.56'	179.33'
C7	N 39°23' W	287.04'	1795.07'	287.35'
C8	N 30°20' W	230.39'	1879.13'	230.54'

FILE NUMBER \_\_\_\_\_  
 DRAWING NUMBER: MCMASTERS\_N-11HU\_REV4  
 SCALE: 1" = 2000'  
 MINIMUM DEGREE OF ACCURACY: 1/200  
 PROVEN SOURCE OF ELEVATION: SUBMETER MAPPING  
GRADE GPS

I, THE UNDERSIGNED, HEREBY CERTIFY THAT THIS PLAT IS CORRECT TO THE BEST OF MY KNOWLEDGE AND BELIEF AND SHOWS ALL THE INFORMATION REQUIRED BY LAW AND THE RULES ISSUED AND PRESCRIBED BY THE DEPARTMENT OF ENVIRONMENTAL PROTECTION



*David L Jackson*

JACKSON SURVEYING INC.  
 P.O. Box 1460  
 Clarksburg, WV 26302  
 304-623-5851



WVDEP  
 OFFICE OF OIL & GAS  
 601 57TH STREET, SE  
 CHARLESTON, WV 25304

DATE: OCTOBER 05, 2022  
 OPERATORS WELL NO. MCMASTERS N-11HU  
 API WELL NO. \_\_\_\_\_

WELL TYPE: OIL \_\_\_ GAS X LIQUID INJECTION \_\_\_ WASTE DISPOSAL \_\_\_  
 (IF "GAS") PRODUCTION X STORAGE \_\_\_ DEEP X SHALLOW \_\_\_  
 LOCATION ELEVATION 1207.75' WATERSHED (HUC 10) FISH CREEK (HUC-10)  
 DISTRICT FRANKLIN COUNTY MARSHALL  
 QUADRANGLE POWHATAN POINT 7.5' LEASE NUMBER SEE WW-6A1 FORM

SURFACE OWNER ROBERT L. SHIELDS, ET AL ACREAGE 104.10/21/2022  
 OIL & GAS ROYALTY OWNER ROBERT L. SHIELDS, ET AL LEASE ACREAGE 104.11  
 PROPOSED WORK: DRILL \_\_\_ CONVERT \_\_\_ DRILL DEEPER \_\_\_ REDRILL \_\_\_ FRACTURE OR STIMULATE \_\_\_ PLUG OFF OLD FORMATION \_\_\_  
 PERFORATE NEW FORMATION \_\_\_ OTHER PHYSICAL CHANGE (SPECIFY) ASDRILLED  
 TARGET FORMATION POINT PLEASANT ESTIMATED DEPTH TVD: 10,887' TMD: 29,043'  
 WELL OPERATOR TUG HILL OPERATING, LLC DESIGNATED AGENT DARREN BROWN, CT CORP  
 ADDRESS 1320 SOUTH UNIVERSITY DRIVE, SUITE 500 FORT WORTH, TX 76107 ADDRESS 5098 WASHINGTON STREET WEST, SUITE 407 CHARLESTON, WV 25313-1561

COUNTY NAME  
 PERMIT

FORM WW6

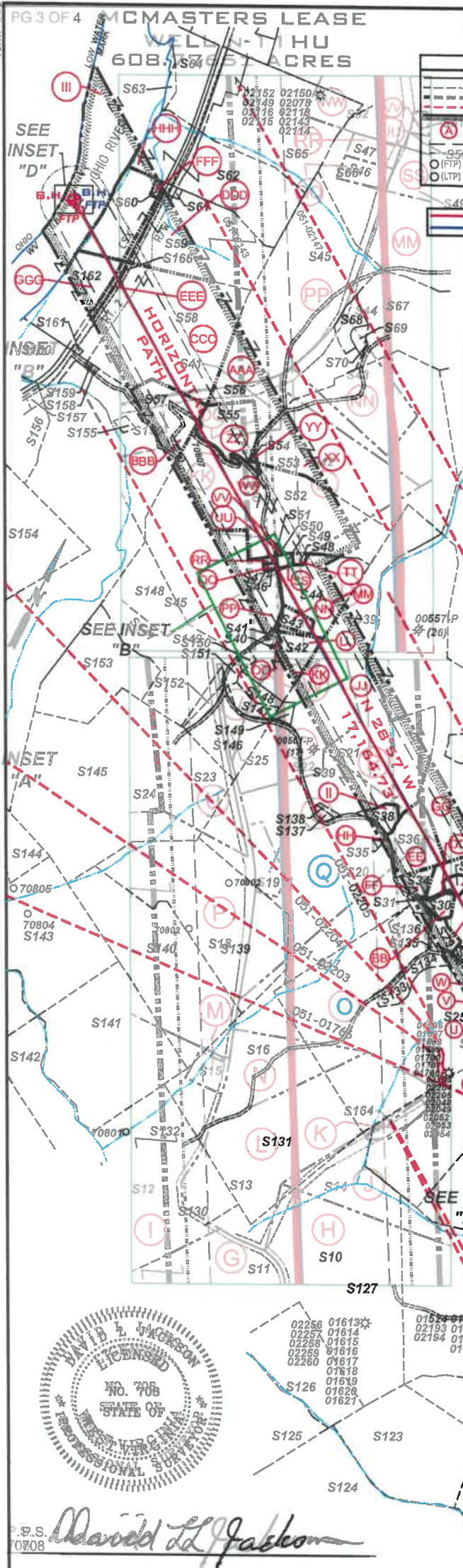

Number	TAX MAP - PARCEL	ADJACENT OWNER	ACRES
S1	KKK 05-18-02	Mark E. Yoho, Et Ux	55.948
S2	05-18-24	Mark A. Yoho	15.436
S3	05-18-18	Mark A. Yoho	15.263
S4	05-19-24	David E. Yoho & Mark E. Yoho	9.976
S5	05-19-17	Roger J. & Beth E. James	9.977
S6	05-19-25	Robert L. & Rebecca A. Shields	2.307
S7	05-19-26	Robert L. Shields	11.612
S8	05-19-11	James & Sherry Beagle	18.356
S9	05-19-14	David E. Yoho & Mark E. Yoho	7.041
S10	05-19-28	David E. Yoho & Mark E. Yoho	56.899
S11	05-19-31	Charles F. & Diane L. Haynes	8.779
S12	05-18-01	Diana Henry Haynes & Carol C. Henry	62.908
S13	05-19-32	Jasper N. Burch, Et Al-Trustees	0.397
S14	05-19-30.1	Eric R.W. & Ashley A. Huggins	2.911
S15	05-19-30	Ernie & Tammy Anderson	19.037
S16	05-19-19	Russell Blake, Et Ux	66.4
S17	05-19-15	Cathy Herran	0.72
S18	05-19-29	Ernie L. & Tammy L. Anderson	10.961
S19	05-19-13	Rose Lee Rice & Charles Franklin Mccardle	94.925
S20	05-19-12	Ernie L. Anderson, Et Ux	5.33
S21	05-19-19	Penny Elaine Anderson	0.08
S22	05-19-20	Wilbert H. Bungalow	0.08
S23	05-19-10	Ernie L. Anderson, Et Ux	0.08
S24	05-19-11	Ernie L. Anderson, Et Ux	0.08
S25	05-19-18	CNX Gas Company	1.5269
S26	05-19-7.5	Adam T. & Jesse L. Anderson	1.9709
S27	05-19-7.1	Robert L. Shields	0.08
S28	05-19-7.2	Olan Rutan	0.08
S29	05-19-7.3	Olan V. Rutan	0.08
S30	05-19-7.4	Olan V. Rutan	0.08
S31	05-19-7.5	Beth Kay Meadows, Rebecca Ann Shields, & Olan V. Rutan	0.08
S32	05-19-7.6	Manjiree K. & Dale R. Gollaha, Et Al	0.08
S33	05-19-7.7	Dale R. Gollaha, Et Al	0.08
S34	05-19-7.8	Dale R. & Jesse L. Rutan	0.08
S35	05-19-7.9	Wanda P. Riney	0.08
S36	05-19-05	Walter V. Straight Jr. Et Ux	9.311
S37	05-14-11	Brian A. Charlotte Mull	0.92
S38	05-14-2	Maria T. Flores	6.024
S39	05-14-4	Maria T. Flores	2.882
S40	05-14-10	Maria T. Flores	25.0
S41	05-14-09	Dorina K. & Leroy Anderson	110.5
S42	05-14-9.2	Joni Lyn Leon	0.457
S43	05-14-9.1	Joni Lyn Leon	0.457
S44	05-14-9.2	Joni Lyn Leon	0.752
S45	05-14-9.3	Joni Lyn Leon	1.118
S46	05-14-9.4	Gary E. Gibson, Et Al	0.46
S47	05-14-9.5	Charles E. Gibson, Et Al	0.104
S48	05-12-20	Edward Gibson-Life	73.436
S49	05-12-7	Linda Halpilton, Et Al	17.495
S50	05-12-16	Woodland Hill Church of God TRS	0.375
S51	05-12-16	Robert W. Jr. & Mary L. Rindgenbach	14.222
S52	05-12-16	Robert W. Rindgenbach, Et Ux	4.231
S53	05-12-21	CNX Land Resources Inc.	1.1
S54	05-12-14	CNX Land Resources Inc.	1.1
S55	05-12-15	CNX Land Resources Inc.	1.1
S56	05-12-15	CNX Land Resources Inc.	1.1
S57	05-12-15	CNX Land Resources Inc.	1.1
S58	05-12-15	CNX Land Resources Inc.	1.1
S59	05-12-15	CNX Land Resources Inc.	1.1
S60	05-12-15	CNX Land Resources Inc.	1.1
S61	05-12-15	CNX Land Resources Inc.	1.1
S62	05-12-15	CNX Land Resources Inc.	1.1
S63	05-12-15	CNX Land Resources Inc.	1.1
S64	05-12-15	CNX Land Resources Inc.	1.1
S65	05-12-15	CNX Land Resources Inc.	1.1
S66	05-12-15	CNX Land Resources Inc.	1.1
S67	05-12-15	CNX Land Resources Inc.	1.1
S68	05-12-15	CNX Land Resources Inc.	1.1
S69	05-12-15	CNX Land Resources Inc.	1.1
S70	05-12-15	CNX Land Resources Inc.	1.1
S71	05-12-15	CNX Land Resources Inc.	1.1
S72	05-12-15	CNX Land Resources Inc.	1.1
S73	05-12-15	CNX Land Resources Inc.	1.1
S74	05-12-15	CNX Land Resources Inc.	1.1
S75	05-12-15	CNX Land Resources Inc.	1.1
S76	05-12-15	CNX Land Resources Inc.	1.1
S77	05-12-15	CNX Land Resources Inc.	1.1
S78	05-12-15	CNX Land Resources Inc.	1.1
S79	05-12-15	CNX Land Resources Inc.	1.1
S80	05-12-15	CNX Land Resources Inc.	1.1
S81	05-12-15	CNX Land Resources Inc.	1.1
S82	05-12-15	CNX Land Resources Inc.	1.1
S83	05-12-15	CNX Land Resources Inc.	1.1
S84	05-12-15	CNX Land Resources Inc.	1.1
S85	05-12-15	CNX Land Resources Inc.	1.1
S86	05-12-15	CNX Land Resources Inc.	1.1
S87	05-12-15	CNX Land Resources Inc.	1.1
S88	05-12-15	CNX Land Resources Inc.	1.1
S89	05-12-15	CNX Land Resources Inc.	1.1
S90	05-12-15	CNX Land Resources Inc.	1.1
S91	05-12-15	CNX Land Resources Inc.	1.1
S92	05-12-15	CNX Land Resources Inc.	1.1
S81	05-15-1	Diane Haynes & Carolyn	65.5
S82	05-18-20.3	Olan V. Patricia E. Rutan	4.6
S83	05-18-04	Olan V. Patricia E. Rutan	65
S84	05-15-10	Mark Stanley Ruck	1.173
S85	05-18-15	Edward Lee Burns, Jr.	1.111
S86	05-18-15	Edward Lee Burns, Jr.	1.111
S87	05-18-1	Edward Lee Burns, Jr.	1.111
S88	05-18-15.3	Charles Yeater	26.44
S89	05-18-23	Tom Meloy	1.14
S90	05-18-18	XC Midstream Operator	1.14
S91	05-18-26	Charles Yeater	26.44
S92	05-18-07	Charles Yeater	24.22

**SURFACE HOLE**  
 UTM, NAD83, ZONE 17  
 IN METERS  
 N 4,401,152.69  
 E 518,797.09

**LANDING POINT 1**  
 UTM, NAD83, ZONE 17  
 IN METERS  
 N 4,400,938.84  
 E 517,584.21

**BOTTOM HOLE**  
 UTM, NAD83, ZONE 17  
 IN METERS  
 N 4,405,477.65  
 E 514,980.86



D. S. David L. Jackson  
 0708

10/21/2022

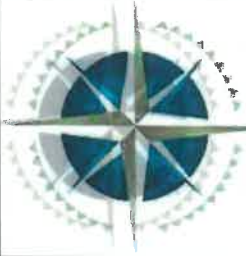

**TUG HILL**  
 OPERATING

OPERATOR'S	WELL IPIRAT
WELL #:	MCMASTERS-N-H1HU
DISTRICT:	Franklin
COUNTY:	Marshall
STATE:	WV
FILE #:	47476051202317
	PAGE 2 OF 4
	DATE: 10/06/2022

PG 4 OF 4 MCMASTERS LEASE  
WELL N-11HU  
608.7765± ACRES

Table with columns: Lease ID, Tag, Parcel, Grantor, Lessor, Etc., Deed Book/Page. Lists various lease agreements and their details.

Table with columns: Number, TAX MAP -PARCEL, ADJOINER OWNER, ACRES. Lists adjacent parcels and their owners.

\* Co-tenancy utilization - At least 7 mineral owners in tract. At least 75% of the royalty owners have executed a lease

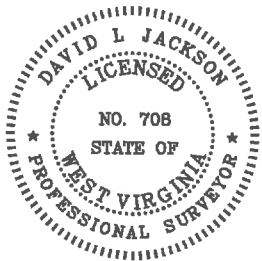

P.S. 708

David L Jackson



TUG HILL OPERATING

OPERATOR'S WELL #: McMasters N11-HU  
DISTRICT: Franklin  
COUNTY: Marshall  
STATE: WV  
API #: 47-051-02317

WELL PLAT  
PAGE 4 OF 4  
DATE: 10/05/2022

10/21/2022