

**HUDSON S LEASE
UTICA UNIT - 544.74 AC±
WELL 14HU
TUG HILL OPERATING**

T.H. LATITUDE 39°50'00"
B.H. LATITUDE 39°47'30"

TAG	SURFACE OWNER	PARCEL	ACRES
A	CNX LAND LLC	9-3-1	106.935
B	JOHN W. & RACHEL A. HOLPP	9-3-2.5	56.259
C	RAYMOND E. & CINDY L. WHITE	9-3-2.6	0.619
D	RAYMOND E. & CINDY L. WHITE	9-3-20	127.00
E	CNX LAND LLC	9-8-4.2	96.902
F	LLOYD ANDREW BEE, ET UX	9-3-18	19.921
G	RAYMOND E. & CINDY L. WHITE	9-3-18.2	2.103
H	BOARD OF EDUCATION (NOT ASSESSED)	NA	NA
I	CNX LAND LLC	9-3-19	45 SQ RODS & 3280 SQ FT
J	CNX LAND RESOURCES, INC.	9-8-4.1	0.333
K	CNX LAND RESOURCES, INC.	9-8-5.2	4.586
L	RAYMOND E. & CINDY L. WHITE	9-3-18.3	0.086
M	CNX LAND LLC	P/O 9-3-19	0.5
N	CNX LAND LLC	9-8-5.1	1.040
O	CNX LAND RESOURCES, INC.	9-8-5	110.37
P	PETER J. MYSLIWIEC, ET AL	9-8-11	73.44
Q	JUDY KAY MCKINLEY	9-8-10	34.00
R	MARY LOU RUBINI, ET AL	9-9-4	268.39
S	MARVIN D. & ADA C. DOBBS (LIFE), ET AL	9-9-5	76.25
T	TODD L. SCHERICH, ET AL	9-9-16	168.204
U	GARY W. MORRIS	9-9-12	54.74
V	DANNY R. & FRANCES V. KERNS ESTATE	9-9-14	48.308
W	AMERICAN ENERGY-MARCELLUS LLC	9-9-14.1	0.40
X	NAUVOO CEMETERY ASSOC. INC.	9-9-16.1	0.126
Y	NAUVOO CEMETERY ASSOC. INC.	9-9-14.2	0.292
Z	NAUVOO CEMETERY ASSOC. INC.	9-9-17	1.00
AA	GARY W. MORRIS	9-9-22	0.15
BB	WARREN BERYLE & ELEANOR LOU CHAMBERS - LIFE TRUSTEES OF THE REORGANIZED CHURCH OF LATTER DAY SAINTS	9-12-11	91.00
CC	WHIPKEY TRUST	9-12-12	61.00
EE	DANNY R. & FRANCES V. KERNS ESTATE	7-8-1	27.00
FF	VIRGINIA MCILVAIN ESTATE & THE WHIPKEY TRUST	9-9-18	LOT
GG	CONSOL MINING CO., LLC	9-12-14	127.61
HH	WHIPKEY TRUST	9-12-15	12.00
II	JOHN ALFRED & LEORA JEAN DOBBS - LIFE	7-8-4	65.65
JJ	JOHN ALFRED & LEORA JEAN DOBBS - LIFE	7-8-5	24.00
KK	JOHN ALFRED & LEORA JEAN DOBBS - LIFE	7-8-8	51.97

(S.P.C. NORTH ZONE) (UTM(M) ZONE 17 NORTH)

NAD'83 S.P.C.(FT)	N. 486,114.40	E. 1,639,177.97
NAD'83 GEO.	LAT-(N) 39.828728	LONG-(W) 80.672637
NAD'83 UTM (M)	N. 4,408,799.24	E. 528,013.32

LANDING POINT

NAD'83 S.P.C.(FT)	N. 486,450.9	E. 1,640,775.7
NAD'83 GEO.	LAT-(N) 39.829709	LONG-(W) 80.666964
NAD'83 UTM (M)	N. 4,408,909.9	E. 528,498.4

BOTTOM HOLE

NAD'83 S.P.C.(FT)	N. 471,289.7	E. 1,649,195.8
NAD'83 GEO.	LAT-(N) 39.788986	LONG-(W) 80.636302
NAD'83 UTM (M)	N. 4,404,333.8	E. 531,140.6

MAP/PARCEL	ADJOINING SURFACE OWNER LIST	ACRES
9-2-9.2	CONSOLIDATION COAL CO.	1.00
9-3-1.1	CONSOLIDATION COAL CO.	5.00
9-3-1.2	CONSOLIDATION COAL CO.	1.00
9-3-1.3	CNX LAND CO. LLC	2.245
9-3-2.2	JOHN W. & RACHEL A. HOLPP	0.483
9-3-2.3	JOHN W. & RACHEL A. HOLPP	0.591
9-3-2.4	JOHN W. & RACHEL A. HOLPP	0.618
9-3-4.2	GRANT M. & MALISSA D. CARTER	0.720
9-3-4.3	JOHN W. & RACHEL A. HOLPP	0.870
9-3-6.1	JOSEPH L. MILETO, II	1.0468
9-3-18.1	LLOYD ANDREW BEE, ET UX	1.010
9-5-10	ROBERT J. & MELINDA J. WHITE	27.957
9-7-9	CNX LAND CO. LLC	2.00
9-7-10	DONALD M. & THERESA L. HARRIS	3.00
9-8-1	CNX LAND CO. LLC	P/O 1.00
9-8-2	CNX LAND CO. LLC	6000 SQ. FT.
9-8-3	CHURCH OF CHRIST	NO ASSD. AC
9-8-4	DONALD M. & THERESA L. HARRIS	3.183
9-8-6.1	MARK E. WOOD & SUNNI H. HARTLEY	1.423

T.H. LONGITUDE 80°40'00"
B.H. LONGITUDE 80°37'30"

AS DRILLED COORDINATES FOR WELL NO. 14HU

(S.P.C. NORTH ZONE) (UTM(M) ZONE 17 NORTH)

NAD'83 S.P.C.(FT)	N. 485,114.40	E. 1,639,177.97
NAD'83 GEO.	LAT-(N) 39.828728	LONG-(W) 80.672637
NAD'83 UTM (M)	N. 4,408,799.24	E. 528,013.32

LANDING POINT

NAD'83 S.P.C.(FT)	N. 486,408.2	E. 1,640,788.9
NAD'83 GEO.	LAT-(N) 39.829592	LONG-(W) 80.666915
NAD'83 UTM (M)	N. 4,408,898.9	E. 528,502.6

BOTTOM HOLE

NAD'83 S.P.C.(FT)	N. 471,287.3	E. 1,649,187.1
NAD'83 GEO.	LAT-(N) 39.788879	LONG-(W) 80.636297
NAD'83 UTM (M)	N. 4,404,333.1	E. 531,141.2

- NOTES ON SURVEY**
- NO WATER WELLS WERE FOUND WITHIN 250' OF PROPOSED GAS WELL. NO AGRICULTURAL BUILDINGS > 2500 SQ. FT. OR DWELLINGS WERE FOUND WITHIN 625' OF THE CENTER OF PROPOSED WELL PAD.
 - WELL SPOT CIRCLE & TOPO MARK SCALE ARE 1"=2000'
 - PROPOSED LATERAL OR TOP HOLE OF HUDSON S-14HU (47-051-02327) IS WITHIN 3000' OF THE TOP HOLES OR LATERALS OF HUDSON S-11HU (47-051-02296), HUDSON S-12HU (47-051-02292), HUDSON S-13HU (47-051-02293), HUDSON S-15HU (47-051-02328), HUDSON S-16HU (47-051-02329), FITZGERALD S-18HU (47-051-02325), FITZGERALD S-19HU (47-051-02328).
 - MINIMUM OFFSET SPACING REQUIREMENTS EXEMPTED BY WAIVER WITH THE WEST VIRGINIA DEPARTMENT OF ENVIRONMENTAL PROTECTION, OFFICE OF OIL AND GAS AND OFFSET LEASEHOLDER AGREEMENTS AS PROVIDED BY TUG HILL OPERATING.
 - WVDOT/DOH OWNERSHIP WITHIN UNIT SET FORTH IN WW-6A-1.
 - PLAT UPDATED TO SHOW AS DRILLED PATH.
 - AS DRILLED DATA PROVIDED BY TUG HILL OPERATING.

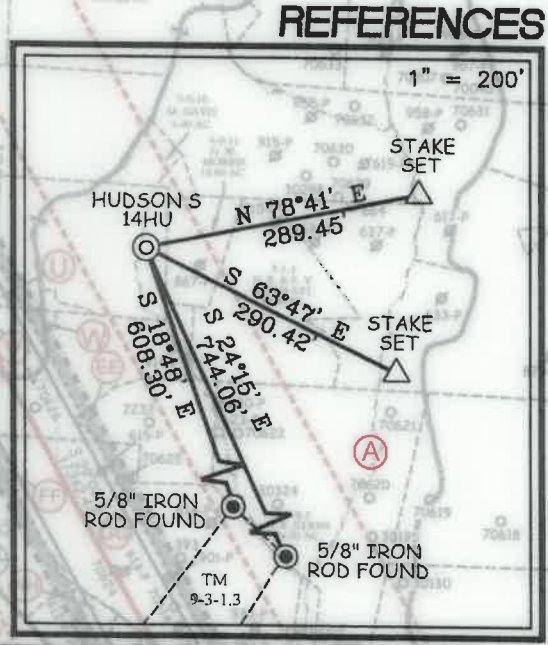

SLS
FROM THE GROUP UP

12 Venhorn Drive | P.O. Box 150 | Glenville, WV 26031 | 204.482.5634
1412 Kanawha Boulevard, East | Charleston, WV 25301 | 304.346.3959
254 East Beckley Bypass | Beckley, WV 26101 | 304.256.5296

slsvw.com

I THE UNDERSIGNED, HEREBY CERTIFY THAT THIS PLAT IS CORRECT TO THE BEST OF MY KNOWLEDGE AND BELIEF AND SHOWS ALL THE INFORMATION REQUIRED BY LAW AND THE REGULATIONS ISSUED AND PRESCRIBED BY THE DIVISION OF ENVIRONMENTAL PROTECTION.



P.S. 677 *Gregory A. Smith*

(+) DENOTES LOCATION OF WELL ON UNITED STATES TOPOGRAPHIC MAPS.

DATE SEPTEMBER 30 20 22

REVISED _____, 20 _____

OPERATORS WELL NO. HUDSON S-14HU

API WELL NO. 47-051-02327

STATE WEST VIRGINIA COUNTY MARSHALL PERMIT 102327

MINIMUM DEGREE OF ACCURACY 1/2500 FILE NO. 8911P14HUAD.dwg

HORIZONTAL & VERTICAL CONTROL DETERMINED BY DGPS (SURVEY GRADE TIE TO CORS NETWORK) SCALE 1" = 2000'

STATE OF WEST VIRGINIA
DIVISION OF ENVIRONMENTAL PROTECTION
OFFICE OF OIL AND GAS

WELL TYPE: OIL GAS INJECTION WASTE DISPOSAL IF "GAS" PRODUCTION STORAGE DEEP SHALLOW

LOCATION: ELEVATION GROUND = 1,366.50' PROPOSED = 1,344.81' WATERSHED HOT HOLLOW OF GRAVE CREEK (HUC 10)

DISTRICT MEADE COUNTY MARSHALL QUADRANGLE GLEN EASTON 7.5'

SURFACE OWNER CNX LAND LLC ACREAGE 106.935±

ROYALTY OWNER CHARLENE L. BAKER, ET AL ACREAGE 106.935±

PROPOSED WORK: DRILL CONVERT DRILL DEEPER REDRILL FRACTURE OR STIMULATE PLUG OFF OLD FORMATION PERFORATE NEW FORMATION PLUG AND ABANDON CLEAN OUT AND REPLUG OTHER

PHYSICAL CHANGE IN WELL (SPECIFY) SEE WW-6A TARGET FORMATION POINT PLEASANT ESTIMATED DEPTH TVD: 11,980' / TMD: 29,676'

WELL OPERATOR TUG HILL OPERATING, LLC DESIGNATED AGENT DARREN BROWN - CT CORPORATION

ADDRESS 1320 SOUTH UNIVERSITY DRIVE, SUITE 500 ADDRESS 5098 WASHINGTON ST. W, STE 407
FORT WORTH, TX 76107 CHARLESTON, WV 25313-1561

COUNTY NAME PERMIT

**HUDSON S LEASE
UTICA UNIT - 544.74 AC±
WELL 14HU
TUG HILL OPERATING**



12 Vanhorn Drive | P.O. Box 150 | Glenville, WV 26351 | 304.462.5634
1412 Kanawha Boulevard, East | Charleston, WV 25301 | 304.346.3952
254 East Beckley Bypass | Beckley, WV 25801 | 304.255.5296
slswv.com

NO.	Lease ID	Parcel	Tags	Grantor, Lessor, Etc.	Deed Book/Page	
1	10*26041	9-3-1	A	FREDDIE C WHITE AND VIOLET L WHITE, ET AL	728	527
2	10*28190	9-3-2.5	B	J RUSSELL LOGSDON, ET AL	1068	309
3	10*28190	9-3-2.6	C	J RUSSELL LOGSDON, ET AL	1068	309
4	10*21345	9-3-20	D	AARON PARRY SR AND JANA PARRY TRUSTEES AARON PARRY SR & JANA PARRY REV LIV TRUS, ET AL	957	280
5	10*28092	9-8-4.2	E	WEST VIRGINIA DEPARTMENT OF TRANSPORTATION DIVISION OF HIGHWAYS, ET AL	1073	370
6	10*21412	9-3-18	F	GARY DOBBS AND SUSAN DOBBS, ET AL	957	270
7	10*21412	9-3-18.2	G	GARY DOBBS AND SUSAN DOBBS, ET AL	957	270
8	10*28092	9-3-19	H	WEST VIRGINIA DEPARTMENT OF TRANSPORTATION DIVISION OF HIGHWAY, ET AL	1073	370
9	10*28092	9-3-19	I	WEST VIRGINIA DEPARTMENT OF TRANSPORTATION DIVISION OF HIGHWAY, ET AL	1073	370
10	10*22760	9-8-4.1	J	DONALD M AND THERESA L HARRIS, ET AL	968	294
11	10*21602	9-8-5.2	K	CAROL STACY SAUNDERS, ET AL	959	289
12	10*21412	9-3-18.3	L	GARY DOBBS AND SUSAN DOBBS, ET AL	957	270
13	10*3100	9-3-19	M	CHARLOTTE A WHITE	738	474
14	10*31000	9-8-5.1	N	CHARLOTTE A WHITE	738	474
15	10*23739	9-8-5	O	APPALACHIAN BASIN MINERALS LP, ET AL	1011	538
16	10*22745	9-8-11	P	BONNIE J JENKINS, ET AL	968	288
17	10*21246	9-8-10	Q	THE ESTATE OF THERESA M ROGERSON CHARLES J ROGERSON EXECUTOR, ET AL	952	422
18	10*31001	9-9-4	R	ERIC KATZMEYER, ET AL	791	226
19	10*28244	9-9-5	S	MICHAEL D DOBBS AND STEPHANIE J DOBBS, ET AL	1068	569
20	10*19987	9-9-16	T	LESLEY D BALLA, ET AL	955	103
21	10*21859	9-9-12	U	GARY WAYNE MORRIS	960	192
22	10*28697	9-9-14	V	DANNY S KERNS, ET AL	1075	134
23	10*28697	9-9-14.1	W	DANNY S KERNS, ET AL	1075	134
24	10*19987	9-9-16.1	X	LESLEY D BALLA, ET AL	955	103
25	10*27299	9-9-14.2	Y	NAUVOO CEMETERY ASSOCIATION	1057	357
26	10*27299	9-9-17	Z	NAUVOO CEMETERY ASSOCIATION	1057	357
27	10*24535	9-9-22	AA	BOARD OF EDUCATION OF MARSHALL COUNTY	1026	64
28	10*15494	9-12-11	BB	CHRISTOPHER SINGER AND SHEREA SINGER, ET AL	898	433
29	NA	9-9-15	CC	TRUSTEES OF THE REORGANIZED CHURCH OF LATTER DAY SAINTS	NA	NA
30	10*19557	9-12-12	DD	TERRY L BLAKE, ET AL	944	649
31	10*25518	7-8-1	EE	DANNY S KERNS, ET AL	1010	532
32	10*27774	9-9-18	FF	RESOURCE MINERALS HEADWATER I LP	1063	258
33	10*18339	9-12-14	GG	RESOURCE MINERALS HEADWATER I LP, ET AL	940	448
34	10*21512	9-12-15	HH	THE WHIPKEY TRUST, ET AL	949	266
35	10*18988	7-8-4	II	MICHAEL R DOBBS AND LEANNE DOBBS, ET AL	957	307
36	10*21112	7-8-5	JJ	CLARENCE C STOVER JR AND LOU E STOVER, ET AL	940	238
37	10*21112	7-8-8	KK	CLARENCE C STOVER JR AND LOU E STOVER, ET AL	952	382

DETAIL 1
SCALE: 1" = 500'

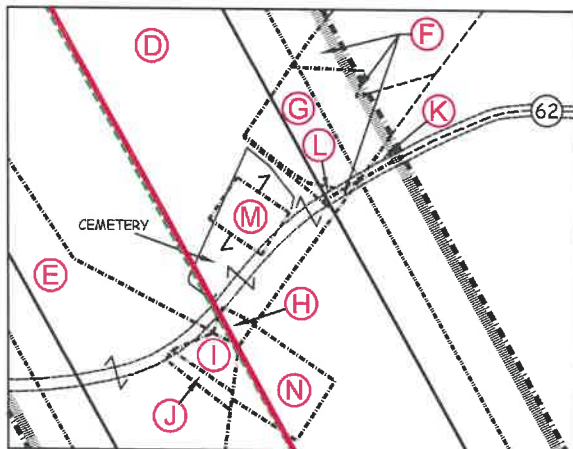

DETAIL 2
SCALE: 1" = 500'

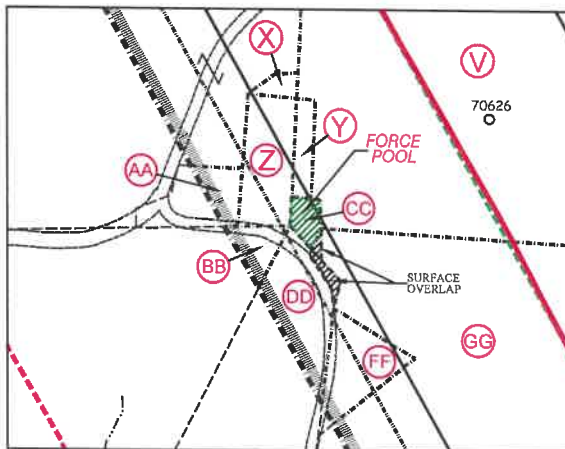

DETAIL 3
SCALE: 1" = 500'

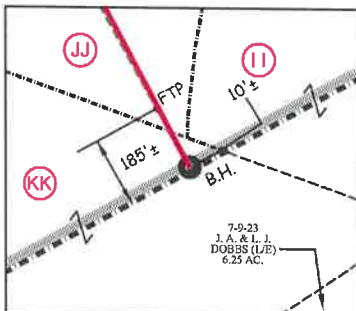

FILE NO. 8911P14HUAD.dwg
HUDSON S-14HU REV6

DATE SEPTEMBER 30, 20 22

REVISED _____, 20 _____

OPERATORS WELL NO. HUDSON S-14HU

API WELL NO. 47 — 051 — 02327

STATE STATE COUNTY COUNTY PERMIT PERMIT

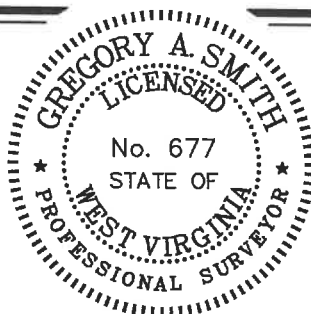

STATE OF WEST VIRGINIA
DIVISION OF ENVIRONMENTAL PROTECTION
OFFICE OF OIL AND GAS

10/21/2022

P.S. 677 *Gregory A. Smith*

WELL OPERATOR TUG HILL OPERATING, LLC ADDRESS 1320 SOUTH UNIVERSITY DRIVE, SUITE 500 FORT WORTH, TX 76107

DESIGNATED AGENT DARREN BROWN - CT CORPORATION ADDRESS 5098 WASHINGTON ST. W, STE 407 CHARLESTON, WV 25313-1561

COUNTY NAME _____
PERMIT _____