

**PENDLETON S-12HU**  
**UTICA UNIT - 241.0963± ACRES**  
**TUG HILL OPERATING**

**LEGEND**

- LEASE TRACTS
- SURFACE TRACTS
- WELL LATERAL
- POINT PLEASANT LEGS
- UNIT BOUNDARY
- (A) LEASE # (SEE 6A1 FORM)
- 400' BORE PATH OFFSET
- 500' WELL BORE OFFSET
- (FTP) PROPOSED FIRST TAKE POINT
- (LTP) PROPOSED LAST TAKE POINT

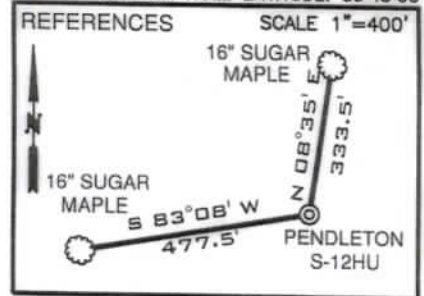
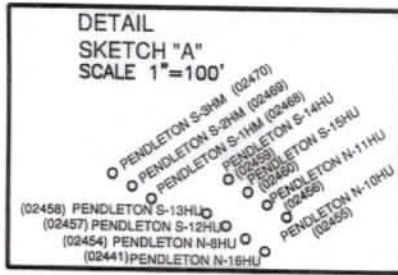

GRID NORTH

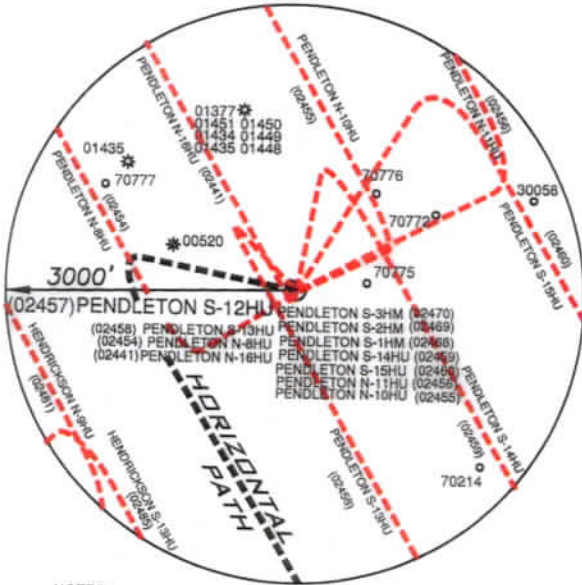

Deep Wells Within 2400' of Proposed Well's Surface Location and/or 500' of Well Lateral

API	OPERATOR
47-051-02441	Tug Hill Operating, LLC
47-051-02454	Tug Hill Operating, LLC
47-051-02455	Tug Hill Operating, LLC
47-051-02456	Tug Hill Operating, LLC
47-051-02458	Tug Hill Operating, LLC
47-051-02459	Tug Hill Operating, LLC
47-051-02460	Tug Hill Operating, LLC

**NOTES**

1. BORE PATH BASED ON GRID NORTH.
2. NO WATER WELLS WITHIN 250' OF WELL WERE FOUND, NO DWELLINGS WITHIN 625' OF PAD CENTER WERE FOUND.
3. OWNERSHIP TAKEN FROM PUBLIC RECORDS OF MARSHALL COUNTY, WV IN FEBRUARY, 2023. COORDINATES AND WELL TIES BASED UPON DIFFERENTIAL GPS MEASUREMENTS.
4. WELL LOCATION REFERENCES ARE BASED UPON THE MAGNETIC MERIDIAN.
5. ALL DEEP WELLS SHOWN ON THIS PLAT.
6. L.P.1 AND (L.T.P.) ARE AT THE SAME POINT.
7. THE FTP IS OVER 500' PERPENDICULAR TO THE BOUNDARY.

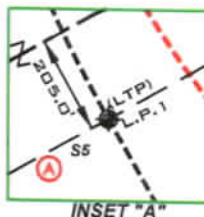

**SURFACE HOLE**  
 UTM. NAD83, ZONE 17  
 IN METERS  
 N) 4,400,422.33  
 E) 522,799.16

**LANDING POINT 1**  
 UTM. NAD83, ZONE 17  
 IN METERS  
 N) 4,400,280.46  
 E) 522,348.71

**BOTTOM HOLE**  
 UTM. NAD83, ZONE 17  
 IN METERS  
 N) 4,398,057.52  
 E) 523,661.48

LINE	BEARING	DISTANCE
L1	N 01°15' E	2,863.13'
L2	N 76°10' W	2,388.14'
L3	N 77°32' W	312.91'
L4	N 76°23' W	1,087.95'

CURVE	CHORD BEARING	CHORD LENGTH	RADIUS	ARC LENGTH
C1	N 76°36' W	212.53'	14,382.81'	212.53'
C2	N 89°11' W	62.71'	124.07'	63.39'
C3	S 53°50' W	58.39'	84.36'	59.62'
C4	S 23°09' W	53.24'	151.52'	53.52'
C5	S 02°48' W	122.08'	368.71'	122.65'
C6	S 12°23' E	246.65'	967.53'	247.32'
C7	S 24°27' E	404.82'	21,13.93'	405.44'

**LEGEND**

- LEASE TRACTS
- SURFACE TRACTS
- WELL LATERAL
- POINT PLEASANT LEGS
- UNIT BOUNDARY
- (A) LEASE # (SEE 6A1 FORM)

FILE NUMBER \_\_\_\_\_  
 DRAWING NUMBER: **PENDLETON S-12HU REV 4**  
 SCALE: 1" = 2000'  
 MINIMUM DEGREE OF ACCURACY: 1/200  
 PROVEN SOURCE OF ELEVATION: **SUBMETER MAPPING**  
**GRADE GPS**

I, THE UNDERSIGNED, HEREBY CERTIFY THAT THIS PLAT IS CORRECT TO THE BEST OF MY KNOWLEDGE AND BELIEF AND SHOWS ALL THE INFORMATION REQUIRED BY LAW AND THE RULES ISSUED AND PRESCRIBED BY THE DEPARTMENT OF ENVIRONMENTAL PROTECTION

P.S. 708

*David L Jackson*

JACKSON SURVEYING INC.  
 P.O. Box 1460  
 Clarksburg, WV 26302  
 304-623-5851

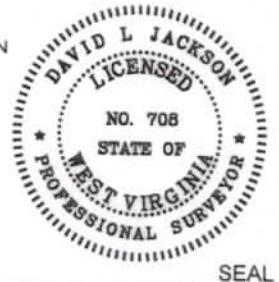

WVDEP  
 OFFICE OF OIL & GAS  
 601 57TH STREET, SE  
 CHARLESTON, WV 25304

DATE: **MARCH 13, 2023**  
 OPERATORS WELL NO. **PENDLETON S-12HU**  
 API WELL NO. **47-051-02457**  
 STATE COUNTY PERMIT

WELL TYPE: OIL \_\_\_ GAS X LIQUID INJECTION \_\_\_ WASTE DISPOSAL \_\_\_  
 (IF "GAS") PRODUCTION X STORAGE \_\_\_ DEEP X SHALLOW \_\_\_

LOCATION ELEVATION **1271.82'** WATERSHED (HUC 10) **FISH CREEK**

DISTRICT **FRANKLIN** COUNTY **MARSHALL**

QUADRANGLE **GLEN EASTON 7.5'** LEASE NUMBER **SEE WW-6A1 Form**

SURFACE OWNER **ALPINE FARM, LLC** ACREAGE **249.07**

OIL & GAS ROYALTY OWNER **ELI A. & FANNIE MAE WENGERD, ET AL** LEASE ACREAGE **249.07**

PROPOSED WORK: DRILL X CONVERT \_\_\_ DRILL DEEPER \_\_\_ REDRILL \_\_\_ FRACTURE OR STIMULATE X PLUG OFF OLD FORMATION \_\_\_  
 PERFORATE NEW FORMATION \_\_\_ OTHER PHYSICAL CHANGE (SPECIFY) \_\_\_\_\_

TARGET FORMATION **POINT PLEASANT** PLUG & ABANDON \_\_\_ CLEAN OUT & REPLUG \_\_\_  
 ESTIMATED DEPTH TVD: **11,765'** TMD: **20,752'**

WELL OPERATOR **TUG HILL OPERATING, LLC** DESIGNATED AGENT **DARREN BROWN, CT CORP**  
 ADDRESS **1320 SOUTH UNIVERSITY DRIVE, SUITE 500 FORT WORTH, TX 76107** ADDRESS **5098 WASHINGTON STREET WEST, SUITE 407 CHARLESTON, WV 25313-1561**

**04/28/2023**

COUNTY NAME  
 PERMIT



PENDLETON S-12HU  
UTICA UNIT - 241.0963± ACRES  
TUG HILL OPERATING

**LEGEND**

- LEASE TRACTS
- - - SURFACE TRACTS
- - - WELL LATERAL
- - - POINT PLEASANT LEGS
- - - UNIT BOUNDARY
- (A) LEASE # (SEE 6A1 FORM)
- 400' BORE PATH OFFSET
- 500' WELL BORE OFFSET
- (FTP) PROPOSED FIRST TAKE POINT
- (LTP) PROPOSED LAST TAKE POINT

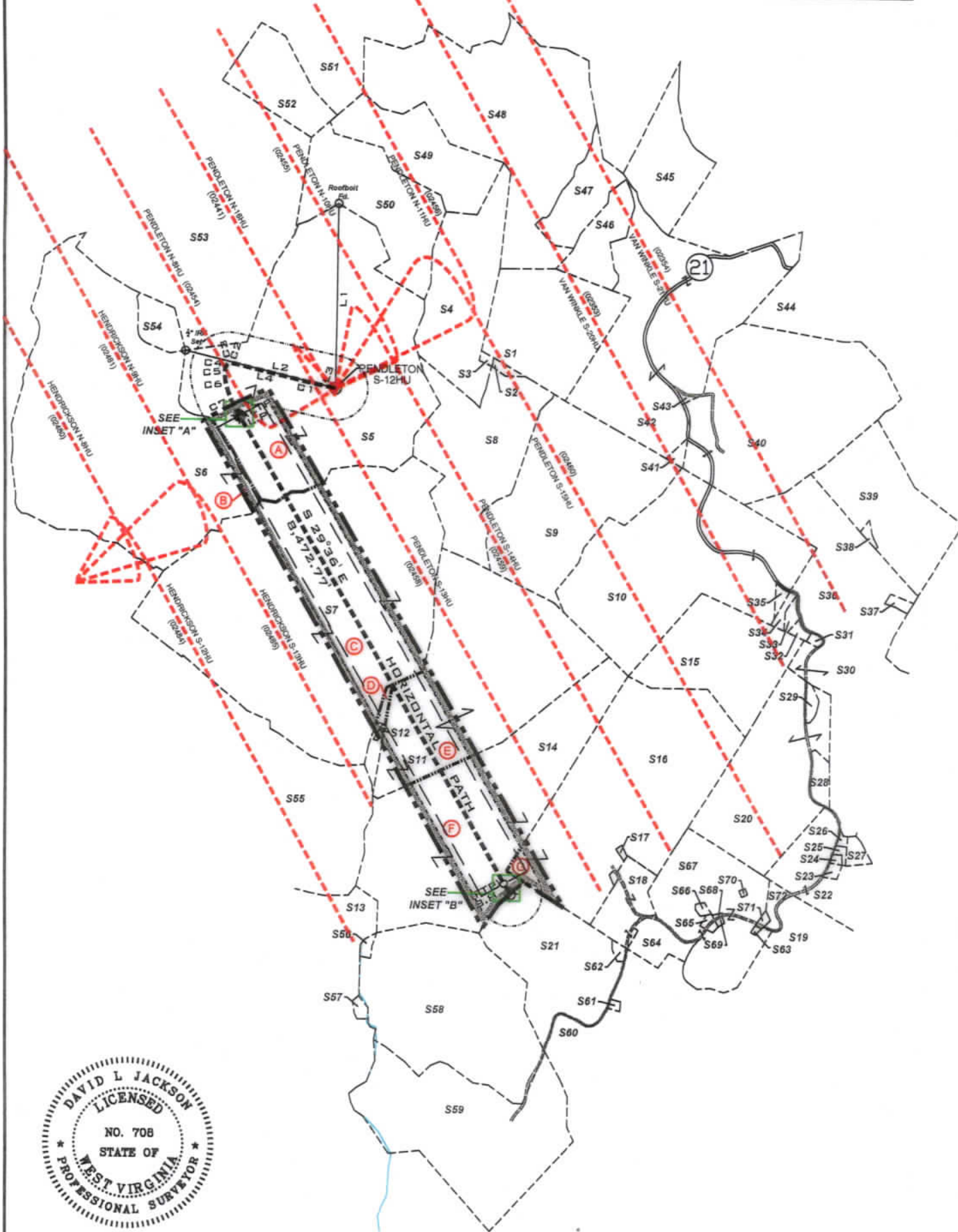

P.S. 708 *David L Jackson*

04/28/2023



**TUG HILL**  
OPERATING

OPERATOR'S  
WELL #: PENDLETON S-12HU  
API#: 47-051-02457  
DISTRICT: Franklin  
COUNTY: Marshall  
STATE: WV

WELL PLAT  
PAGE 2 OF 4  
DATE: 03/13/2023

form 996

**PENDLETON S-12HU  
UTICA UNIT - 241.0963 ACRES  
TUG HILL OPERATING**

Parcels Within Unit Boundary				
Tags	Number	Tax Map -Parcel	Surface Owner	Acres
A	S5	05-17-06	ALPINE FARM, LLC	249.07
B	S6	05-17-08	ROGER H. HALL, JR	257.50
C	S7	05-24-02	ROY FRIEND YOHO	316.80
D	S12	09-20-01	MICHAEL JAMES PEKULA	5
E	S11	09-20-02	MICHAEL JAMES PEKULA	138
F	S14	09-20-04	SHELLIE J. PEKULA, HRS	171
G	S16	09-20-05	GERALD A. FROHNAPFEL ET UX - TRUST	164.143
Number	Tax Map -Parcel	Adjoining Parcels		Acres
S1	09-16-04	BERTHA L. KLUG		73.39
S2	09-18-03	BERTHA L. KLUG		1.33
S3	09-18-04	BERTHA L. KLUG		1
S4	09-16-03	BERTHA L. KLUG (S)		71
S8	09-18-01	THERESA MAE LONG THOMAS, ET AL		58.66
S9	09-18-02	BRIAN T. KLUG		85
S10	09-18-18	JAMES D. FROHNAPFEL, ET UX		154.03
S13	05-25-03	S.D. & SUSAN SMITH FERTITTA		181.548
S15	09-20-06	KEITH & KRISTY FERRELL REVOCABLE LIVING TRUST		64.75
S17	09-20-5.2	WHEELING CATHOLIC DIOCESE		.447
S18	09-22-04	WHEELING CATHOLIC DIOCESE		20
S19	09-20-17	MARTIN L. KLUG		49.78
S20	09-20-07	SONNY M & LINDA L TAGG		72.828
S21	09-22-3.2	MARK H. MILLER		75
S22	09-20-9	JOHN G. JR & MARILYN S. WEIGAND		48.131
S23	09-20-9.4	HELEN B. SHUTLER - LIFE		.78
S24	09-20-10	JAMES MILLER, ET UX		.50
S25	09-20-9.3	JAMES MILLER, ET UX		.804
S26	09-20-9.5	JAMES MILLER, ET UX		.666
S27	09-20-9.6	JAMES MILLER, ET UX		2.919
S28	09-20-7.1	DAVID PAUL FROHNAPFEL		4.930
S29	09-20-7.2	MICKEY R. DULANEY, JR		2.242
S30	09-18-15	KEITH & KRISTY FERRELL REVOCABLE LIVING TRUST		29.5
S31	09-18-15.1	NICHOLAS C. FROHNAPFEL, ET UX		0.68
S32	09-18-16.1	NICHOLAS C. FROHNAPFEL, ET UX		1.50
S33	09-18-16.3	BERNARD A KLUG ET UX, ESTS		1.818
S34	09-18-16.2	JOHN F. WAYMAN, EST		2.17
S35	09-18-18.1	JOHN .F WAYMAN, EST		1.1
S36	09-18-16	ROBERT F. VILLERS		62.893
S37	09-18-16.4	ROBERT F. & APRIL L. VILLERS		1.509
S38	09-18-17.1	VINCENT JOHN WAYMAN		1.010
S39	09-18-17	VINCENT J. WAYMAN		68.99
S40	09-18-06	LOUIS FOX		141.75
S41	09-18-5.1	LOUIS FOX		1.583
S42	09-18-05	BERTHA L. KLUG		122.437
S43	09-18-5.2	LOUIS FOX		0.933
S44	09-16-20	LOUIS T. FOX		86.174
S45	09-16-11	JAMES G. RICHMOND		67.882
S46	09-16-07	BERTHA KLUG		26.105
S47	09-16-06	ROBERT M. & NANCY R. MCCARDLE		31
S48	09-16-05	ROBERT M. & NANCY R. MCCARDLE		133
S49	09-16-02	ROBERT M. & NANCY MCCARDLE		53.40
S50	05-17-05	ALPINE FARM, LLC		76.96
S51	09-16-01	ROBERT M. & NANCY R. MCCARDLE		46.80
S52	05-16-13	DAVID ALAN RUBCICH, ET AL		33.31
S53	05-17-04	ALPINE FARM, LLC		212
S54	05-17-07	ALPINE FARM, LLC		10.8
S55	05-24-3.3	CHARLES E. & DEBRA K. BERTRAND		120.433
S56	09-22-1.1	CNG TRANSMISSION CO		1.43
S57	05-25-3.2	CONSOL ENERGY HOLDINGS, LLC., XVI		1.43
S58	09-22-01	LOUIS T. FOX		124.57
S59	09-22-02	MARK H. J. MILLER, ETAL		124.80
S60	09-22-03	MARK HILARY MILLER		63.73
S61	09-22-3.3	MARY C. WRIGHT		.617
S62	09-22-3.1	MARGARET ANN MYSLUWIEC - LIFE		1.1
S63	09-20-22.6	MARY MARGARET STINE		0.1185
S64	09-22-5.1	HILARY G. MILLER, EST		10.62
S65	09-20-22.7	JOAN L. KLUG		1.06
S66	09-20-22.8	JOAN LOUISE KLUG		.80
S67	09-20-22	CHARLES DILLON BLAKE & ALLISON R. KLUG		70.2398
S68	09-20-22.4	CHARLES DILLON BLAKE & ALLISON R. KLUG		0.165
S69	09-20-22.5	CHARLES DILLON BLAKE & ALLISON R. KLUG		.3767
S70	09-20-22.3	GRANDVIEW-DOOLIN PSD		0.23
S71	09-20-22.1	MARY MARGARET STINE		04/28/2023
S72	09-20-21	MARY MARGARET STINE		3.25



P.S. 708

*David L Jackson*



**TUG HILL  
OPERATING**

OPERATOR'S  
WELL #: PENDLETON S-12HU  
API#: 47-051-02457  
DISTRICT: Franklin  
COUNTY: Marshall  
STATE: WV

**WELL PLAT**  
**PAGE 3 OF 4**  
**DATE: 03/13/2023**



form wv6

**PENDLETON S-12HU  
 UTICA UNIT - 241.0963± ACRES  
 TUG HILL OPERATING**

Lease ID	TMP	Tag	Grantor, Lessor, Etc.	Deed Book/Page	
10*14114	5-17-6	A	ELI & FANNIE MAE WENGERD	671	323
10*14460	5-17-8	B	GERTRUD GODDARD, H G WELLS AIF, ET AL	725	515
10*14024	5-24-2	C	ROY FRIEND YOHO AND DARLENE J YOHO, ET AL	665	508
10*39661	9-20-1	D	SHELLIE J PEKULA AND MICHAEL PEKULA	1126	542
10*39661	9-20-2	E	SHELLIE J PEKULA AND MICHAEL PEKULA	1126	542
10*31101	9-20-4	F	ELIZABETH BRINKMEIER ET AL	103	183
10*19555	9-20-5	G	MARY JEAN FROHNAPFEL	936	936



P.S. *David L Jackson*  
 708

04/28/2023



**TUG HILL  
 OPERATING**

OPERATOR'S  
 WELL #: PENDLETON S-12HU  
 API#: 47-051-02457  
 DISTRICT: Franklin  
 COUNTY: Marshall  
 STATE: WV

**WELL PLAT**  
 PAGE 4 OF 4  
 DATE: 03/13/2023