

form: wv6

PENDLETON S-14HU
UTICA UNIT - 288.5447± ACRES
TUG HILL OPERATING

LEGEND

- LEASED TRACTS
- SURFACE TRACTS
- WELL LATERAL
- POINT PLEASANT LEGS
- UNIT BOUNDARY
- LEASE # (SEE GA1 FORM)
- 400' BORE PATH OFFSET
- 500' WELL BORE OFFSET
- (FTP) PROPOSED FIRST TAKE POINT
- (LTP) PROPOSED LAST TAKE POINT

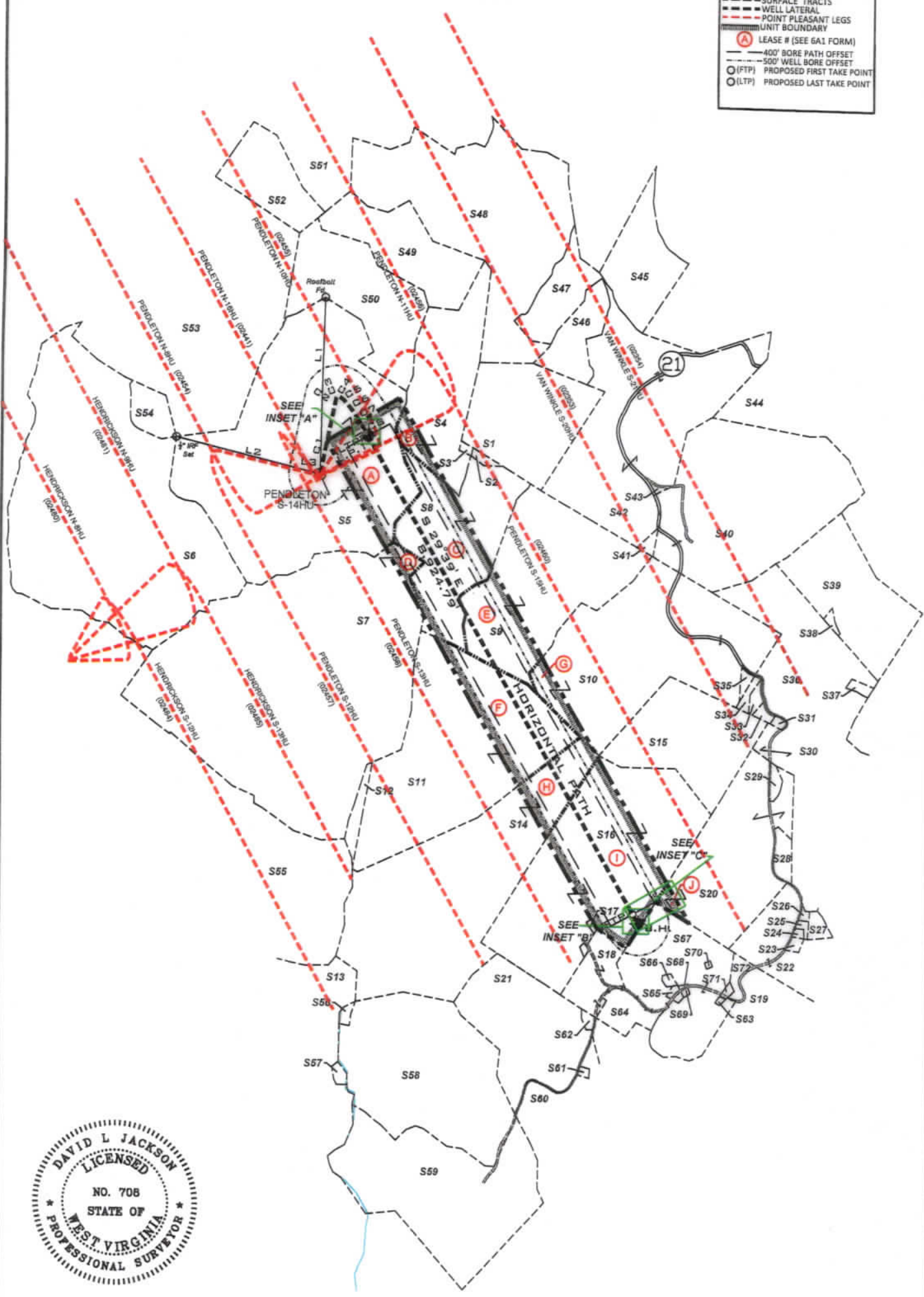

P.S. 708 *David L Jackson*

04/28/2023



TUG HILL
OPERATING

OPERATOR'S
WELL #: PENDLETON S-14HU
DISTRICT: Franklin
COUNTY: Marshall
STATE: WV
API #: 47-051-02459

WELL PLAT
PAGE 2 OF 4
DATE: 3/13/2023

form .wv6

**PENDLETON S-14HU
UTICA UNIT - 288.5447± ACRES
TUG HILL OPERATING**

Parcels Within Unit Boundary				
Tags	Number	Tax Map -Parcel	Surface Owner	Acres
A	S5	05-17-06	ALPINE FARM, LLC	249.07
B	S4	09-16-03	BERTHA L. KLUG	71
C	S8	09-18-01	THERESA MAE LONG THOMAS, ET AL	58.66
D	S7	05-24-02	ROY FRIEND YOHO	316.80
E	S9	09-18-02	BRIAN T. KLUG	85
F	S11	09-20-02	MICHAEL JAMES PEKULA	138
G	S10	09-18-18	JAMES D. FROHNAPFEL, ET UX (154.03
H	S14	09-20-04	SHELLIE J. PEKULA, HRS	171
I	S16	09-20-05	GERALD A. FROHNAPFEL ET UX - TRUST	164.143
J	S20	09-20-07	SONNY M & LINDA L. TAGG	72.828
Number	Tax Map -Parcel	Adjoining Parcels		Acres
S1	09-16-04	BERTHA L. KLUG		73.39
S2	09-18-03	BERTHA L. KLUG		1.33
S3	09-18-04	BERTHA L. KLUG		1
S6	05-17-08	ROGER H. HALL, JR		257.50
S12	09-20-01	MICHAEL JAMES PEKULA		5
S13	05-25-03	S.D. & SUSAN SMITH FERTITTA		181.548
S15	09-20-06	KEITH & KRISTY FERRELL REVOCABLE LIVING TRUST		64.75
S17	09-20-5.2	WHEELING CATHOLIC DIOCESE		.447
S18	09-22-04	WHEELING CATHOLIC DIOCESE		20
S19	09-20-17	MARTIN L. KLUG		49.78
S21	09-22-3.2	MARK H. MILLER		75
S22	09-20-9	JOHN G. JR & MARILYN S. WEIGAND		48.131
S23	09-20-9.4	HELEN B. SHUTLER - LIFE		.78
S24	09-20-10	JAMES MILLER, ET UX		.50
S25	09-20-9.3	JAMES MILLER, ET UX		.804
S26	09-20-9.5	JAMES MILLER, ET UX		.666
S27	09-20-9.6	JAMES MILLER, ET UX		2.919
S28	09-20-7.1	DAVID PAUL FROHNAPFEL		4.930
S29	09-20-7.2	MICKEY R. DULANEY, JR		2.242
S30	09-18-15	KEITH & KRISTY FERRELL REVOCABLE LIVING TRUST		29.5
S31	09-18-15.1	NICHOLAS C. FROHNAPFEL, ET UX		0.68
S32	09-18-16.1	NICHOLAS C. FROHNAPFEL, ET UX		1.50
S33	09-18-16.3	BERNARD A KLUG ET UX ESTS.		1.818
S34	09-18-16.2	JOHN F. WAYMAN, EST		2.17
S35	09-18-18.1	JOHN F. WAYMAN, EST		1.1
S36	09-18-16	ROBERT F. VILLERS		62.893
S37	09-18-16.4	ROBERT F. & APRIL L. VILLERS		1.509
S38	09-18-17.1	VINCENT JOHN WAYMAN		1.010
S39	09-18-17	VINCENT J. WAYMAN		68.99
S40	09-18-06	LOUIS FOX		141.75
S41	09-18-5.1	LOUIS FOX		1.583
S42	09-18-05	BERTHA L. KLUG		122.437
S43	09-18-5.2	LOUIS FOX		0.933
S44	09-16-20	LOUIS T. FOX		86.174
S45	09-16-11	JAMES G. RICHMOND		67.882
S46	09-16-07	BERTHA L. KLUG		26.105
S47	09-16-06	ROBERT M. & NANCY R. MCCARDLE		31
S48	09-16-05	ROBERT M. & NANCY R. MCCARDLE		133
S49	09-16-02	ROBERT M. & NANCY MCCARDLE		53.40
S50	05-17-05	ALPINE FARM, LLC		76.96
S51	09-16-01	ROBERT M. & NANCY R. MCCARDLE		46.80
S52	05-16-13	DAVID ALAN RUBCICH, ET AL		33.31
S53	05-17-04	ALPINE FARM, LLC		212
S54	05-17-07	ALPINE FARM, LLC		10.8
S55	05-24-3.3	CHARLES E. & DEBRA K. BERTRAND		120.433
S56	09-22-1.1	CNG TRANSMISSION CO		1.43
S57	05-25-3.2	CONSOL ENERGY HOLDINGS, LLC., XVI		1.43
S58	09-22-01	LOUIS T. FOX		124.57
S59	09-22-02	MARK H. J. MILLER, ETAL		124.80
S60	09-22-03	MARK HILARY MILLER		63.73
S61	09-22-3.3	MARY C. WRIGHT		.617
S62	09-22-3.1	MARGARET ANN MYSLIWIEC - LIFE		1.1
S63	09-20-22.6	MARY MARGARET STINE		0.1185
S64	09-22-5.1	HILARY G. MILLER, EST		10.62
S65	09-20-22.7	JOAN L. KLUG		1.06
S66	09-20-22.8	JOAN LOUISE KLUG		.80
S67	09-20-22	CHARLES DILLON BLAKE & ALLISON R. KLUG		70.2398
S68	09-20-22.4	CHARLES DILLON BLAKE & ALLISON R. KLUG		0.165
S69	09-20-22.5	CHARLES DILLON BLAKE & ALLISON R. KLUG		.3767
S70	09-20-22.3	GRANDVIEW-DOOLIN PSD		0.23
S71	09-20-22.1	MARY MARGARET STINE		04/28/2023
S72	09-20-21	MARY MARGARET STINE		3.25



P.S. 708 *David L Jackson*



**TUG HILL
OPERATING**

OPERATOR'S
WELL #1: PENDLETON S-14HU
DISTRICT: Franklin
COUNTY: Marshall
STATE: WV
API #: 47-051-02459

WELL PLAT
PAGE 3 OF 4
DATE: 3/13/2023

**PENDLETON S-14HU
 UTICA UNIT - 288.5447± ACRES
 TUG HILL OPERATING**

Lease ID	TMP	Tag	Grantor, Lessor, Etc.	Deed Book/Page	
10*14114	5-17-6	A	ELI & FANNIE MAE WENGERD	671	323
10*19638	9-16-3	B	GREGORY J HALL, ET AL	944	461
10*28262	9-18-1	C	JAMES W MESSEY ET AL	67	487
10*14024	5-24-2	D	ROY FRIEND AND DARLENE J YOHO, ET AL	665	508
10*28262	9-18-2	E	JAMES W MESSEY ET AL	67	487
10*39661	9-20-2	F	SHELLIE J AND MICHAEL PEKULA	1126	542
10*47051.047.1	9-18-18	G	JAMES E BLATT, ET AL	869	587
10*31101	9-20-4	H	ELIZABETH BRINKMEIER ET AL	103	183
10*19555	9-20-5	I	MARY JEAN FROHNAPFEL	936	525
10*19343	9-20-7	J	SONNY M TAGG AND LINDA L TAGG	936	521



P.S. 708 *David L Jackson*

04/28/2023

	OPERATOR'S WELL #: <u>PENDLETON S-14HU</u>	WELL PLAT PAGE 4 OF 4
	DISTRICT: <u>Franklin</u>	DATE: <u>3/13/2023</u>
	COUNTY: <u>Marshall</u>	
	STATE: <u>WV</u>	
	API #: <u>47-051-02459</u>	