



---

west virginia department of environmental protection

---

Office of Oil and Gas  
601 57<sup>th</sup> Street, S.E.  
Charleston, WV 25304  
(304) 926-0450  
fax: (304) 926-0452

Harold D. Ward, Cabinet Secretary  
[www.dep.wv.gov](http://www.dep.wv.gov)

Friday, October 27, 2023  
PERMIT MODIFICATION APPROVAL  
Horizontal 6A / New Drill

SWN PRODUCTION COMPANY, LLC  
POST OFFICE BOX 12359

SPRING, TX 773914954

Re: Permit Modification Approval for DAVID REINBEAU MSH 406H  
47-051-02499-00-00

**Updated lateral leases**

SWN PRODUCTION COMPANY, LLC

The Office of Oil and Gas has reviewed the attached permit modification for the above referenced permit. The attached modification has been approved and well work may begin. Please be reminded that the oil and gas inspector is to be notified twenty-four (24) hours before permitted well work is commenced.

If there are any questions, please feel free to contact me at (304) 926- 0450.

James A. Martin  
Chief

Operator's Well Number: DAVID REINBEAU MSH 406H  
Farm Name: SHELLY A & DAVID W REINBEAU  
U.S. WELL NUMBER: 47-051-02499-00-00  
Horizontal 6A New Drill  
Date Modification Issued: 10/27/2023

Promoting a healthy environment.

10/27/2023

**4705102409**

**STATE OF WEST VIRGINIA**  
**DEPARTMENT OF ENVIRONMENTAL PROTECTION, OFFICE OF OIL AND GAS**  
**WELL WORK PERMIT APPLICATION**

1) Well Operator: SWN Production Co., LLC 494512924 051- Marsha 07-Union 486-Moundsville  
Operator ID County District Quadrangle

2) Operator's Well Number: David Reinbeau MSH 406H Well Pad Name: David Reinbeau MSH

3) Farm Name/Surface Owner: Shelly A & David W. Reinbeau Public Road Access: Sorghum Ridge Road

4) Elevation, current ground: 1251' Elevation, proposed post-construction: 1251'

5) Well Type (a) Gas  Oil  Underground Storage

Other

(b) If Gas Shallow  Deep

Horizontal

6) Existing Pad: Yes or No Yes

7) Proposed Target Formation(s), Depth(s), Anticipated Thickness and Expected Pressure(s):  
Target Formation- Marcellus, Down-Dip well to the North, Target Top TVD- 6431', Target Base TVD- 6488', Anticipated Thickness- 57', Associated Pressure- 4217

8) Proposed Total Vertical Depth: 6483'

9) Formation at Total Vertical Depth: Marcellus

10) Proposed Total Measured Depth: 25709'

11) Proposed Horizontal Leg Length: 16628.40'

12) Approximate Fresh Water Strata Depths: 426'

13) Method to Determine Fresh Water Depths: Deepest Nearby Water Well

14) Approximate Saltwater Depths: 883'- Salinity Profile

15) Approximate Coal Seam Depths: 774'

16) Approximate Depth to Possible Void (coal mine, karst, other): None that we are aware of.

17) Does Proposed well location contain coal seams directly overlying or adjacent to an active mine? Yes  No

(a) If Yes, provide Mine Info: Name: \_\_\_\_\_  
Depth: \_\_\_\_\_  
Seam: \_\_\_\_\_  
Owner: \_\_\_\_\_

*Strader Gower*

9/27/2023

10/27/2023  
Page 1 of 9

RECEIVED  
Office of Oil and Gas  
OCT 12 2023  
WV Department of  
Environmental Protection

18)

**CASING AND TUBING PROGRAM**

**47 05 10 24 99**

TYPE	Size (in)	New or Used	Grade	Weight per ft. (lb/ft)	FOOTAGE: For Drilling (ft)	INTERVALS: Left in Well (ft)	CEMENT: Fill-up (Cu. Ft.)/CTS
Conductor	20"	New	J-55	94#	110'	110'	CTS
Fresh Water	13 3/8"	New	J-55	54.4#	476'	476'	551 sx/CTS
Coal	See	Interm	Casing				
Intermediate	9 5/8"	New	J-55	36#	2069'	2069'	789 sx/CTS
Production	5 1/2"	New	P-110 HP	20#	25709'	25709'	Tell 4592sz/ 100' Inside Intermediate
Tubing							
Liners							

TYPE	Size (in)	Wellbore Diameter (in)	Wall Thickness (in)	Burst Pressure (psi)	Anticipated Max. Internal Pressure (psi)	Cement Type	Cement Yield (cu. ft./k)
Conductor	20"	30"	0.25	2120	81	Class A	1.20/30% Excess
Fresh Water	13 3/8"	17.5"	0.380	2730	633	Class A	1.20/30% Excess
Coal	See	Interm	Casing				
Intermediate	9 5/8"	12 1/4"	0.395	3950	1768	Class A	1.19/40% Excess
Production	5 1/2"	8 3/4"-8 1/2"	0.361	14360	10500	Class A	1.19/5% Excess
Tubing							
Liners							

RECEIVED  
Office of Oil and Gas

OCT 12 2023

WV Department of  
Environmental Protection

**PACKERS**

Kind:				
Sizes:				
Depths Set:				

*Strader Gower*

9/27/2023

10/27/2023  
Page 2 of 3

4705102499

19) Describe proposed well work, including the drilling and plugging back of any pilot hole:

Drill and stimulate any potential zones between and including the Benson to Marcellus. \*\*If we should encounter a void place basket above and below void area- balance cement to bottom of void and grout from basket to surface or run external casing packer/cementing stage tool above void interval and perform 2 stage cementing operation dependent upon depth of void. Run casing not less than 20' below void nor more than 75' below void. (\*If freshwater is encountered deeper than anticipated it must be protected, set casing 50' below and cts.)

20) Describe fracturing/stimulating methods in detail, including anticipated max pressure and max rate:

Well will be perforated within the target formation and stimulated with a slurry of water, sand, and chemical additives at a high rate. This will be performed in stages with the plug and perf method along the wellbore until the entire lateral has been stimulated within the target formation. All stage plugs are then drilled out and the well is flowed back to surface. In some instances, additional toe prep may be performed by pumping additional water in the toe of the well prior to perforating and pumping Stage 1 to ensure that the toe guns/toe sleeves are fully open prior to pumping stage 1. The well is produced through surface facilities consisting of high pressure production units, horizontal separation units, water and oil storage tanks. Max press and anticipated max rate- 12,500 psi @ 100 barrels a minute.

21) Total Area to be disturbed, including roads, stockpile area, pits, etc., (acres): 18.42

22) Area to be disturbed for well pad only, less access road (acres): 10.4

23) Describe centralizer placement for each casing string:

All casing strings will be ran with a centralizer at a minimum of 1 per every 3 joints of casing.

24) Describe all cement additives associated with each cement type:

See Attachment \*\*\*

RECEIVED  
Office of Oil and Gas  
OCT 12 2023  
WV Department of  
Environmental Protection

25) Proposed borehole conditioning procedures:

All boreholes will be conditioned with circulation and rotation for a minimum of one bottoms up and continuing until operator is satisfied with borehole conditions.

\*Note: Attach additional sheets as needed.

**Southwestern Energy Company**

**Proposed Drilling Program**



Well: DAVID REINBEAU MSH 406  
 Field: NORTH VICTORY FIELD WET  
 County: MARSHALL  
 SHL (NAD83): 39.992768 Latitude -80.661534 Longitude  
 BHL (NAD83): 39.942272 Latitude -80.646833 Longitude  
 KB Elev: 1,277 ft MSL KB: 26 ft AGL  
 Re-entry Rig: SDC 41  
 Prospect: Marcellus Shale  
 State: WV  
 GL Elev: 1,251 ft MSL

NO COAL VOID EXPECTED

PROD TOC @ 2,069' MD

TUBULAR DETAIL					
Casing String	Casing Size (in)	Weight (Min)	Grade (Min)	Planned Interval	
				From	To
Conductor	20	94.0 #	J-55	0'	110'
Surface	13.375	54.4 #	J-55	0'	476'
Intermediate/Coal	9.625	36.0 #	J-55	0'	2,069'
Production	5.5	20.0 #	P-110 HP	0'	25,709'

**CEMENT DETAIL**

	Sacks	Class	Density
Conductor	140	A	19.3
Surface	551	A	15.6
Intermediate	789	A	15.6
Production	4592	A	14.5-15.0

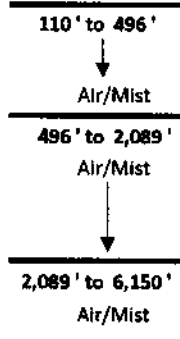

KOP at 6,150' MD

Freshwater Depth - 426' TVD  
 Coal Depth - 774' TVD  
 Saltwater Depth - 883' TVD  
 TVD - 6,483'  
 TMD - 25,709'

RECEIVED  
 Office of Oil & Gas  
 OCT 12 2023  
 WV Department of Environmental Protection

6,365' TVD Target Center

TD at 25,709' MD  
 6,483' TVD

LP at 7,192' MD  
 SHL Onondaga 6,376' TVD

Onondaga 6,494' TVD  
 7,192' to 25,709'  
 12.5-13.5 ppg

September 28, 2023

Mr. Charles Brewer  
Office of Oil & Gas  
601 57<sup>th</sup> Street  
Charleston, WV 25304

**RE:** Proposed New Well: David Reinbeau MSH 406H

Dear Mr. Brewer:

SWN has reviewed the area of the above mentioned well and discovered no shallow wells within 500' of the lateral. This well is situated on the Reinbeau's property, in Union District, Marshall County, West Virginia.

If you have any questions or desire additional information, please me at 304-884-1613.

Thank you.

Sincerely,



Brittany Woody  
Staff Regulatory Specialist  
Southwestern Energy Production Company, LLC

RECEIVED  
Office of Oil and Gas  
OCT 12 2023  
WV Department of  
Environmental Protection



10/27/2023

JACKSON SURVEYING  
 INC.  
 2413 EAST PIKE ST. # 112  
 Clarksburg, WV 26302  
 304-623-5851

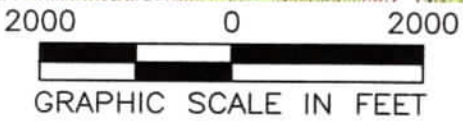
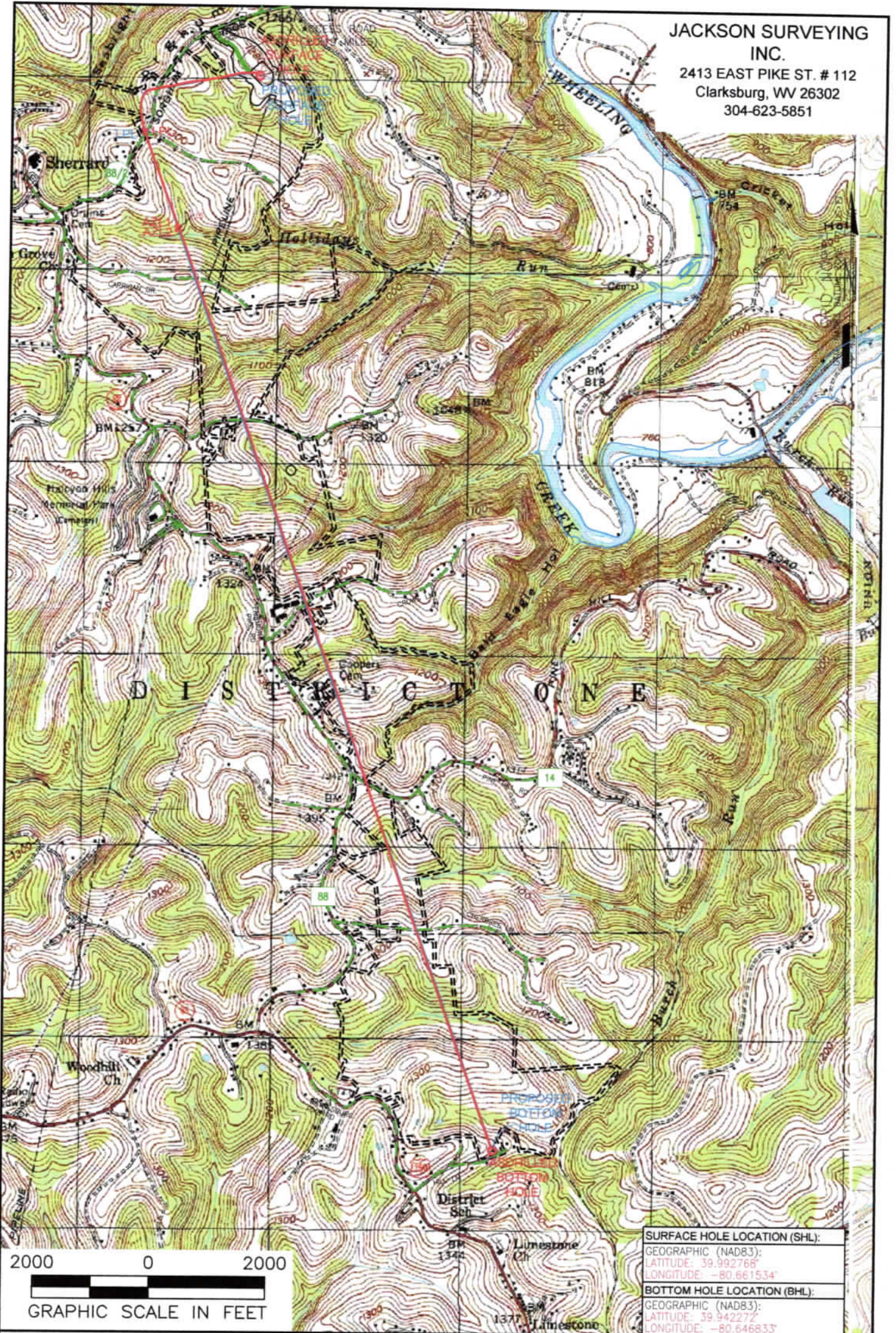

<b>SURFACE HOLE LOCATION (SHL):</b>	
GEOGRAPHIC (NAD83):	
LATITUDE: 39.992768°	LONGITUDE: -80.661534°
<b>BOTTOM HOLE LOCATION (BHL):</b>	
GEOGRAPHIC (NAD83):	
LATITUDE: 39.942272°	LONGITUDE: -80.646833°

**NOTES ON SURVEY**  
 1. SURFACE AND ROYALTY OWNER INFORMATION AND THEIR BOUNDARIES SHOWN HEREON WERE PLOTTED FROM DEEDS AND/OR TAX PARCEL MAPS PROVIDED BY CLIENT AND/OR FIELD LOCATIONS.  
 2. THIS PLAT DOES NOT REPRESENT A BOUNDARY SURVEY OF THE PARCELS SHOWN HEREON.  
 4. ALL INSETS ARE GRID NORTH UNLESS OTHERWISE DEPICTED.

<b>LEGEND:</b>	<b>10/27/2023</b>
○ PROPOSED SURFACE HOLE / BOTTOM HOLE	— DRILLING UNIT
⊗ EXISTING / PRODUCING WELLHEAD	== LEASE BOUNDARY
LPL LANDING POINT LOCATION	— ASDRILLED PATH
⊕ EXISTING WATER WELL	— PROPOSED PATH
⊙ EXISTING SPRING	

<b>WELL OPERATOR:</b> SWN PRODUCTION COMPANY, LLC	<b>API #:</b> 47-051-02499	<b>WELL (FARM) NAME:</b> DAVID REINBEAU MSH	<b>WELL #</b> 406H
<b>ADDRESS:</b> 1300 FORT PIERPONT ROAD, SUITE 200 MORGANTOWN, WV 26508	<b>COUNTY - CODE</b> MARSHALL - 051	<b>DISTRICT; UNION</b>	
<b>SURFACE OWNER:</b> SHELLY A. & DAVID W. REINBEAU	<b>USGS 7 1/2 QUADRANGLE MAP NAME</b> MOUNDSVILLE, WV		

Latitude: 40°00'00"

SURFACE HOLE 10,235'

Latitude: 39°57'30"

BOTTOM HOLE 6,121'

JACKSON SURVEYING INC.

2413 EAST PIKE ST. # 112
Clarksburg, WV 26302
304-623-5851

Table with 2 columns: Location Name and UTM Coordinates (Northings, Eastings). Includes Surface Hole, Landing Point, and Azimuth Point locations.



Table with 5 columns: LINE, BEARING, DISTANCE, DESCRIPTION, MONUMENT. Lists survey lines L1 through L5.

Vertical dimension lines on the right side: 'BOTTOM HOLE 5,851'', 'SURFACE HOLE 2,634'', 'Longitude: 80°37'30''.

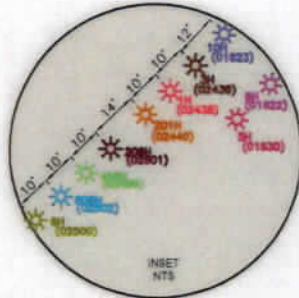
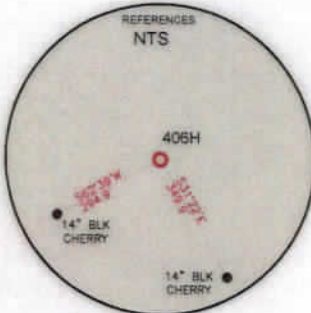
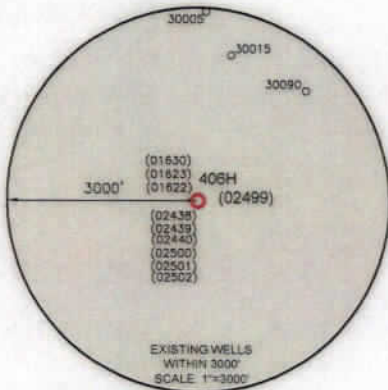

Table with 2 columns: Location Name and UTM Coordinates. Includes Surface Hole, Landing Point, and Azimuth Point locations.



WELL RESTRICTIONS

- 1. NO OCCUPIED DWELLINGS > 2500 SQ FT. WITHIN 625 FEET OF CENTER OF PAD.
2. NO AGRICULTURE BUILDINGS > 2500 SQ FT. WITHIN 625 FEET OF CENTER OF PAD.
3. NO WATER WELLS OR DEVELOPED SPRINGS ARE WITHIN 250 FEET OF PROPOSED WELL.
4. NO PERENNIAL STREAMS, LAKES, PONDS, OR RESERVOIRS WITHIN 100 FEET OF THE LIMITS OF DISTURBANCE.
5. NO NATURALLY PRODUCING TROUT STREAM WITHIN 300 FEET OF LIMITS OF DISTURBANCE.
6. NO GROUND INTAKE OR PUBLIC WATER SUPPLY WITHIN 1000 FEET OF WELL PAD, LIMITS OF DISTURBANCE, E & S CONTROLS OR PUBLIC WATER SUPPLY.

NOTES ON SURVEY

- 1. SURFACE AND ROYALTY OWNER INFORMATION AND THEIR BOUNDARIES SHOWN HEREON WERE PLOTTED FROM DEEDS AND/OR TAX PARCEL MAPS PROVIDED BY CLIENT AND/OR FIELD LOCATIONS.
2. THIS PLAT DOES NOT REPRESENT A BOUNDARY SURVEY OF THE PARCELS SHOWN HEREON.
4. ALL INSETS ARE GRID NORTH UNLESS OTHERWISE DEPICTED.

I, THE UNDERSIGNED, HEREBY CERTIFY THAT THIS PLAT IS CORRECT TO THE BEST OF MY KNOWLEDGE AND BELIEF AND SHOWS ALL THE INFORMATION REQUIRED BY LAW AND REGULATIONS ISSUED AND PRESCRIBED BY THE DEPARTMENT OF ENVIRONMENTAL PROTECTION.

P.S. 708

Signature of David L Jackson



COMPANY: SWN Production Company, LLC

Table with 3 columns: State of West Virginia logo, well location details, and accuracy/proof source information.

Form with fields for Well Type, Watershed, District, Surface Owner, Oil & Gas Royalty Owner, Drill options, Convert options, Target Formation, and Estimated Depth.

Form with fields for Well Operator (SWN Production Company, LLC) and Designated Agent (Brittany Woody).

Table with 2 columns: Legend (Proposed Surface Hole, Existing Well, LPL, Existing Water Well, Existing Spring) and Revisions/Date information.



**JACKSON SURVEYING  
INC.**

2413 EAST PIKE ST. # 112  
Clarksburg, WV 26302  
304-623-5851

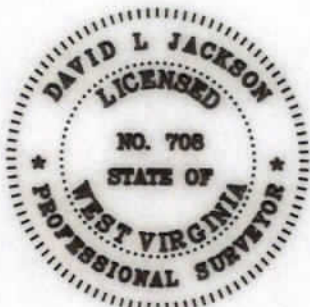

I, THE UNDERSIGNED, HEREBY CERTIFY THAT THIS PLAT IS CORRECT TO THE BEST OF MY KNOWLEDGE AND BELIEF AND SHOWS ALL THE INFORMATION REQUIRED BY LAW AND REGULATIONS ISSUED AND PRESCRIBED BY THE DEPARTMENT OF ENVIRONMENTAL PROTECTION.

P.S. 708 *David L Jackson*

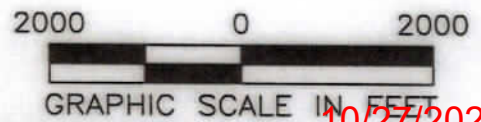

10/27/2023

REVISIONS:	COMPANY:		
	OPERATOR'S	DAVID REINBEAU MSH	DATE: 10-05-2023
	WELL #:	406H	DRAWN BY: N. MANO
	DISTRICT:	COUNTY:	SCALE: N/A
	UNION	MARSHALL	DRAWING NO:
		STATE:	WV
			WELL LOCATION PLAT 2

**JACKSON SURVEYING  
INC.**

2413 EAST PIKE ST. # 112  
Clarksburg, WV 26302  
304-623-5851

WELL BORE TRACTS		
TRACT	SURFACE OWNER (S) / ROYALTY OWNER (R)	TAX PARCEL
1	REINBEAU SHELLY A & DAVID W (S/R)	13-8-29
TRACT SURFACE OWNER (S)		
2	REINBEAU SHELLY A & DAVID W (S)	13-8-27
3	REINBEAU RONALD W & FRIEDA A - LIFE (S)	13-07-22.2
4	SHEPHERD JAMES LEE II (S)	13-07-23
5	MCCLINTOCK JOSIE & LARRY (S)	13-07-22.4
6	CAIN ROGER L II (S)	13-7E-10
7	MCCOMBS JOHN A SR, THOMAS E & BETH (S)	13-08-26
8	HIERONIMUS C KEITH ET UX (S)	13-08-15
9	CONNER AMBER D & DAVID HANES JR (S)	13-08-12
10	CARTER KELLY J (S)	13-10-20
11	MELNIK BRUCE A ET UX (S)	13-10-21
12	MERINAR KENNETH LEE ET UX (S)	13-10-21.6
13	JONES NICHOLAS & EVELINE J (S)	13-10-21 B
14	METS PROPERTIES LLC (S)	13-10-22
15	METS PROPERTIES LLC (S)	13-10-23
16	ELIAS GRANT THOMAS ET UX (S)	13-09-32
17	BIXBY LINDA L (S)	13-09-32.2
18	LAUDERMILT RAY A ET UX (S)	13-09-41
19	JARRETT JAMES M & EVELYN E (S)	13-09-40
20	LILLEY KENNETH R & CARLOTTA J (S)	13-09-31
21	PARSONS JAY D ET UX (S)	13-14-01
22	FREEMAN RAYMOND CHRISTOPHER (S)	13-14-04
23	SUNDERHAUS TINA M & STEPHEN G	13-14-7.7
24	CHAMBERS DOROTHY - LIFE (S)	13-14-07
25	ROVER PIPELINE LLC (S)	13-14-08
26	ROVER PIPELINE LLC (S)	13-14-09
27	KONWALSKI PAUL JOSEPH (S)	13-14-9.4
28	DRAKE JASON T & DEANNA J (S)	13-14-31.1
29	LYONS BRENT G ET UX (S)	13-14-31
30	HENRY GH & JANET FAMILY TRUST (S)	13-14-32
31	HENRY GH & JANET FAMILY TRUST (S)	13-14-29
32	GUNTO CARL M ET UX (S)	13-14-34
33	FOSTER CHARLES S & BRENDA (S)	13-14-38.2
34	KOONTZ CARL JR ET AL (S)	14-05-24
35	FRANCIS LISA JANE (S)	14-05-37
36	TATCH DANIEL EDWARD TRUST (S)	14-05-36
37	HILL KAY F ET AL (S)	14-05-28
38	HILL KAY F ET AL (S)	14-05-29
39	HILL HOWARD B EST (S)	14-05-29.2

\*Highlighted Parcels impacted by drilling activity.

ADJOINING OWNERS TABLE		
TRACT	SURFACE OWNER	TAX PARCEL
A	KOSTELECKY JOSEPH J JR & CAROLYN - TOD	13-08-31.1
B	FUNK CHARLES D ET UX	13-08-32
C	LOY EUGENE EST ET AL	13-08-01
D	LIBERTY JOHN ET UX	13-08-10
E	MCCOMBS JOHN A SR, THOMAS E & BETH	13-08-11
F	CONNER AMBER D & DAVID HANES JR	13-08-14
G	CONNER AMBER D & DAVID HANES JR	13-08-13
H	LILLEY CONSTANCE E - TOD	13-08-10.1
I	LILLEY CONSTANCE E - TOD	13-08-7.7
J	KINNEER JAMIE ET UX	13-08-7.9
K	KINNEER VERNON A JR & JAMIE	13-08-06
L	ROCKY PEARL FARM LLC	13-09-06
M	MELNIK BRUCE A ET UX	13-10-21.1
N	MONTGOMERY TORIE	13-10-21.2
O	RIGGLE STACY L	13-10-21.9
P	GANTZER THOMAS P & JILL N	13-10-21.5
Q	GANTZER THOMAS P & JILL N	13-10-21.3
R	JOHNSON GARY A ET UX	13-10-21.4
S	JONES NICHOLAS & EVELINE J	13-09-08
T	EDISON MARK C ET UX	13-09-09
U	BERTRAM BRIAN B & ADDIE L	13-09-30
V	CUNNINGHAM JOHN F	13-09-29.7
W	KELCH SCOTT EDWARD ET UX	13-09-29.5
X	THOMPSON MICHAEL C & CRYSTAL M	13-14-13
Y	ROGERSON CHESTER ET AL - LIFE	13-14-12
Z	BRIGGS ANDREW & MAXCINE	13-14-11
A2	MCWHORTER LELAND & DEBORAH 2018 IRREVOCABLE TRUST	13-14-10
B2	COULTER JAMES G & SONDR A K	13-14-9.7
C2	GODDARD RUSSELL E	13-14-9.5
D2	NORRIS THOMAS E ET UX	13-14-9.2
E2	MCCONNELL DAVID A	13-14-9.6
F2	STANFORD BETTY R & BRADLEY	13-14-30.1
G2	EBBERT JOHN D III ET UX	13-14-29.9
H2	NIVEN ROBERT M ET UX	13-14-29.12
I2	KNUTH DAVID W JR & NICOLE L	13-14-29.10
J2	SNIDER LINDA ELIZABETH	13-14-29.11
K2	FOSTER CHARLES S ET UX	13-14-38.1
L2	WILSON ROBERT J & REBECCA S	14-05-24.6
M2	FOSTER CAITLIN E	13-14-50
N2	SMITH EDWARD LEE II	14-05-26
O2	BLED SOE BILLY JAMES SR & NORA -LIFE-BLED SOE TIMOTHY & DAVID	14-05-26.2
P2	BLED SOE BILLY J JR & CLARA M	14-05-26.4
Q2	ECO-VRINDABAN	15-02-18
R2	GORAKSHYA-SEVA & ENV EDU TR OF AMERICA INC	14-02-18.2
S2	HILL KAY F ET UX	14-05-30
T2	HILL KAY F ET UX	14-05-29.1
U2	HILL KAY F ET UX	14-05-32.4
V2	LILLEY ROGER W JR & TRICIA	14-05-32.6
W2	LILLEY ROGER W ET UX	14-05-32.5
X2	YOHO KIM MARLENE	14-05-33
Y2	WHIPKEY ROGER ET UX	14-05-35
Z2	SIMONS JORDAN M & VICTORIA G BENLINE SIMONS	14-05-36.1
A3	DERROW SAMUEL R ET UX	14-05-39
B3	KELLEY RODNEY & BONNIE	14-05-38.1
C3	KELLEY RODNEY & BONNIE	14-05-38
D3	KELLEY RODNEY & BONNIE	14-05-38.2
E3	KELLEY RODNEY & BONNIE	14-05-38.3
F3	WALTER DANA F	14-05-38.4

DETAIL "B"

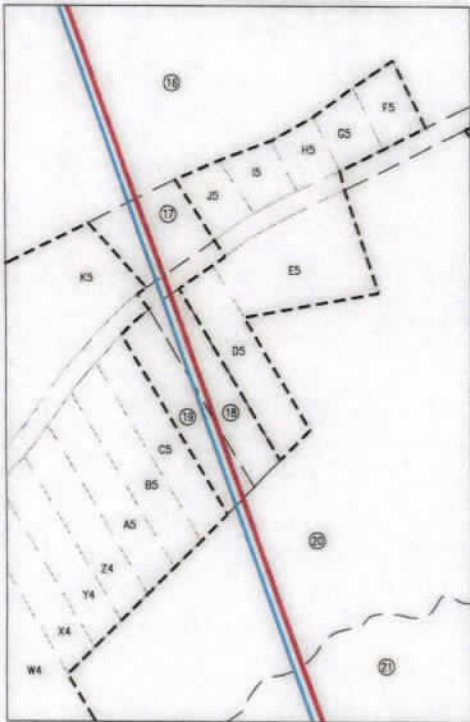

DETAIL "A"



I, THE UNDERSIGNED, HEREBY CERTIFY THAT THIS PLAT IS CORRECT TO THE BEST OF MY KNOWLEDGE AND BELIEF AND SHOWS ALL THE INFORMATION REQUIRED BY LAW AND REGULATIONS ISSUED AND PRESCRIBED BY THE DEPARTMENT OF ENVIRONMENTAL PROTECTION.

P.S. 708

*David L Jackson*



10/27/2023

REVISIONS:	COMPANY:	<b>SWN</b> Production Company, LLC	
	OPERATOR'S	DAVID REINBEAU MSH	API #:
	WELL #:	406H	47-051-02499
	DISTRICT:	COUNTY:	STATE:
	UNION	MARSHALL	WV
			DATE: 10-05-2023
			DRAWN BY: N. MANO
			SCALE: N/A
			DRAWING NO:
			WELL LOCATION PLAT 3

**JACKSON SURVEYING  
INC.**

2413 EAST PIKE ST. # 112  
Clarksburg, WV 26302  
304-623-5851

ADJOINING OWNERS TABLE		
TRACT	SURFACE OWNER	TAX PARCEL
G3	WALTER DANA F	14-05-38.5
H3	FRANCIS LISA JANE	14-05-36.2
I3	BISHOP PENNY S ET VIR	14-05-39.1
J3	FRANCIS LISA JANE	14-05-37.1
K3	GALLOWAY HARRY L	14-05-11
L3	J & R DEVELOPMENT LLC	14-05-11.3
M3	SMITH MARK ALLEN ET UX	14-05-23
N3	KOONTZ COLE	14-05-24.8
O3	WILLIAMS CARL R & RHONDA L	14-05-24.5
P3	WILLIAMS CARL R & RHONDA L	14-05-24.4
Q3	KOONTZ JOHN R	14-05-24.3
R3	WOODS JOHN E SR & FRANCES J	14-05-24.2
S3	KOONTZ CARL E JR	14-05-24.1
T3	THOMAS WAYNE L - THOMAS MARILYN	13-14-39
U3	EBERT BRADLEY	14-05-24.9
V3	WALTER DANA F & VINCENT LORETTO	13-14-38
W3	WEST THOMAS J JR & KATHY ANN	13-14-34.1
X3	POLANSKI LYNDASAY N	13-14-41.2
Y3	FERDA BRIAN T	13-14-46.2
Z3	OLDFIELD KAREN KAY	13-14-33
A4	GRAY DARYL J	13-14-49
B4	LILLEY PAUL THOMAS	13-13-17
C4	YOHO GAIL L & RONNIE E	13-14-8.4
D4	BECKNER DAVID E & DEBORAH K	13-14-7.3
E4	LEWEY CHARLES L & MARGARET A	13-14-7.1
F4	DORAN BRIAN W ET UX	13-14-7.4
G4	COTTRELL COLE T	13-14-7.5
H4	CHAMBERS DOROTHY	13-14-6.2
I4	MURPHY MICHAEL A & BLACK AMY S	13-14-7.6
J4	GIVENS BRUCE E ET UX	13-14-7.2
K4	GIVENS BRUCE E ET UX	13-14-06
L4	KENDZIERSKI ALAN B ET UX	13-14-6.4
M4	CLOVIS JUSTIN	13-14-6.3
N4	TROWBRIDGE ROBEYN & JOSHUA SKIDGEL	13-14-6.1
O4	TROWBRIDGE ROBEYN & JOSHUA SKIDGEL	13-14-05
P4	FREEMAN RAYMOND CHRISTOPHER	13-14-03
Q4	CAMPBELL CODIE JOHNELLE	13-14-02
R4	ANDERSON MICHAEL L	13-13-14
S4	TH EXPLORATION LLC	13-13-13.1
T4	TH EXPLORATION LLC	13-13-13.3
U4	NORRIS TABITHA L	13-13-13.2
V4	COOPER TIM L	13-09-31.3
W4	FRYE JACQUELINE L & CHARLES G	13-09-31.1
X4	VEMURI HOME & GARDEN LLC	13-09-34
Y4	KIMBERLY JORDAN A	13-09-35
Z4	HUCK MARY L ET AL	13-09-36
A5	GETCHEY RONALD D	13-09-37
B5	WEST RICHARD L & TIMBERLY A	13-09-38
C5	WEST RICHARD L & TIMBERLY A	13-09-39
D5	FRANCIS SAMUELE	13-09-42
E5	ROUSE PENNY L - TOD	13-09-43
F5	PHILLIPS JANET M	13-09-32.6
G5	PHILLIPS JANET	13-09-32.8
H5	WRIGHT DAVID JAMES	13-09-32.4

ADJOINING OWNERS TABLE		
TRACT	SURFACE OWNER	TAX PARCEL
I5	CRAKE ROBERT J & SHELLEY S	13-09-32.7
J5	CRAKE ROBERT J & SHELLEY S	13-09-32.3
K5	EAGLE LTD	13-09-32.1
L5	CHAMBERS ROBIN L & DENICE E	13-09-33.2
M5	CHAMBERS ROBIN L & DENICE E	13-09-33.1
N5	MILLER KENNETH LEE - TOD	13-09-33
O5	SCHABER LESLIE B & LORI D	13-13-10
P5	SIBURT ERIC R & CARLA M	13-13A-01
Q5	STURGILL JULIE L & JOE D	13-10-24
R5	METS PROPERTIES LLC	13-10-24.1
S5	SCHABER LESLIE B & LORI D	13-13-10.1
T5	MARSH DAVID A ET UX	13-10-28
U5	THORN RONNIE L & BETH A	13-10-30.1
V5	ELLIOTT GLENN F	13-10-30
W5	SPIELVOGEL HARRY C ET UX	13-10-8-10
X5	LOY JEFFREY A & JULIE M	13-10-31
Y5	MERINAR KENNETH LEE & LEEANN	13-108-08
Z5	GAST COREY M & JOLIE A	13-10-21.10
A6	SHAW SIDNEY S & ROBIN MARIE	13-108-02
B6	SHAW SIDNEY S & ROBIN MARIE	13-108-01
C6	BOWERS MARY L	13-108-37
D6	WISE CLARA L	13-10-18
E6	CARTER KELLY J	13-10-19
F6	CARTER KELLY J	13-10-15.1
G6	WALTON DANIEL JR & THERESA	13-08-17
H6	WALTON DANIEL JR & THERESA	13-08-18
I6	MCCOMBS THOMAS E & BETH E - TOD	13-08-19
J6	PRESBYTERIAN CHURCH	13-08-20
K6	ALLEN GROVE PRESBYTERIAN CHURCH	13-08-15.1
L6	KAHLBAUGH DAVID W & DELORES - TOD	13-07-24
M6	HIERONIMUS C KEITH ET UX	13-7A-23
N6	SHERRARD CEMETERY	13-7A-22
O6	JOHNSON GILBERT	13-7A-03
P6	MCCOMBS THOMAS E & BETH E - TOD	13-08-16
Q6	PATTERSON DANIEL & MICHELLE	13-07-22
R6	MCLAUGHLIN SHAWN & ELIZABETH	13-08-23
S6	PERRY JOSEPH P JR	13-08-24
T6	THORN JACLYN A & JASON K	13-08-25
U6	SBERNA JOSEPH L JR & TAMMY	13-7E-01
V6	CRAWFORD GARY J	13-7E-07
W6	JOSEPH WILLIAM F & SUSAN L	13-7E-08
X6	MALARSKI CHAD	13-7E-09
Y6	BOARD OF EDUCATION	13-07-16
Z6	BOARD OF EDUCATION	13-07-17
A7	MCCOMBS JOHN A SR & MARILYN S	13-07-22.1
B7	REINBEAU DAVID W & SHELLEY A	13-07-22.3
C7	REINBEAU DAVID W & SHELLEY A	13-07-21.1
D7	BOWMAN MICHAEL ET UX	13-08-28
E7	BOWMAN MICHAEL J & CONSTANCE G	13-07-21
F7	ALEXANDER LORRAINE	13-07-20
G7	ALEXANDER LORRAINE	13-07-18.1
H7	ALEXANDER LORRAINE	13-07-18
I7	SAMPSON EDITH VIRGINIA EST	13-07-19
J7	NARRISH KEVIN	13-08-30
K7	SOUTH CHRISTOPHER C	13-08-31

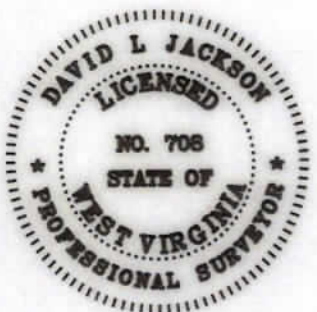

I, THE UNDERSIGNED, HEREBY CERTIFY THAT THIS PLAT IS CORRECT TO THE BEST OF MY KNOWLEDGE AND BELIEF AND SHOWS ALL THE INFORMATION REQUIRED BY LAW AND REGULATIONS ISSUED AND PRESCRIBED BY THE DEPARTMENT OF ENVIRONMENTAL PROTECTION.

P.S. 708 *David L Jackson*

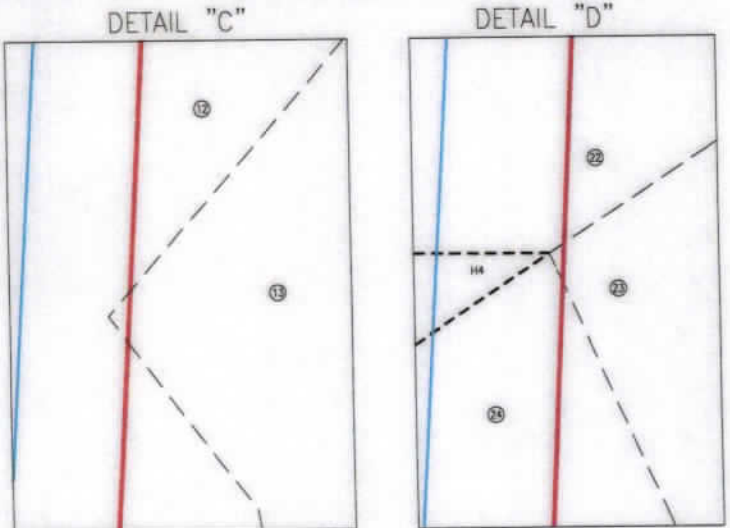

10/27/2023

REVISIONS:	COMPANY:		
	OPERATOR'S	DAVID REINBEAU MSH	API #: 47-051-02499
	WELL #:	406H	DATE: 10-05-2023
	DISTRICT:	UNION	COUNTY: MARSHALL
			STATE: WV
			DRAWN BY: N. MANO
			SCALE: N/A
			DRAWING NO: WELL LOCATION PLAT 4

**INFORMATION SUPPLIED UNDER WEST VIRGINIA CODE**  
**Chapter 22, Article 6A, Section 5(a)(5)**  
**IN LIEU OF FILING LEASE(S) AND OTHER CONTINUING CONTRACT(S)**

Under the oath required to make the verification on page 1 of this Notice and Application, I depose and say that I am the person who signed the Notice and Application for the Applicant, and that –

- (1) the tract of land is the same tract described in this Application, partly or wholly depicted in the accompanying plat, and described in the Construction and Reclamation Plan;
- (2) the parties and recordation data (if recorded) for lease(s) or other continuing contract(s) by which the Applicant claims the right to extract, produce or market the oil or gas are as follows:

Lease Name or Number	Grantor, Lessor, etc.	Grantee, Lessee, etc.	Royalty	Book/Page
See Exhibit "A"				

RECEIVED  
Office of Oil and Gas

OCT 12 2023

WV Department of  
Environmental Protection

\*Co-tenancy utilization - At least 75% of the royalty owners have consented to the lawful use or development of the oil or natural gas mineral property on the tract. The interests of the remaining co-tenants will be secured pursuant to the Co-tenancy Modernization and Majority Protection Act.

\*Horizontal well unit utilization - Subject to unitization filing with the West Virginia Oil and Gas Conservation Commission.

\*Highlighted Parcels impacted by drilling activity

**Acknowledgement of Possible Permitting/Approval  
In Addition to the Office of Oil and Gas**

The permit applicant for the proposed well work addressed in this application hereby acknowledges the possibility of the need for permits and/or approvals from local, state, or federal entities in addition to the DEP, Office of Oil and Gas, including but not limited to the following:

- WV Division of Water and Waste Management
- WV Division of Natural Resources WV Division of Highways
- U.S. Army Corps of Engineers
- U.S. Fish and Wildlife Service
- County Floodplain Coordinator

The applicant further acknowledges that any Office of Oil and Gas permit in no way overrides, replaces, or nullifies the need for other permits/approvals that may be necessary and further affirms that all needed permits/approvals should be acquired from the appropriate authority before the affected activity is initiated.

Well Operator: SWN Production Company, LLC

By: Garvin Nadeau

Its: SENIOR LANDMAN

4705102490

EXHIBIT "A"

Attached to and made a part of the State of West Virginia Oil and Gas Form, WV 6A-1, by SWN Production Company, LLC, as Operator  
David Reimboe MSH 406H  
Marshall County, West Virginia

#	TWP	LESSOR	LESSEE	ROYALTY	BOGPG	% Interest Not Leased/Owned by SWN Production Company, LLC
1)	13-0028-0029-0000	Shelly A. Reimboe and David W. Reimboe, her husband, joint tenants, with right of survivorship	Chesapeake Appalachia, LLC SWN Production Company, LLC	14.00%	688/424 33/110	0.00%
2)	13-0028-0027-0000	Shelly A. Reimboe and David W. Reimboe, her husband, joint tenants, with right of survivorship	Chesapeake Appalachia, LLC SWN Production Company, LLC	14.00%	688/424 33/110	0.00%
3)	13-0007-0022-0002	James D. Gardner, a widower	TriEnergy Holdings, LLC NPAR, LLC Chevron U.S.A. Inc. Chesapeake Appalachia, LLC	14.00%	709/558 24/430 756/332 30/532	
		Robert E. Gardner and Mary Gardner, his wife	SWN Production Company, LLC TriEnergy Holdings, LLC NPAR, LLC Chevron U.S.A. Inc. Chesapeake Appalachia, LLC	16.00%	33/110 717/139 24/430 756/332 30/532	
		Olivia N. McOuire and Kenneth McOuire, her husband	SWN Production Company, LLC TriEnergy Holdings, LLC NPAR, LLC Chevron U.S.A. Inc. Chesapeake Appalachia, LLC	14.00%	33/110 717/137 24/430 756/332 30/532	0.00%
		Lilo Gardner, a/k/a Lindotte P. Gardner, a widow	SWN Production Company, LLC TriEnergy Holdings, LLC NPAR, LLC Chevron U.S.A. Inc. Chesapeake Appalachia, LLC	16.00%	33/110 717/135 24/430 756/332 30/532	
4)	13-0007-0023-0000	James D. Gardner, a widower	TriEnergy Holdings, LLC NPAR, LLC Chevron U.S.A. Inc. Chesapeake Appalachia, LLC	16.00%	709/558 24/430 756/332 30/532	
		Robert E. Gardner and Mary Gardner, his wife	SWN Production Company, LLC TriEnergy Holdings, LLC NPAR, LLC Chevron U.S.A. Inc. Chesapeake Appalachia, LLC	16.00%	33/110 717/139 24/430 756/332 30/532	0.00%
		Olivia N. McOuire and Kenneth McOuire, her husband	SWN Production Company, LLC TriEnergy Holdings, LLC NPAR, LLC Chevron U.S.A. Inc. Chesapeake Appalachia, LLC	16.00%	33/110 717/137 24/430 756/332 30/532	
		Lilo Gardner, a/k/a Lindotte P. Gardner, a widow	SWN Production Company, LLC TriEnergy Holdings, LLC NPAR, LLC Chevron U.S.A. Inc. Chesapeake Appalachia, LLC	16.00%	33/110 717/135 24/430 756/332 30/532	
5)	13-0007-0022-0004	James D. Gardner, a widower	TriEnergy Holdings, LLC NPAR, LLC Chevron U.S.A. Inc. Chesapeake Appalachia, LLC	16.00%	709/558 24/430 756/332 30/532	
		Robert E. Gardner and Mary Gardner, his wife	SWN Production Company, LLC TriEnergy Holdings, LLC NPAR, LLC Chevron U.S.A. Inc. Chesapeake Appalachia, LLC	16.00%	33/110 717/139 24/430 756/332 30/532	0.00%
		Olivia N. McOuire and Kenneth McOuire, her husband	SWN Production Company, LLC TriEnergy Holdings, LLC NPAR, LLC Chevron U.S.A. Inc. Chesapeake Appalachia, LLC	16.00%	33/110 717/137 24/430 756/332 30/532	
		Lilo Gardner, a/k/a Lindotte P. Gardner, a widow	SWN Production Company, LLC TriEnergy Holdings, LLC NPAR, LLC Chevron U.S.A. Inc. Chesapeake Appalachia, LLC	16.00%	33/110 717/135 24/430 756/332 30/532	
6)	13-007E-0010-0000	James D. Gardner, a widower	TriEnergy Holdings, LLC NPAR, LLC Chevron U.S.A. Inc. Chesapeake Appalachia, LLC	16.00%	709/558 24/430 756/332 30/532	
		Robert E. Gardner and Mary Gardner, his wife	SWN Production Company, LLC TriEnergy Holdings, LLC NPAR, LLC Chevron U.S.A. Inc. Chesapeake Appalachia, LLC	16.00%	33/110 717/139 24/430 756/332 30/532	0.00%
		Olivia N. McOuire and Kenneth McOuire, her husband	SWN Production Company, LLC TriEnergy Holdings, LLC NPAR, LLC Chevron U.S.A. Inc. Chesapeake Appalachia, LLC	16.00%	33/110 717/137 24/430 756/332 30/532	
		Lilo Gardner, a/k/a Lindotte P. Gardner, a widow	SWN Production Company, LLC TriEnergy Holdings, LLC NPAR, LLC Chevron U.S.A. Inc. Chesapeake Appalachia, LLC	16.00%	33/110 717/135 24/430 756/332 30/532	

RECEIVED  
Office of Oil and Gas

OCT 12 2023

WV Department of  
Environmental Protection

10/27/2023

4705102499

EXHIBIT "A"

Attached to and made a part of the State of West Virginia Oil and Gas Form, WV 6A-1, by SWN Production Company, LLC, as Operator  
 David Reinbeau MSH 406H  
 Marshall County, West Virginia

#	TMP	LESSOR	LESSEE	ROYALTY	RS/PG	% Interest Not Leased/Owned by SWN Production Company, LLC
7)	13-0008-0026-0000	Rosalyn Denise Ivan McCombs, a/k/a Ivan W. McCombs and Alma Jean McCombs, as joint tenants with the right of survivorship (Life Tenant), Agent, and John A. McCombs, Sr. and Marilyn Sue McCombs, husband and wife (as Remainderman), and Thomas E. McCombs and Beth Ellen McCombs, husband and wife, as joint tenants with the right of survivorship (as Remainderman)	a/s Chesapeake Appalachia, L.L.C. SWN Production Company, LLC	a/s 18.00%	754-547 33/110	11.82%
		Allan G. Ketzell II a/k/a Allan G. Ketzell and Patricia L. Ketzell, husband and wife	SWN Production Company, LLC	15.00%	1089/186	
		Amy W. Farrer, a/k/a Amy W. Ratcliff Farrer, a divorced woman and not remarried	SWN Production Company, LLC	15.00%	1035/25	
		Ann Cox, a/k/a Ann Cox Boyce, and Chris Boyce, husband and wife	Chesapeake Appalachia, L.L.C. SWN Production Company, LLC	18.00%	836/519 33/110	
		Ashley Elizabeth Johnson, single	SWN Production Company, LLC	18.00%	1152/409	
		Betty Moore, f/k/a Betty Wilson and Allan C. Moore, wife and husband	SWN Production Company, LLC	15.00%	1071/616	
		Carol Delaney, single woman	Chesapeake Appalachia, L.L.C. SWN Production Company, LLC	18.00%	834/146 33/110	
		Carol M. Rainbow, a widow and not remarried	SWN Production Company, LLC	18.00%	1104/558	
		Carol V. Ridgely and Paul D. Ridgely, wife and husband	Chesapeake Appalachia, L.L.C. SWN Production Company, LLC	18.00%	827/24 33/110	
		Catherine H. Stall a/k/a Catherine Hammer Stall a/k/a Catherine Jane Stall, a widow and not remarried	SWN Production Company, LLC	17.00%	1114/207	
		Craig W. Farnsworth, single, individually, as Executor of the Estate of M. Martha Ormiston, Trustee and Beneficiary of the M. Martha Ormiston Revocable Trust, and Co-Trustee and Beneficiary of the Joyce R. Farnsworth Revocable Trust dated April 30, 1998	SWN Production Company, LLC	18.00%	1148/434	
		Cynthia A. Thompson, married and doing business in her sole and separate right	Chesapeake Appalachia, L.L.C. SWN Production Company, LLC	18.00%	795/336 33/110	
		David C. Farnsworth, married, dealing herein with his separate property	SWN Production Company, LLC	18.00%	1148/428	
		David Morgan Wilson, II, a married man dealing in his sole and separate property	SWN Production Company, LLC	17.00%	1072/335	
		Dawn Joyce Zimmerman, f/k/a Dawn Joyce Wilson, a married woman dealing in her sole and separate property	SWN Production Company, LLC	17.00%	1073/241	
		Diane R. Fuchs Nelson, a/k/a Diane R. Fuchs Nelson, a married woman dealing in her sole and separate property	SWN Production Company, LLC	18.00%	1075/354	
		Dorothy A. Magnus, f/k/a Dorothy A. Clovis, f/k/a Annette Clovis, and Charles W. Magnus, her husband	Chesapeake Appalachia, L.L.C. SWN Production Company, LLC	18.00%	792/59 33/110	
		Douglas Jackson Coombs, a single man	Chesapeake Appalachia, L.L.C. SWN Production Company, LLC	18.00%	830/70 33/110	
		George M. Clovis and Inas Clovis, his wife	Chesapeake Appalachia, L.L.C. SWN Production Company, LLC	18.00%	795/325 33/110	
		Gerard M. Wilson a/k/a G. Michael Wilson, a married man dealing in his sole and separate property	SWN Production Company, LLC	17.00%	1103/433	
		Gilda R. Coombs, a/k/a Gilda T. Coombs, widow	Chesapeake Appalachia, L.L.C. SWN Production Company, LLC	18.00%	795/312 33/110	
		Hastings National Bank of West Virginia, successor to First National Bank of Morgantown, Trustee of the David A. Wilson Trust, dated January 7, 1993	SWN Production Company, LLC	18.00%	1112/556	
		James F. Pfanzagl, Sr., a widower and not remarried	SWN Production Company, LLC	17.00%	1097/425	
		James Shannon Coombs, II, a single man	Chesapeake Appalachia, L.L.C. SWN Production Company, LLC	18.00%	795/302 33/110	
		Judith Ann Fuchs Leahy, a married woman dealing in her sole and separate property	SWN Production Company, LLC	18.00%	1073/572	
		Kay S. Leary, a/k/a Kay C. Leary, and Henry B. Leary, her husband	Chesapeake Appalachia, L.L.C. SWN Production Company, LLC	18.00%	792/65 33/110	
		Kenneth Lee Brandfass and Terry Brandfass, husband and wife	SWN Production Company, LLC	18.00%	1072/355	
		Kenneth Raymond Fuchs, a married man dealing in his sole and separate property	SWN Production Company, LLC	15.00%	1076/348	
		Kristen Kay Wilkerson and Kenneth L. Wilkerson, wife and husband	SWN Production Company, LLC	15.00%	1040/237	
		Larry Gene Fuchs, a married man dealing in his sole and separate property	SWN Production Company, LLC	15.00%	1077/45	
		Marshall Raymond Whitaker, III, a single man	SWN Production Company, LLC	15.00%	1069/290	
		Marti Brown, single woman	Chesapeake Appalachia, L.L.C. SWN Production Company, LLC	18.00%	827/12 33/110	
		Mary Elizabeth Fuchs Boston, a married woman dealing in her sole and separate property	SWN Production Company, LLC	18.00%	1077/50	
		Mary Kathryn Coombs Howard, divorced	Chesapeake Appalachia, L.L.C. SWN Production Company, LLC	18.00%	795/307 33/110	
		Matthew S. Cox, a single man	SWN Production Company, LLC	15.00%	1040/532	
		Michael A. Gephart, a/k/a Michael Allan Gephart and Velvet M. Gephart, husband and wife	SWN Production Company, LLC	15.00%	1061/305	
		Nancy Hastings Crow, a married woman dealing in her sole and separate property	SWN Production Company, LLC	15.00%	1041/475	
		Patricia Sue Woodrum, a single woman	SWN Production Company, LLC	15.00%	1061/315	
		Patricia A. Foreman, a/k/a Patricia C. Foreman, a widow	Chesapeake Appalachia, L.L.C. SWN Production Company, LLC	18.00%	792/4 33/110	
		Ralph W. Gephart, Jr., a/k/a Ralph Gephart, Jr., a single man	SWN Production Company, LLC	15.00%	1061/310	
		Rebecca Hastings Servino, a married woman dealing in her sole and separate property	SWN Production Company, LLC	15.00%	1040/232	
		Richard T. Ratcliff and Karen T. Ratcliff, husband and wife	SWN Production Company, LLC	15.00%	1035/30	
		Robert Maxwell Howard, a single man	Chesapeake Appalachia, L.L.C. SWN Production Company, LLC	18.00%	795/331 33/110	
		Robert V. Fuchs and Linda S. Fuchs, husband and wife	SWN Production Company, LLC	18.00%	1072/345	
		Robert Virgil Hastings, a married man dealing in his sole and separate property	SWN Production Company, LLC	15.00%	1041/470	
		Ronald Allen Kline and Mary Katherine Kline, his wife	SWN Production Company, LLC	18.00%	1148/79	
		Russell David Johnson, individually and as Beneficiary of the Joyce R. Farnsworth Revocable Trust dated April 30, 1998	SWN Production Company, LLC	18.00%	1151/86	
		Ruth Hastings Donovan, a married woman dealing in her sole and separate property	SWN Production Company, LLC	15.00%	1041/231	
		Sandra Lynn Marshall and John Marshall, wife and husband	Chesapeake Appalachia, L.L.C. SWN Production Company, LLC	18.00%	827/18 33/110	
		Shannon Griffin Hamner and Michelle Marie Hamner, his wife	Chesapeake Appalachia, L.L.C. SWN Production Company, LLC	18.00%	800/6 33/110	
		Sharon L. Brechon and Timothy W. Brechon, her husband	Chesapeake Appalachia, L.L.C. SWN Production Company, LLC	18.00%	791/335 33/110	
		Stephanie A. Smith, a single woman	Chesapeake Appalachia, L.L.C. SWN Production Company, LLC	18.00%	791/341 33/110	
		Stuart C. Dillon, married, dealing herein with his separate property	SWN Production Company, LLC	18.00%	1137/458	
		Stuart Krieg Hastings, a married man dealing in his sole and separate property	SWN Production Company, LLC	15.00%	1040/222	
		Susan Amanda Cox, f/k/a Susan Amanda Cox Bailey	SWN Production Company, LLC	18.00%	1157/276	
		Susan R. Cloutdy and Larry R. Cloutdy, her husband	Chesapeake Appalachia, L.L.C. SWN Production Company, LLC	18.00%	791/329 33/110	
		Thomas Michael Johnson, married, dealing herein with his separate property	SWN Production Company, LLC	18.00%	1151/80	
		Virginia Anne Yeater, a/k/a Virginia G. Yeater, a single woman	Chesapeake Appalachia, L.L.C. SWN Production Company, LLC	18.00%	795/317 33/110	
		Vivian Marie Martin, f/k/a Vivian Dillon, widow	SWN Production Company, LLC	18.00%	1137/452	
8)	13-0008-0015-0000	C. Keith Hieronimus and Terri L. Hieronimus, husband and wife	Chesapeake Appalachia, L.L.C. SWN Production Company, LLC	18.00%	873/464 35/32	0.00%
9)	13-0008-0012-0000	David Alonzo Connor Estate	ALL RESOURCES, L.L.C. Chesapeake Appalachia, L.L.C. SWN Production Company, LLC	15.00%	677/458 21/425 33/110	0.00%
10)	13-0010-0020-0000	Kelly J. Carter, single	American Petroleum Partners Operating, LLC SWN Production Company, LLC	19.00%	940/425 45/381	0.00%

RECEIVED  
Office of Oil and Gas  
OCT 12 2023  
WV Department of  
Environmental Protection

10/27/2023

4705102490

**EXHIBIT "A"**  
 Attached to and made a part of the State of West Virginia Oil and Gas Form, WV 6A-1, by SWN Production Company, LLC, as Operator  
 David Reinbeau MSH 406H  
 Marshall County, West Virginia

#	TMP	LESSOR	LESSEE	ROYALTY	BLK/PG	% Interest Not Leased/Owned by SWN Production Company, LLC
11)	13-0010-0021-0000	Bruce A. Melnik and Carolyn Melnik, husband and wife	Chesapeake Appalachia, L.L.C. SWN Production Company, LLC	18.00%	759/187 33/110	0.00%
12)	13-0010-0021-0000	Kenneth Lee Marinar and Lee Ann Marinar, his wife	Chesapeake Appalachia, L.L.C. SWN Production Company, LLC	12.50%	681/457 33/110	0.00%
13)	13-0010-0021-0000	Orey R. Dean and Cynthia M. Dean, husband and wife	Chesapeake Appalachia, L.L.C. SWN Production Company, LLC	12.50%	682/83 33/110	0.00%
14)	13-0010-0022-0000	William D. Anderson and Karen L. Anderson, husband and wife	Chesapeake Appalachia, L.L.C. SWN Production Company, LLC	14.00%	684/340 33/110	0.00%
15)	13-0010-0023-0000	William D. Anderson and Karen L. Anderson, husband and wife	Chesapeake Appalachia, L.L.C. SWN Production Company, LLC	14.00%	684/357 33/110	0.00%
16)	13-0009-0032-0000	Grant Thomas Elias and Rhonda Renee Elias, husband and wife	SWN Production Company, LLC	18.00%	111/92	0.00%
17)	13-0009-0032-0002	JRC Minerals, LLC, represented herein by James R. Chaffin, member	SWN Production Company, LLC	18.00%	1158/91	0.00%
18)	13-0009-0041-0000	Ray A. Landerhill and Camille A. Landerhill, husband and wife	Chesapeake Appalachia, L.L.C. SWN Production Company, LLC	12.50%	682/110 33/110	0.00%
19)	13-0009-0046-0000	James M. Jarratt, divorced	SWN Production Company, LLC	18.00%	1152/263	0.00%
20)	13-0009-0031-0000	Kenneth R. Lilley and Carlotta J. Lilley, husband and wife	Chesapeake Appalachia, L.L.C. SWN Production Company, LLC	12.50%	680/286 33/110	0.00%
21)	13-0014-0001-0000	Jay D. Parsons and Kathleen F. Parsons, husband and wife	Chesapeake Appalachia, L.L.C. SWN Production Company, LLC	12.50%	690/393 33/110	0.00%
22)	13-0014-0004-0000	Annett M. Freeman, a widow	TriEnergy Holdings, LLC NPAR, LLC Chevron U.S.A. Inc. Chesapeake Appalachia, LLC SWN Production Company, LLC	18.00%	714/48 24/30 756/332 30/332 33/110	0.00%
23)	13-0014-0007-0000	Tina Marie Riggs, single	Chesapeake Appalachia, L.L.C. SWN Production Company, LLC	12.50%	690/63 33/110	0.00%
24)	13-0014-0007-0000	Harrison F. Chambers and Dorothy M. Chambers, husband and wife	Chesapeake Appalachia, L.L.C. SWN Production Company, LLC	12.50%	688/493 33/110	0.00%
25)	13-0014-0008-0000	Keith W. Peluchette, by John R. Estall, as Guardian of the Estate of Keith W. Peluchette and David C. White as Guardian Ad Litem	American Petroleum Partners Operating, LLC SWN Production Company, LLC	20.00%	1052/568 45/81	0.00%
26)	13-0014-0009-0000	Roselynn Owens (subject to unitization filing dated May 11, 2023)	n/a	n/a	n/a	100.00%
27)	13-0014-0009-0004	Paul Joseph Kowalski, a single man	American Petroleum Partners Operating, LLC NPAR, LLC Chevron U.S.A. Inc. Chesapeake Appalachia, LLC SWN Production Company, LLC	18.00%	1014/133 45/81 696/68 756/332 30/332 33/110	0.00%
28)	13-0014-0031-0001	Brent G. Lyons and Joy H. Lyons, his wife	NPAR, LLC Chevron U.S.A. Inc. Chesapeake Appalachia, LLC SWN Production Company, LLC	18.75%	696/68 756/332 30/332 33/110	0.00%
29)	13-0014-0031-0000	Brent G. Lyons and Joy H. Lyons, his wife	NPAR, LLC Chevron U.S.A. Inc. Chesapeake Appalachia, LLC SWN Production Company, LLC	18.75%	696/68 756/332 30/332 33/110	0.00%
30)	13-0014-0032-0000	Roselynn Owens (subject to unitization filing dated May 11, 2023)	n/a	n/a	n/a	100.00%
31)	13-0014-0028-0000	Roselynn Owens (subject to unitization filing dated May 11, 2023)	n/a	n/a	n/a	100.00%
32)	13-0014-0034-0000	Carol Wenzel	TriEnergy Holdings, LLC NPAR, LLC Chevron U.S.A. Inc. EQT Aurora LLC SWN Production Company, LLC TriEnergy Holdings, LLC NPAR, LLC Chevron U.S.A. Inc. EQT Aurora LLC SWN Production Company, LLC TriEnergy Holdings, LLC NPAR, LLC Chevron U.S.A. Inc. EQT Aurora LLC SWN Production Company, LLC	18.00%	729/377 25/449 756/332 47/1 51/256 701/482 25/449 756/332 47/1 51/256 729/379 25/449 756/332 47/1 51/256	0.00%
33)	13-0014-0038-0002	Charles S. Foster and Brenda K. Foster, husband and wife	Chesapeake Appalachia, L.L.C. SWN Production Company, LLC	18.75%	700/291 33/110	0.00%
34)	14-0005-0024-0000	Roselynn Owens (subject to unitization filing dated May 11, 2023)	n/a	n/a	n/a	73.00%
		Danna Kowitz Coffield, a widow	American Petroleum Partners Operating, LLC SWN Production Company, LLC	18.00%	932/159 48/263	
		John R. Kowitz, a widower	American Petroleum Partners Operating, LLC SWN Production Company, LLC	18.00%	932/188 48/263	
		Linda J. Kowitz, a single woman	American Petroleum Partners Operating, LLC SWN Production Company, LLC	18.00%	933/352 48/263	
		Lisa Ann Kowitz, a widow	American Petroleum Partners Operating, LLC SWN Production Company, LLC	18.00%	938/82 48/263	
35)	14-0005-0037-0000	Richard Francis a/k/a Richard Harold Francis, a widower (Lisa Jean Francis)	TH Exploration, LLC Outpost Energy Corporation & Fossil Creek Ohio, LLC American Petroleum Partners Operating, LLC Chevron U.S.A. Inc. EQT Aurora LLC SWN Production Company, LLC	18.00%	879/317 36/528 36/588 40/99 47/1 51/256	0.00%
36)	14-0005-0036-0000	Daniel E. Taitoh	NPAR, LLC Chevron U.S.A. Inc. Chesapeake Appalachia, L.L.C. SWN Production Company, LLC	18.75%	698/161 756/332 30/332 33/110	0.00%
37)	14-0005-0028-0000	Key F. Hill and Beverly K. Hill, his wife, and Kathleen T. Hill, a widow	NPAR, LLC Chevron U.S.A. Inc. EQT Aurora LLC SWN Production Company, LLC	18.75%	698/154 756/332 47/1 51/256	0.00%
38)	14-0005-0029-0000	Key F. Hill and Beverly K. Hill, his wife, and Kathleen T. Hill, a widow	NPAR, LLC Chevron U.S.A. Inc. Chesapeake Appalachia, L.L.C. SWN Production Company, LLC	18.75%	698/154 756/332 30/332 33/110	0.00%
39)	14-0005-0029-0002	Roselynn Owens (subject to unitization filing dated May 11, 2023)	n/a	n/a	n/a	100.00%

Co-tenancy utilization - At least 75% of the royalty owners have consented to the lawful use or development of the oil or natural gas mineral property on the tract. The interests of the remaining

Horizontal well unit utilization - Subject to unitization filing with the West Virginia Oil and Gas Conservation Commission.

\*Highlighted Parties impacted by drilling activity

END OF EXHIBIT "A"

WVCOG (NACD)  
Office of Oil and Gas

OCT 12 2023

WV Department of  
Environmental Protection

10/27/2023



SWN Production Company, LLC  
1300 Fort Pierpont Dr, Ste 201  
Morgantown, WV 26508  
Tel: 304 884 1810  
Fax: 304 471 2497  
www.swn.com

May 10, 2023

Mr. Charles Brewer  
WV DEP Office of Oil & Gas  
601 57<sup>th</sup> St., SE  
Charleston, WV 25304

**RE:** SWN's proposed New Well: David Reinbeau MSH 406H in Marshall County, West Virginia, Drilling under Sorghum Ridge Road, Carrigan Drive, Hanlin Hill Road, Crows Lane, Pine Hill Road, Cherokee Lane, and Waynesburg Pike Road.

Dear Mr. Brewer:

SWN Production Company, LLC ("SWN") is applying for a drilling permit for the above referenced well. The State of West Virginia has raised some concern as to SWN's right to drill under Sorghum Ridge Road, Carrigan Drive, Hanlin Hill Road, Crows Lane, Pine Hill Road, Cherokee Lane, and Waynesburg Pike Road. Please be advised that SWN has leased all mineral owners under said route as it relates to the above-referenced well and unit.

Thank you.

Sincerely,

Bailey Brougher  
Staff Landman  
SWN Production Company, LLC

RECEIVED  
Office of Oil and Gas

OCT 12 2023

WV Department of  
Environmental Protection

The Right People, At the Right Time, Doing the Right Things,  
wisely investing the cash flow from our  
underlying Assets, will create Value.<sup>SM</sup>

10/27/2023