



west virginia department of environmental protection

Office of Oil and Gas
601 57th Street, S.E.
Charleston, WV 25304
(304) 926-0450
fax: (304) 926-0452

Harold D. Ward, Cabinet Secretary
www.dep.wv.gov

Friday, October 27, 2023
PERMIT MODIFICATION APPROVAL
Horizontal 6A / New Drill

SWN PRODUCTION COMPANY, LLC
POST OFFICE BOX 12359

SPRING, TX 773914954

Re: Permit Modification Approval for DAVID REINBEAU MSH 606H
47-051-02502-00-00

Updated lateral leases

SWN PRODUCTION COMPANY, LLC

The Office of Oil and Gas has reviewed the attached permit modification for the above referenced permit. The attached modification has been approved and well work may begin. Please be reminded that the oil and gas inspector is to be notified twenty-four (24) hours before permitted well work is commenced.

If there are any questions, please feel free to contact me at (304) 926-0450.

A handwritten signature in blue ink, appearing to read 'James A. Martin', is written over a faint circular stamp.

James A. Martin
Chief

Operator's Well Number: DAVID REINBEAU MSH 606H
Farm Name: SHELLY A & DAVID W REINBEAU
U.S. WELL NUMBER: 47-051-02502-00-00
Horizontal 6A New Drill
Date Modification Issued: 10/27/2023

Promoting a healthy environment.

10/27/2023

4705102502

STATE OF WEST VIRGINIA
DEPARTMENT OF ENVIRONMENTAL PROTECTION, OFFICE OF OIL AND GAS
WELL WORK PERMIT APPLICATION

1) Well Operator: SWN Production Co., LLC 494512924 051- Marsha 07-Union 486-Moundsville
Operator ID County District Quadrangle

2) Operator's Well Number: David Reinbeau MSH 606H Well Pad Name: David Reinbeau MSH

3) Farm Name/Surface Owner: Shelly A & David W. Reinbeau Public Road Access: Sorghum Ridge Road

4) Elevation, current ground: 1251' Elevation, proposed post-construction: 1251'

5) Well Type (a) Gas Oil Underground Storage
Other
(b) If Gas Shallow Deep
Horizontal

RECEIVED
Office of Oil and Gas
OCT 12 2023
WV Department of
Environmental Protection

6) Existing Pad: Yes or No Yes

7) Proposed Target Formation(s), Depth(s), Anticipated Thickness and Expected Pressure(s):
Target Formation- Marcellus, Down-Dip well to the North, Target Top TVD- 6419', Target Base TVD- 6476', Anticipated Thickness- 57', Associated Pressure- 4209

8) Proposed Total Vertical Depth: 6478'

9) Formation at Total Vertical Depth: Marcellus

10) Proposed Total Measured Depth: 24610'

11) Proposed Horizontal Leg Length: 15145.07'

12) Approximate Fresh Water Strata Depths: 426'

13) Method to Determine Fresh Water Depths: Deepest Nearby Water Well

14) Approximate Saltwater Depths: 883'- Salinity Profile

15) Approximate Coal Seam Depths: 774'

16) Approximate Depth to Possible Void (coal mine, karst, other): None that we are aware of.

17) Does Proposed well location contain coal seams directly overlying or adjacent to an active mine? Yes No

(a) If Yes, provide Mine Info: Name: _____
Depth: _____
Seam: _____
Owner: _____

18) **CASING AND TUBING PROGRAM 47 05 10 25 02**

TYPE	Size (in)	New or Used	Grade	Weight per ft. (lb/ft)	FOOTAGE: For Drilling (ft)	INTERVALS: Left in Well (ft)	CEMENT: Fill-up (Cu. Ft.)/CTS
Conductor	20"	New	J-55	94#	110'	110'	CTS
Fresh Water	13 3/8"	New	J-55	54.4#	476'	476'	551 sx/CTS
Coal	See	Interm	Casing				
Intermediate	9 5/8"	New	J-55	36#	2069'	2069'	789 sx/CTS
Production	5 1/2"	New	P-110 HP	20#	24610'	24610'	Tot 4375sx/100' inside Intermediate
Tubing							
Liners							

RECEIVED
Office of Oil and Gas

OCT 12 2023

WV Department of
Environmental Protection

TYPE	Size (in)	Wellbore Diameter (in)	Wall Thickness (in)	Burst Pressure (psi)	Anticipated Max. Internal Pressure (psi)	Cement Type	Cement Yield (cu. ft./k)
Conductor	20"	30"	0.25	2120	81	Class A	1.20/30% Excess
Fresh Water	13 3/8"	17.5"	0.380	2730	633	Class A	1.20/30% Excess
Coal	See	Interm	Casing				
Intermediate	9 5/8"	12 1/4"	0.395	3950	1768	Class A	1.19/40% Excess
Production	5 1/2"	8 3/4"-8 1/2"	0.361	14360	10500	Class A	1.19/5% Excess
Tubing							
Liners							

PACKERS

Kind:				
Sizes:				
Depths Set:				

4705102502

19) Describe proposed well work, including the drilling and plugging back of any pilot hole:

Drill and stimulate any potential zones between and including the Benson to Marcellus. **If we should encounter a void place basket above and below void area- balance cement to bottom of void and grout from basket to surface or run external casing packer/cementing stage tool above void interval and perform 2 stage cementing operation dependent upon depth of void. Run casing not less than 20' below void nor more than 75' below void. (*If freshwater is encountered deeper than anticipated it must be protected, set casing 50' below and cts.)

Office of Oil and Gas
OCT 12 2023
WV Department of Environmental Protection

20) Describe fracturing/stimulating methods in detail, including anticipated max pressure and max rate:

Well will be perforated within the target formation and stimulated with a slurry of water, sand, and chemical additives at a high rate. This will be performed in stages with the plug and perf method along the wellbore until the entire lateral has been stimulated within the target formation. All stage plugs are then drilled out and the well is flowed back to surface. In some instances, additional toe prep may be performed by pumping additional water in the toe of the well prior to perforating and pumping Stage 1 to ensure that the toe guns/toe sleeves are fully open prior to pumping stage 1. The well is produced through surface facilities consisting of high pressure production units, horizontal separation units, water and oil storage tanks. Max press and anticipated max rate- 12,500 psi @ 100 barrels a minute.

21) Total Area to be disturbed, including roads, stockpile area, pits, etc., (acres): 18.42

22) Area to be disturbed for well pad only, less access road (acres): 10.4

23) Describe centralizer placement for each casing string:

All casing strings will be ran with a centralizer at a minimum of 1 per every 3 joints of casing.

24) Describe all cement additives associated with each cement type:

See Attachment ***

25) Proposed borehole conditioning procedures:

All boreholes will be conditioned with circulation and rotation for a minimum of one bottoms up and continuing until operator is satisfied with borehole conditions.

*Note: Attach additional sheets as needed.

Southwestern Energy Company

Proposed Drilling Program



Well: DAVID REINBEAU MSH 606
Field: NORTH VICTORY FIELD WET
County: MARSHALL

Re-entry Rig: SDC 41
Prospect: Marcellus Shale
State: WV

SHL (NAD83): 39.992749 Latitude -80.661560 Longitude
BHL (NAD83): 39.945136 Latitude -80.650926 Longitude
KB Elev: 1,277 ft MSL **KB:** 26 ft AGL **GL Elev:** 1,251 ft MSL

NO COAL VOID EXPECTED

PROD TOC @ 2,069' MD

TUBULAR DETAIL					
Casing String	Casing Size (in)	Weight (Min)	Grade (Min)	Planned Interval	
				From	To
Conductor	20	94.0 #	J-55	0'	110'
Surface	13.375	54.4 #	J-55	0'	476'
Intermediate/Coal	9.625	36.0 #	J-55	0'	2,069'
Production	5.5	20.0 #	P-110 HP	0'	24,610'

CEMENT DETAIL

RECEIVED
Office of Oil and Gas

OCT 12 2023

WV Department of
Environmental Protection

	Sacks	Class	Density
Conductor	140	A	19.3
Surface	551	A	15.6
Intermediate	789	A	15.6
Production	4375	A	14.5-15.0

KOP at 6,469' MD

Freshwater Depth - 426' TVD

Coal Depth - 774' TVD

Saltwater Depth - 883' TVD

TVD - 6,478'

TMD - 24,610'

6,359' TVD Target Center

TD at 24,610' MD

6,478' TVD

LP at 7,504' MD

SHL Onondaga 6,370' TVD

Onondaga 6,489' TVD

7,504' to 24,610'

12.5-13.5 ppg

Created by: Sebastian Ziaja on 09/22/2023

September 28, 2023

Mr. Charles Brewer
Office of Oil & Gas
601 57th Street
Charleston, WV 25304

RE: Proposed New Well: David Reinbeau MSH 606H

Dear Mr. Brewer:

SWN has reviewed the area of the above mentioned well and discovered no shallow wells within 500' of the lateral. This well is situated on the Reinbeau's property, in Union District, Marshall County, West Virginia.

If you have any questions or desire additional information, please me at 304-884-1613.

Thank you.

Sincerely,

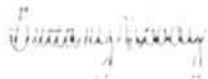

Brittany Woody
Staff Regulatory Specialist
Southwestern Energy Production Company, LLC

RECEIVED
Office of Oil and Gas

OCT 12 2023

WV Department of
Environmental Protection



10/27/2023

**JACKSON SURVEYING
INC.**
2413 EAST PIKE ST. # 112
Clarksburg, WV 26302
304-623-5851

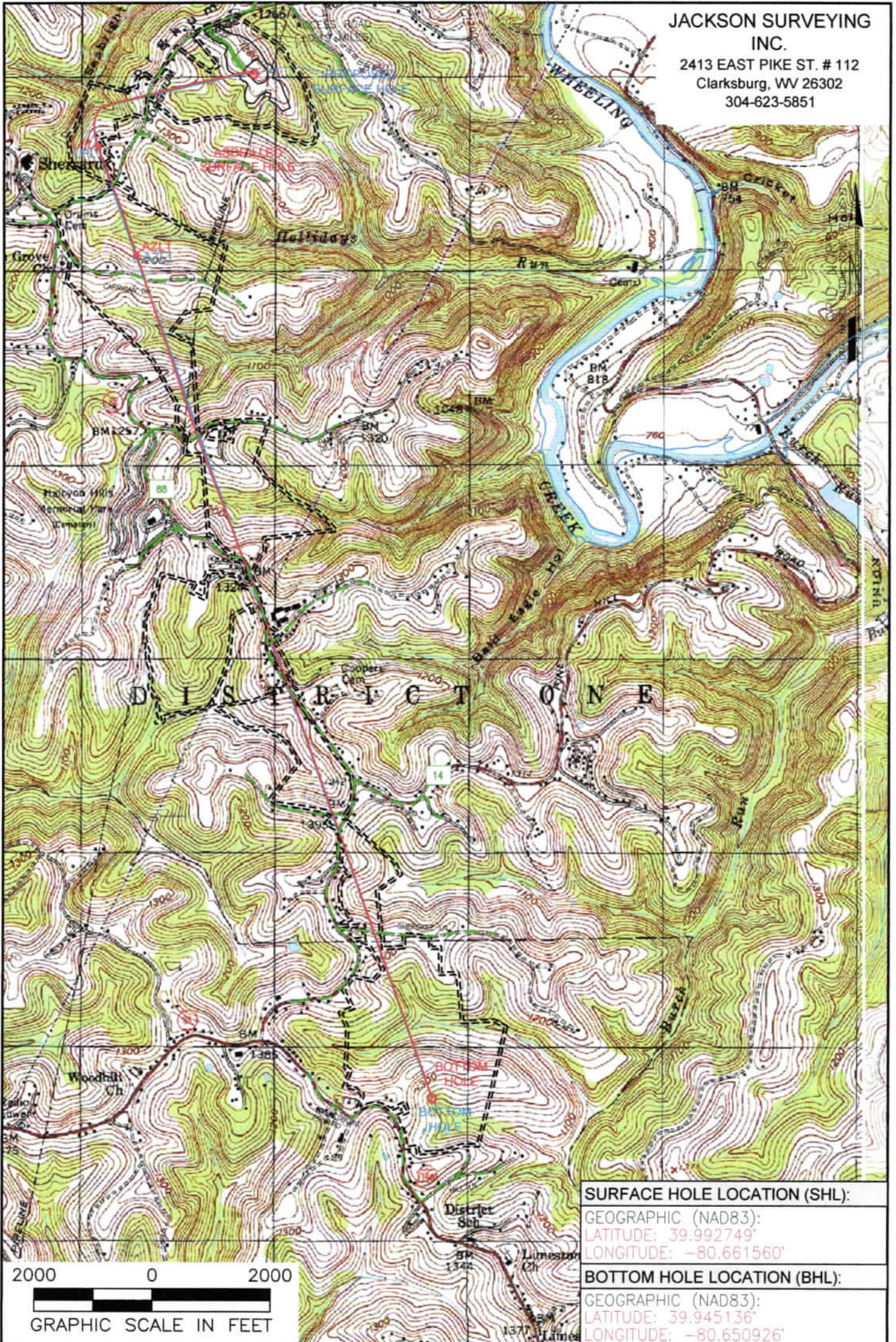

SURFACE HOLE LOCATION (SHL):

GEOGRAPHIC (NAD83):
LATITUDE: 39.992749°
LONGITUDE: -80.661560°

BOTTOM HOLE LOCATION (BHL):

GEOGRAPHIC (NAD83):
LATITUDE: 39.945136°
LONGITUDE: -80.650926°

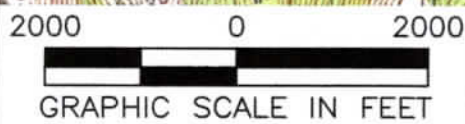

NOTES ON SURVEY

1. SURFACE AND ROYALTY OWNER INFORMATION AND THEIR BOUNDARIES SHOWN HEREON WERE PLOTTED FROM DEEDS AND/OR TAX PARCEL MAPS PROVIDED BY CLIENT AND/OR FIELD LOCATIONS.
2. THIS PLAT DOES NOT REPRESENT A BOUNDARY SURVEY OF THE PARCELS SHOWN HEREON.
3. ALL INSETS ARE GRID NORTH UNLESS OTHERWISE DEPICTED.

LEGEND:

- PROPOSED SURFACE HOLE / BOTTOM HOLE
- ☼ EXISTING / PRODUCING WELLHEAD
- LPL* LANDING POINT LOCATION
- 🌊 FLOOD PLAIN
- 10/27/2023
- PUBLIC ROAD
- ACCESS ROAD TO PREV. SITE
- == LEASE BOUNDARY
- PROPOSED PATH
- ASDRILLED PATH

WELL OPERATOR: SWN PRODUCTION COMPANY, LLC	WELL (FARM) NAME: DAVID REINBEAU MSH	WELL # 606H
ADDRESS: 1300 FORT PIERPONT ROAD, SUITE 200 MORGANTOWN, WV 26508	COUNTY - CODE MARSHALL - 051	DISTRICT; UNION
SURFACE OWNER: SHELLY A. & DAVID W. REINBEAU	USGS 7 1/2 QUADRANGLE MAP NAME MOUNDSVILLE, WV	API #: 47-051-02502

Latitude: 40°00'00"

SURFACE HOLE 10,242'

Latitude: 39°57'30"

BOTTOM HOLE 7,268'

JACKSON SURVEYING INC.

2413 EAST PIKE ST. # 112
Clarksburg, WV 26302
304-623-5851

Table with 2 columns: Location Name and UTM Coordinates (Northing, Easting). Includes Surface Hole, Landing Point, Azimuth Point, and Bottom Hole locations.



Table with 2 columns: Location Name and UTM Coordinates (Northing, Easting). Includes Surface Hole, Landing Point, Azimuth Point, and Bottom Hole locations.

Table with 5 columns: Line, Bearing, Distance, Description, Monument. Includes lines L1, L2, L4, L3 with bearings and distances.

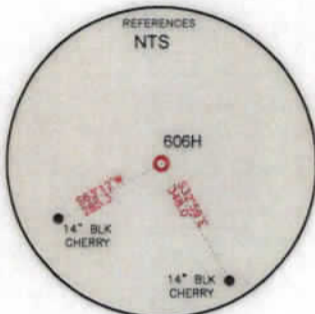
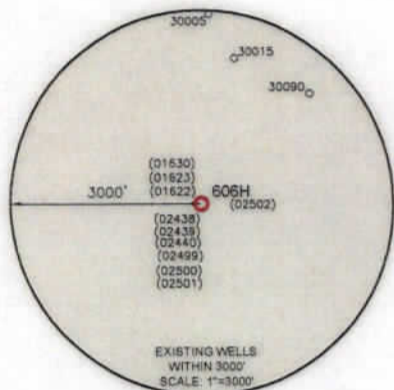

WELL RESTRICTIONS

- List of 6 well restrictions including distances from dwellings, buildings, water wells, streams, and public water supply.

NOTES ON SURVEY

- Notes on survey including information on boundaries, parcel maps, and grid north.

I, THE UNDERSIGNED, HEREBY CERTIFY THAT THIS PLAT IS CORRECT TO THE BEST OF MY KNOWLEDGE AND BELIEF AND SHOWS ALL THE INFORMATION REQUIRED BY LAW AND REGULATIONS ISSUED AND PRESCRIBED BY THE DEPARTMENT OF ENVIRONMENTAL PROTECTION.

P.S. 708

Signature of David L. Jackson

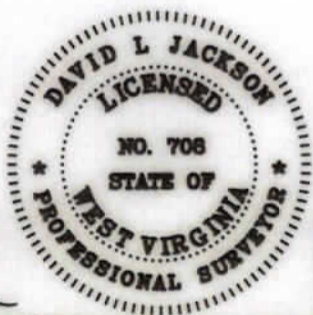

COMPANY: SWN Production Company, LLC

State of West Virginia logo and WVDE Office of Oil & Gas address: 601 57th Street, Charleston, WV 25034.

MINIMUM DEGREE OF ACCURACY: 1/200
PROVEN SOURCE OF ELEVATION: SURVEY GRADE GPS (NAVD 88, US FT)

DAVID REINBEAU MSH
OPERATOR'S WELL #: 606H
API WELL #: 47 STATE, 051 COUNTY, 02502 PERMIT

Well type and details form including: WELL TYPE (Oil, Gas, etc.), WATERSHED, DISTRICT, COUNTY, SURFACE OWNER, OIL & GAS ROYALTY OWNER, DRILL options, TARGET FORMATION (Marcellus), ESTIMATED DEPTH (10/27/2023).

Well operator and agent information form including: WELL OPERATOR (SWN Production Company, LLC), ADDRESS, CITY (Morgantown), STATE (WV), ZIP CODE (26508), DESIGNATED AGENT (Brittany Woody).

**JACKSON SURVEYING
INC.**

2413 EAST PIKE ST. # 112
Clarksburg, WV 26302
304-623-5851

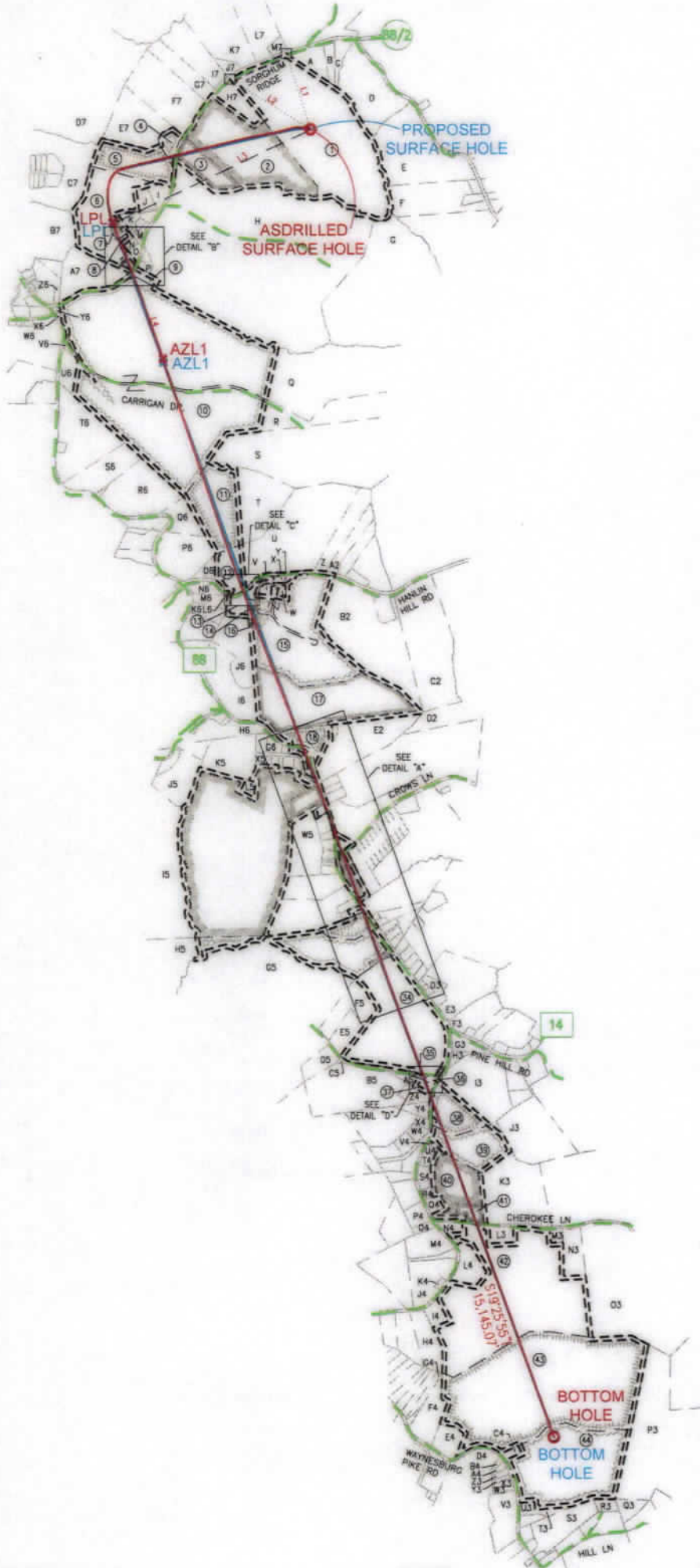

DETAIL "B"

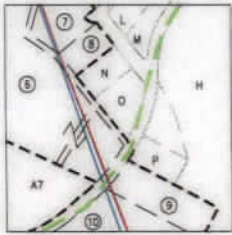

DETAIL "C"



DETAIL "D"

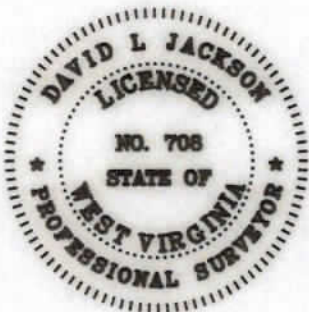

I, THE UNDERSIGNED, HEREBY CERTIFY THAT THIS PLAT IS CORRECT TO THE BEST OF MY KNOWLEDGE AND BELIEF AND SHOWS ALL THE INFORMATION REQUIRED BY LAW AND REGULATIONS ISSUED AND PRESCRIBED BY THE DEPARTMENT OF ENVIRONMENTAL PROTECTION.

P.S. 708

David L Jackson

2000 0 2000



GRAPHIC SCALE IN FEET

10/27/2023

REVISIONS:	COMPANY:		
	OPERATOR'S	DAVID REINBEAU MSH	API #: 47-051-02502
	WELL #:	606H	DATE: 10-05-2023
	DISTRICT:	COUNTY:	DRAWN BY: N. MANO
	UNION	MARSHALL	SCALE: N/A
		STATE:	DRAWING NO:
		WV	WELL LOCATION PLAT 2

**JACKSON SURVEYING
INC.**

2413 EAST PIKE ST. # 112
Clarksburg, WV 26302
304-623-5851

WELL BORE TRACTS		
TRACT	SURFACE OWNER (S) / ROYALTY OWNER (R)	TAX PARCEL
1	REINBEAU SHELLY A & DAVID W (S/R)	13-8-29
TRACT	SURFACE OWNER (S)	
2	REINBEAU SHELLY A & DAVID W (S)	13-8-27
3	REINBEAU RONALD W & FRIEDA A - LIFE (S)	13-07-22.2
4	SHEPHERD JAMES LEE II (S)	13-07-23
5	MCCLEINTOCK JOSIE & LARRY (S)	13-07-22.4
6	PATTERSON DANIEL & MICHELLE (S)	13-07-22
7	SBERNA JOHN L (S)	13-7E-04
8	SBERNA SANDRA (S)	13-7E-03
9	MCLAUGHLIN SHAWN & ELIZABETH (S)	13-08-23
10	HIERONIMUS C KEITH ET UX (S)	13-08-15
11	CARTER KELLY J (S)	13-10-19
12	WISE CLARA L (S)	13-10-18
13	LOY JEFFREY A & JULIE M (S)	13-10-31
14	MERINAR KENNETH LEE & LEEANN (S)	13-10B-08
15	MERINAR KENNETH LEE ET UX (S)	13-10-21.6
16	SPIELVOGEL HARRY C ET UX (S)	13-10B-10
17	METS PROPERTIES LLC (S)	13-10-22
18	STURGILL JULIE L & JOE D (S)	13-10-24
19	GELLNAR GARY (S)	13-13A-04
20	GELLNER GARY (S)	13-13A-03
21	HENDERSON SHERYL LYNN (S)	13-13A-02
22	SIBURT ERIC R & CARLA M (S)	13-13A-01
23	SCHABER LESLIE B & LORI D (S)	13-13-10
24	HARVEY JOSHUA STEVEN (S)	13-13-11.1
25	AVILA EDWARD A (S)	13-13-11.4
26	PENNINGTON KAREN LYNN (S)	13-09-32.5
27	HACKATHORN JUDITH ANN - LIFE (S)	13-09-31.2
28	COOPER TIM L (S)	13-09-31.3
29	TH EXPLORATION LLC (S)	13-13-13.1
30	ANDERSON MICHAEL L (S)	13-13-14
31	BROWN ROSEMARY M (S)	13-13-15
32	GODDARD RUSSELL E & MICHELE L (S)	13-13-16
33	GODDARD RUSSELL E & MICHELE L (S)	13-13-17.1
34	LILLEY PAUL THOMAS (S)	13-13-17
35	CUNNINGHAM TOYA A - TOD (S)	13-14-48.1
36	GRAY DARYL J (S)	13-14-49
37	SCOTT RANDALL C ET UX (S)	13-14-48
38	OLDFIELD KAREN KAY (S)	13-14-33
39	GUNTO CARL M ET UX (S)	13-14-34
40	WALTER DANA F & VINCENT LORETTO (S)	13-14-38
41	THOMAS WAYNE L - THOMAS MARILYN (S)	13-14-39
42	KOONTZ CARL JR ET AL (S)	14-05-24
43	FRANCIS LISA JANE (S)	14-05-37
44	TATICH DANIEL EDWARD TRUST (S)	14-05-36

*Highlighted Parcels impacted by drilling activity.

ADJOINING OWNERS TABLE		
TRACT	SURFACE OWNER	TAX PARCEL
A	NARRISH KEVIN	13-08-30
B	SOUTH CHRISTOPHER C	13-08-31
C	KOSTELECKY JOSEPH J JR & CAROLYN - TOD	13-08-31.1
D	FUNK CHARLES D ET UX	13-08-32
E	LOY EUGENE EST ET AL	13-08-01
F	LIBERTY JOHN ET UX	13-08-10
G	MCCOMBS JOHN A SR, THOMAS E & BETH	13-08-11
H	MCCOMBS JOHN A SR, THOMAS E & BETH	13-08-26
I	CAIN ROGER L II	13-7E-10
J	MALARSKI CHAD	13-7E-09
K	SANDRETH ELIZABETH A	13-7E-05
L	MILLER RALPH D ET UX	13-7E-06
M	CRAWFORD GARY J	13-7E-07
N	SBERNA JOSEPH L JR & TAMMY L	13-7E-02
O	SBERNA JOSEPH L JR & TAMMY	13-7E-01
P	PERRY JOSEPH P JR	13-08-24
Q	CONNER AMBER D & DAVID HANES JR	13-08-14
R	CONNER AMBER D & DAVID HANES JR	13-08-13
S	CONNER AMBER D & DAVID HANES JR	13-08-12
T	CARTER KELLY J	13-10-20
U	MELNIK BRUCE A ET UX	13-10-21
V	GAST COREY M & JOLIE A	13-10-21.10
W	BOWERS MARY L	13-10B-37
X	SHAW SIDNEY S & ROBIN MARIE	13-10B-02
Y	SHAW SIDNEY S & ROBIN MARIE	13-10B-01
Z	MELNIK BRUCE A ET UX	13-10-21.1
AZ	MONTGOMERY TORIE	13-10-21.2
B2	JONES NICHOLAS & EVELINE J	13-10-21.8

DETAIL "A"



10/27/2023



I, THE UNDERSIGNED, HEREBY CERTIFY THAT THIS PLAT IS CORRECT TO THE BEST OF MY KNOWLEDGE AND BELIEF AND SHOWS ALL THE INFORMATION REQUIRED BY LAW AND REGULATIONS ISSUED AND PRESCRIBED BY THE DEPARTMENT OF ENVIRONMENTAL PROTECTION.

P.S. 708 *David L Jackson*

REVISIONS:	COMPANY:		
	OPERATOR'S	DAVID REINBEAU MSH	API #: 47-051-02502
	WELL #:	606H	DATE: 10-05-2023
	DISTRICT:	UNION	COUNTY: MARSHALL
		STATE: WV	DRAWN BY: N. MANO
			SCALE: N/A
			DRAWING NO: WELL LOCATION PLAT 3

**JACKSON SURVEYING
INC.**

2413 EAST PIKE ST. # 112
Clarksburg, WV 26302
304-623-5851

ADJOINING OWNERS TABLE		
TRACT	SURFACE OWNER	TAX PARCEL
C2	JONES NICHOLAS & EVELINE J	13-09-08
D2	EDISON MARK C ET UX	13-09-09
E2	METS PROPERTIES LLC	13-10-23
F2	METS PROPERTIES LLC	13-10-24.1
G2	MILLER KENNETH LEE - TOD	13-09-33
H2	CHAMBERS ROBIN L & DENICE E	13-09-33.1
I2	CHAMBERS ROBIN L & DENICE E	13-09-33.2
J2	EAGLE LTD	13-09-32.1
K2	VEMURI HOME & GARDEN LLC	13-09-34
L2	FRYE JACQUELINE L & CHARLES G	13-09-31.1
M2	PARSONS JAY D ET UX	13-14-01
N2	CAMPBELL CODIE JOHNELLE	13-14-02
O2	FREEMAN RAYMOND CHRISTOPHER	13-14-03
P2	TROWBRIDGE ROBEYN & JOSHUA SKIDGEL	13-14-05
Q2	TROWBRIDGE ROBEYN & JOSHUA SKIDGEL	13-14-6.1
R2	CLOVIS JUSTIN	13-14-6.3
S2	KENDZIERSKI ALAN B ET UX	13-14-6.4
T2	GIVENS BRUCE E ET UX	13-14-06
U2	GIVENS BRUCE E ET UX	13-14-7.2
V2	CHAMBERS DOROTHY-LIFE	13-14-07
W2	COTTRELL COLE T	13-14-7.5
X2	DORAN BRIAN W ET UX	13-14-7.4
Y2	LEWEY CHARLES L & MARGARET A	13-14-7.1
Z2	BECKNER DAVID E & DEBORAH K	13-14-7.3
A3	GANTZER MARCIA L & JAMES E	13-14-8.2
B3	GANTZER MARCIA L & JAMES E	13-14-8.1
C3	YOHO RONNIE E	13-14-8.3
D3	YOHO GAIL L & RONNIE E	13-14-8.4
E3	ROVER PIPELINE LLC	13-14-08
F3	ROVER PIPELINE LLC	13-14-09
G3	DRAKE JASON T & DEANNA J	13-14-31.1
H3	LYONS BRENT G ET UX	13-14-31
I3	HENRY GH & JANET FAMILY TRUST	13-14-32
J3	HENRY GH & JANET FAMILY TRUST	13-14-29
K3	FOSTER CHARLES S & BRENDA	13-14-38.2
L3	EBERT BRADLEY	14-05-24.9
M3	WILSON ROBERT J & REBECCA S	14-05-24.6
N3	FOSTER CAITLIN E	13-14-50
O3	SMITH EDWARD LEE II	14-05-26
P3	HILL KAY F ET AL	14-05-28
Q3	HILL KAY F ET AL	14-05-29
R3	LILLEY ROGER W ET UX	14-05-32.5
S3	YOHO KIM MARLENE	14-05-33
T3	WHIPKEY ROGER ET UX	14-05-35
U3	SIMONS JORDAN M & VICTORIA G BENLINE SIMONS	14-05-36.1
V3	DERROW SAMUEL R ET UX	14-05-39
W3	KELLEY RODNEY & BONNIE	14-05-38.1
X3	KELLEY RODNEY & BONNIE	14-05-38
Y3	KELLEY RODNEY & BONNIE	14-05-38.2
Z3	KELLEY RODNEY & BONNIE	14-05-38.3
A4	WALTER DANA F	14-05-38.4
B4	WALTER DANA F	14-05-38.5
C4	FRANCIS LISA JANE	14-05-36.2
D4	BISHOP PENNY S ET VIR	14-05-39.1
E4	FRANCIS LISA JANE	14-05-37.1
F4	GALLOWAY HARRY L	14-05-11
G4	J & R DEVELOPMENT LLC	14-05-11.3
H4	SMITH MARK ALLEN ET UX	14-05-23
I4	KOONTZ COLE	14-05-24.8
J4	WILLIAMS CARL R & RHONDA L	14-05-24.5
K4	WILLIAMS CARL R & RHONDA L	14-05-24.4
L4	KOONTZ JOHN R	14-05-24.3
M4	WOODS JOHN E SR & FRANCES J	14-05-24.2
N4	KOONTZ CARL E JR	14-05-24.1
O4	SNYDER DAVID L - LIFE	13-14-40
P4	SNYDER DAVID L - LIFE	13-14-44
Q4	HEWITT MARTIN O ET UX	13-14-38.3
R4	SMITH CAROLYN - TOD	13-14-38.4
S4	GUMP CHRISTINA H	13-14-37
T4	WEST THOMAS J JR & KATHY ANN	13-14-36

ADJOINING OWNERS TABLE		
TRACT	SURFACE OWNER	TAX PARCEL
U4	WEST THOMAS J JR & KATHY ANN	13-14-35
V4	WEST THOMAS J JR & KATHY ANN	13-14-34.1
W4	POLANSKI LYND SAY N	13-14-41.2
X4	FERDA BRIAN T	13-14-46.2
Y4	BOWIE CHRISTOPHER E	13-14-46.1
Z4	CUNNINGHAM CHAD	13-14-47
A5	KOONTZ HELEN - TOD	13-14-48.2
B5	CUNNINGHAM CHAD L & JEFFREY H	13-14-47.1
C5	CUNNINGHAM JEFFREY H & CHAD	13-13-20
D5	CUNNINGHAM JEFFREY H & CHAD	13-13-19
E5	HELLER AMBER R & EDGAR D JR	13-13-18.1
F5	HELLER AMBER R & EDGAR D JR	13-13-18
G5	HELLER EDGAR D JR TRUST	13-13-21
H5	HELLER EDGAR D JR TRUST	13-13-23
I5	HELLER EDGAR D JR TRUST	13-13-09
J5	KOCH JOHN E & BARBARA A - TOD	13-13-9.3
K5	SCHABER LESLIE B & LORI D	13-13-10.1
L5	SCHABER LESLIE B & LORI D	13-13-10.2
M5	TH EXPLORATION, LLC	13-13-13.3
N5	NORRIS TABITHA L	13-13-13.2
O5	GROSS COBER R ET UX	13-13-13
P5	SHANNON WILLIAM JAMES	13-13-12
Q5	BURTON ERIC & LEE ANN	13-13-11.7
R5	SCARNECHIA DAVID W	13-13-11.6
S5	SCARNECHIA DAVID W	13-13-11
T5	SCARNECHIA DAVID W	13-13-11.5
U5	HAIGHT DONNA JEAN	13-13-11.8
V5	HAIGHT DONNA JEAN	13-13-11.2
W5	SHANNON WILLIAM JAMES	13-13-11.3
X5	BACH WILBERT H II ET UX	13-13A-10
Y5	BACH WILBERT H II ET UX	13-13A-11
Z5	SCHABER LESLIE B & LORI D	13-13A-12
A6	SCHABER LESLIE B & LORI D	13-13A-13.1
B6	KNOBLICH RICHARD KARL ET UX	13-13A-13
C6	WARD ROBERT C JR & VICKY LINN	13-13A-15
D6	SCHABER LESLIE & LORI	13-13-10.3
E6	CARR PHYLLIS J	13-13A-06
F6	HESS GEORGE JR ET UX	13-13A-07
G6	WHIPKEY ROBERT	13-13A-08
H6	MARSH DAVID A ET UX	13-10-28
I6	THORN RONNIE L & BETH A	13-10-30.1
J6	ELLIOTT GLENN F	13-10-30
K6	ELLIOTT GLENN F	13-10-33
L6	MANUFACTURING LIGHT & HEAT CO	13-10-18.2
M6	RUSH J LARRY & LINDA M	13-10-32.1
N6	RUSH JOSEPH L & LINDA M	13-10-32
O6	MOSA BLAIR P ET UX	13-10-18.1
P6	TARGOSKY ROSEMARY & MCCOY-GOOGEL BARAK	13-10-16
Q6	CARTER KELLY J	13-10-15.1
R6	WALTON DANIEL JR & THERESA	13-08-17
S6	WALTON DANIEL JR & THERESA	13-08-18
T6	MCCOMBS THOMAS E & BETH E -TOD	13-08-19
U6	PRESBYTERIAN CHURCH	13-08-20
V6	ALLEN GROVE PRESBYTERIAN CHURCH	13-08-15.1
W6	KAHLBAUGH DAVID W & DELORES- TOD	13-07-24
X6	HIERONIMUS C KEITH ET UX	13-7A-23
Y6	SHARRARD CEMETERY	13-7A-22
Z6	JOHNSON GILBERT	13-7A-03
A7	MCCOMBS THOMAS E & BETH E - TOD	13-08-16
B7	CMK REALTY LLC	13-7A-09
C7	BOARD OF EDUCATION	13-07-16
D7	BOARD OF EDUCATION	13-07-17
E7	MCCOMBS JOHN A SR & MARILYN S	13-07-22.1
F7	REINBEAU DAVID W & SHELLY A	13-07-22.3
G7	REINBEAU DAVID W & SHELLY A	13-07-21.1
H7	BOWMAN MICHAEL ET UX	13-08-28
I7	BOWMAN MICHAEL J & CONSTANCE G	13-07-21
J7	ALEXANDER LORRAINE	13-07-20
K7	ALEXANDER LORRAINE	13-07-18.1
L7	ALEXANDER LORRAINE	13-07-18
M7	SAMPSON EDITH VIRGINIA EST	13-07-19

10/27/2023

REVISIONS:	COMPANY:	 		
	OPERATOR'S	DAVID REINBEAU MSH	API #:	10-05-2023
	WELL #:	606H	47-051-02502	DRAWN BY: N. MANO
	DISTRICT:	UNION	COUNTY:	SCALE: N/A
			STATE:	DRAWING NO:
			WV	WELL LOCATION PLAT 4

**INFORMATION SUPPLIED UNDER WEST VIRGINIA CODE
Chapter 22, Article 6A, Section 5(a)(5)
IN LIEU OF FILING LEASE(S) AND OTHER CONTINUING CONTRACT(S)**

Under the oath required to make the verification on page 1 of this Notice and Application, I depose and say that I am the person who signed the Notice and Application for the Applicant, and that –

- (1) the tract of land is the same tract described in this Application, partly or wholly depicted in the accompanying plat, and described in the Construction and Reclamation Plan;
- (2) the parties and recordation data (if recorded) for lease(s) or other continuing contract(s) by which the Applicant claims the right to extract, produce or market the oil or gas are as follows:

Lease Name or Number	Grantor, Lessor, etc.	Grantee, Lessee, etc.	Royalty	Book/Page
----------------------	-----------------------	-----------------------	---------	-----------

See Exhibit A

RECEIVED
Office of Oil and Gas
OCT 12 2023
WV Department of
Environmental Protection

***Highlighted Parcels impacted by drilling activity**

**Acknowledgement of Possible Permitting/Approval
In Addition to the Office of Oil and Gas**

The permit applicant for the proposed well work addressed in this application hereby acknowledges the possibility of the need for permits and/or approvals from local, state, or federal entities in addition to the DEP, Office of Oil and Gas, including but not limited to the following:

- WV Division of Water and Waste Management
- WV Division of Natural Resources WV Division of Highways
- U.S. Army Corps of Engineers
- U.S. Fish and Wildlife Service
- County Floodplain Coordinator

The applicant further acknowledges that any Office of Oil and Gas permit in no way overrides, replaces, or nullifies the need for other permits/approvals that may be necessary and further affirms that all needed permits/approvals should be acquired from the appropriate authority before the affected activity is initiated.

Well Operator: SWN Production Co., LLC

By: 
Gavin Nadeau, RPL

Its: Senior Landman

4703102502

EXHIBIT "A"
David Rankins MBE 6001
Marshall County, West Virginia

Minced to and made a part of the State of West Virginia Oil and Gas Permit Form, WV-641, by SWN Production Company, LLC, Operator

#	TWP	LESSOR	LESSEE	ROYALTY	REVENUE	% INTEREST NOT RECEIVED BY SWN PRODUCTION COMPANY, LLC
1)	15-0088-0023-0000	Shady A. Rankins and David W. Rankins, her husband, joint tenants, with right of survivorship	Chesapeake Appalachia, L.L.C. SWN Production Company, LLC	14.00%	688424 32110	0.00%
2)	15-0088-0023-0000	Shady A. Rankins and David W. Rankins, her husband, joint tenants, with right of survivorship	Chesapeake Appalachia, L.L.C. SWN Production Company, LLC	14.00%	688424 32110	0.00%
3)	15-0087-0023-0001	James D. Gardner, a widower	TribEnergy Holdings, LLC NPAR, LLC Chesapeake U.S.A. Inc. Chesapeake Appalachia, L.L.C. SWN Production Company, LLC	16.00%	799258 36430 756232 30532 33110	
		Robert E. Gardner and Mary Gardner, his wife	TribEnergy Holdings, LLC NPAR, LLC Chesapeake U.S.A. Inc. Chesapeake Appalachia, L.L.C. SWN Production Company, LLC	16.00%	717129 36430 756232 30532 33110	
		Glenn N. McGuire and Kenneth McGuire, her husband	TribEnergy Holdings, LLC NPAR, LLC Chesapeake U.S.A. Inc. Chesapeake Appalachia, L.L.C. SWN Production Company, LLC	16.00%	717129 36430 756232 30532 33110	4.00%
		Lisa Gardner, w/o Lindelle P. Gardner, a widow	TribEnergy Holdings, LLC NPAR, LLC Chesapeake U.S.A. Inc. Chesapeake Appalachia, L.L.C. SWN Production Company, LLC	16.00%	717129 36430 756232 30532 33110	
4)	15-0087-0023-0000	James D. Gardner, a widower	TribEnergy Holdings, LLC NPAR, LLC Chesapeake U.S.A. Inc. Chesapeake Appalachia, L.L.C. SWN Production Company, LLC	16.00%	799258 36430 756232 30532 33110	
		Robert E. Gardner and Mary Gardner, his wife	TribEnergy Holdings, LLC NPAR, LLC Chesapeake U.S.A. Inc. Chesapeake Appalachia, L.L.C. SWN Production Company, LLC	16.00%	717129 36430 756232 30532 33110	
		Glenn N. McGuire and Kenneth McGuire, her husband	TribEnergy Holdings, LLC NPAR, LLC Chesapeake U.S.A. Inc. Chesapeake Appalachia, L.L.C. SWN Production Company, LLC	16.00%	717129 36430 756232 30532 33110	0.00%
		Lisa Gardner, w/o Lindelle P. Gardner, a widow	TribEnergy Holdings, LLC NPAR, LLC Chesapeake U.S.A. Inc. Chesapeake Appalachia, L.L.C. SWN Production Company, LLC	16.00%	717129 36430 756232 30532 33110	
5)	15-0087-0023-0004	James D. Gardner, a widower	TribEnergy Holdings, LLC NPAR, LLC Chesapeake U.S.A. Inc. Chesapeake Appalachia, L.L.C. SWN Production Company, LLC	16.00%	799258 36430 756232 30532 33110	
		Robert E. Gardner and Mary Gardner, his wife	TribEnergy Holdings, LLC NPAR, LLC Chesapeake U.S.A. Inc. Chesapeake Appalachia, L.L.C. SWN Production Company, LLC	16.00%	717129 36430 756232 30532 33110	
		Glenn N. McGuire and Kenneth McGuire, her husband	TribEnergy Holdings, LLC NPAR, LLC Chesapeake U.S.A. Inc. Chesapeake Appalachia, L.L.C. SWN Production Company, LLC	16.00%	717129 36430 756232 30532 33110	0.00%
		Lisa Gardner, w/o Lindelle P. Gardner, a widow	TribEnergy Holdings, LLC NPAR, LLC Chesapeake U.S.A. Inc. Chesapeake Appalachia, L.L.C. SWN Production Company, LLC	16.00%	717129 36430 756232 30532 33110	
6)	15-0087-0023-0000	Kathleen M. Haller and Michael D. Haller, wife and husband	Chesapeake Appalachia, L.L.C. SWN Production Company, LLC	12.75%	704178 33110	0.00%
7)	15-0078-0004-0000	James D. Gardner, a widower	TribEnergy Holdings, LLC NPAR, LLC Chesapeake U.S.A. Inc. Chesapeake Appalachia, L.L.C. SWN Production Company, LLC	16.00%	799258 36430 756232 30532 33110	
		Robert E. Gardner and Mary Gardner, his wife	TribEnergy Holdings, LLC NPAR, LLC Chesapeake U.S.A. Inc. Chesapeake Appalachia, L.L.C. SWN Production Company, LLC	16.00%	717129 36430 756232 30532 33110	
		Glenn N. McGuire and Kenneth McGuire, her husband	TribEnergy Holdings, LLC NPAR, LLC Chesapeake U.S.A. Inc. Chesapeake Appalachia, L.L.C. SWN Production Company, LLC	16.00%	717129 36430 756232 30532 33110	0.00%
		Lisa Gardner, w/o Lindelle P. Gardner, a widow	TribEnergy Holdings, LLC NPAR, LLC Chesapeake U.S.A. Inc. Chesapeake Appalachia, L.L.C. SWN Production Company, LLC	16.00%	717129 36430 756232 30532 33110	

RECEIVED
Office of Oil and Gas
OCT 12 2023
WV Department of
Environmental Protection

10/27/2023

4705102502

EXHIBIT "A"
David Rainey MBH 6061
Marshall County, West Virginia

Attached to and made a part of the State of West Virginia Oil and Gas Permit Form, WV-6A1, by SWN Production Company, LLC, Operator

#	TMP	LESSOR	LESSEE	ROYALTY	BLPG	% INTEREST NOT LEASED BY SWN PRODUCTION COMPANY, LLC
8)	13-0071-0020-0000	James D. Gardner	Tollansky Holdings, LLC NPAR, LLC Chevron U.S.A. Inc. Chesapeake Appalachia, L.L.C. SWN Production Company, LLC	16.00%	709338 24430 756332 30532 23110	
		Robert E. Gardner and Mary Gardner, his wife	Tollansky Holdings, LLC NPAR, LLC Chevron U.S.A. Inc. Chesapeake Appalachia, L.L.C. SWN Production Company, LLC	16.00%	717119 24430 756332 30532 23110	0.00%
		Olivia N. McGuire and Kenneth McGuire, her husband	Tollansky Holdings, LLC NPAR, LLC Chevron U.S.A. Inc. Chesapeake Appalachia, L.L.C. SWN Production Company, LLC	16.00%	717119 24430 756332 30532 23110	0.00%
		Lisa Gardner, aka LisaBeth P. Gardner	Tollansky Holdings, LLC NPAR, LLC Chevron U.S.A. Inc. Chesapeake Appalachia, L.L.C. SWN Production Company, LLC	16.00%	717119 24430 756332 30532 23110	0.00%
9)	13-0028-0025-0000	Shawn E. Mclaughlin and Beth A. Mclaughlin, his wife	Tollansky Holdings, LLC NPAR, LLC Chevron U.S.A. Inc. Chesapeake Appalachia, L.L.C. SWN Production Company, LLC	18.00%	721551 24430 756332 30532 23110	0.00%
10)	13-0028-0015-0000	C. Keith Huermeaux and Tami L. Huermeaux, husband and wife	Chesapeake Appalachia, L.L.C. SWN Production Company, LLC	18.00%	873464 45281	0.00%
11)	13-0019-0018-0000	Edly J. Carter, single	American Petroleum Partners Operating, LLC SWN Production Company, LLC	19.00%	909423 45281	0.00%
12)	13-0019-0018-0000	Russell Platt, single and Michael Geary, single	Chesapeake Appalachia, L.L.C. SWN Production Company, LLC	12.50%	688478 23110	0.00%
13)	13-0019-0021-0000	Arch James Norem and Nancy M. Norem, husband and wife	American Petroleum Partners Operating, LLC SWN Production Company, LLC	18.00%	894368 45281	0.00%
14)	13-0109-0008-0000	Kenneth Lee Marzari and Louise Marzari, husband and wife	American Petroleum Partners Operating, LLC SWN Production Company, LLC	20.00%	956330 45281	0.00%
15)	13-0019-0021-0000	Kenneth Lee Marzari and Lee Ann Marzari, his wife	Chesapeake Appalachia, L.L.C. SWN Production Company, LLC	12.50%	681457 23110	0.00%
16)	13-0109-0010-0000	Henry C. Spjorvold and Jacqueline R. Spjorvold, husband and wife	American Petroleum Partners Operating, LLC SWN Production Company, LLC	18.00%	1051412 45281	0.00%
17)	13-0019-0023-0000	William D. Anderson and Karen L. Anderson, husband and wife	Chesapeake Appalachia, L.L.C. SWN Production Company, LLC	14.00%	684340 23110	0.00%
18)	13-0019-0024-0000	William D. Anderson and Karen L. Anderson, husband and wife	Chesapeake Appalachia, L.L.C. SWN Production Company, LLC	14.00%	684340 23110	0.00%
19)	13-0113-0004-0000	Gary Gifford and Dianne Gifford, husband and wife	American Petroleum Partners Operating, LLC SWN Production Company, LLC	18.00%	935303 45281	0.00%
20)	13-0113-0003-0000	Gary Gifford and Dianne Gifford, husband and wife	American Petroleum Partners Operating, LLC SWN Production Company, LLC	18.00%	935303 45281	0.00%
21)	13-0113-0002-0000	Beryl Lynn Henderson and Ronald P. Henderson, wife and husband	American Petroleum Partners Operating, LLC SWN Production Company, LLC	18.00%	93846 45281	0.00%
22)	13-0113-0001-0000	Eric R. Silant and Carla M. Silant, husband and wife	American Petroleum Partners Operating, LLC SWN Production Company, LLC	18.00%	10621 45281	0.00%
23)	13-0013-0010-0000	John F. Miller, Sr. Trustee of the John F. Miller, Sr. Irrevocable Trust Carol A. Wenzel aka Carol A. Miller, acting as Trustee for the Carol A. Wenzel Irrevocable Trust dated October 28, 2010	Chevron U.S.A. Inc. EQT Antrim L.L.C. SWN Production Company, LLC Chevron U.S.A. Inc. EQT Antrim L.L.C.	16.00%	77570 1166273 77570 471 1166273	0.00%
24)	13-0013-0011-0001	Justin Bruce Harvey and James L. Harvey, husband and wife	American Petroleum Partners Operating, LLC SWN Production Company, LLC	18.00%	95597 45281	0.00%
25)	13-0013-0013-0004	Edward A. Arls and Andrea D. Arls, husband and wife	TH Exploration, LLC SWN Production Company, LLC	15.00%	1122381 1166256	0.00%
26)	13-0009-0033-0001	IBC Minerals, LLC	TH Exploration, LLC SWN Production Company, LLC	15.00%	1122484 1166256	0.00%
27)	13-0009-0031-0002	Judith Ann Healdstrom, a single woman	SWN Production Company, LLC	18.00%	1138488	0.00%
28)	13-0009-0031-0001	Tom L. Conner, a single man	SWN Production Company, LLC	18.00%	1162111	0.00%
29)	13-0013-0013-0001	Charles L. Wright, Jr. and Cara Edith Wright, his wife	American Petroleum Partners Operating, LLC SWN Production Company, LLC	17.50%	91923 45281	0.00%
30)	13-0013-0014-0000	Michael I. Anderson, single	American Petroleum Partners Operating, LLC SWN Production Company, LLC	18.00%	91841 45281	0.00%
31)	13-0013-0015-0000	Rosemary M. Brown, single	Chesapeake Appalachia, L.L.C. Chevron U.S.A. Inc. EQT Antrim L.L.C. SWN Production Company, LLC	17.00%	70197 30461 471 1166273	0.00%
32)	13-0013-0016-0000	Russell E. Goddard and Michelle L. Goddard, husband and wife	Chesapeake Appalachia, L.L.C. Chevron U.S.A. Inc. EQT Antrim L.L.C. SWN Production Company, LLC	18.75%	716977 30461 471 1166273	0.00%
33)	13-0013-0017-0001	Russell E. Goddard, married	SWN Production Company, LLC	18.00%	1158453	0.00%
34)	13-0013-0017-0000	Paul Thomas Lilly, a widow	TH Exploration, LLC Outfront Energy Corporation & Fossil Creek Ohio, LLC American Petroleum Partners Operating, LLC Chevron U.S.A. Inc. EQT Antrim L.L.C. SWN Production Company, LLC	18.00%	841133 16728 16788 4090 471 1166273	0.00%

RECEIVED
Office of Oil and Gas

OCT 12 2023

WV Department of
Environmental Protection

10/27/2023

4705102502

EXHIBIT "A"
David Robinson MDH 0601
Marshall County, West Virginia

Attached to and made a part of the State of West Virginia Oil and Gas Permit Form, WVA-6A1, by SWN Production Company, LLC, Operator

#	TMP	LESSOR	LESSEE	ROYALTY	BCLPG	% INTEREST NOT LEASED BY SWN PRODUCTION COMPANY, LLC
37)	13-0014-0014-0001	Tanya A. Cunningham, a single woman	SWN Production Company, LLC	18.00%	1165266	0.00%
		Carys M. Platt Ph.D. Carys Marie Ostrander, a widow	Chesrow U.S.A. Inc	16.00%	950209	
			SWN Production Company, LLC		1166273	
		Jan Elaine Ostrander, Jr., a widow	Chesrow U.S.A. Inc	16.00%	94970	
			EQT Atmos LLC		471	
		John Wayne Ostrander, a married man dealing in his sole and separate property	SWN Production Company, LLC	16.00%	956318	
			Chesrow U.S.A. Inc		471	
			SWN Production Company, LLC		1166273	
		Laticia Trigg, Ph.D. Laticia Rose Ostrander, a widow	Chesrow U.S.A. Inc	16.00%	94976	
			EQT Atmos LLC		471	
			SWN Production Company, LLC		1166273	
		Linda S. Ostrander, a widow	Chesrow U.S.A. Inc	16.00%	948177	
			EQT Atmos LLC		471	
	SWN Production Company, LLC		1166273			
Phyllis Jean Ostrander, a widow	Chesrow U.S.A. Inc	16.00%	950199			
	EQT Atmos LLC		471			
	SWN Production Company, LLC		1166273			
Robert Lee Ostrander, a single man	Chesrow U.S.A. Inc	16.00%	948174			
	EQT Atmos LLC		471			
	SWN Production Company, LLC		1166273			
Sharon Heath Ph.D. Sharon Jeanita Ostrander, a single woman	Chesrow U.S.A. Inc	16.00%	94973			
	EQT Atmos LLC		471			
	SWN Production Company, LLC		1166273			
Independent Order of Odd Fellows 9 Whooling Lodge	American Petroleum Partners Operating, LLC	17.00%	1021580			
	SWN Production Company, LLC		48263			
Lorraine E. Hatfield, a widow	American Petroleum Partners Operating, LLC	20.00%	951434			
	SWN Production Company, LLC		48263			
38)	13-0014-0014-0003	Daryl J. Gray, a single man	Tollanery Holdings, LLC	18.00%	720373	0.00%
			NP&R, LLC		25449	
			Chesrow U.S.A. Inc		750312	
			EQT Atmos LLC		471	
			SWN Production Company, LLC		1166273	
		Jan Elaine Ostrander, Jr., a widow	Chesrow U.S.A. Inc	16.00%	1166273	
			EQT Atmos LLC		1166273	
			SWN Production Company, LLC		1166273	
		Linda S. Ostrander, a widow	Chesrow U.S.A. Inc	16.00%	1166273	
			EQT Atmos LLC		1166273	
			SWN Production Company, LLC		1166273	
		Phyllis Jean Ostrander, a widow	Chesrow U.S.A. Inc	16.00%	1166273	
			EQT Atmos LLC		1166273	
	SWN Production Company, LLC		1166273			
Robert Lee Ostrander, a single man	Chesrow U.S.A. Inc	16.00%	1166273			
	EQT Atmos LLC		1166273			
	SWN Production Company, LLC		1166273			
Carys M. Platt Ph.D. Carys Marie Ostrander, a widow	Chesrow U.S.A. Inc	16.00%	1166273			
	EQT Atmos LLC		1166273			
	SWN Production Company, LLC		1166273			
Sharon Heath Ph.D. Sharon Jeanita Ostrander, a single woman	Chesrow U.S.A. Inc	16.00%	1166273			
	EQT Atmos LLC		1166273			
	SWN Production Company, LLC		1166273			
Laticia Trigg Ph.D. Laticia Rose Ostrander	Chesrow U.S.A. Inc	16.00%	1166273			
	EQT Atmos LLC		1166273			
	SWN Production Company, LLC		1166273			
John Wayne Ostrander, a married man dealing in his sole and separate property	Chesrow U.S.A. Inc	16.00%	1166273			
	EQT Atmos LLC		1166273			
	SWN Production Company, LLC		1166273			
37)	13-0014-0014-0000	Carys M. Platt Ph.D. Carys Marie Ostrander, a widow	Chesrow U.S.A. Inc	16.00%	950209	0.00%
			EQT Atmos LLC		471	
			SWN Production Company, LLC		1166273	
		Jan Elaine Ostrander, Jr., a widow	Chesrow U.S.A. Inc	16.00%	94970	
			EQT Atmos LLC		471	
		John Wayne Ostrander, a married man dealing in his sole and separate property	SWN Production Company, LLC	16.00%	1166273	
			Chesrow U.S.A. Inc		956318	
			EQT Atmos LLC		471	
		Laticia Trigg, Ph.D. Laticia Rose Ostrander, a widow	SWN Production Company, LLC	16.00%	1166273	
			Chesrow U.S.A. Inc		94976	
			EQT Atmos LLC		471	
			SWN Production Company, LLC		1166273	
		Linda S. Ostrander, a widow	Chesrow U.S.A. Inc	16.00%	948177	
	EQT Atmos LLC		471			
	SWN Production Company, LLC		1166273			
Phyllis Jean Ostrander, a widow	Chesrow U.S.A. Inc	16.00%	950199			
	EQT Atmos LLC		471			
	SWN Production Company, LLC		1166273			
Randall C. Scott and Donna C. Scott, his wife	SWN Production Company, LLC	16.00%	943583			
	EQT Atmos LLC		471			
	SWN Production Company, LLC		1166273			
Robert Lee Ostrander, a single man	Chesrow U.S.A. Inc	16.00%	948174			
	EQT Atmos LLC		471			
	SWN Production Company, LLC		1166273			
Sharon Heath Ph.D. Sharon Jeanita Ostrander, a single woman	Chesrow U.S.A. Inc	16.00%	94973			
	EQT Atmos LLC		471			
	SWN Production Company, LLC		1166273			
18)	13-0014-0014-0000	Karen Oldfield, Trustee of the Karen Oldfield Family Trust dated June 24, 2021	SWN Production Company, LLC	18.00%	1165482	0.00%
39)	13-0014-0014-0000	Carol Woodard	Tollanery Holdings, LLC	18.00%	720373	0.00%
			NP&R, LLC		25449	
			Chesrow U.S.A. Inc		750312	
			EQT Atmos LLC		471	
			SWN Production Company, LLC		11256	
		Mary Rapson	Tollanery Holdings, LLC	18.75%	701482	
			NP&R, LLC		25449	
			Chesrow U.S.A. Inc		750312	
			EQT Atmos LLC		471	
			SWN Production Company, LLC		11256	
		Barry Rapson	Tollanery Holdings, LLC	18.00%	720378	
			NP&R, LLC		25449	
			Chesrow U.S.A. Inc		750312	
	EQT Atmos LLC		471			
	SWN Production Company, LLC		11256			
40)	13-0014-0014-0000	Yvonne Lucette & Don F. Walker, JTWRs	SWN Production Company, LLC	18.00%	1165281	0.00%
			SWN Production Company, LLC	18.00%	1165375	0.00%
41)	13-0014-0014-0000	Wayne L. Thomas	TH Exploration, LLC	18.00%	1151433	
42)	14-0005-0014-0000	Bonnie J. Masters, a widow, by her Attorney-in-Fact, Bruce M. Masters, II and Kimberly Renee Castorby	TH Exploration, LLC	18.00%	1166236	0.00%
			SWN Production Company, LLC		1166236	
			TH Exploration, LLC		1166474	
		Carl E. Knott, Jr., a married man dealing in his sole and separate property	SWN Production Company, LLC	18.00%	1166236	
			TH Exploration, LLC		1158972	
			SWN Production Company, LLC		1166236	
		Cathy A. Short, married, dealing in her separate property	American Petroleum Partners Operating, LLC	18.00%	932118	
			SWN Production Company, LLC		48263	
		Donna Knott Colfield, a widow	American Petroleum Partners Operating, LLC	18.00%	932188	
			SWN Production Company, LLC		48263	
		John B. Knott, a widower	American Petroleum Partners Operating, LLC	18.00%	933352	
			SWN Production Company, LLC		48263	
		Linda J. Knott, a single woman	American Petroleum Partners Operating, LLC	18.00%	93832	
	SWN Production Company, LLC		48263			
Lisa Ann Knott, a widow	American Petroleum Partners Operating, LLC	18.00%	939317			
	SWN Production Company, LLC		48263			
43)	14-0005-0014-0000	Richard Francis A's Richard Harold Francis, a widower (Lisa Jane Francis)	TH Exploration, LLC	18.00%	30728	0.00%
			Outpost Energy Corporation & Powell Creek Ohio, LLC		16188	
			American Petroleum Partners Operating, LLC		4059	
			Chesrow U.S.A. Inc		471	
			EQT Atmos LLC		11256	

RECEIVED
Office of Oil and Gas
OCT 12 2023
WV Department of
Environmental Protection

10/27/2023

4705102502

EXHIBIT "A"
David Robinson MBE 6001
Marshall County, West Virginia

Attached to and made a part of the State of West Virginia Oil and Gas Permit Form, WW-6A1, by SWN Production Company, LLC, Operator

#	TMP	LESSOR	LESSEE	ROYALTY	BCPG	% INTEREST NOT LEASED BY SWN PRODUCTION COMPANY, LLC
44)	14-0015-0016-0001	Daniel E. Tatum	SPAR, LLC Chevron U.S.A. Inc. Chesapeake Appalachia, L.L.C. SWN Production Company, LLC	11.75%	598141 750312 108512 13118	0.00%

* Highlighted Parcels impacted by drilling activity

END OF EXHIBIT "A"

RECEIVED
Office of Oil and Gas
OCT 12 2023
WV Department of
Environmental Protection

10/27/2023



4705102502

SWN Production Company, LLC
1500 Fort Pierpont Dr, Ste 201
Morgantown, WV 26508
Tel: 304 884 1610
Fax: 304 471 2497
www.swn.com

May 24, 2023

Mr. Charles Brewer
WV DEP Office of Oil & Gas
601 57th St., SE
Charleston, WV 25304

RE: SWN's proposed New Well: David Reinbeau MSH 606H in Marshall County, West Virginia, Drilling under Sorghum Ridge Road, Carrigan Drive, Hanlin Hill Road, Crows Lane, WV-88, and Cherokee Lane.

Dear Mr. Brewer:

SWN Production Company, LLC ("SWN") is applying for a drilling permit for the above referenced well. The State of West Virginia has raised some concern as to SWN's right to drill under Sorghum Ridge Road, Carrigan Drive, Sorghum Ridge Road, Carrigan Drive, Hanlin Hill Road, Crows Lane, WV-88, and Cherokee Lane. Please be advised that SWN has leased all mineral owners under said route as it relates to the above-referenced well and unit.

Thank you.

Sincerely,

Bailey Brougher
Staff Landman
SWN Production Company, LLC

RECEIVED
Office of Oil and Gas

OCT 12 2023

WV Department of
Environmental Protection

The Right People, doing the Right Things,
wisely investing the Right Money from our
underlying Assets, will create Value.SM

10/27/2023