

**JACKSON SURVEYING
INC.**
2413 EAST PIKE ST. # 112
Clarksburg, WV 26302
304-623-5851

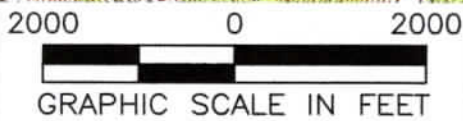
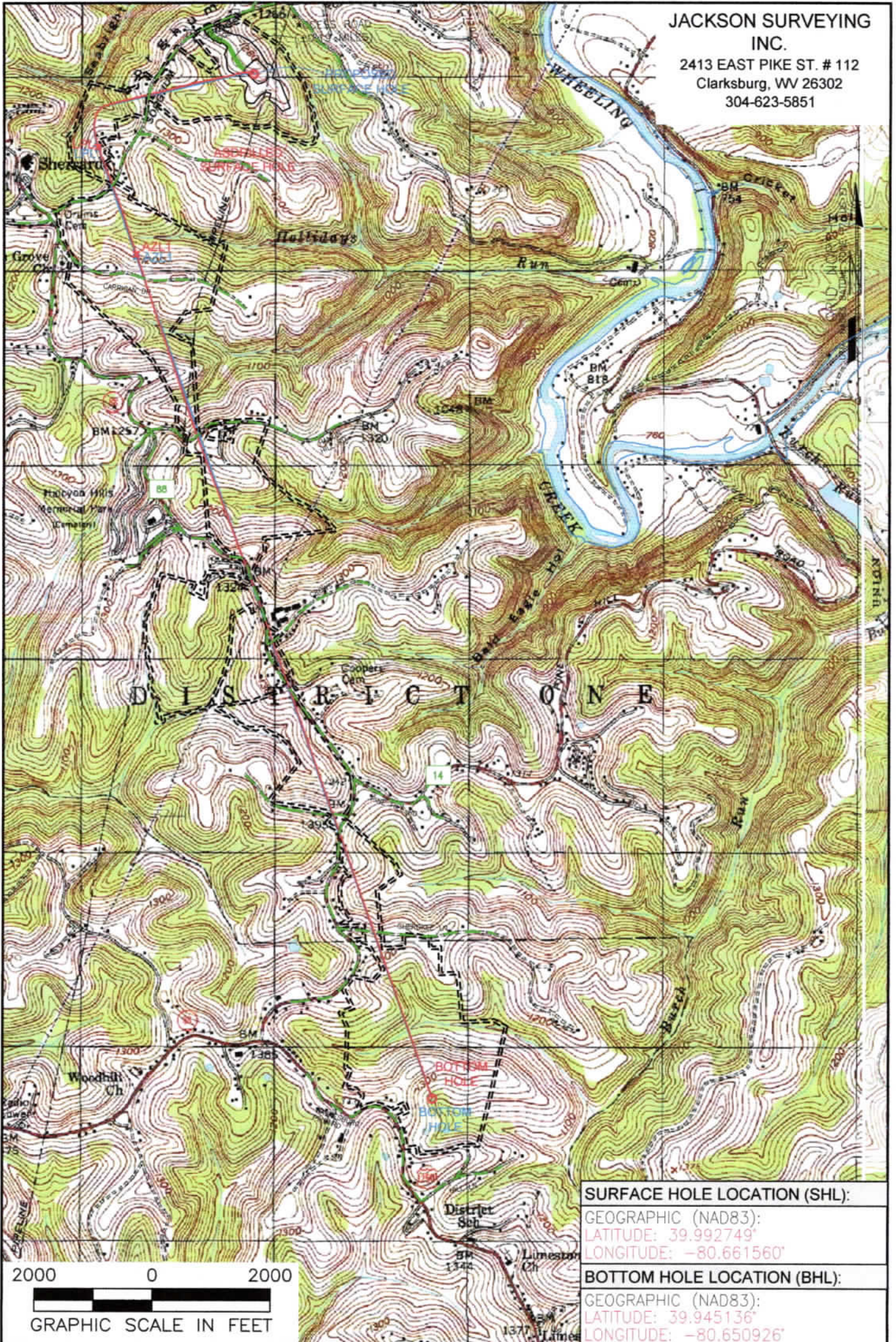

SURFACE HOLE LOCATION (SHL):

GEOGRAPHIC (NAD83):
LATITUDE: 39.992749°
LONGITUDE: -80.661560°

BOTTOM HOLE LOCATION (BHL):

GEOGRAPHIC (NAD83):
LATITUDE: 39.945136°
LONGITUDE: -80.650926°

NOTES ON SURVEY

1. SURFACE AND ROYALTY OWNER INFORMATION AND THEIR BOUNDARIES SHOWN HEREON WERE PLOTTED FROM DEEDS AND/OR TAX PARCEL MAPS PROVIDED BY CLIENT AND/OR FIELD LOCATIONS.
2. THIS PLAT DOES NOT REPRESENT A BOUNDARY SURVEY OF THE PARCELS SHOWN HEREON.
3. ALL INSETS ARE GRID NORTH UNLESS OTHERWISE DEPICTED.

LEGEND:

- PROPOSED SURFACE HOLE / BOTTOM HOLE
- ☼ EXISTING / PRODUCING WELLHEAD
- LPL* LANDING POINT LOCATION
- 🌊 FLOOD PLAIN
- 10/27/2023
- PUBLIC ROAD
- ACCESS ROAD TO PREV. SITE
- == LEASE BOUNDARY
- PROPOSED PATH
- ASDRILLED PATH

WELL OPERATOR: SWN PRODUCTION COMPANY, LLC	WELL (FARM) NAME: DAVID REINBEAU MSH	WELL # 606H
ADDRESS: 1300 FORT PIERPONT ROAD, SUITE 200 MORGANTOWN, WV 26508	COUNTY - CODE MARSHALL - 051	DISTRICT; UNION
SURFACE OWNER: SHELLY A. & DAVID W. REINBEAU	USGS 7 1/2 QUADRANGLE MAP NAME MOUNDSVILLE, WV	API #: 47-051-02502

Latitude: 40°00'00"

SURFACE HOLE 10,242'

Latitude: 39°57'30"

BOTTOM HOLE 7,268'

JACKSON SURVEYING INC.

2413 EAST PIKE ST. # 112
Clarksburg, WV 26302
304-623-5851

SURFACE HOLE LOCATION (SHL):
UTM (NAD83, ZONE 17, METERS): NORTHING: 4,427,007.356 EASTING: 528,892.356
LANDING POINT LOCATION (LPL):
UTM (NAD83, ZONE 17, METERS): NORTHING: 4,426,628.705 EASTING: 528,086.018
AZIMUTH POINT LOCATION (AZL1):
UTM (NAD83, ZONE 17, METERS): NORTHING: 4,426,066.049 EASTING: 528,285.181
BOTTOM HOLE LOCATION (BHL):
UTM (NAD83, ZONE 17, METERS): NORTHING: 4,421,728.136 EASTING: 529,820.230



SURFACE HOLE LOCATION (SHL):
UTM (NAD83, ZONE 17, METERS): NORTHING: 4,427,007.318 EASTING: 528,892.239
LANDING POINT LOCATION (LPL):
UTM (NAD83, ZONE 17, METERS): NORTHING: 4,426,634.720 EASTING: 528,087.303
AZIMUTH POINT LOCATION (AZL1):
UTM (NAD83, ZONE 17, METERS): NORTHING: 4,426,079.526 EASTING: 528,284.927
BOTTOM HOLE LOCATION (BHL):
UTM (NAD83, ZONE 17, METERS): NORTHING: 4,421,726.251 EASTING: 529,820.683

LINE	BEARING	DISTANCE	DESCRIPTION	MONUMENT
L1	N 17°10'37" W	1,063.88'	SHL TO LANDMARK	FD. FENCE CORNER
L2	N 57°48'31" W	1,267.17'	SHL TO LANDMARK	FD. FENCE CORNER
L4	S 19°35'36" E	1,933.45'	LPL TO AZL1	

LINE	BEARING	DISTANCE	CURVE LENGTH	DESCRIPTION
L3	S 65°09'40" W	2910.06'	3,387.81'	SHL TO LP

SURFACE HOLE 4,807'
 BOTTOM HOLE 2,641'
 Longitude: 80°37'30"
 Longitude: 80°37'30"

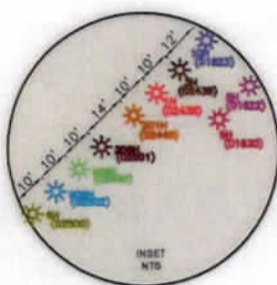
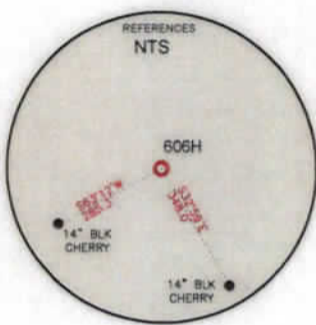
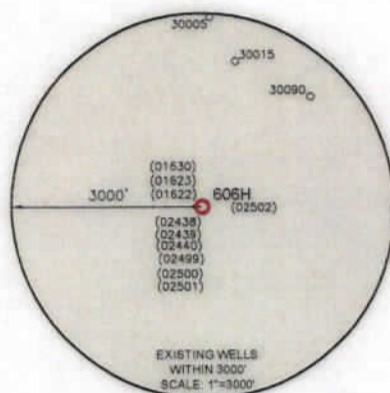

WELL RESTRICTIONS

- NO OCCUPIED DWELLINGS > 2500 SQ FT. WITHIN 625 FEET OF CENTER OF PAD.
- NO AGRICULTURE BUILDINGS > 2500 SQ FT. WITHIN 625 FEET OF CENTER OF PAD.
- NO WATER WELLS OR DEVELOPED SPRINGS ARE WITHIN 250 FEET OF PROPOSED WELL.
- NO PERENNIAL STREAMS, LAKES, PONDS, OR RESERVOIRS WITHIN 100 FEET OF THE LIMITS OF DISTURBANCE.
- NO NATURALLY PRODUCING TROUT STREAM WITHIN 300 FEET OF LIMITS OF DISTURBANCE.
- NO GROUND INTAKE OR PUBLIC WATER SUPPLY WITHIN 1000 FEET OF WELL PAD, LIMITS OF DISTURBANCE, E & S CONTROLS OR PUBLIC WATER SUPPLY.

NOTES ON SURVEY

- SURFACE AND ROYALTY OWNER INFORMATION AND THEIR BOUNDARIES SHOWN HEREON WERE PLOTTED FROM DEEDS AND/OR TAX PARCEL MAPS PROVIDED BY CLIENT AND/OR FIELD LOCATIONS.
- THIS PLAT DOES NOT REPRESENT A BOUNDARY SURVEY OF THE PARCELS SHOWN HEREON.
- ALL INSETS ARE GRID NORTH UNLESS OTHERWISE DEPICTED.

I, THE UNDERSIGNED, HEREBY CERTIFY THAT THIS PLAT IS CORRECT TO THE BEST OF MY KNOWLEDGE AND BELIEF AND SHOWS ALL THE INFORMATION REQUIRED BY LAW AND REGULATIONS ISSUED AND PRESCRIBED BY THE DEPARTMENT OF ENVIRONMENTAL PROTECTION.

P.S. 708

David L Jackson



COMPANY: **SWN** Production Company, LLC

(+) DENOTES LOCATION OF WELL ON UNITED STATES TOPOGRAPHIC MAPS WVDEP OFFICE OF OIL & GAS 601 57TH STREET CHARLESTON, WV 25034	MINIMUM DEGREE OF ACCURACY: 1/200 PROVEN SOURCE OF ELEVATION: SURVEY GRADE GPS (NAVD 88, US FT)	COMPANY: DAVID REINBEAU MSH OPERATOR'S WELL #: 606H API WELL #: 47 051 02502 STATE COUNTY PERMIT
---	--	---

WELL TYPE: OIL WASTE DISPOSAL PRODUCTION DEEP GAS LIQUID INJECTION STORAGE SHALLOW
 WATERSHED: HOLLIDAYS RUN OF WHEELING CREEK (HUC-10) ELEVATION: 1,251.2'
 DISTRICT: UNION COUNTY: MARSHALL QUADRANGLE: MOUNDSVILLE, WV
 SURFACE OWNER: SHELLY A. & DAVID W. REINBEAU ACREAGE: ±50.88
 OIL & GAS ROYALTY OWNER: SHELLY A. & DAVID W. REINBEAU ACREAGE: ±50.88
 DRILL DRILL DEEPER REDRILL FRACTURE OR STIMULATE PLUG OFF OLD FORMATION PERFORATE NEW FORMATION
 CONVERT PLUG & ABANDON CLEAN OUT & REPLUG OTHER CHANGE (SPECIFY) MODIFICATION
 TARGET FORMATION: MARCELLUS ESTIMATED DEPTH: 10/27/2023 TMD

WELL OPERATOR: SWN PRODUCTION COMPANY, LLC	DESIGNATED AGENT: BRITTANY WOODY
ADDRESS: 1300 FORT PIERPONT ROAD, SUITE 200	ADDRESS: 1300 FORT PIERPONT ROAD, SUITE 200
CITY: MORGANTOWN STATE: WV ZIP CODE: 26508	CITY: MORGANTOWN STATE: WV ZIP CODE: 26508

LEGEND: ○ PROPOSED SURFACE HOLE / BOTTOM HOLE * EXISTING / PRODUCING WELLHEAD LPL * LANDING POINT LOCATION (W) EXISTING WATER WELL (S) EXISTING SPRING	— SURVEYED BOUNDARY — DRILLING UNIT = LEASE BOUNDARY — ASDRILLED PATH — PROPOSED PATH	REVISIONS: DATE: 10-05-2023 DRAWN BY: N. MANO SCALE: 1" = 2000' DRAWING NO: WELL LOCATION PLAT
--	---	--

**JACKSON SURVEYING
INC.**

2413 EAST PIKE ST. # 112
Clarksburg, WV 26302
304-623-5851

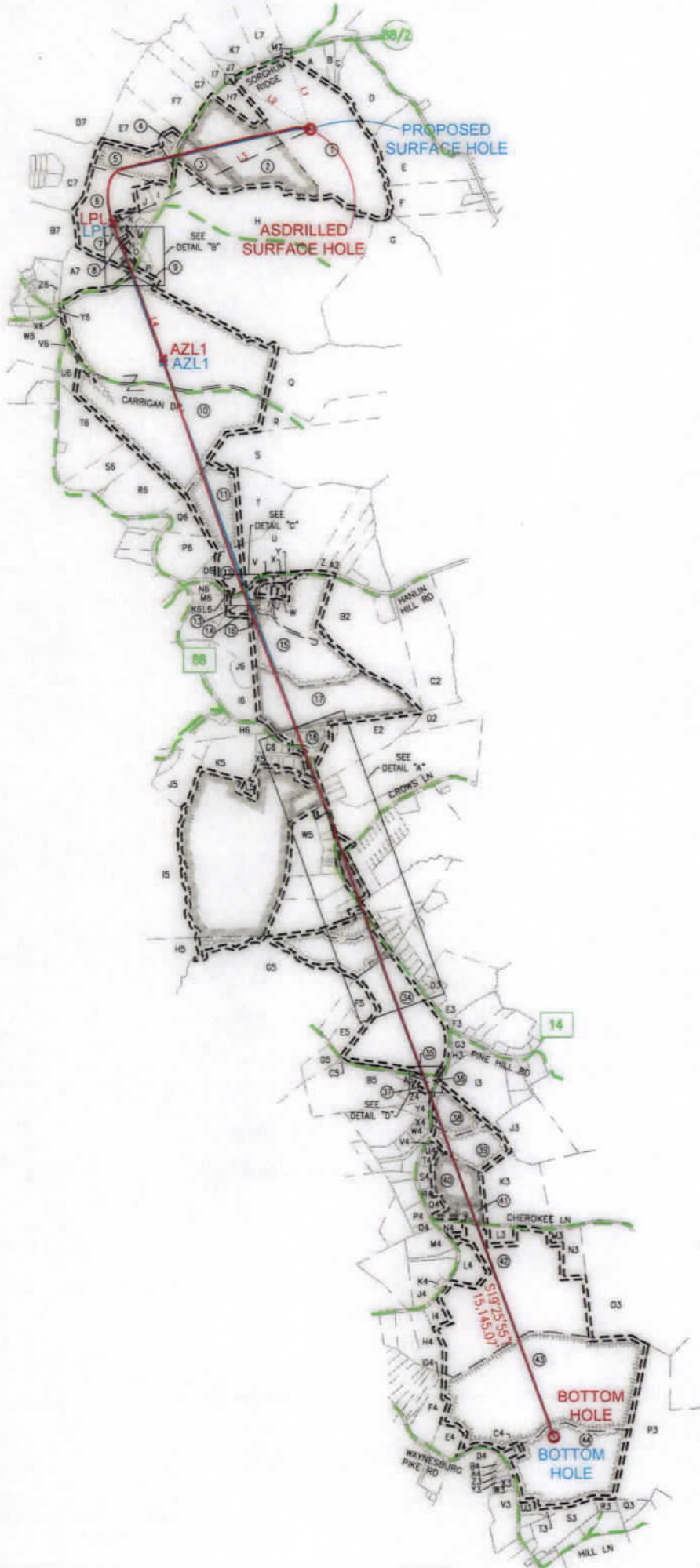

DETAIL "B"

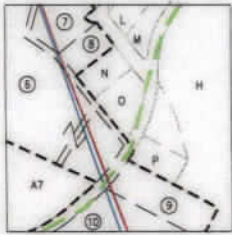

DETAIL "C"



DETAIL "D"

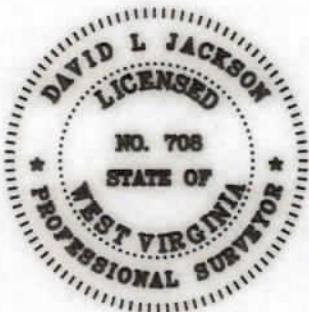

I, THE UNDERSIGNED, HEREBY CERTIFY THAT THIS PLAT IS CORRECT TO THE BEST OF MY KNOWLEDGE AND BELIEF AND SHOWS ALL THE INFORMATION REQUIRED BY LAW AND REGULATIONS ISSUED AND PRESCRIBED BY THE DEPARTMENT OF ENVIRONMENTAL PROTECTION.

P.S. 708

David L Jackson

2000 0 2000



GRAPHIC SCALE IN FEET

10/27/2023

REVISIONS:	COMPANY:		
	OPERATOR'S	DAVID REINBEAU MSH	API #: 47-051-02502
	WELL #:	606H	DATE: 10-05-2023
	DISTRICT:	COUNTY:	DRAWN BY: N. MANO
	UNION	MARSHALL	SCALE: N/A
		STATE:	DRAWING NO:
		WV	WELL LOCATION PLAT 2

**JACKSON SURVEYING
INC.**

2413 EAST PIKE ST. # 112
Clarksburg, WV 26302
304-623-5851

WELL BORE TRACTS		
TRACT	SURFACE OWNER (S) / ROYALTY OWNER (R)	TAX PARCEL
1	REINBEAU SHELLY A & DAVID W (S/R)	13-8-29
TRACT	SURFACE OWNER (S)	
2	REINBEAU SHELLY A & DAVID W (S)	13-8-27
3	REINBEAU RONALD W & FRIEDA A - LIFE (S)	13-07-22.2
4	SHEPHERD JAMES LEE II (S)	13-07-23
5	MCCLINTOCK JOSIE & LARRY (S)	13-07-22.4
6	PATTERSON DANIEL & MICHELLE (S)	13-07-22
7	SBERNA JOHN L (S)	13-7E-04
8	SBERNA SANDRA (S)	13-7E-03
9	MCLAUGHLIN SHAWN & ELIZABETH (S)	13-08-23
10	HIERONIMUS C KEITH ET UX (S)	13-08-15
11	CARTER KELLY J (S)	13-10-19
12	WISE CLARA L (S)	13-10-18
13	LOY JEFFREY A & JULIE M (S)	13-10-31
14	MERINAR KENNETH LEE & LEEANN (S)	13-10B-08
15	MERINAR KENNETH LEE ET UX (S)	13-10-21.6
16	SPIELVOGEL HARRY C ET UX (S)	13-10B-10
17	METS PROPERTIES LLC (S)	13-10-22
18	STURGILL JULIE L & JOE D (S)	13-10-24
19	GELLNAR GARY (S)	13-13A-04
20	GELLNER GARY (S)	13-13A-03
21	HENDERSON SHERYL LYNN (S)	13-13A-02
22	SIBURT ERIC R & CARLA M (S)	13-13A-01
23	SCHABER LESLIE B & LORI D (S)	13-13-10
24	HARVEY JOSHUA STEVEN (S)	13-13-11.1
25	AVILA EDWARD A (S)	13-13-11.4
26	PENNINGTON KAREN LYNN (S)	13-09-32.5
27	HACKATHORN JUDITH ANN - LIFE (S)	13-09-31.2
28	COOPER TIM L (S)	13-09-31.3
29	TH EXPLORATION LLC (S)	13-13-13.1
30	ANDERSON MICHAEL L (S)	13-13-14
31	BROWN ROSEMARY M (S)	13-13-15
32	GODDARD RUSSELL E & MICHELE L (S)	13-13-16
33	GODDARD RUSSELL E & MICHELE L (S)	13-13-17.1
34	LILLEY PAUL THOMAS (S)	13-13-17
35	CUNNINGHAM TOYA A - TOD (S)	13-14-48.1
36	GRAY DARYL J (S)	13-14-49
37	SCOTT RANDALL C ET UX (S)	13-14-48
38	OLDFIELD KAREN KAY (S)	13-14-33
39	GUNTO CARL M ET UX (S)	13-14-34
40	WALTER DANA F & VINCENT LORETTO (S)	13-14-38
41	THOMAS WAYNE L - THOMAS MARILYN (S)	13-14-39
42	KOONTZ CARL JR ET AL (S)	14-05-24
43	FRANCIS LISA JANE (S)	14-05-37
44	TATICH DANIEL EDWARD TRUST (S)	14-05-36

ADJOINING OWNERS TABLE		
TRACT	SURFACE OWNER	TAX PARCEL
A	NARRISH KEVIN	13-08-30
B	SOUTH CHRISTOPHER C	13-08-31
C	KOSTELECKY JOSEPH J JR & CAROLYN - TOD	13-08-31.1
D	FUNK CHARLES D ET UX	13-08-32
E	LOY EUGENE EST ET AL	13-08-01
F	LIBERTY JOHN ET UX	13-08-10
G	MCCOMBS JOHN A SR, THOMAS E & BETH	13-08-11
H	MCCOMBS JOHN A SR, THOMAS E & BETH	13-08-26
I	CAIN ROGER L II	13-7E-10
J	MALARSKI CHAD	13-7E-09
K	SANDRETH ELIZABETH A	13-7E-05
L	MILLER RALPH D ET UX	13-7E-06
M	CRAWFORD GARY J	13-7E-07
N	SBERNA JOSEPH L JR & TAMMY L	13-7E-02
O	SBERNA JOSEPH L JR & TAMMY	13-7E-01
P	PERRY JOSEPH P JR	13-08-24
Q	CONNER AMBER D & DAVID HANES JR	13-08-14
R	CONNER AMBER D & DAVID HANES JR	13-08-13
S	CONNER AMBER D & DAVID HANES JR	13-08-12
T	CARTER KELLY J	13-10-20
U	MELNIK BRUCE A ET UX	13-10-21
V	GAST COREY M & JOLIE A	13-10-21.10
W	BOWERS MARY L	13-10B-37
X	SHAW SIDNEY S & ROBIN MARIE	13-10B-02
Y	SHAW SIDNEY S & ROBIN MARIE	13-10B-01
Z	MELNIK BRUCE A ET UX	13-10-21.1
AZ	MONTGOMERY TORIE	13-10-21.2
BZ	JONES NICHOLAS & EVELINE J	13-10-21.8

*Highlighted Parcels impacted by drilling activity.

DETAIL "A"



I, THE UNDERSIGNED, HEREBY CERTIFY THAT THIS PLAT IS CORRECT TO THE BEST OF MY KNOWLEDGE AND BELIEF AND SHOWS ALL THE INFORMATION REQUIRED BY LAW AND REGULATIONS ISSUED AND PRESCRIBED BY THE DEPARTMENT OF ENVIRONMENTAL PROTECTION.

P.S. 708

David L Jackson

10/27/2023

REVISIONS:	COMPANY:		
	OPERATOR'S	DAVID REINBEAU MSH	API #: 47-051-02502
	WELL #:	606H	DATE: 10-05-2023
	DISTRICT:	UNION	COUNTY: MARSHALL
		STATE: WV	DRAWN BY: N. MANO
			SCALE: N/A
			DRAWING NO: WELL LOCATION PLAT 3

**JACKSON SURVEYING
INC.**

2413 EAST PIKE ST. # 112
Clarksburg, WV 26302
304-623-5851

ADJOINING OWNERS TABLE		
TRACT	SURFACE OWNER	TAX PARCEL
C2	JONES NICHOLAS & EVELINE J	13-09-08
D2	EDISON MARK C ET UX	13-09-09
E2	METS PROPERTIES LLC	13-10-23
F2	METS PROPERTIES LLC	13-10-24.1
G2	MILLER KENNETH LEE - TOD	13-09-33
H2	CHAMBERS ROBIN L & DENICE E	13-09-33.1
I2	CHAMBERS ROBIN L & DENICE E	13-09-33.2
J2	EAGLE LTD	13-09-32.1
K2	VEMURI HOME & GARDEN LLC	13-09-34
L2	FRYE JACQUELINE L & CHARLES G	13-09-31.1
M2	PARSONS JAY D ET UX	13-14-01
N2	CAMPBELL CODIE JOHNELLE	13-14-02
O2	FREEMAN RAYMOND CHRISTOPHER	13-14-03
P2	TROWBRIDGE ROBEYN & JOSHUA SKIDGEL	13-14-05
Q2	TROWBRIDGE ROBEYN & JOSHUA SKIDGEL	13-14-6.1
R2	CLOVIS JUSTIN	13-14-6.3
S2	KENDZIERSKI ALAN B ET UX	13-14-6.4
T2	GIVENS BRUCE E ET UX	13-14-06
U2	GIVENS BRUCE E ET UX	13-14-7.2
V2	CHAMBERS DOROTHY-LIFE	13-14-07
W2	COTTRELL COLE T	13-14-7.5
X2	DORAN BRIAN W ET UX	13-14-7.4
Y2	LEWEY CHARLES L & MARGARET A	13-14-7.1
Z2	BECKNER DAVID E & DEBORAH K	13-14-7.3
A3	GANTZER MARCIA L & JAMES E	13-14-8.2
B3	GANTZER MARCIA L & JAMES E	13-14-8.1
C3	YOHO RONNIE E	13-14-8.3
D3	YOHO GAIL L & RONNIE E	13-14-8.4
E3	ROVER PIPELINE LLC	13-14-08
F3	ROVER PIPELINE LLC	13-14-09
G3	DRAKE JASON T & DEANNA J	13-14-31.1
H3	LYONS BRENT G ET UX	13-14-31
I3	HENRY GH & JANET FAMILY TRUST	13-14-32
J3	HENRY GH & JANET FAMILY TRUST	13-14-29
K3	FOSTER CHARLES S & BRENDA	13-14-38.2
L3	EBERT BRADLEY	14-05-24.9
M3	WILSON ROBERT J & REBECCA S	14-05-24.6
N3	FOSTER CAITLIN E	13-14-50
O3	SMITH EDWARD LEE II	14-05-26
P3	HILL KAY F ET AL	14-05-28
Q3	HILL KAY F ET AL	14-05-29
R3	LILLEY ROGER W ET UX	14-05-32.5
S3	YOHO KIM MARLENE	14-05-33
T3	WHIPKEY ROGER ET UX	14-05-35
U3	SIMONS JORDAN M & VICTORIA G BENLINE SIMONS	14-05-36.1
V3	DERROW SAMUEL R ET UX	14-05-39
W3	KELLEY RODNEY & BONNIE	14-05-38.1
X3	KELLEY RODNEY & BONNIE	14-05-38
Y3	KELLEY RODNEY & BONNIE	14-05-38.2
Z3	KELLEY RODNEY & BONNIE	14-05-38.3
A4	WALTER DANA F	14-05-38.4
B4	WALTER DANA F	14-05-38.5
C4	FRANCIS LISA JANE	14-05-36.2
D4	BISHOP PENNY S ET VIR	14-05-39.1
E4	FRANCIS LISA JANE	14-05-37.1
F4	GALLOWAY HARRY L	14-05-11
G4	J & R DEVELOPMENT LLC	14-05-11.3
H4	SMITH MARK ALLEN ET UX	14-05-23
I4	KOONTZ COLE	14-05-24.8
J4	WILLIAMS CARL R & RHONDA L	14-05-24.5
K4	WILLIAMS CARL R & RHONDA L	14-05-24.4
L4	KOONTZ JOHN R	14-05-24.3
M4	WOODS JOHN E SR & FRANCES J	14-05-24.2
N4	KOONTZ CARL E JR	14-05-24.1
O4	SNYDER DAVID L - LIFE	13-14-40
P4	SNYDER DAVID L - LIFE	13-14-44
Q4	HEWITT MARTIN O ET UX	13-14-38.3
R4	SMITH CAROLYN - TOD	13-14-38.4
S4	GUMP CHRISTINA H	13-14-37
T4	WEST THOMAS J JR & KATHY ANN	13-14-36

ADJOINING OWNERS TABLE		
TRACT	SURFACE OWNER	TAX PARCEL
U4	WEST THOMAS J JR & KATHY ANN	13-14-35
V4	WEST THOMAS J JR & KATHY ANN	13-14-34.1
W4	POLANSKI LYNDSEY N	13-14-41.2
X4	FERDA BRIAN T	13-14-46.2
Y4	BOWIE CHRISTOPHER E	13-14-46.1
Z4	CUNNINGHAM CHAD	13-14-47
A5	KOONTZ HELEN - TOD	13-14-48.2
B5	CUNNINGHAM CHAD L & JEFFREY H	13-14-47.1
C5	CUNNINGHAM JEFFREY H & CHAD	13-13-20
D5	CUNNINGHAM JEFFREY H & CHAD	13-13-19
E5	HELLER AMBER R & EDGAR D JR	13-13-18.1
F5	HELLER AMBER R & EDGAR D JR	13-13-18
G5	HELLER EDGAR D JR TRUST	13-13-21
H5	HELLER EDGAR D JR TRUST	13-13-23
I5	HELLER EDGAR D JR TRUST	13-13-09
J5	KOCH JOHN E & BARBARA A - TOD	13-13-9.3
K5	SCHABER LESLIE B & LORI D	13-13-10.1
L5	SCHABER LESLIE B & LORI D	13-13-10.2
M5	TH EXPLORATION, LLC	13-13-13.3
N5	NORRIS TABITHA L	13-13-13.2
O5	GROSS COBER R ET UX	13-13-13
P5	SHANNON WILLIAM JAMES	13-13-12
Q5	BURTON ERIC & LEE ANN	13-13-11.7
R5	SCARNECHIA DAVID W	13-13-11.6
S5	SCARNECHIA DAVID W	13-13-11
T5	SCARNECHIA DAVID W	13-13-11.5
U5	HAIGHT DONNA JEAN	13-13-11.8
V5	HAIGHT DONNA JEAN	13-13-11.2
W5	SHANNON WILLIAM JAMES	13-13-11.3
X5	BACH WILBERT H II ET UX	13-13A-10
Y5	BACH WILBERT H II ET UX	13-13A-11
Z5	SCHABER LESLIE B & LORI D	13-13A-12
A6	SCHABER LESLIE B & LORI D	13-13A-13.1
B6	KNOBLICH RICHARD KARL ET UX	13-13A-13
C6	WARD ROBERT C JR & VICKY LINN	13-13A-15
D6	SCHABER LESLIE & LORI	13-13-10.3
E6	CARR PHYLLIS J	13-13A-06
F6	HESS GEORGE JR ET UX	13-13A-07
G6	WHIPKEY ROBERT	13-13A-08
H6	MARSH DAVID A ET UX	13-10-28
I6	THORN RONNIE L & BETH A	13-10-30.1
J6	ELLIOTT GLENN F	13-10-30
K6	ELLIOTT GLENN F	13-10-33
L6	MANUFACTURING LIGHT & HEAT CO	13-10-18.2
M6	RUSH J LARRY & LINDA M	13-10-32.1
N6	RUSH JOSEPH L & LINDA M	13-10-32
O6	MOSA BLAIR P ET UX	13-10-18.1
P6	TARGOSKY ROSEMARY & MCCOY-GOOGEL BARAK	13-10-16
Q6	CARTER KELLY J	13-10-15.1
R6	WALTON DANIEL JR & THERESA	13-08-17
S6	WALTON DANIEL JR & THERESA	13-08-18
T6	MCCOMBS THOMAS E & BETH E -TOD	13-08-19
U6	PRESBYTERIAN CHURCH	13-08-20
V6	ALLEN GROVE PRESBYTERIAN CHURCH	13-08-15.1
W6	KAHLBAUGH DAVID W & DELORES- TOD	13-07-24
X6	HIERONIMUS C KEITH ET UX	13-7A-23
Y6	SHARRARD CEMETERY	13-7A-22
Z6	JOHNSON GILBERT	13-7A-03
A7	MCCOMBS THOMAS E & BETH E - TOD	13-08-16
B7	CMK REALTY LLC	13-7A-09
C7	BOARD OF EDUCATION	13-07-16
D7	BOARD OF EDUCATION	13-07-17
E7	MCCOMBS JOHN A SR & MARILYN S	13-07-22.1
F7	REINBEAU DAVID W & SHELLY A	13-07-22.3
G7	REINBEAU DAVID W & SHELLY A	13-07-21.1
H7	BOWMAN MICHAEL ET UX	13-08-28
I7	BOWMAN MICHAEL J & CONSTANCE G	13-07-21
J7	ALEXANDER LORRAINE	13-07-20
K7	ALEXANDER LORRAINE	13-07-18.1
L7	ALEXANDER LORRAINE	13-07-18
M7	SAMPSON EDITH VIRGINIA EST	13-07-19

10/27/2023

REVISIONS:	COMPANY:	 		
	OPERATOR'S	DAVID REINBEAU MSH	API #:	DATE: 10-05-2023
	WELL #:	606H	47-051-02502	DRAWN BY: N. MANO
	DISTRICT:	UNION	COUNTY:	SCALE: N/A
			STATE:	DRAWING NO:
			WV	WELL LOCATION PLAT 4