

Latitude

Longitude

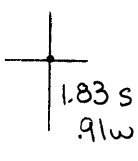

Topo Location

7.5' Loc. \_\_\_\_\_ 15' Loc. \_\_\_\_\_  
 \_\_\_\_\_ (calc.) \_\_\_\_\_

Company Manufact Lt & Ht  
 Farm Lucinda Bunge #3008  
 15' Quad \_\_\_\_\_  
 (sec.)  
 7.5' Quad Glen Easton  
 District Liberty

WELL LOCATION PLAT

County 051 Permit 30006

Liberty dist.

Plugging Affidavit

April 20, 1931

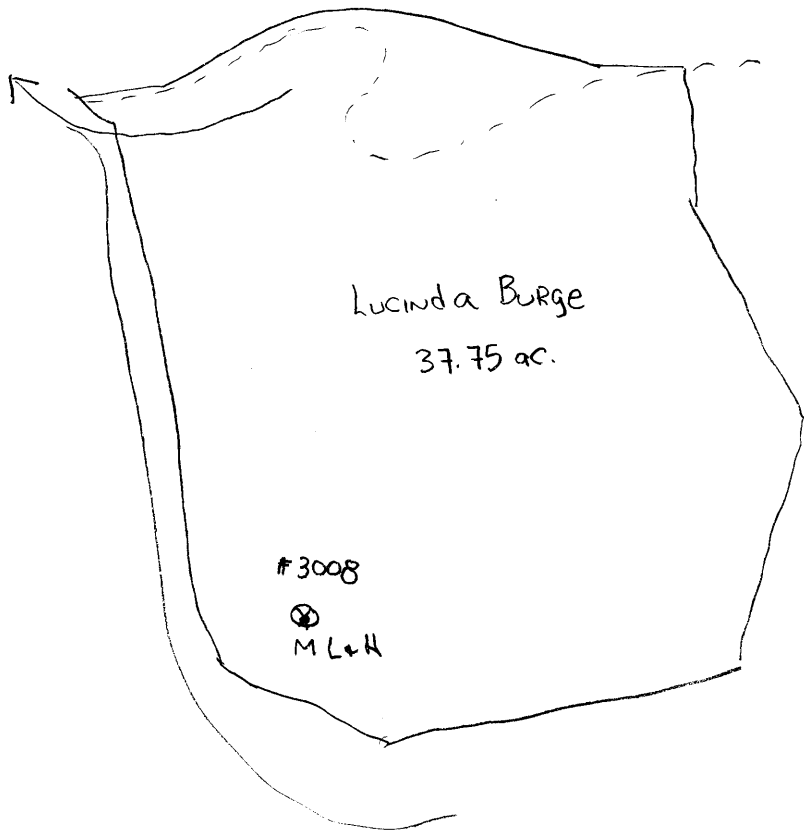

Marsh 6A

Liberty District, Marshall County, W. Va.  
 Manufacturers Light & Heat Co., 800 Union Tr. Bldg., Pittsburgh, Pa.  
 On 37.75 acres, surface owned by Lucinda Burge, Adaline, W. Va.,  
 and mineral rights by ML&H Co., Pittsburgh, Pa.

Drilled prior to July 1, 1929.

Elevation, 855'.

14" conductor; 5-5/8" casing, 1768'; 5-3/16", 1975'.

Coal was encountered at 355-359, 561-565, 661-667, and 1289-1294'.

Abandonment reported to Dept. of Mines Feb. 26, 1931.

	Top.	Bottom.
Sand (hole full water)	295	- 355
Waynesburg Coal	355	- 359
Mapletown Coal	561	- 565
Pittsburgh Coal (2 barrels water)	661	- 667
Murphy Sand	765	- 800
Big Dankard Sand	1180	- 1240
Coal	1289	- 1294
Gas Sand	1360	- 1380
Salt Sand	1425	- 1475
2nd Salt Sand	1534	- 1640
Sand (hole full water)	1558	- 1572
Marion Sand	1640	- 1680
Big Lime	1754	- 1808
Big Injun Sand (gas, 1824-1828')	1808	- 2055
50-Ft. Sand	2610	- 2627
Gordon Stray Sand	2657	- 2675
Gordon Sand	2678	- 2683
4th Sand	2724	- 2730
5th Sand (gas, 2761')	2760	- 2763
Total depth		2764

MARS-6-A