

Plugging Affidavit

Aug. 16, 1932

Washington dist

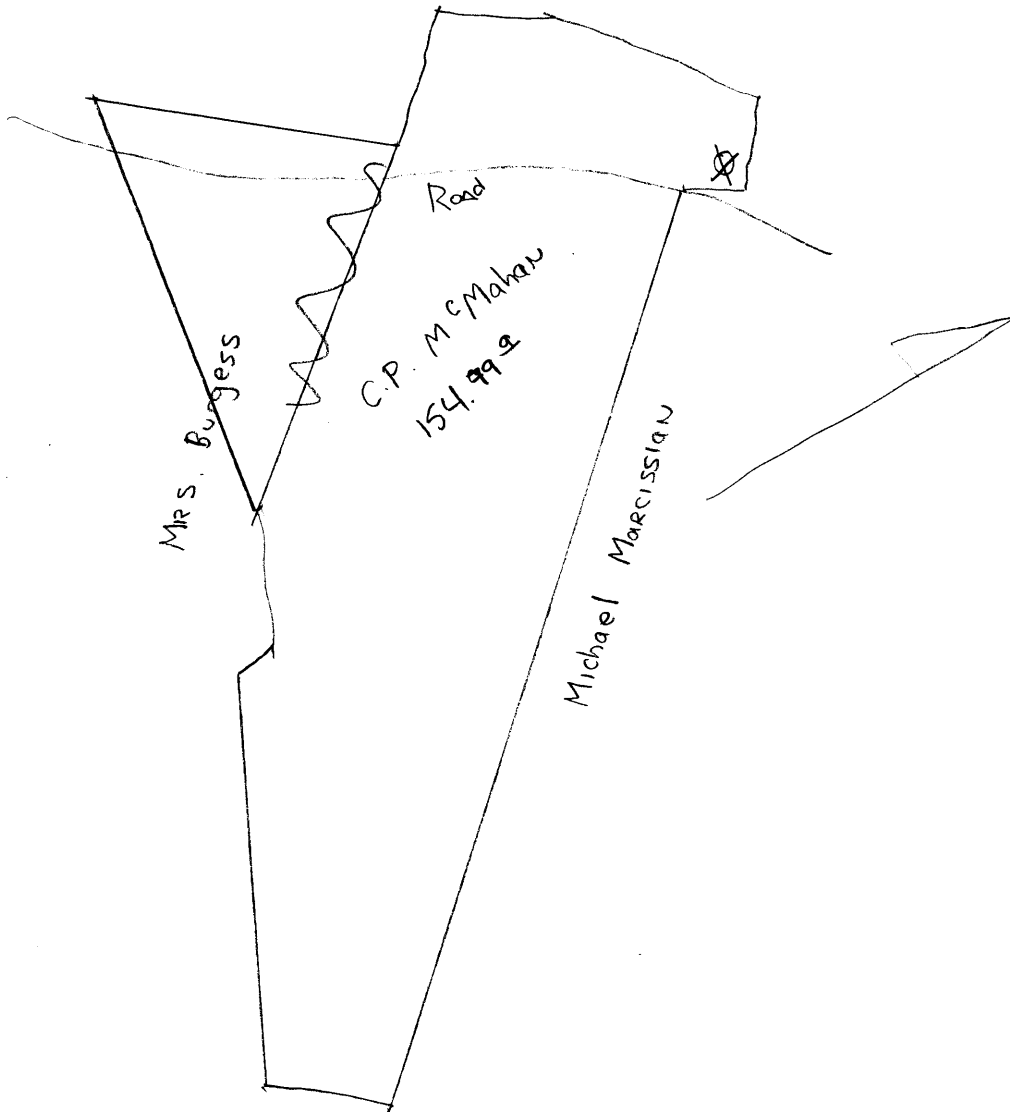

Washington District, Marshall County, W. Va.

Thomas F. Harlett, 74 Sixth St., Metchum, N. Va.

On 154.79 acres, surface owned by C. P. McMahon, Glendale, W. Va.,
and mineral rights by Glendale Gas Coal Co., Glendale, W. Va.

This well was drilled in 1926. Has since gone dry and lease has
been surrendered to landowner.

Elevation, 655'.

13" casing, 47'; 8", 190'; 6", 730'; 5", 1240'.

Coal was encountered at 90-94, 175-181'.

No liners used.

Abandonment reported to Dept. of Mines June 27, 1931.

Light gasser; was drilled in 1926; has since quite producing.

Fresh water at 30'; salt water at 1075'.

Well was not shot.

MARS-9-A

	Top.	Bottom.
Swickley, Mapletown Coal, black, soft fuel	90	94
Pittsburgh Coal, black, soft fuel (mined out and abandoned)	175	181
Salt Sand, grayish, sandy, reasonably hard (water, 1075')	1075	1105
Maxton, Dawson Sand, grayish, hard, porous, (water)	1175	1190
Keener Sand, grayish, hard, sandy (dry)	1246	1261
Big Injun Sand, grayish, sandy, hard, (gas; small quantity)	1281	1301
Total depth		1301