

Meade Dist

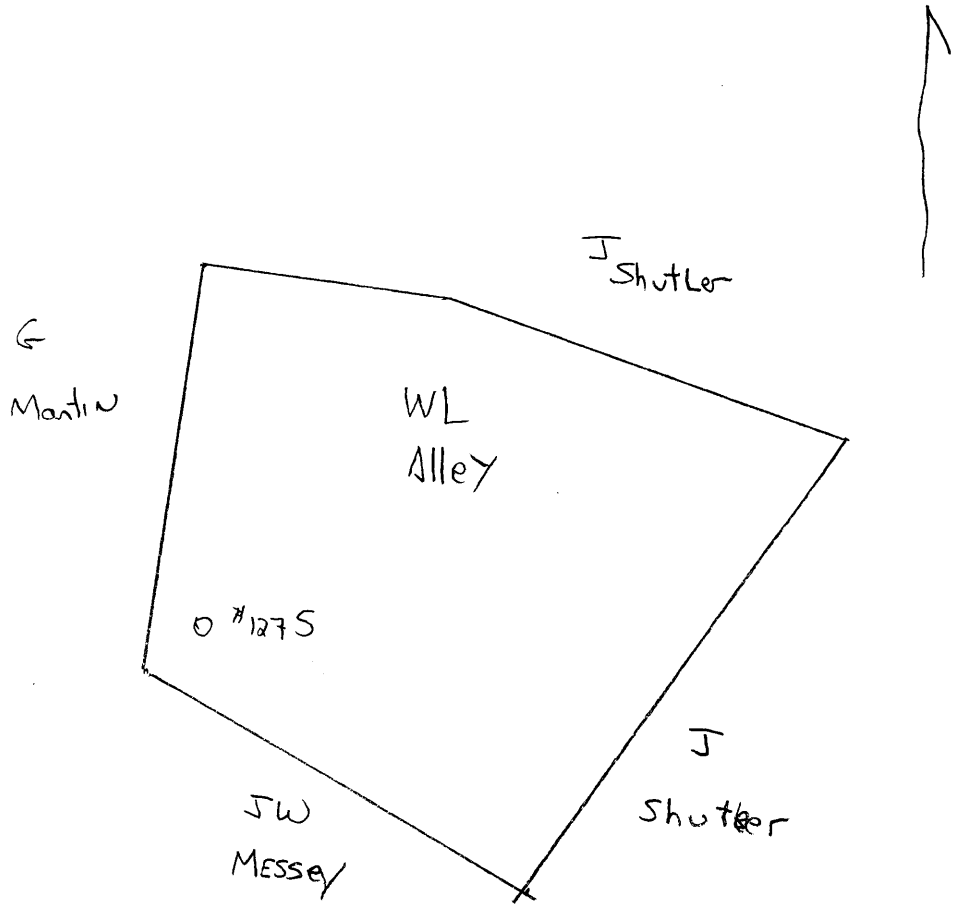

30056

JOHN SHUTLER (FORMERLY W. L. ALLEN) NO. 1 (1275) WELL.
No. 125 O.F.-Marshall

Meade District, Marshall County, W. Va.
Manufacturers Light & Heat Co., 800 Union Tr. Bldg., Pittsburgh, Pa.
On 55 acres, surface owned by John Shutler, RD 1, Proctor, W. Va.,
and mineral rights by ML&H Co., Pittsburgh, Pa.

Drilled prior to June 1, 1929.

No elevation given.

10" casing, 1210'; 8 1/2", 1436'; 6-5/8", 2225'; 3" tubing, 2895'.

Coal was encountered at 801 and 896'.

Abandonment reported to Dept. of Mines August 17, 1935.

This is the only record available for this well.

MARS-56-A

	Top.	Bottom.
Mapletown Coal	801	
Pittsburgh Coal	896	
Dunkard Sand	1436	
Salt Sand	1575	
Maxton Sand	1875	
Big Linn	1966	
Big Injun Sand	2030	
Red rock	2735	
Stray Sand	2830	
Gordon (and gas) Sand	2882	
Total depth		2895