

LATITUDE 39° 45'

LONGITUDE 80° 42' 30"

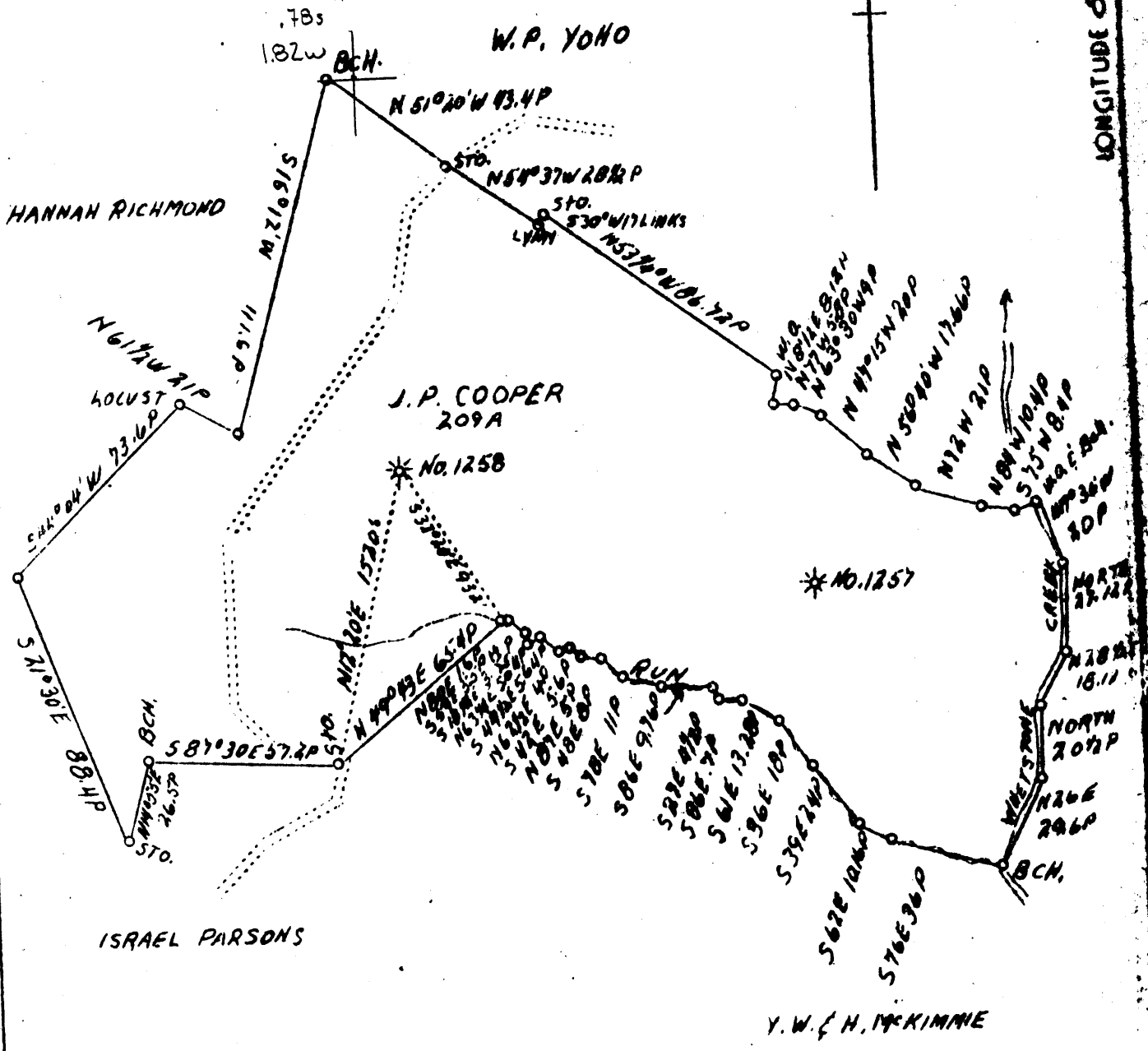

Well 1258 To be Plugged  
Coal Has Not Been Sold

0.86 S  
4.03 W

Company	The Manufacturers Light & Heat
Address	800 Union Trust Bldg., Pittsburgh, Pa.
Farm	J. P. Cooper
Tract	1
Acres	209
Lease No.	2851
Well (Farm) No.	Two
Serial No.	1258
Elevation (SL)	1340
Quadrangle	Littleton N. W.
County	Marshall, Franklin Dist.
Engineer	A. J. Russel
Eng. Reg. No.	-
Drawing No.	Y-8-211
Date	2/28/39 - Scale 1" = 800'

STATE OF WEST VIRGINIA  
Department of Mines  
OIL & GAS DIVISION  
Charleston

WELL LOCATION MAP

File No. MAY-93-PA

x Denotes location of well on U. S. Topographic Maps, scale 1 to 62,500, latitude and longitude lines being represented by border lines as shown.

- Denotes one inch spaces on border line of original tracing.

WEST VIRGINIA DEPARTMENT OF MINES  
OIL AND GAS DIVISION

WELL RECORD

155

Permit No. MAR 5-93-A

Oil or Gas Well Gas  
(Kind)

Company <b>The Manufacturers Light &amp; Heat Co.,</b>	Casing and Tubing	Used in Drilling	Left in Well	Packers
Address <b>800 Union Trust Bldg., Pittsburgh, Pa.</b>	Size			
Farm <b>Nicholas Cooper</b> Acres <b>209</b>	16			Kind of Packer
Location (waters)	13			
Well No. <b>2 - 1258</b> Elev. <b>1310'</b>	10	<b>1205</b>		Size of <b>3x6 1/2x16</b>
District <b>Franklin</b> County <b>Marshall</b>	8 1/4	<b>1685</b>		Depth set <b>2682</b>
The surface of tract is owned in fee by <b>W. N. Cooper</b>	6 5/8	<b>1745</b>	<b>1745</b>	Perf. top
<b>R D 1</b> Address <b>Proctor, WVa.</b>	5 3/16		<b>2912</b>	Perf. bottom
Mineral rights are owned by <b>The Mfrs. Light &amp; Heat Co.</b>	3			Perf. top
<b>800 Union Trust Bldg.</b> Address <b>Pittsburgh, Pa.</b>	2			Perf. bottom
Drilling commenced <b>June 28, 1904</b>	Liners Used			
Drilling completed <b>Aug. 24, 1904</b>				
Date shot				
Open Flow /10ths Water in				
/10ths Merc. in				
Volume				
Rock Pressure				
Oil				
Fresh water				
Salt water				

CASING CEMENTED SIZE No. FT. Date  
 COAL WAS ENCOUNTERED AT **835** FEET **60** INCHES  
**925** FEET **72** INCHES FEET INCHES  
 FEET INCHES FEET INCHES

Formation	Color	Hard or Soft	Top	Bottom	Oil Gas or Water	Depth Found	Remarks
Mapletown Coal			835	840			
Pittsburgh Coal			925	931			
Little Dunkard Sand			1325	1345			
Big Dunkard Sand			1400	1415			
Big Lime			1990	2050			
Big Injun			2050	2320			
Berea Grit			2660	2675			
Gordon Sand			2925	2942	Gas		
Completed at				2974			

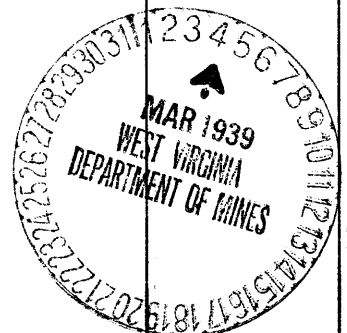

Formation	Color	Hard or Soft	Top	Bottom	Oil, Gas or Water	Depth Found	Remarks

Date..... **March 3rd,** ..... 19**39**

APPROVED **THE MANUFACTURERS LIGHT & HEAT CO.** Owner

By *Harry H. Fowler*  
Land Dept. (Title) Office Manager