

2.85
3.13
2.75
3.00

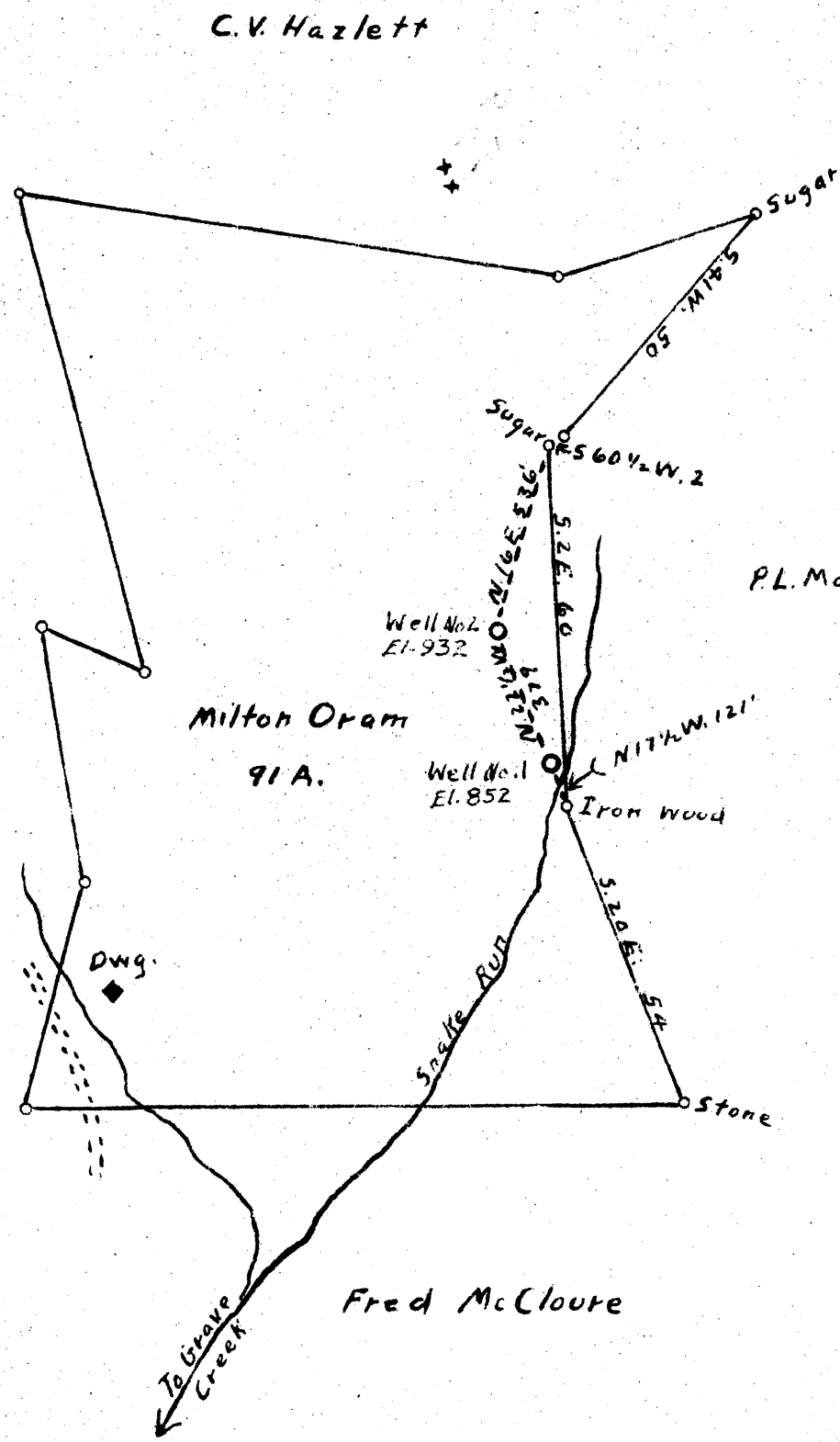

New Location
 Drill Deeper
 Abandonment

Company W.M. Moses
 Address Salem, W.Va.
 Farm Milton Oram
 Tract _____ Acres 91 Lease No. _____
 Well (Farm) No. 1-2 Serial No. _____
 Elevation (Spirit Level) No. 1-852; No. 2-932
 Quadrangle Cameron
 County Marshall District Union
 Engineer A.K. Westfall
 Engineer's Registration No. _____
 File No. _____ Drawing No. _____
 Date July 21, 1945 Scale 1" = 30 Poles

STATE OF WEST VIRGINIA
 DEPARTMENT OF MINES
 OIL AND GAS DIVISION
 CHARLESTON

WELL LOCATION MAP
 FILE NO. MARS-234-A-No. 2
MARS-235-A-No. 1

+ Denotes location of well on United States Topographic Maps, scale 1 to 62,500, latitude and longitude lines being represented by border lines as shown.
 - Denotes one inch spaces on border line of original tracing



276

STATE OF WEST VIRGINIA
DEPARTMENT OF MINES
OIL AND GAS DIVISION

WELL RECORD

Permit No. 735-A

Oil or Gas Well _____
(KIND)

Company George W. Moses
 Address Salem, W. Va.
 Farm Milton Oram Acres 91
 Location (waters) _____
 Well No. One Elev. 1193
 District Union County Marshall
 The surface of tract is owned in fee by _____
Geo. Moses Address _____
 Mineral rights are owned by _____
 Address _____
 Drilling commenced _____
 Drilling completed _____
 Date Shot _____ From _____ To _____
 With _____
 Open Flow _____ /10ths Water in _____ Inch
 _____ /10ths Merc. in _____ Inch
 Volume _____ Cu. Ft.
 Rock Pressure _____ lbs. _____ hrs.
 Oil _____ bbls., 1st 24 hrs.
 Fresh water _____ feet _____ feet
 Salt water _____ feet _____ feet

Casing and Tubing	Used in Drilling	Left in Well	Packers
Size			
16			Kind of Packer
13			
10			Size of
8 1/4			
6 5/8		1410	Depth set
5 3/16		1420	
3			Perf. top
2			Perf. bottom
Liners Used			Perf. top
			Perf. bottom

CASING CEMENTED _____ SIZE _____ No. Ft. _____ Date _____
 COAL WAS ENCOUNTERED AT 375 FEET _____ INCHES
 _____ FEET _____ INCHES FEET _____ INCHES
 _____ FEET _____ INCHES FEET _____ INCHES

Formation	Color	Hard or Soft	Top	Bottom	Oil, Gas or Water	Depth Found	Remarks
			375	380			
			1475	1492			
			1485	1490			
<p>Dear Mrs. Griffith: The Above is the only record which I have for Milton Oram Well # 1. I realize that it is not much and wonder if you could make me out a plugging record from a well in that nearby vicinity for which you have a good record of the drilling.</p> <p>Thanking you very much, I remain,</p> <p>Respectfully yours,</p> <p>George W. Moses</p>							

