

LATITUDE 38° 45' 00"

00,00,28
LONGITUDE

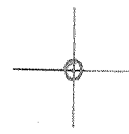

7'5 OGIS topo location

7.5' loc 2.02 S 15' loc _____
 0.58 W (calc.) _____

Company _____

Farm _____

Quad ARLEE 7 1/2'

County MASON

District ARBUCKLE

WELL LOCATION MAP

File No. 053-0004

DEEP WELL

LATITUDE 38°45'

02°00'

LONGITUDE



7 1/2' LOC.
2.02 mi S.
0.58 mi W

Company _____

Farm _____

Glenwood NE

Quad ARLEE Quad- 7 1/2'

County MASON

District ARBUCKLE

WELL LOCATION MAP

File No. MASON-053-4

DEEP WELL

1-0 unnamed (o)

Mason

Proposed Location of Well 9104
Federal Fuel Corpⁿ of West Va.
On James Williamson 81³/₄ Farm
Arbuckle District
Mason County
West Virginia

40 poles
2 1/2 inch

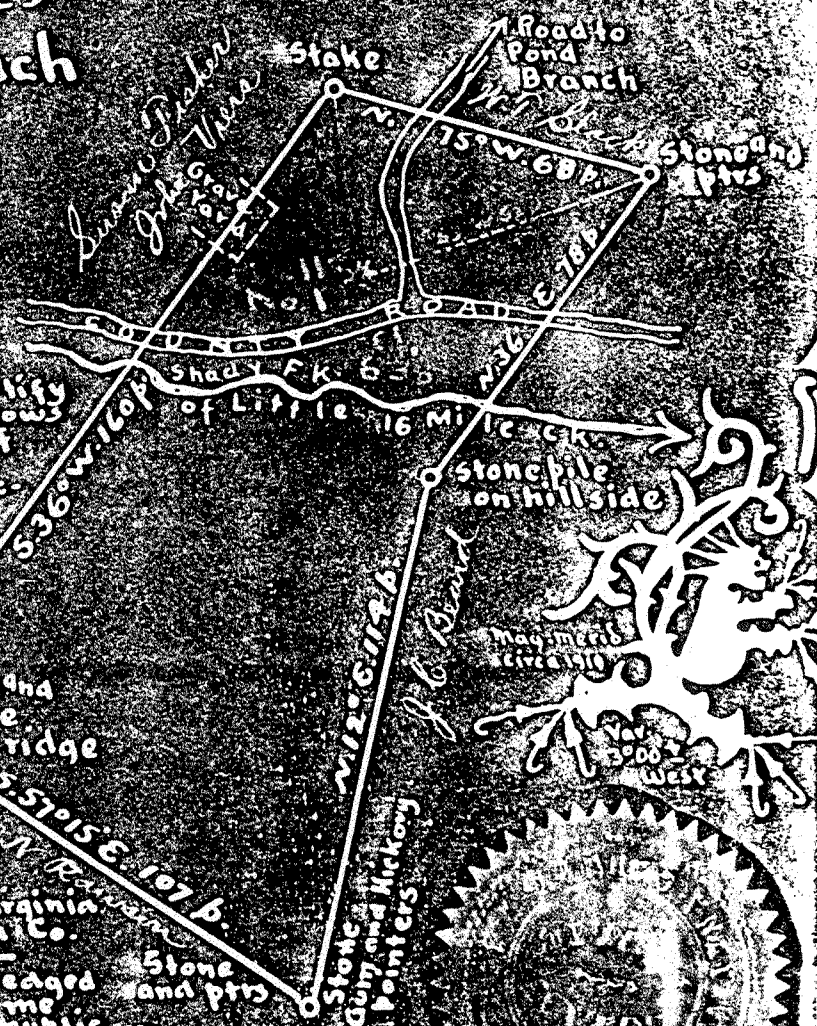

I the undersigned hereby certify that this map is correct and shows all the information to the best of my knowledge and belief, required by the Oil and Gas Section of the Mining Laws of West Virginia.

W.S. Kelly



State of West Virginia
Kanawha Co.
I acknowledge and
before me a notary public
July 5, 1930
my commission expires
April 25, 1938

P.J. Walsh

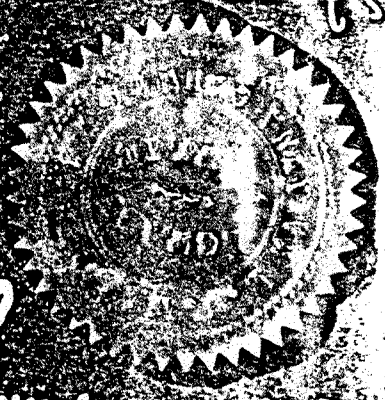

Msn 4

000104

JAMES WILLIAMSON NO. GW-704 WELL.

Arbuckle District, Mason County, W. Va.
By The Federal Fuel Corporation (and Columbian Carbon Co.),
Charleston, W. Va.

Commenced drilling July 24, 1930; completed October 6, 1930;
abandoned October 30.

Location made July 3, 1930.

Elevation, 638' L.

Drillers, Harry Fulmer and Harry Adamson. Tool dressers, Ross Francis,
and Hupp.

On Shady Fork of Little Sixteenmile Creek, 1 mi. N. E. of Condee,
2.3 mi. N. W. of Southside, and 4.1 mi. S. W. of Beech Hill Station.

4.05 mi. E. of 82° 05' and 3.75 mi. N. of 38° 40' - NE - Glenwood Quadrangle.

13 1/2" casing, 124' 2" 42-lb. (83' 4" pulled--40' 10" left in well);
10" casing, 32-lb., 696' 7" (pulled); 8 1/2" casing, 24-lb., 1422' 3"
(pulled); 6 5/8" casing, 2079' 8" (pulled); 1 - 6 5/8" casing shoe (pulled).
16' x 16" wood conductor.

Well was shot October 9, 1930, with 5800 lbs. gelatin; 83 shells, 4 1/2 x 10'.
Shooter, R. O. Wright. Well abandoned as dry hole.

1 1/2 hrs. after shot, 238,000 cu. ft.; 15 hrs. after shot, 50,000 cu. ft.;
28 hrs. after shot, 38,000 cu. ft. Well shut in casing--rocked up
to 185 lbs.

Record published in pp. 307-8 of Volume VII, Deep-Well Records.

	Top.	Bottom.
Sandy soil	0	10
Gravel	10	20
Sand (water at 20')	20	40
Red rock	40	55
Lime	55	80
Blue slate	80	110
Red rock	110	125
Sand	125	150
Red rock	150	190
Lime	190	215
Pink slate	215	265
Black slate	265	300
Red rock	300	310
Slate	310	330
Sand	330	380
Slate	380	420
Red rock	420	440
Lime	440	470
Sand	470	490
Red rock	490	510
Slate	510	525
Lime	525	540
Red rock	540	555
Slate	555	590
Water sand (5 bailers water per hour at 630')	590	660
Slate	660	720
Sand	720	740
Slate	740	850
Sand	850	890
Slate	890	910
Sand	910	930
Slate	930	940
Sand	940	1000

(OVER)

JAMES WILLIAMSON NO. GW-704 WELL (Continued).

	Top.	Bottom.
Slate	1000	- 1010
Sand	1010	- 1020
Black slate	1020	- 1100
Sand	1100	- 1130
Slate	1130	- 1140
Sand	1140	- 1160
Slate	1160	- 1190
Sand	1190	- 1250
Slate	1250	- 1280
Sand	1280	- 1285
Slate	1285	- 1405
Big Lime	1405	- 1545
Big Injun Sand (hole full water at 1550')	1545	- 1775
Lime	1775	- 1810
Slate and shells	1810	- 2022
Coffee slate	2022	- 2026
Berea Sand (water all the way through)	2026	- 2057
Slate	2057	- 2100
Slate and shells	2100	- 2300
Slate	2300	- 2425
Shells	2425	- 2440
Slate	2440	- 2994
Dark broken shale	2994	- 3262
Dark-brown shale	3262	- 3414
Light shale (show of gas, 3446')	3414	- 3590
Light and dark shale	3590	- 3660
Black shale (good show of gas all the way through)	3660	- 3828
Corniferous Lime (9' in)	3828	- 3837
Total depth		3837

5800 lbs gal
 would cover
 About 580'

3828
 638
 -3190

SHOT APPROX. 3257' - TD

2994
 638
 -3632

1405
 638
 -766

7-11-4

Federal Fuel Corporation Company
 Charleston Address
 W. Va.

COMPLETION DATA SHEET
 NO. 2
 FORMATION RECORD

Name	Color	Character	Oil, Gas or Water	Top	Bottom	Thickness	Total Depth	Remarks
Sandy Soil	Brown	-	-	0	10	10		
Gravel	-	-	-	10	20	10		
Sand	-	-	-	20	40	20		
Sand	-	-	-	-	-	-		Water.
Red Rock	-	-	-	40	55	15		
Lime	-	-	-	55	80	25		
Blue Slate	-	-	-	80	110	30		
Red Rock	-	-	-	110	125	15		
Sand	-	-	-	125	150	25		
Red Rock	-	-	-	150	190	40		
Lime	-	-	-	190	215	25		
Pink Slate	-	-	-	215	265	50		
Black Slate	-	-	-	265	300	35		
Red Rock	-	-	-	300	310	10		
Slate	-	-	-	310	330	20		
Sand	-	-	-	330	380	50		
Slate	-	-	-	380	420	40		
Red Rock	-	-	-	420	440	20		
Lime	-	-	-	440	470	30		
Sand	-	-	-	470	490	20		
Red Rock	-	-	-	490	510	20		
Slate	-	-	-	510	525	15		
Lime	-	-	-	525	540	15		
Red Rock	-	-	-	540	555	15		
Slate	-	-	-	555	590	35		
Water Sand	-	-	-	590	660	70		
Slate	-	-	-	660	720	60		
Water	Five bailers	per hour at	650 ft.					
Sand	-	-	-	720	740	20		
Slate	-	-	-	740	850	110		
Sand	-	-	-	850	890	40		
Slate	-	-	-	890	910	20		
Sand	-	-	-	910	930	20		
Slate	-	-	-	930	940	10		
Sand	-	-	-	940	1000	60		
Slate	-	-	-	1000	1010	10		
Sand	-	-	-	1010	1020	10		
Black Slate	-	-	-	1020	1100	80		
Sand	-	-	-	1100	1130	20		
Slate	-	-	-	1130	1140	10		
Sand	-	-	-	1140	1160	20		
Slate	-	-	-	1160	1190	30		
Sand	-	-	-	1190	1250	60		
Slate	-	-	-	1250	1280	30		
Sand	-	-	-	1280	1285	5		
Slate	-	-	-	1285	1405	120		

7700-4

Federal Fuel Corporation Company
 Charleston, W. Va. Address

COMPLETION DATA SHEET
 NO. 2
 FORMATION RECORD

Name	Color	Character	Oil, Gas or Water	Top	Bottom	Thickness	Total Depth	Remarks
Lime	-	-	-	1405	1545	140		
Injun Sand	-	-	-	1545	1775	230		
Lime	-	-	-	1775	1810	35		
Hole full of water at 1550 ft.								
Slate & Shells	-	-	-	1810	2022	112		
Coffee Slate	-	-	-	2022	2026	4		
Brea Sand	-	-	-	2026	2057	31		
Water all the way through								
Slate	-	-	-	2057	2100	43		
Slate & Shells	-	-	-	2100	2300	200		
Slate	-	-	-	2300	2425	125		
Shells	-	-	-	2425	2440	15		
Slate	-	-	-	2440	2994	554		
Dark Broken Shale	-	-	-	2994	3262	268		
Dark Brown Shale	-	-	-	3262	3414	152		
Light Shale	-	-	-	3414	3590	176		
Light & Dark Shale	-	-	-	3590	3660			
Black Shale	-	-	-	3660	3828	168		
Carnifus Lime	-	-	-	3828	9 ft. in		3837	
Total Depth								

Well was ~~not~~ ^{shot} shot at 2994 to 3828 feet; well was shot at _____ feet.

Salt ^{salt} Fresh water at 20 feet; ~~fresh~~ water at 650 feet.

Well was ~~producing~~ ^{dry} hole.

October 15 - 1930. _____ Approved Federal Fuel Corporation
 Date Owner - *by Glenn Dearet*

NOTE: All bottom formations must be noted as indicated above and all key-rocks and oil and gas sands must be recorded under their proper geological names in the district as well as any local names commonly used in the district for such strata.