

Latitude 38° 50'

Longitude 82° 00'

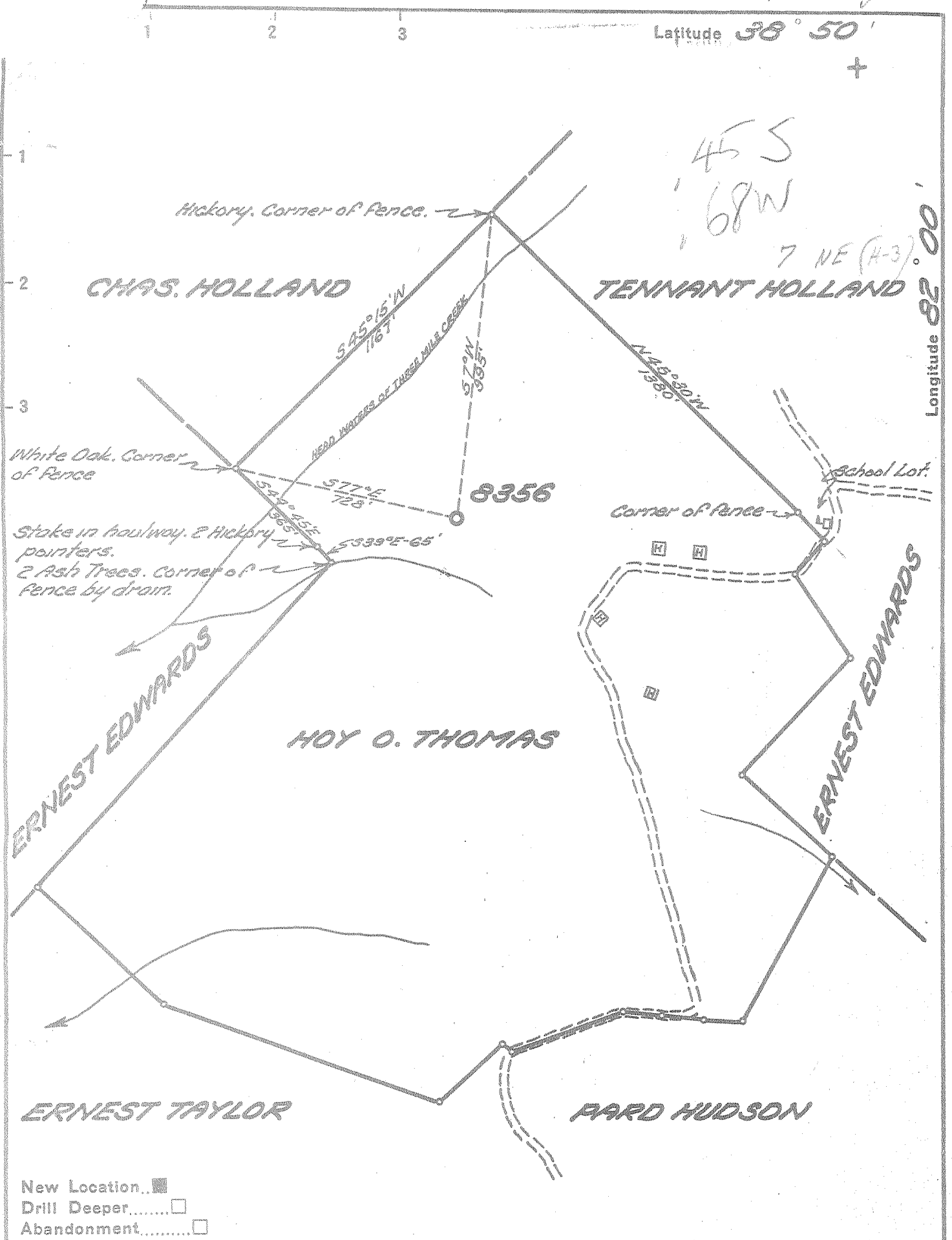

New Location
 Drill Deeper
 Abandonment

Company UNITED FUEL GAS CO.
 Address CHARLESTON, W. VA.
 Farm HOY O. THOMAS
 Tract _____ Acres 115 Lease No. 49187
 Well (Farm) No. 1 Serial No. 8356
 Elevation (Spirit Level) 833.99'
 Quadrangle POINT PLEASANT SE
 County MASON District COOPER
 Engineer Seybert R Jewell
 Engineer's Registration No. 2529
 File No. 40-91 Drawing No. _____
 Date 8-14-54 Scale 1" = 400'

STATE OF WEST VIRGINIA
 DEPARTMENT OF MINES
 OIL AND GAS DIVISION
 CHARLESTON

WELL LOCATION MAP
 FILE NO. MAS-64

+ Denotes location of well on United States Topographic Maps, scale 1 to 62,500, latitude and longitude lines being represented by border lines as shown.
 - Denotes one inch spaces on border line of original tracing.

Samples 9-H (169-3881') 1-0 Deep Well



STATE OF WEST VIRGINIA
DEPARTMENT OF MINES
OIL AND GAS DIVISION

Quadrangle Point Pleasant

Permit No. MAS-64

WELL RECORD

Oil or Gas Well Dry Hole
(KIND)

Company UNITED FUEL GAS COMPANY
Address P.O. Box 1273, Charleston 25, W. Va.
Farm Hoy O. Thomas #1 Acres 115
Location (waters) Threemile Creek
Well No. 8356-T Elev. 833.99'
District Cooper County Mason
The surface of tract is owned in fee by _____
Address _____
Mineral rights are owned by Hoy O. Thomas
Rt. 2 Address Leon, W. Va.
Drilling commenced 9-8-54
Drilling completed 10-29-54
Date Shot _____ From _____ To _____
With _____
Open Flow _____ /10ths Water in _____ Inch
_____ /10ths Merc. in _____ Inch
Volume _____ Cu. Ft.
Rock Pressure _____ lbs. _____ hrs.
Oil _____ bbls., 1st 24 hrs.
Fresh water 782, 850, 1058 feet 1870-1890, 2118 feet
Salt water _____ feet _____ feet

Casing and Tubing	Used in Drilling	Left in Well	Packers
Size			Kind of Packer
16			
18			
10 <u>-3/4"</u>		<u>901'</u>	Size of
8 1/2		<u>1537'</u>	
6 3/4 <u>7"</u>		<u>2533'</u>	Depth set
5 3/16			
3			Perf. top
2			Perf. bottom
Liners Used			Perf. top
			Perf. bottom

CASING CEMENTED _____ SIZE _____ No. Ft. _____ Date _____

COAL WAS ENCOUNTERED AT 225 FEET 24 INCHES
_____ FEET _____ INCHES _____ FEET _____ INCHES
_____ FEET _____ INCHES _____ FEET _____ INCHES

Formation	Color	Hard or Soft	Top	Bottom	Oil, Gas or Water	Depth Found	Remarks
Clay			0	21	Water 782'	2 bailers per hour	
Slate			21	40			
Red Rock			40	80	Water 850'	10 bailers per hour	
Slate			80	100			
Red Rock			100	118	Water 1053'	hole full	
Slate			118	170			
Red Rock			170	202	Water 1870-1890'	2 gallons per hour	
Slate			202	225			
Coal			225	227	Water 2118'	1 bailer per hour	
Sand			227	249			
Red Rock			249	281	Dry Hole -	Br. Shale	
Slate			281	324			
Sand			324	367	Will plug &	& abandon	
Slate			367	410			
Red Rock			410	610			
Sand			610	640			
Red Rock			640	690			
Slate			690	760			
Sand			760	894			
Slate			894	909			
Sand			909	1070			
Slate			1070	1200			
Sand			1200	1230			
Slate			1230	1276			
Lime			1276	1362			
Maxon			1362	1515			
Big Lime			1515	1635			
Slate & Shells			1635	2100			
Coffee Shale			2100	2112			
Berea			2118	2150			
Slate & Shells			2150	3155			
Shale			3155	3200			
Slate			3200	3350			
Shale			3350	3500			
Slate			3500	3795			
Shale			3795	3875			
Corniferous			3875				
Total depth			3891'				

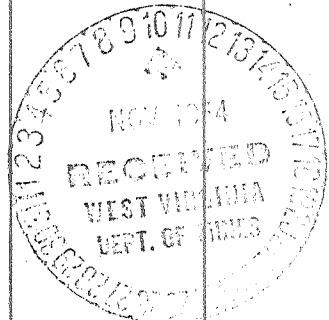

3875
834
-3041