

LATITUDE 37° 27' 30"

91° 35' 00"

LONGITUDE

WITHIN CIRCLE



7'5 OGIS topo location

7.5' loc 1.905  
0.10W

15' loc 4.685  
(calc.) 0.10W

Company \_\_\_\_\_

Farm \_\_\_\_\_

Quad WELCH 7 1/2' ± 15' NC

County Mc DONELL

District BROWNS CREEK

WELL LOCATION MAP

File No. 047-1242

Coil T. Carter & J. G. Conwright

1284

38° F.

OPERATOR U.S.G. Elev Surf At Well = 1284.3  
Depth of Well = 38° F.

PLAT OF GAS WELL LOCATION

CITY OF WELCH, BROWNS CREEK DISTRICT  
MCDOWELL CO. WEST VA

Scale 1:200  
October 22, 1934  
L.A. Osborn City Engr.

Well Location Shown

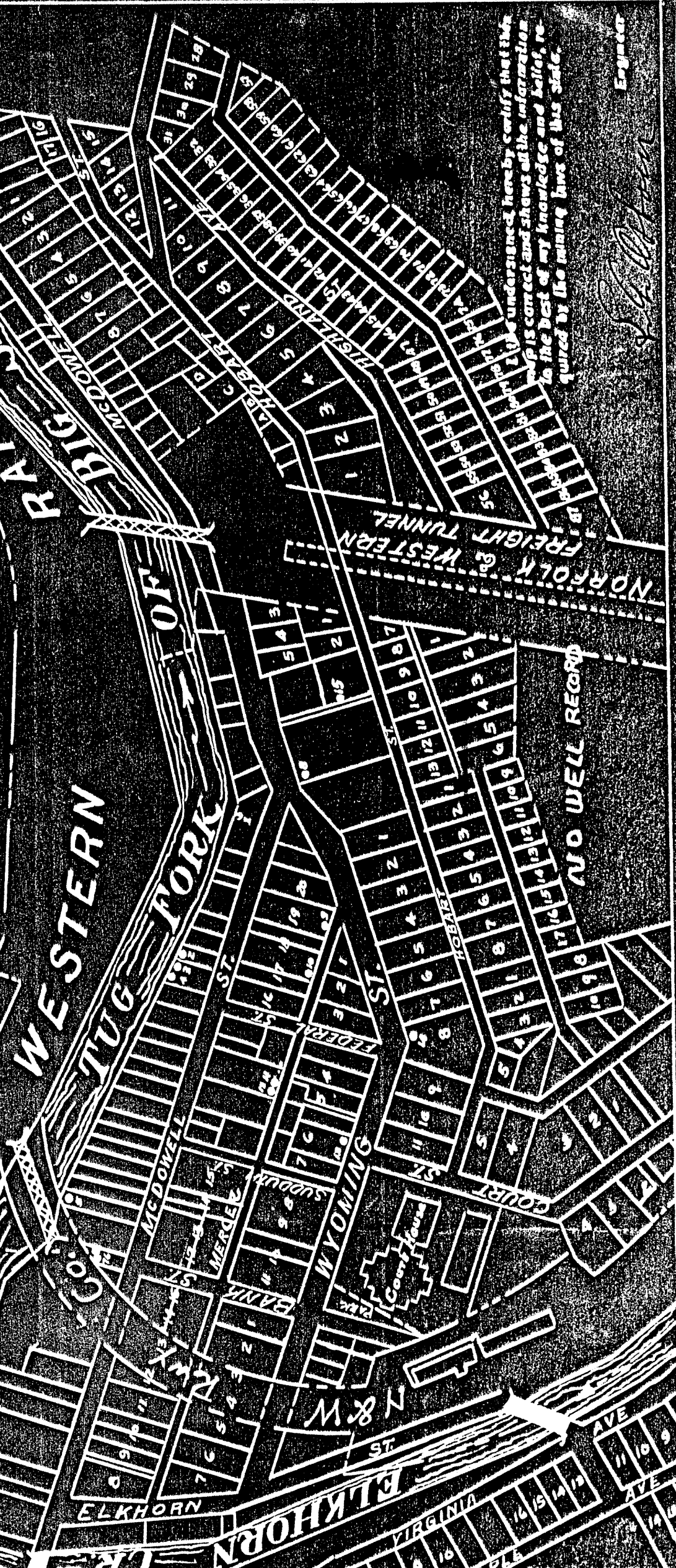

I, the undersigned hereby certify that this map is correct and shows all the information to the best of my knowledge and belief, required by the mining laws of this state.

*L.A. Osborn*  
Engineer

2-D-3W

CITY OF WELCH NO. 1.

McD-2.

By Gail T. Carter & J. G. Cart.

Browns Creek Dist.

(NO PERMIT)