

LATITUDE 37° 27' 30"

9° 53' 18"

LONGITUDE

WITHIN CIRCLE



7'5 OGIS topo location

7.5' loc 1.80S
0.11W

15' loc 4.68S
(calc.) 0.11W

Company _____

Farm _____

Quad WELCH 7 1/2' + 15' NC

County Mc DOWELL

District BROWNS CREEK

WELL LOCATION MAP

File No. 047-117

McDowell County Corporation

1928

89

OPERATOR U.S.G.S. Elev Surf At Well =
Depth of Well =

PLAT OF GAS WELL LOCATION

BY CITY OF WELCH, BROWNS CREEK DISTRICT
MCDOWELL CO. WEST VA

NORFOLK & WESTERN CO. RAILROAD

Scale 1"=200' ^{October 15, 1928} L. Osborn, City Engr.

Well Location Shown *

WESTERN CO. TUGA YORK

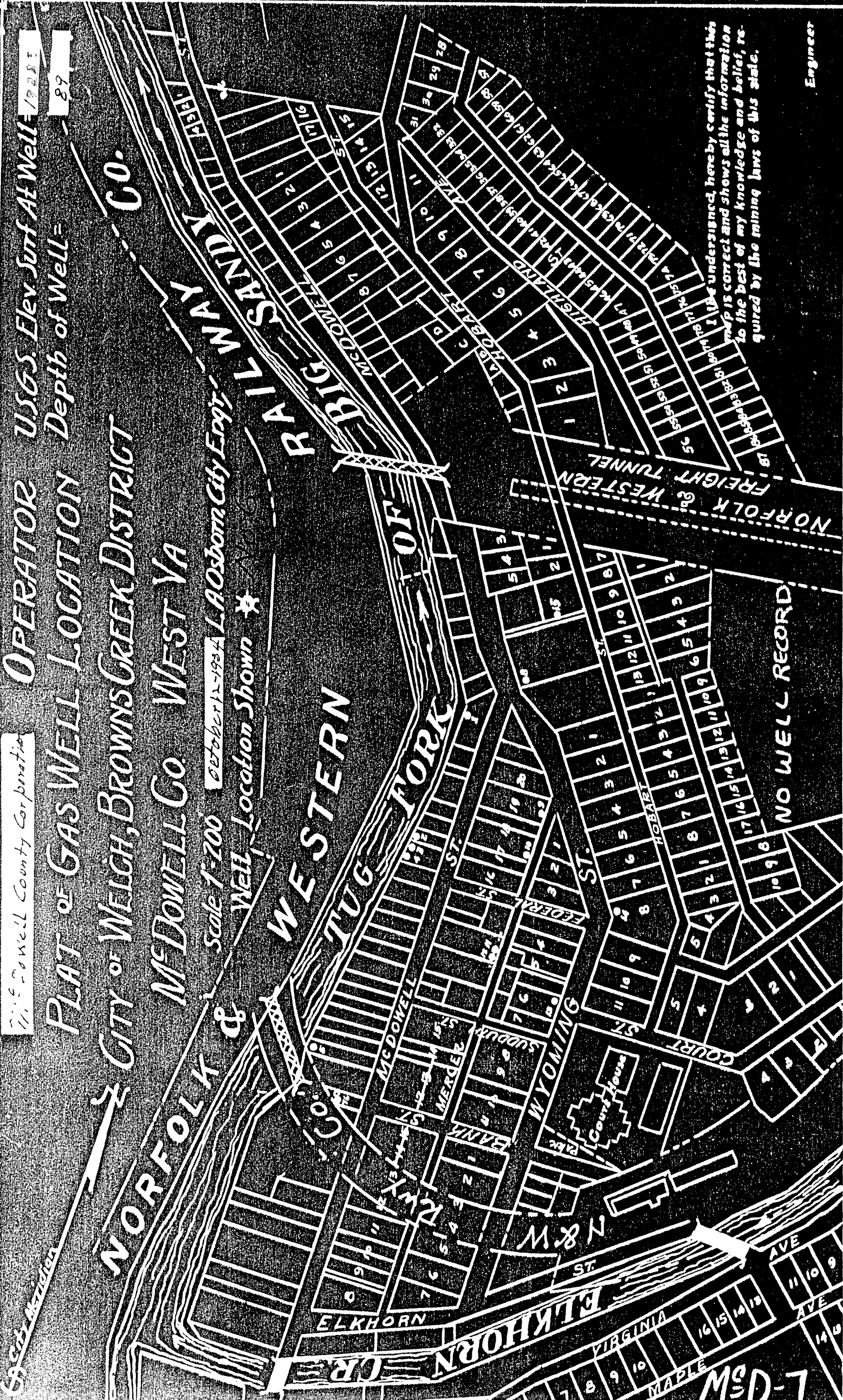

I, the undersigned, hereby certify that this map is correct and shows all the information to the best of my knowledge and belief, required by the mining laws of this state.

Engineer

NO WELL RECORD

MSD-7

CITY OF WELCH NO. 6.

McD-7.

By McDowell County Corp.

Browns Creek Dist.

(NO PERMIT)