

LATITUDE 37° 27' 30"

00' 53" 18"

LONGITUDE

WITHIN CIRCLE



7'5 OGIS topo location

7.5' loc 1.78 S 15' loc _____
 6.11 W (calc.) _____

Company _____

Farm _____

Quad WELCH 7 1/2' + NC

County Mc DOWELL

District BROWNS CREEK

WELL LOCATION MAP

File No. 047-2114

Section Meridian

J. H. Hort 7 map 14

1290'

752'

OPERATOR USGS Ely Surf Al Well
PLAT OF GAS WELL LOCATION Depth of Well

CITY OF WELCH, BROWNS CREEK DISTRICT
MCDOWELL CO. WEST VA

Scale 1"=200' October 15-1924 L. A. Osborn City Engr
Well Location Shown

WESTERN
TUG FORK
NORFOLK & WESTERN
RAILROAD

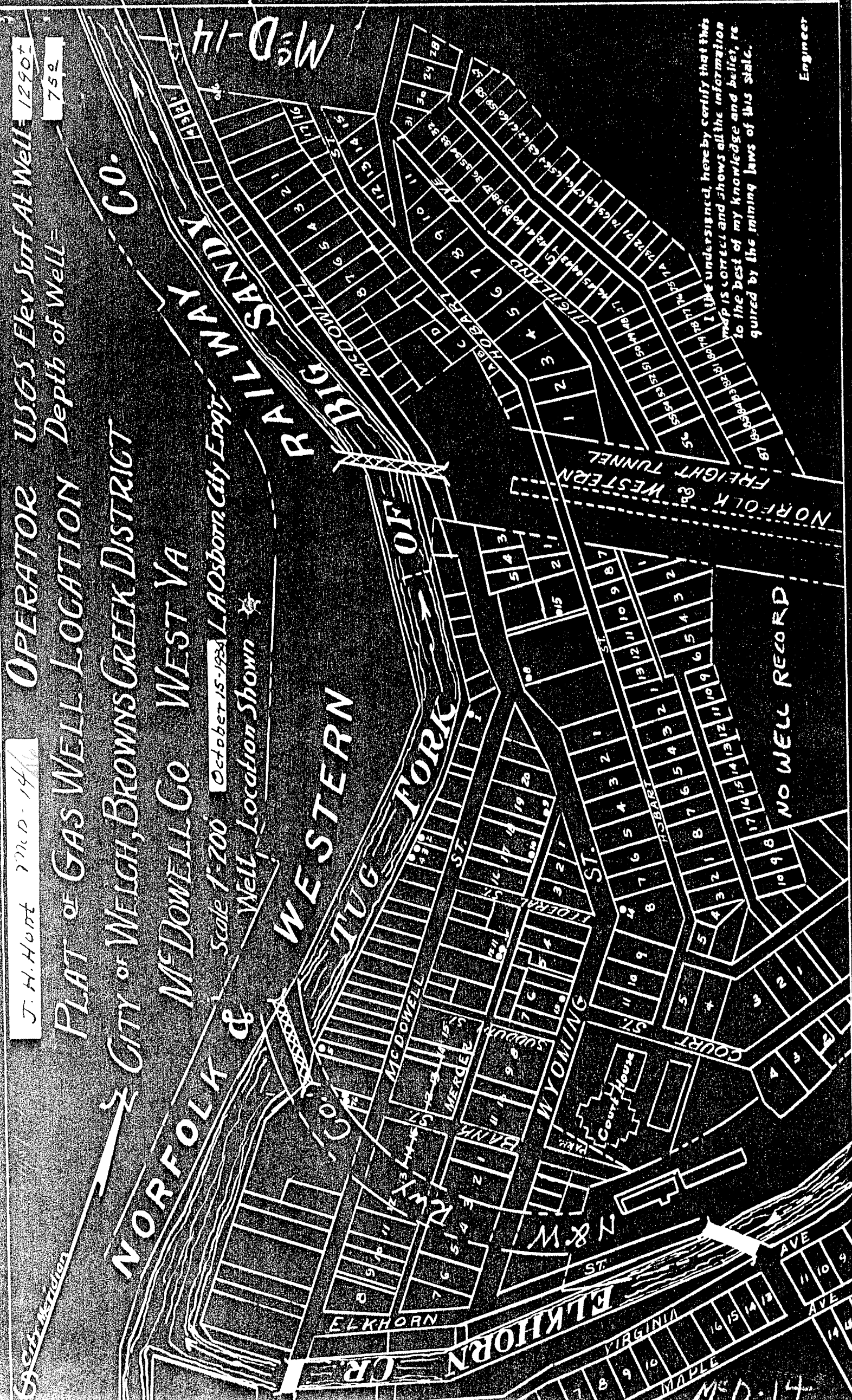

I, the undersigned, hereby certify that this map is correct and shows all the information to the best of my knowledge and belief, required by the mining laws of this State.

Engineer

MCD-14

CITY OF WELCH NO. 16.

McD-14.

By J. H. Hunt.

Browns Creek Dist.

(NO PERMIT)