

LATITUDE 37° 27' 30"

81° 35' 00"

LONGITUDE

WITHIN CIRCLE

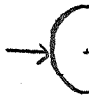

7'5 OGIS topo location

7.5' loc	<u>1.79 S</u>	15' loc	<u>4.675</u>
	<u>0.07 W</u>	(calc.)	<u>0.07 W</u>

Company _____

Farm _____

Quad WELCH 7 1/2' x 15' 00

County Mc DOWELL

District BROWNS CREEK

WELL LOCATION MAP

File No. 047-118

W. F. Shaw Jr

Operator USGS Elev Surf At Well 1306

Depth of Well 72.91

PLAT OF GAS WELL LOCATION
CITY OF WELCH, BROWNS CREEK DISTRICT
McDOWELL CO WEST VA

Scale 1"=200' ~~Robert Smith~~ La Osborn City Eng'r
Well Location Shown & 16.3

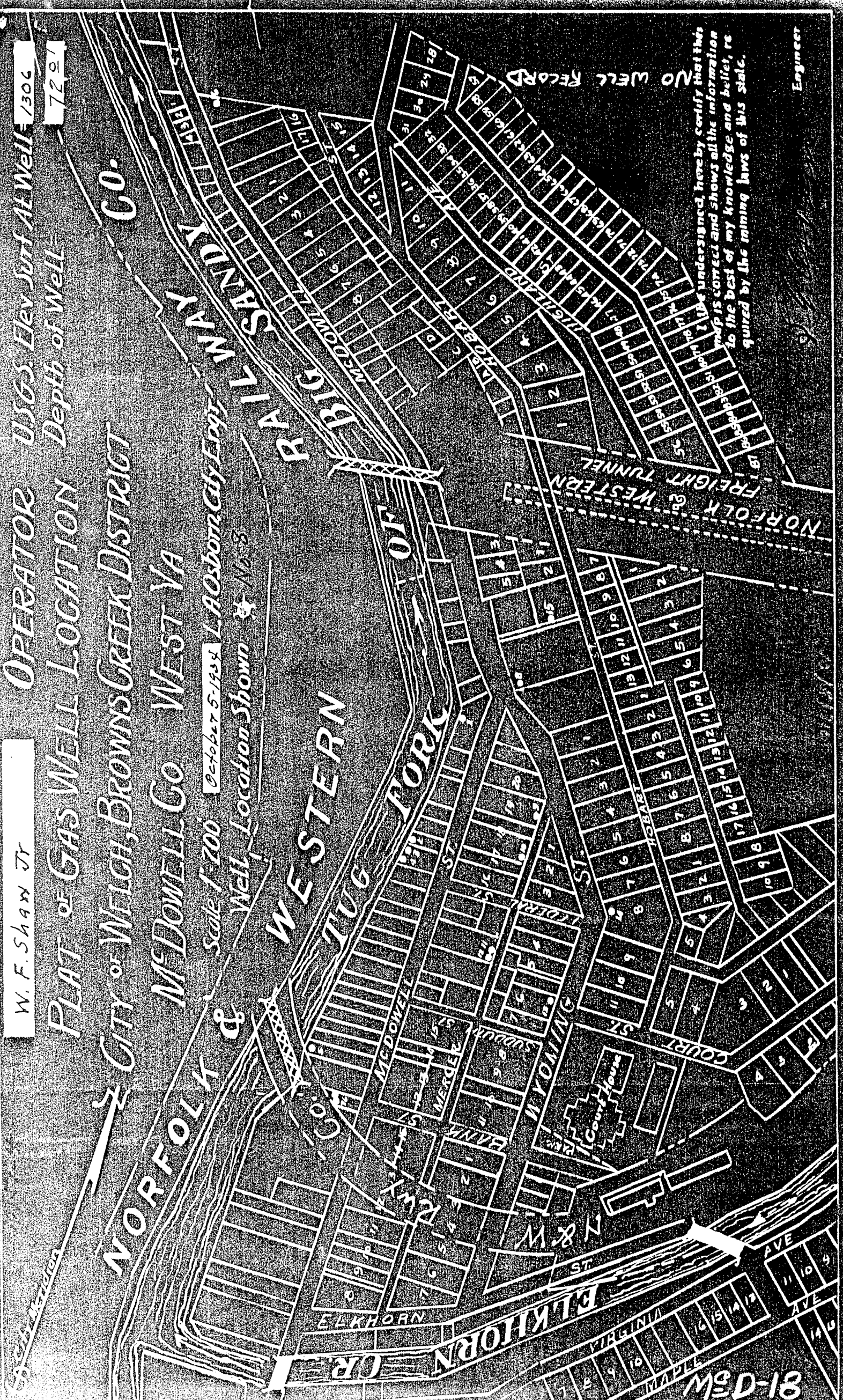

81-D-54

NO WELL RECORD

I, the undersigned, hereby certify that this map is correct and shows all the information to the best of my knowledge and belief, required by the mining laws of this State.

Engineer

CITY OF WELCH NO. 8.

McD-18.

By W. F. Shaw, Jr.

Browns Creek Dist.

(NO PERMIT)