

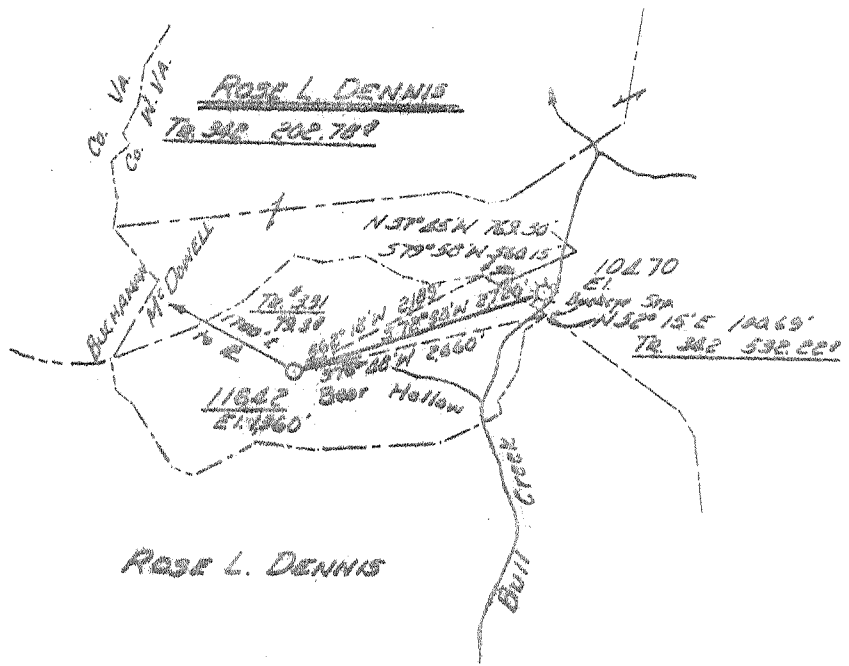

0.625
1.52W



Minimum Error of Closure 1' IN 200'
 Source of Elevation CONSOLIDATED GAS SUPPLY CORR WELL
10479 El. 988.09 F.B. 1276 Pg. 27
 "I, the undersigned, hereby certify that this map is correct to the best of my knowledge and belief and shows all the information required by paragraph 6 of the rules and regulations of the oil and gas section of the mining laws of West Virginia."

- New Location
- Drill Deeper
- Abandonment

MAP SHEET 825W 312E N77 F.B. 1621 Pg. 6-9

Company CONSOLIDATED GAS SUPPLY CORR
 Address CLARKSBURG, WEST VA.
 Farm ROSE L. DENNIS
 Tract 331 Acres 79.3 of 6067.85 Lease No. 71258
 Well (Farm) No. _____ Serial No. 11642
 Elevation (Spirit Level) 1360'
 Quadrangle JAEGER N.W.
 County MCDOWELL District SANDY RIVER
 Engineer JACKSON M. JAMES
 Engineer's Registration No. 2437
 File No. _____ Drawing No. _____
 Scale 1" = 2000'

STATE OF WEST VIRGINIA
 DEPARTMENT OF MINES
 OIL AND GAS DIVISION
 CHARLESTON

WELL LOCATION MAP
 FILE NO. MCD-618

Denotes location of well on United States Topographic Maps, scale 1 to 62,500, latitude and longitude lines being represented by border lines as shown.
 — Denotes one inch spaces on border line of original tracing.

DEEP WELL
 47 047

2-5

Huff Creek (303) (347)



RECEIVED

NOV 8 1974

STATE OF WEST VIRGINIA
DEPARTMENT OF MINES

OIL & GAS DIVISION
DEPT. OF MINES

Oil and Gas Division

WELL RECORD

Quadrangle Taeger
Permit No. MCD-618

Rotary XX Oil _____
Cable _____ Gas X
Recycling _____ Comb. _____
Water Flood _____ Storage _____
Disposal _____ (Kind) _____

Company Consolidated Gas Supply Corp.
Address 445 W. Main St., Clarksburg, WV
Farm Rose L. Dennis Acres 6068
Location (waters) Bull Creek/Tug Fork
Well No. 11642 Elev. 1360
District Sandy River County McDowell
The surface of tract is owned in fee by _____
A. H. Allen
Address Welch, WV
Mineral rights are owned by Clyde Dennis
Address Grundy, VA
Drilling Commenced 12-9-73
Drilling Completed 1-2-74
Initial open flow No Test cu. ft. _____ bbls.
Final production 189M cu. ft. per day _____ bbls.
Well open 24 hrs. before test 525# RP.

Casing and Tubing	Used in Drilling	Left in Well	Cement fill up Cu. ft. (Sks.)
Size 20- XX	22'	22'	To Surface
Cond. 12 1/2"	608'	608'	To Surface
9 5/8			
8 5/8	1680'	1680'	360 bags
7			
5 1/2			
4 1/2	4250'	4250'	87 bags
3			
2			
Liners Used			

Well treatment details:

Attach copy of cementing record.

Well treated in Brown Shale with 500 gals. 15% HCL, 60 gal. I-42
770 bbl. 1% KCL water, 50,000# sand. Well treated in Big Lime with 4,000 gal 20%
HCL, 8,000 gal of 15% HCL.
Perforations: 4131'-4140', 4116'-4119', 3161'-3168', 3143'-3145', 3064'-3068'
Dev. Sh. "Strog" dry | Pay - Big Lime

Coal was encountered at _____ Feet _____ Inches
Fresh water _____ Feet _____ Salt Water _____ Feet _____
Producing Sand Big Lime Depth 3064'-3168'

Formation	Color	Hard or Soft	Top Feet	Bottom Feet	Oil, Gas or Water	* Remarks
Sand			0	12		
Shale			12	16		
Sand			16	44		
Shale			44	89		
Sand			89	328		
Shale			328	338		
Sand			338	646		
Shale			646	777		
Sand			777	801		
Shale			801	857		
Sand			857	1090		
Shale			1090	1108		
Sand			1108	1191		
Shale			1191	1207		
Sand			1207	1260		
Sand & Shale			1260	1288		
Shale			1288	1324		
Sand			1324	1371		
Shale			1371	1386		
Sand & Shale			1386	1401		
Sand			1401	1435		
Sand & Shale			1435	1460		
Sand			1460	1733		

(over)

* Indicates Electric Log tops in the remarks section.

NOV 21 1974

Formation	Color	Hard or Soft	Top Feet //	Bottom Feet	Oil, Gas or Water	* Remarks
Sand & Shale			1733	1889		
Sand			1889	1924		
Sand & Shale			1924	1937		
Shale			1937	1973		
Sand			1973	2024		
Sand & Shale			2024	2072		
Sand			2072	2084		
Shale			2084	2090		
Maxton			2090	2234		
Sand & Shale			2234	2281		
Sand			2281	2314		
Sand & Shale			2314	2344		
Sand			2344	2358		
Sand & Shale			2358	2404		
Sand			2404	2449		
Shale			2449	2583		
Sand & Shale			2583	2670		
Lower Maxton			2670	2724		
Shale			2724	2758		
Little Lime			2758	2875		
Sand, Shale, Lime			2875	2930		
Big Lime			2930	3211		
Sand & Shale			3211	3430		
Shale			3430	3825		
Berea			3825	3836		
Shale			3836	4819		
Sand & Shale			4819	5015		
Shale			5015	5670		
Onondago			5670	5747		
Oriskany			5747	5765		
Shale			5765	5870		
Total Depth				5870		
<u>Electric Log</u>						
Upper Maxton			2093	2233		
Maxton			2394	2456		
Lower Maxton			2674	2736		
Little Lime			2790	2847		
<u>Big Lime</u>			2870	3194		
Berea			3817	3834		
<u>Stray sd. in Brown Shale seg.</u>			4115	4159		
Onondaga			5666	5694		
Oriskany			5694	5716		
Helderberg			5716	5776		
Silurian			5776	5845		
<u>Salina</u>			5845			
Total Depth				5860		
Measured from K. B. 10' above G. L.						

Date November 6, 19 74

APPROVED Consolidated Gas Supply Corp. Owner

By [Signature] Manager of Production

(Title)

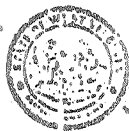

STATE OF WEST VIRGINIA
DEPARTMENT OF MINES

Oil and Gas Division

WELL RECORD

Rotary XX Oil _____
 Cable _____ Gas X
 Recycling _____ Comb. _____
 Water Flood _____ Storage _____
 Disposal _____ (Kind) _____

Quadrangle Taeger

REVISED

Permit No. MCD-618

Company Consolidated Gas Supply Corp.
 Address 445 W. Main St., Clarksburg, WV
 Prop. Rose L. Dennis Acres 6068
 Location (waters) Bull Creek/Tug Fork
 Well No. 11642 Elev. 1360
 District Sandy River County McDowell
 The surface of tract is owned in fee by _____
A. H. Allen
 Address Welch, WV
 Mineral rights are owned by Clyde Dennis
 Address Grundy, VA
 Drilling Commenced 12-9-73
 Drilling Completed 1-2-74
 Initial open flow No Test cu. ft. _____ bbls.
 Final production 189M cu. ft. per day _____ bbls.
 Well open 24 hrs. before test 525# RP.
 Well treatment details:

Casing and Tubing	Used in Drilling	Left in Well	Cement fill up Cu. ft. (Sks.)
Size 20- xxx	22'	22'	To Surface
Cond. 1210'	608'	608'	To Surface
9 5/8			
8 5/8	1680'	1680'	360 bags
7			
5 1/2			
4 1/2	4250'	4250'	87 bags
3			
2			
Liners Used			

Attach copy of cementing record.

Well treated in Brown Shale with 500 gals. 15% HCL, 60 gal. 1-1/2
 770 bbl. 1% KCL water, 50,000# sand. Well treated in Big Lime with 4,000 gal 20%
 HCL, 8,000 gal of 15% HCL.
 Perforations: 4131'-4140', 4116'-4119', 3161'-3168', 3143'-3145', 3064'-3068'

Coal was encountered at _____ Feet _____ Inches
 Fresh water _____ Feet _____ Salt Water _____ Feet _____
 Producing Sand: Big Lime Depth 3064'-3168'

Formation	Color	Hard or Soft	Top Feet	Bottom Feet	Oil, Gas or Water	* Remarks
Sand			0	12		
Shale			12	16		
Sand			16	44		
Shale			44	89		
Sand			89	328		
Shale			328	338		
Sand			338	646		
Shale			646	777		
Sand			777	801		
Shale			801	857		
Sand			857	1090		
Shale			1090	1108		
Sand			1108	1191		
Shale			1191	1207		
Sand			1207	1260		
Sand & Shale			1260	1288		
Shale			1288	1324		
Sand			1324	1371		
Shale			1371	1386		
Sand & Shale			1386	1401		
Sand			1401	1435		
Sand & Shale			1435	1460		
Sand			1460	1733		

(over)

* Indicates Electric Log tops in the remarks section.

Formation	Color	Hard or Soft	Top Feet	Bottom Feet	Oil, Gas or Water	* Remarks
Sand & Shale			1733	1889		
Sand			1889	1924		
Sand & Shale			1924	1937		
Shale			1937	1973		
Sand			1973	2024		
Sand & Shale			2024	2072		
Sand			2072	2084		
Shale			2084	2090		
Maxton			2090	2234		
Sand & Shale			2234	2281		
Sand			2281	2314		
Sand & Shale			2314	2344		
Sand			2344	2358		
Sand & Shale			2358	2404		
Sand			2404	2449		
Shale			2449	2583		
Sand & Shale			2583	2670		
Lower Maxton			2670	2724		
Shale			2724	2758		
Little Lime			2758	2875		
Sand, Shale, Lime			2875	2930		
Big Lime			2930	3211		
Sand & Shale			3211	3430		
Shale			3430	3825		
Berea			3825	3836		
Shale			3836	4819		
Sand & Shale			4819	5015		
Shale			5015	5670		
Onondago			5670	5747		
Oriskany			5747	5765		
Shale			5765	5870		
Total Depth				5870		
Electric Log						
Upper Maxton			2093	2233		
Maxton			2394	2456		
Lower Maxton			2674	2736		
Little Lime			2790	2847		
Big Lime			2870	3194		
Berea			3817	3834		
Stray			4115	4159		
Onondago			5666	5694		
Oriskany			5694	5716		
Helderberg			5716	5776		
Silurian			5776	5845		
Salina			5845			
Total Depth				5860		
Present TD				4471		
						*Ran 7-1/4" open-hole bridge plug set @ 4490 with 5 sacks calseal (filled up to 4471', present depth).
Measured from K. B. 10' above G. L.						

RECEIVED
 FEB 24 1976
 PENNSYLVANIA STATE OIL & GAS
 CONSERVATION COMMISSION

Date November 6, 19 74

APPROVED Consolidated Gas Supply Corp. Owner

By [Signature] Manager of Production

(Title)



STATE OF WEST VIRGINIA
DEPARTMENT OF MINES

Oil and Gas Division

OIL AND GAS WELL PERMIT APPLICATION

TO THE DEPARTMENT OF MINES,
Charleston, W. Va.

DATE November 21, 1973

Surface Owner A. H. Allen
Address Welch, West Virginia
Mineral Owner Clyde Dennis, Agt.
Address Drawer D, Grundy, Virginia
Coal Owner Same
Address _____
Coal Operator No Operations
Address _____

Company Consolidated Gas Supply Corporation
Address Clarksburg, West Virginia
Farm Rose L. Dennis Acres 6067.86
Location (waters) Bull Creek/Tug Fork
Well No. 11642 Elevation 1360'
District Sandy River County McDowell
Quadrangle Iaeger

THIS PERMIT MUST BE POSTED AT THE WELL SITE
All provisions being in accordance with Chapter 22,
of the W. Va. Code, the location is hereby approved
for drilling. This permit shall expire if
operations have not commenced by 3-28-74.

[Signature]
Deputy Director - Oil & Gas Division

Rue Schoolcraft
Pineville, W.Va. 732-7245

GENTLEMEN:

The undersigned well operator is entitled to drill upon the above named farm or tract of land for oil and gas, having fee title thereto, (or as the case may be) under grant or lease dated August 9 1961 by Rose L. Dennis made to Hope Natural Gas Company and recorded on the 16th day of November 1961 in McDowell County, Book 249 Page 672

XX NEW WELL _____ DRILL DEEPER _____ REDRILL _____ FRACTURE OR STIMULATE
_____ OIL AND GAS WELL ORIGINALLY DRILLED BEFORE JUNE 5, 1969.

The enclosed plat was prepared by a registered engineer or licensed land surveyor and all coal owners and/or operators have been notified as of the above date.

The above named coal owners and/or operator are hereby notified that any objection they wish to make, or are required to make by Section 3 of the Code, must be received by, or filed with the Department of Mines within ten (10) days. *

Copies of this notice and the enclosed plat were mailed by registered mail, or delivered to the above named coal operators or coal owners at their above shown respective address Same day _____ before, or on the same day with the mailing or delivery of this copy to the Department of Mines at Charleston, West Virginia.

W. Va. Oil & Gas Comm. Rules & Regulations 3.04 (b)

No deep wells are located within one mile of proposed Well No. 11642

Very truly yours,

(Sign Name) [Signature] Mgr. of Prod.

Well Operator

Consolidated Gas Supply Corporation

Street

Address of Well Operator

445 West Main Street

City or Town

Clarksburg, West Virginia 26301

State

*SECTION 3 . . . If no objections are filed or found by the Department of mines, within said period of ten days from the receipt of notice and plat by the department of mines, to said proposed location, the department shall forthwith issue to the well operator a permit reciting the filing of such plat, that no objections have been made by the coal operators or found thereto by the department and that the same is approved and the well operator authorized to proceed.

THIS IS AN ESTIMATE ONLY
ACTUAL INFORMATION WILL BE SUBMITTED ON OG-10 UPON COMPLETION

PROPOSED WORK ORDER TO XX DRILL _____ DEEPEN _____ FRACTURE-STIMULATE _____
 DRILLING CONTRACTOR: (If Known) _____ RESPONSIBLE AGENT: _____
 NAME Lohmann-Johnson Drilling Company NAME R. E. Bayne
 ADDRESS Charleston, West Virginia 25301 ADDRESS Bridgeport, West Virginia 26330
 TELEPHONE (304) 343-0185 TELEPHONE 623-3611
 ESTIMATED DEPTH OF COMPLETED WELL: 5900' ROTARY XX CABLE TOOLS _____
 PROPOSED GEOLOGICAL FORMATION: Oriskany
 TYPE OF WELL: OIL _____ GAS XX COMB. _____ STORAGE _____ DISPOSAL _____
 RECYCLING _____ WATER FLOOD _____ OTHER _____

TENTATIVE CASING PROGRAM:

CASING AND TUBING SIZE	USED FOR DRILLING	LEFT IN WELL	CEMENT FILL UP OR SACKS - CUBIC FT.
XXXXX 20"	20'	20'	To Surface
XXXXX 11"	650'	650'	To Surface
9 - 5/8			
8 - 5/8	1600'	1600'	To Surface
7			
5 1/2			
4 1/2	5825'	5825'	150 bags
3			Perf. Top
2			Perf. Bottom
Liners			Perf. Top
			Perf. Bottom

APPROXIMATE FRESH WATER DEPTHS 95' FEET _____ SALT WATER None FEET _____
 APPROXIMATE COAL DEPTHS Various
 IS COAL BEING MINED IN THE AREA? No BY WHOM? _____

TO DRILL:

SUBMIT FIVE (5) COPIES OF OG - 1, \$100.00 PERMIT FEE, PERFORMANCE BOND AND PERMANENT COPY OF PLAT.

TO DRILL DEEPER OR REDRILL:

SUBMIT FIVE (5) COPIES OF OG - 1, SHOWING ORIGINAL PERMIT NUMBER AND PERFORMANCE BOND. ON WELLS DRILLED PRIOR TO 1929, A PERMANENT COPY OF THE PLAT AND THE ORIGINAL WELL RECORD MUST ALSO BE SUBMITTED.

TO FRACTURE - STIMULATE:

OIL AND/OR GAS WELL ORIGINALLY DRILLED BEFORE JUNE 5, 1929, FIVE (5) COPIES OG - 1, PERFORMANCE BOND, PERMANENT PLAT AND ORIGINAL WELL RECORD.

OIL AND/OR GAS WELL ORIGINALLY DRILLED ON AND/OR AFTER JUNE 5, 1929, FIVE COPIES OG - 1, SHOWING ORIGINAL PERMIT NUMBER, AND PERFORMANCE BOND.

Required forms must be filed within ninety (90) days of completion for bond release. Inspector to be notified twenty-four (24) hours in advance.

The following waiver must be completed by the coal operator if the permit is to be issued within ten days of receipt thereof.

WAIVER: I the undersigned, Agent for _____ Coal Company, Owner or Operator of the coal under this lease have examined and place on our mine maps this proposed well location.

We the _____ Coal Company have no objections to said well being drilled at this location, providing operator has complied with all rules and regulations in Articles 4, 5, and 7, Chapter 22 of the West Virginia Code.

For Coal Company

Official Title