

BERWIND LEASE
2430.35 ACRES+
WELL NO. 8

NOTE: ALL PRODUCING WELLS WITHIN 2400' ARE SHOWN HEREON.



I THE UNDERSIGNED, HEREBY CERTIFY THAT THIS PLAT IS CORRECT TO THE BEST OF MY KNOWLEDGE AND BELIEF AND SHOWS ALL THE INFORMATION REQUIRED BY LAW AND THE REGULATIONS ISSUED AND PRESCRIBED BY THE DEPARTMENT OF ENERGY.

L.L.S. 677 Gregory A. Smith

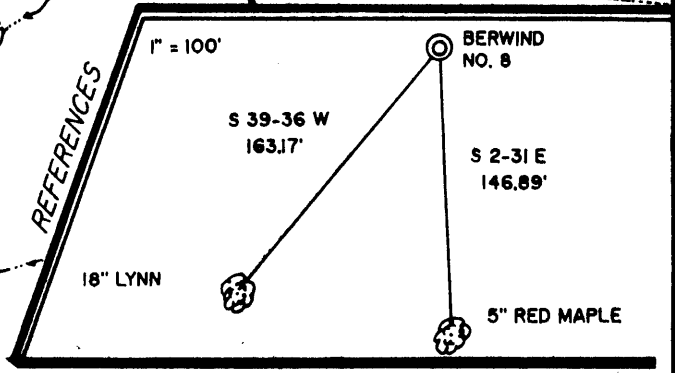
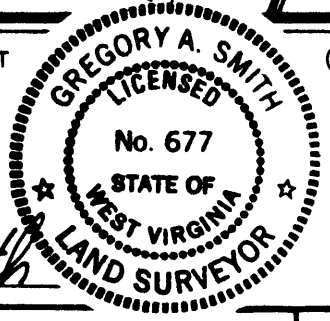

(+) DENOTES LOCATION OF WELL ON UNITED STATES TOPOGRAPHIC MAPS.
 DATE NOVEMBER 3, 19 92
 OPERATORS WELL NO. BERWIND NO. 8
 API WELL NO. 47 - 047 - 1177
 STATE COUNTY PERMIT

MINIMUM DEGREE OF ACCURACY 1 / 200 FILE NO. 2901 (41-04)
 PROVEN SOURCE OF ELEVATION TOP OF KNOB ELEVATION 2622' SCALE 1" = 2000'

STATE OF WEST VIRGINIA
 DEPARTMENT OF ENERGY
OIL AND GAS DIVISION

WELL TYPE: OIL GAS LIQUID INJECTION WASTE DISPOSAL IF "GAS" PRODUCTION STORAGE DEEP SHALLOW
 LOCATION: ELEVATION 2619' WATERSHED YALL CREEK OF DRY FORK COUNTY NAME NW-Pounding Mill
 DISTRICT BIG CREEK COUNTY McDOWELL QUADRANGLE AMONATE 7.5'
 SURFACE OWNER BERWIND LAND COMPANY ACREAGE 2430.35 OF 24,625.33
 ROYALTY OWNER BERWIND LAND COMPANY LEASE ACREAGE 2430.35 OF 24,625.33
 PROPOSED WORK: LEASE NO. _____
 DRILL CONVERT DRILL DEEPER REDRILL FRACTURE OR STIMULATE PLUG OFF OLD FORMATION PERFORATE NEW FORMATION PLUG AND ABANDON CLEAN OUT AND REPLUG OTHER _____
 PHYSICAL CHANGE IN WELL (SPECIFY) _____ TARGET FORMATION BERA
 ESTIMATED DEPTH 5000'

WELL OPERATOR Waco Oil & Gas Company Inc. DESIGNATED AGENT Stephen Holloway
 ADDRESS P.O. Box 397 Glenville, WV 26351 ADDRESS P.O. Box 397 Glenville, WV 26351
6-6 Big Creek (267)

State of West Virginia
Division of Environmental Protection
Section of Oil and Gas

Reviewed TM6

Recorded _____ Well Operator's Report of Well Work

Farm name: BRINARD, RAY Operator Well No.: BERWIND LAND#8

LOCATION: Elevation: 2619.00 Quadrangle: AMONATE

District: BIG CREEK County: MCDOWELL
Latitude: 9370 Feet South of 37 Deg. 15Min. 0 Sec.
Longitude 8390 Feet West of 81 Deg. 40 Min. 0 Sec.

Company: WACO OIL & GAS CO., INC.
1297 N. LEWIS ST.
GLENVILLE, WV 26351-0000

Agent: STEPHEN E. HOLLOWAY

Inspector: OFIE HELMICK
Permit Issued: 11/10/92
Well work Commenced: 11/20/92
Well work Completed: 12/11/92

Verbal Plugging
Permission granted on: _____

Rotary Cable _____ Rig

Total Depth (feet) 5489'

Fresh water depths (ft) _____
90'

Salt water depths (ft) _____
474'

Is coal being mined in area (Y/N)? N
Coal Depths (ft): 538-542, 1239-1243,
1953-1958

Casing & Tubing Size	Used in Drilling	Left in Well	Cement Fill Up Cu. Ft.
11-3/4"	181	181	C.T.S.
8-5/8"	2076	2076	C.T.S.
4-1/2"		5423	170 Sk.

OPEN FLOW DATA

Producing formation Berea, Gordon Pay zone depth (ft) see treatment
Gas: Initial open flow N/A MCF/d Oil: Initial open flow N/A Bbl/d
Final open flow 117 MCF/d Final open flow 0 Bbl/d
Time of open flow between initial and final tests 4 Hours
Static rock Pressure 680 psig (surface pressure) after 48 Hours

Second producing formation _____ Pay zone depth (ft) _____
Gas: Initial open flow _____ MCF/d Oil: Initial open flow _____ Bbl/d
Final open flow _____ MCF/d Final open flow _____ Bbl/d
Time of open flow between initial and final tests _____ Hours
Static rock Pressure _____ psig (surface pressure) after _____ Hours

NOTE: ON BACK OF THIS FORM PUT THE FOLLOWING: 1). DETAILS OF PERFORATED INTERVALS, FRACTURING OR STIMULATING, PHYSICAL CHANGE, ETC. 2). THE WELL LOG WHICH IS A SYSTEMATIC DETAILED GEOLOGICAL RECORD OF ALL FORMATIONS, INCLUDING COAL ENCOUNTERED BY THE WELLBORE.

RECEIVED

WV Division of Environmental Protection

APR 06 93

Permitting Office of Oil & Gas

For: WACO OIL & GAS CO., INC.

By: Daniel R. Chapman, Geologist

Date: March 30, 1993

1st stage: Gordon (5394-5379) 500 gal 15% HCL, 40,000# 20/40, 560 bbl H₂O, 193 Mcf N₂
 2nd stage: Berea (5271-5258) 500 gal 15% HCL, 7000# 80/100, 58,000# 20/40, 926 bbl H₂O
 116 Mcf N₂

Sand, Shale	0	538	3" Stream @ 90'
Coal	538	542	1" Stream @ 474
Sand, Shale	542	1239	
Coal	1239	1243	
Sand, Shale	1243	1953	
Coal	1953	1958	
Sand, Shale	1958	3822	
Big Lime	3822	4622	
Shale	4622	5238	
Berea	5238	5281	
Shale	5281	5324	
Gordon	5324	5384	
Shale	5384	5489	

T. D.

DE - 404

OF - 419

RECEIVED

WV Division of
 Environmental Protection

APR 06 83

Permitting
 Office of Oil & Gas

47-047-01177

Issued 11/10/92 Page of

STATE OF WEST VIRGINIA
 DEPARTMENT OF ENERGY, DIVISION OF OIL AND GAS
WELL WORK PERMIT APPLICATION

- 1) Well Operator: Waco Oil and Gas Company, Inc. ⁹³³ 51800 12) 210
- 2) Operator's Well Number: Berwind Land Company #8 3) Elevation: 2619'
- 4) Well type: (a) Oil / or Gas X/
- (b) If Gas: Production X/ Underground Storage /
- Deep / Shallow X/
- 5) Proposed Target Formation(s): Berea 395
- 6) Proposed Total Depth: 5000' feet
- 7) Approximate fresh water strata depths: 150'
- 8) Approximate salt water depths: 2200'
- 9) Approximate coal seam depths: 159, 553, 1162
- 10) Does land contain coal seams tributary to active mine? Yes / No X/
- 11) Proposed Well Work: Drill and stimulate new well
- 12)

CASING AND TUBING PROGRAM

TYPE	SPECIFICATIONS			FOOTAGE INTERVALS		CEMENT
	Size	Grade	Weight per ft.	For drilling	Left in well	Fill-up (cu. ft.)
Conductor						
Fresh Water	11-3/4"	H	42	150	150	38CS918-11.3 38CS918-11.2 C.T.S.
Coal	8-5/8"	J	24	2050	2050	C.T.S.
Intermediate	4-1/2"	J	10.5		5000	200 ft.3
Production						38CS918-11.1
Tubing						
Liners						

PACKERS : Kind
 Sizes
 Depths set

For Division of Oil and Gas Use Only

Fee(s) paid: Well Work Permit Reclamation Fund WPCP

Plat WW-9 WW-2B Bond Security Blanket Agent

(Type)

02/14/94
36

1) Date: NOVEMBER 2, 1992
2) Operator's well number BERWIND WELL #8
3) API Well No: 47 - 047 - 1177
State - County - Permit

STATE OF WEST VIRGINIA
DIVISION OF ENVIRONMENTAL PROTECTION, OFFICE OF OIL AND GAS

NOTICE AND APPLICATION FOR A WELL WORK PERMIT

4) Surface Owner(s) to be served:
(a) Name RAY BRINARD
Address BERWIND LAND COMPANY
1050 ONE VALLEY SQUARE
~~(b) XXXX Name~~ CHARLESTON, WV 25301
Address _____
(c) Name _____
Address _____
6) Inspector OFIE HELMICK
Address P.O. BOX 218
FANROCK, WV 24824
Telephone (304)- 732-9135

5) (a) Coal Operator:
Name Consolidation Coal Company
Address P.O. Box 1289
Bluefield, Virginia 24605
(b) Coal Owner(s) with Declaration
Name Berwind Land Company
Address 1050 One Valley Square
Charleston, WV 25301
Name _____
Address _____
(c) Coal Lessee with Declaration
Name Consolidation Coal Company
Address P.O. Box 1289
Bluefield, Virginia 24605

TO THE PERSON(S) NAMED ABOVE TAKE NOTICE THAT:

_____ Included is the lease or leases or other continuing contract or contracts by which I hold the right to extract oil and gas OR
XXX Included is the information required by Chapter 22B, Article 1, Section 8(d) of the Code of West Virginia (see page 2)

I certify that as required under Chapter 22B of the West Virginia Code I have served copies of this notice and application, a location plat, and accompanying documents pages 1 through 7 on the above named parties, by:
XXX Personal Service (Affidavit attached)
_____ Certified Mail (Postmarked postal receipt attached)
_____ Publication (Notice of Publication attached)

I have read and understand Chapter 22B and 38 CSR 11-18, and I agree to the terms and conditions of any permit issued under this application.
I certify under penalty of law that I have personally examined and am familiar with the information submitted on this application form and all attachments, and that based on my inquiry of those individuals immediately responsible for obtaining the information, I believe that the information is true, accurate, and complete.

I am aware that there are significant penalties for submitting false information, including the possibility of fine and imprisonment.

Well Operator WACO OIL AND GAS
By: [Signature]
Its: STEVEN HOLLOWAY - DESIGNATED AGENT
Address P.O. BOX 397
GLENVILLE, WV 26351
Telephone (304) 462-5347

Subscribed and sworn before me this 2nd day of November, 1992
Russell L. Tallhimer Commissioner
My commission expires September 9th, 2001 Notary Public