

10,950'

LATITUDE 37 - 27 - 30

LONGITUDE 81 - 12 - 30

Dominion Well No. 30222
Dominion Exploration and Production Co.
103,420 Acre Lease

47-055-00233 *

47-055-00234 *

Pocahontas Land Corporation
242/227
2160.35 Acres

DOM No. 30174

Proposed
DOM No. 30222

47-055-00022 *

Scale: 1" = 2000'

47-055-00245 *

47-055-00244 *

Proposed
DOM No. 30222

Proposed
DOM No. 30174

Pocahontas Land Corporation
242/227
424.55 Acres

47-055-00022 *

47-055-00306 *

COE
3/4/09

Notes:
Well site coordinates are
N: 164,249 Latitude: 37-27-03.3
E: 1,928,575 Longitude: 81-14-45.1
West Virginia
Coordinate System of 1927, South Zone
based upon
Differential GPS Measurements.
Plat orientation and corner and well
references are based upon the grid
north meridian.
Well location references are based upon
the magnetic meridian.

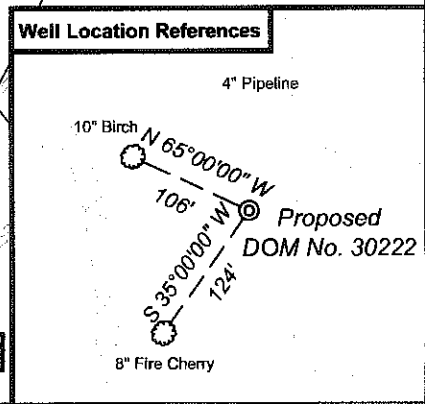

(-•-) Denotes location of well on United States topographic maps

Legend

- ⊙ Proposed gas well
- Found corner, as noted
- Surface boundary (approximate)
- - - Interior surface tracts (approx.)



I, the undersigned, hereby certify that this plat is correct to the best of my knowledge and belief and shows all the information required by law and the regulations issued and prescribed by the Department of Environmental Protection.

Ben R. Singleton
P.S. 2092

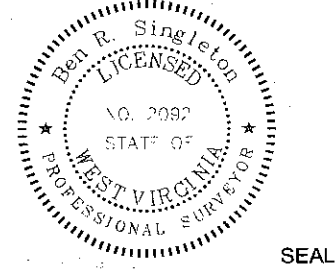

FILE NO: **W158-22-BR-04 (SWD-73)**
DRAWING NO: **W158-04_30222.dwg**
SCALE: **1" = 1000'**
MINIMUM DEGREE OF ACCURACY: **1:2500**
PROVEN SOURCE OF ELEVATION: **NGS HARN DEP Base Station Kanawha City**

STATE OF WEST VIRGINIA
DEPARTMENT OF ENVIRONMENTAL PROTECTION
OFFICE OF OIL AND GAS

DATE: **February 18** 20**09**
OPERATOR'S WELL NO. **DOM #30222**
API WELL NO.:
47 - 055 - 00398
STATE COUNTY PERMIT

CANCELLED

WELL TYPE: OIL GAS LIQUID INJECTION WASTE DISPOSAL
(IF GAS) PRODUCTION: STORAGE DEEP SHALLOW
LOCATION: ELEVATION: **2638'** WATERSHED **Righthand Fork of Widemouth Creek**
QUADRANGLE: **Matoaka** DISTRICT: **Rock** COUNTY: **Mercer**
SURFACE OWNER: **Pocahontas Land Corp.** ACREAGE: **425.55**
OIL AND GAS ROYALTY OWNER: **Penn Virginia Oil and Gas Co.** LEASE NO: **79917** ACREAGE: **103,420**
PROPOSED WORK: DRILL CONVERT DRILL DEEPER FRACTURE OR STIMULATE PLUG OFF OLD FORMATION
 PERFORATE NEW FORMATION OTHER PHYSICAL CHANGE IN WELL (SPECIFY) _____
 PLUG AND ABANDON CLEAN OUT AND REPLUG TARGET FORMATION: **BEREA SAND** ESTIMATED DEPTH: **4950'**

WELL OPERATOR: **Dominion Exploration and Production Inc.** DESIGNATED AGENT: **VP/Operations - Rodney Biggs**
ADDRESS: **One Dominion Drive, P.O. Box 1248** ADDRESS: **One Dominion Drive, P.O. Box 1248**
Jane Lew, WV 26378 **Jane Lew, WV 26378**

02/10/2012