

LATITUDE 37° 52' 30"



LONGITUDE 82° 17' 30"

7.5 OGIS topo location

7.5' loc	<u>0.555</u>	15' loc	<u>3.435</u>
	<u>0.60W</u>	(calc.)	<u>2.87W</u>

Company _____

Farm _____

Quad NAUGATUCK 7 1/2' ^{± 15' EC}

County MINGO

District KERMIT

WELL LOCATION MAP

File No. 059-1121

Deep hole (243)

I, the undersigned hereby certify that this map is true and correct, and shows all the information required by Oil & Gas law, Acts of 1929.

G.A. Cunningham

Acknowledged before me a _____ Notary Public of _____
Kanawha County, W.Va. this 20 day of March 1931

My Commission expires 2/28/35

D.G. Jay
Notary Public

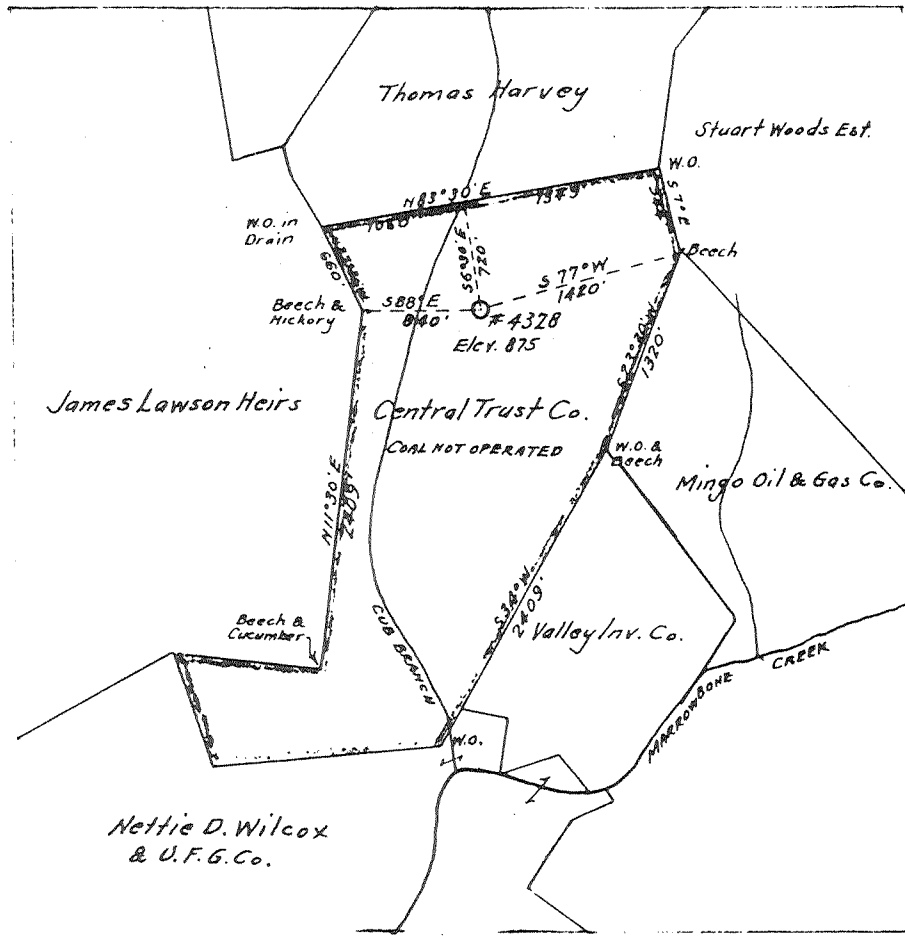

Central Trust Co.
Well No. 4328

LEWIS
Warfield District
Mingo County, W.Va.
March 19, 1931

Mingo-21

UNITED FUEL GAS CO.
MAP SHOWING
PROPOSED WELL LOCATION
SCALE:- 4 INCHES = 1 MILE

KERM IT

~~Marfield~~ District, Mingo County, W. Va.

United Fuel Gas Co., Charleston, W. Va.

On 6,852.4 acres, surface and mineral rights owned by Central Trust Company, Cincinnati, Ohio.

Drilled under permit Mingo-21, issued April 1, 1931.1 $\frac{1}{2}$ " casing, 33'; 10", 256'; 8 $\frac{1}{4}$ ", 604'.

Coal was encountered at 200-204'.

Completion reported to Dept. of Mines Dec. 7, 1931.

Fresh water at 50'; salt water at 1190, 1435 and 1555'.

	Top.	Bottom.
Sand and gravel	0	33
Sand	33	200
Coal	200	204
Slate	204	222
Sand	222	315
Broken lime	315	350
Slate	350	460
Sand	460	515
Slate	515	610
Sand	610	700
Slate	700	770
Sand	770	840
Broken lime	840	980
Slate	980	1010
Sand	1010	1200
Lime	1200	1235
Slate	1235	1240
Lime	1240	1415
Sand	1415	1445
Broken lime	1445	1482
Red rock	1482	1502
Lime	1502	1517
Red rock	1517	1535
Slate	1535	1545
Maxton Sand	1545	1582

Incomplete?

B-6

UNITED FUEL GAS COMPANY
(INCORPORATED)

May 21

SERIAL WELL NO. 4328

LEASE NO. 51896

MAP SQUARE 24-25

RECORD OF WELL No. 4328 on the
Central Trust Co. Farm of 6852.4 Acres
in Warfield District
Mingo County
W. Va.
Charlottesville Field, State of

CASING AND TUBING		
SIZE	USED IN DRILLING	LEFT IN WELL
10		
18 1/2	33	33
10	256	256
8 1/4	1322	604
6 5/8	1768	1768
5 3/16		
4 7/8		
4		
3	3706	3706
2		

TEST BEFORE SHOT
4 of Water in 2 in
10lbs of Merc. in
10lbs 88,000
Volume.....Cu. ft.

Furnished by Contractor
Rig Commenced 192
Rig Completed 192
Drilling Commenced July 11, 1931 192
Drilling Completed Oct. 24, 1931 192
Drilling to cost per foot
Contractor is: J.W. Ramsey & Sons
Charleston, W. Va.
Address:
Drillers' Names C.C. Ward
C.E. Ramsey
A.O. Taylor
Elev. 875' Bar.

SHUT IN
Date: Nov 7, 1931
3 in Tubing on casing
Size of Packer 3"x6 5/8"x16"
Kind of Packer Hook Wall 2660'
1st Perf. Set 3706 from 3695 11'
2nd Perf. Set 3514 from 3492 22'

TEST AFTER SHOT
22 of Water in 1 in casing
10lbs of Merc. in 1 in
Volume 132,390 246 Cu. ft.
Rock Pressure 432-F & 368
Date Shot 11/2, 3, 4, 5/31
Size of Torpedo
Oil Flowed.....bbls. 1st 24 hr
Oil Pumped.....bbls. 1st 24 hr

Well abandoned and
Plugged.....19
11'
22'

DRILLER'S RECORD

FORMATION	TOP	BOTTOM	THICKNESS	REMARKS
and Gravel	0	33	33	No casing shoe or packer used on
and	33	200	167	bottom of 18 1/2" or 10" Casing
al	200	204	4	8 1/2"x10"x13" Bottom Hole packer used
ate	204	222	18	on bottom of 8 1/2" Casing set 1322'
nd	222	315	93	6 5/8"x8 1/2"x10" Bottom Hole packer
roken Lime	315	350	35	on bottom of 6 5/8" Casing Set 1768
ate	350	460	110	Hole Full water at 50'
and	460	515	55	
late	515	610	95	
and	610	700	90	
late	700	770	70	
and	770	840	70	
roken Lime	840	980	140	
late	980	1010	30	
and	1010	1200	190	Hole full water at 1190'
ime	1200	1235	35	
late	1235	1240	5	
ime	1240	1415	175	
and	1415	1445	30	1 bailer water per hr. at 1435'
roken Lime	1445	1482	37	
Red Rock	1482	1502	20	
Lime	1502	1517	15	
Red Rock	1517	1535	18	
Slate	1535	1545	10	
maxon Sand	1545	1582	37	Hole full water at 1555'
Red Rock	1582	1597	15	
Slate	1597	1636	39	

Handwritten signature

SERIAL WELL NO. 4328

LEASE NO. _____

MAP SQUARE _____

RECORD OF WELL No.	on the	CASING AND TUBING			TEST BEFORE SHOT	
		Farm of	Acres	SIZE	USED IN DRILLING	LEFT IN WELL
in	District	County	10			10ths _____ of Merc. in _____ Inc
			18			10ths _____ Volume _____ Cu. f
Field, State of			10			TEST AFTER SHOT
			8 1-4			_____ of Water in _____ Inc
Big Commenced	102		6 5-8			10ths _____ of Merc. in _____ Inc
Big Completed	102		5 3-16			10ths _____ Volume _____ Cu. f
Drilling Commenced	102		4 7-8			Rock Pressure _____
Drilling Completed	102		4			Date Shot _____
Drilling to cost	per foot		3			Size of Torpedo _____
Contractor is:			2			Oil Flowed _____ bbls. 1st 24 hr
Address:			SHUT IN			Oil Pumped _____ bbls. 1st 24 hr
Drillers' Names			Date _____			Well abandoned and
			_____ in	Tubing or Casing		Plugged _____ 10 _____
			Size of Packer _____			
			Kind of Packer _____			
			1st Perf. Set _____ from _____			
			2nd Perf. Set _____ from _____			

DRILLER'S RECORD

FORMATION	TOP	BOTTOM	THICKNESS	REMARKS
Red Rock	1636	1649	13	
Slate	1649	1678	29	
Little Lime	1678	1702	24	
Pencil	1702	1704	2	
Big Lime	1704	1881	177	Gas 1807-1812--7/10 w 2"
Red Big Injun	1881	1902	21	Gas 1878-1881--10/10 w 2"
Gray Injun	1902	1931	29	
Slate	1931	1936	5	
Lime Shells	1936	1967	31	Black Oil 1960-1967
Slate	1967	1989	22	
Grily Lime	1989	2009	20	
Slate	2009	2039	30	
Black Lime	2039	2059	20	Gas 2054-2059--3/10 w 6 5/8"
Slate	2059	2175	116	
Lime	2175	2200	25	
Slate	2200	2498	298	
Berea Grit	2498	2552	54	Show of Oil at 2505
Slate	2552	2570	18	Top of tools left in hole 2542'
Broken Lime	2570	2840	270	Bottom of tools left in hole 2594'
Slate	2840	3010	170	Top of first Shot 3779
Shale	3010	3080	70	Bottom of first Shot 3854'
Slate	3080	3247	167	560f Gel. No increase in gas Prod.
Shale	3247	3290	43	Top of 2nd. Shot 3247
Lime	3290	3320	30	Bottom of 2nd. shot 3500
Shale	3320	3485	165	1920f Gel. Increase in gas well m
Slate	3485	3779	294	13/10 water 2" 24hrs after Shot.
Shale Brown	3779	3852	73	

Completed and drilled in

[Signature]

SERIAL WELL NO. 4328

LEASE NO. _____

MAP SQUARE _____

RECORD OF WELL No. Farm of District County Field, State of	on the Acres District County	CASING AND TUBING			TEST BEFORE SHOT	
		SIZE	USED IN DRILLING	LEFT IN WELL	_____ of Water in..... Incl	_____ of Merc. in..... Incl
		10			10ths	_____ Cu. ft
		13			10ths	_____ Cu. ft
		10			TEST AFTER SHOT	
		8 1-4			_____ of Water in..... Incl	_____ Cu. ft
Rig Commenced	192	0 5-8			10ths	_____ Incl
Rig Completed	192	5 3-10			10ths	_____ Cu. ft
Drilling Commenced	192	4 7-8			Rock Pressure _____	
Drilling Completed	192	4			Date Shot _____	
Drilling to cost	per foot	3			Size of Torpedo _____	
Contractor is:		2			Oil Flowed _____ bbls. 1st 24 hrs	
Address:		SHUT IN			Oil Pumped _____ bbls. 1st 24 hrs	
Drillers' Names		Date.....			Well abandoned and	
		_____ in			Plugged _____ 19_____	
		Size of Packer.....				
		Kind of Packer.....				
		1st Perf. Set..... from.....				
		2nd Perf. Set..... from.....				

DRILLER'S RECORD

FORMATION	TOP	BOTTOM	THICKNESS	REMARKS
Gasiferous Lime TOTAL DEPTH"	3852	3854	2 3854	Top of 3rd. shot 3006' Bottom of 3rd. shot 3680' 560# Gal. No increase in gas prod. Hole filled up with stone & clay from 3854 to 3662' (Present depth of Hole) Total Depth, where hole was filled up to, all gas pays, all shows of oil, all casing points, and top and bottom of tools left in hole all STEEL LINE MEASUREMENT.
Rig & water furnished by Contractor Gas furnished by United Fuel Gas Co.				

[Handwritten Signature]

Min-21

WEST VIRGINIA DEPARTMENT OF MINES

Oil and Gas Section

PRELIMINARY DATA SHEET NO. 1

File No. Well No. 4328

UNITED FUEL GAS Company, of Charleston, W. Va.

on the Central Trust Company Farm

containing 6,852.4 acres. Location

Warfield District, in Mingo County, West Virginia.

The surface of the above tract is owned in fee by Central Trust Company

of Cincinnati, Ohio. address, and the mineral rights are owned by

Central Trust Company of Cincinnati, Ohio.

The oil and gas privileges are held under lease by the above named company, and this well is drilled under

permit No. Mingo 21 issued by the West Virginia Department of Mines, Oil and Gas Section,

April 1st, 1931.

Elevation of surface at top of well, 875 ~~Spirit-~~ Barometric.

The number of feet of the different sized casings used in the well.

.....feet.....size. Wood conductor

33 feet 13 1/2 size, csg. 256 feet 10" sized csg.

604 feet 8 1/4 size, csg.feet.....sized csg.

.....feet.....size, csg.feet.....sized csg.

.....packer of.....size, set at.....

.....packer of.....size, set at.....

.....in casing perforated at.....feet to.....feet.

.....in casing perforated at.....feet to.....feet.

Coal was encountered at 200 feet; thickness 48" inches, and at.....

feet; thickness.....inches; and at.....feet; thickness.....inches.

Liners were used as follows: (Give details).....

December 7, 1931.

Date.

Approved UNITED FUEL GAS COMPANY, Owner.

By.....

(Title) Engineer.

110-21

UNITED FUEL GAS Company

Charleston, W. Va. Address

Well #4328

COMPLETION DATA SHEET

NO. 2

FORMATION RECORD

Name	Color	Character	Oil, Gas or Water	Top	Bottom	Thickness	Total Depth	Remarks
Sand Gravel				0	33	33		
Sand				33	200	167		
Coal				200	204	4		
Slate				204	222	18		
Sand				222	315	93		
Broken Lime				315	350	35		
Slate				350	460	110		
Sand				460	515	55		
Slate				515	610	95		
Sand				610	700	90		
Slate				700	770	70		
Sand				770	840	70		
Broken Lime				840	980	140		
Slate				980	1010	30		
Sand				1010	1200	190		
Lime				1200	1235	35		
Slate				1235	1240	5		
Lime				1240	1415	175		
Sand				1415	1445	30		
Broken Lime				1445	1482	37		
Red Rock				1482	1502	20		
Lime				1502	1517	15		
Red Rock				1517	1535	18		
Slate				1535	1545	10		
Maxon Sand				1545	1582	37		

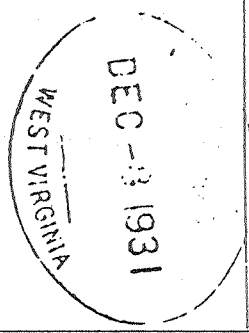

Well was not shot at.....feet; well was shot at.....feet.

Fresh water at.....50.....feet; salt fresh water at.....1190; 1435 and 1555.....feet.

Well was producing hole. dry

December 7th, 1931. Approved UNITED FUEL GAS COMPANY Date Owner

NOTE: All bottom formations must be noted as indicated above and all key-rocks and oil and gas sands must be recorded under their proper geological names in the district as well as any local names commonly used in the district for such strata.