

LATITUDE 37° 52' 30"



LONGITUDE

7'5 OGIS topo location

7.5' loc 0.26S
0.50W

15' loc 3/4S
(calc.) 0.50W

Company _____

Farm _____

Quad NAUGATUCK 7 1/2' + 15'0

County MINGO

District KERMIT

WELL LOCATION MAP

File No. 059-1126

I, the undersigned hereby certify that the information required by Oil & Gas Law, Chapter 20, Article 1, Section 1, and shows the information required by Oil & Gas Law, Chapter 20, Article 1, Section 1.

E. A. Cunningham

acknowledged before me a _____ of Kanawha County, W. Va. this 8 day of Apr 1931

My Commission expires May 8 - 1933

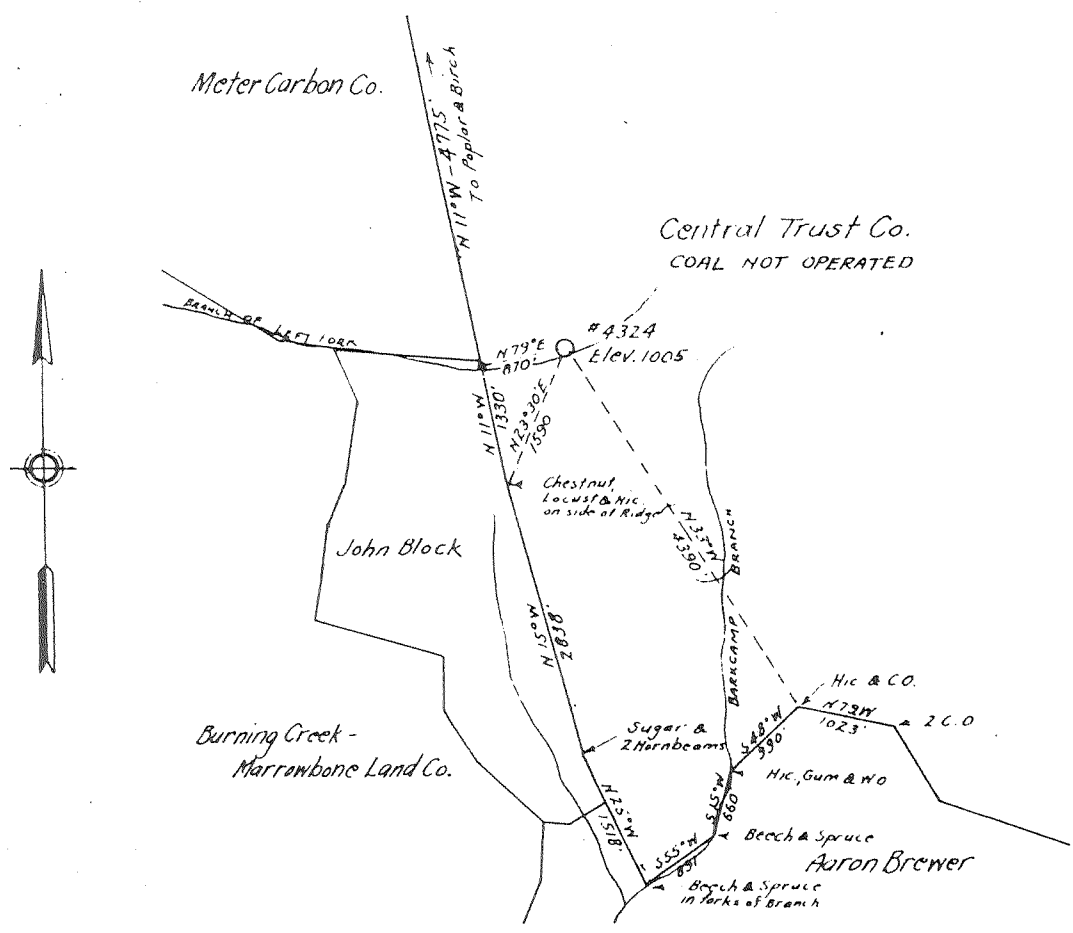

Central Trust Co.
Well No. 4324
Warfield District
Mingo County, W. Va.
April 6, 1931

KERMIT

Mingo-26

UNITED FUEL GAS CO.
MAP SHOWING
PROPOSED WELL LOCATION
SCALE :- 1 INCH = 2000 FEET

Central Trust Company No. 4324 Well.

0579-26

Kermit District, Mingo County, W. Va.
 By United Fuel Gas Company.
 Permit No. Min-26.
 Elevation, 947' B. *OK*

Dry hole.
 Located 3.12 mi. S. of 37° 55' and 0.49 mi. W. of 82° 20'—C—Nauga-
 tuck Quadrangle.

On north side of Left Fork of Marrowbone Creek.
 2.3 mi. N. E. of Selwyn; 2.1 mi. N. W. of Baisden School.

	Top.	Bottom.	Thickness.	Elevation (top)
Big Lime -----	1457	1665	208	— 510
Big Injun Sand-----	1665	1705	40	— 718
Berea Sand -----	2182	2260	78	—1235
Corniferous Lime+-----	3490	4080	(590)	—2543
Oriskany Sand -----			0	

Thickness, Devonian Shales, 1230 feet. Total depth, 4095'.
 Remarks: Completed Jan. 9, 1932. Shot at 2647-2720', 2254-2380',
 2850-3125', and 3623-3651'.

Salt water, 875' and 1315'.
 Gas, 825-27' (in Salt Sand). Gas at 1312-16' (in Maxton Sand).
 Gas in Big Lime at 1612-1620'. Oil show in Big Injun Sand at
 1680-90'. Gas at 3645-50'.
 On 6852.4 acres.

Deep well

Nauppluk Q-C

KERM IT

Warfield District, Wingo County, W. Va.

United Fuel Gas Co., Charleston, W. Va.

On 6852.4 acres; surface and mineral rights owned by Central Trust Co., Cincinnati, Ohio.

Drilled under permit Wingo-26, issued Aug. 29, 1931.

Elevation, ~~1300~~ B. 947 - KLA - 7.5' topo 10/18/32

1 1/2" casing, 21'; 10", 240'; 6-5/8", 1463'.

Coal was encountered at 100-103'.

Completion reported to Dept. of Mines Feb. 4, 1932.

Well was shot at 3623-3651, 2850-3125, 2647-2720, and 2254-2380'.

Salt water at 875' and 1315'.

Dry hole.

Completed 01/09/32

	Top.	Bottom.
Surface	0	15
S _{and}	15	35
S _{late}	35	80
S _{and}	80	100
Coal	100	103
S _{and}	103	175
S _{late}	175	215
S _{and}	215	250
S _{late}	250	325
L _{ime}	325	375
S _{and}	375	425
S _{late}	425	470
G _{as} S _{and}	470	530
S _{late}	530	545
S _{and}	545	675
Broken lime	675	725
S _{alt} S _{and} (gas, 825-827'; water, 875')	725	1050
Broken lime	1050	1175
R _{ed} r _{ock}	1175	1185
S _{late}	1185	1250
L _{ime}	1250	1265
R _{ed} r _{ock}	1265	1305
M _{er} ton S _{and} (gas, 1312-1316'; water, 1315')	1305	1320
S _{late}	1320	1340
L _{ime}	1340	1355
R _{ed} r _{ock}	1355	1370
S _{late}	1370	1400
L _{ittle} L _{ime}	1400	1440
L _{ime} s _{hell}	1440	1455
P _{encil} C _{ave}	1455	1457
B _{ig} L _{ime} (gas, 1612-1620')	1457	1665
B _{ig} I _n jun S _{and} (oil, 1682-1690')	1665	1705
S _{quaw} S _{and}	1705	1750
S _{late} l _{ime} s _{hells}	1750	1920
H _{ard} l _{ime}	1920	1975
S _{late}	1975	2160
B _{rown} s _{hale}	2160	2182
B _{erea} G _{rit}	2182	2260
B _{rown} s _{hale}	2260	2380
S _{late}	2380	2650
B _{rown} s _{hale}	2650	2720
S _{late}	2720	2850
B _{rown} s _{hale}	2850	3135
S _{late}	3135	3385
B _{rown} s _{hale}	3385	3490
C _{orniferous} L _{ime} (gas, 3645-3650')	3490	4080
S _{late, to} b _{ottom}	4080	4095

2182
1380
802

Vol. XVI - Pg. 521

3.12 mi. S $37^{\circ}55'$, 0.49 mi. W $83^{\circ}20'$

Mine 26

WEST VIRGINIA DEPARTMENT OF MINES
Oil and Gas Section
PRELIMINARY DATA SHEET NO. 1

File No. _____ Well No. 4324

UNITED FUEL GAS Company, of Charleston, W. Va.

on the Central Trust Company Farm

containing 6852.4 acres. Location

Warfield District, in Mingo County, West Virginia.

The surface of the above tract is owned in fee by Central Trust Company of Cincinnati, Ohio.

Central Trust Company of Cincinnati, Ohio.

The oil and gas privileges are held under lease by the above named company, and this well is drilled under permit No. Mingo 26 issued by the West Virginia Department of Mines, Oil and Gas Section, August 29th, 1931.

Elevation of surface at top of well, 1380 Spirit Barometric.

The number of feet of the different sized casings used in the well.

_____ feet _____ size. Wood conductor

21 feet 13 1/2 size, csg. 240 feet 10" sized csg.

1463 feet 6-5/8 size, csg. _____ feet _____ sized csg.

_____ feet _____ size, csg. _____ feet _____ sized csg.

_____ packer of _____ size, set at _____

_____ packer of _____ size, set at _____

_____ in casing perforated at _____ feet to _____ feet.

_____ in casing perforated at _____ feet to _____ feet.

Coal was encountered at 100 feet; thickness 36 inches, and at _____

feet; thickness _____ inches; and at _____ feet; thickness _____ inches.

Liners were used as follows: (Give details) _____

February 4, 1932, _____

Date.

Approved UNITED FUEL GAS COMPANY, Owner.

By G. Cunningham (Title) Engineer, W.

Min-24

UNITED FUEL GAS Company

COMPLETION DATA SHEET

Charleston, W. Va. Address

NO. 2

Well #4324.

FORMATION RECORD

Name	Color	Character	Oil, Gas or Water	Top	Bottom	Thickness	Total Depth	Remarks
Surface				0	15	15		
Sand				15	35	20		
Slate				35	80	45		
Sand				80	100	20		
Coal				100	103	3		
Sand				103	175	72		
Slate				175	215	40		
Sand				215	250	35		
Slate				250	325	75		
Lime				325	375	50		
Sand				375	425	50		
Slate				425	470	45		
Gas Sand				470	530	60		
Slate				530	545	15		
Sand				545	675	130		
Broken Lime				675	725	50		
Salt Sand				725	1050	325		
Gas			825-827					
Water			875					
Broken Lime				1050	1175	125		
Red Rock				1175	1185	10		
Slate				1185	1250	65		
Lime				1250	1266	15		
Red Rock				1265	1305	40		
Maxon Sand				1305	1320	15		
Gas			1312-1316					
Water			1315					
Slate				1320	1340	20		
Lime				1340	1355	15		
Red Rock				1355	1370	15		
Slate				1370	1400	30		
Little Lime				1400	1440	40		
Lime Shell				1440	1455	15		
Pencil Cave				1455	1457	2		
Big Lime				1457	1665	208		
Gas			1612-1620					
Big Injun				1665	1705	40		
Oil			1680-1690					
			(Cont'd.)					

Well was not shot at ^{shot} 3623-3651, 2850-3125 feet; well was shot at 2647-2720, 2254-2380 feet.

Salt ^{salt} fresh water at 875 feet; fresh water at 1315 feet.

Well was ^{producing} hole. dry

February 4, 1932.

Approved

UNITED FUEL GAS COMPANY.

Date

Owner

NOTE: All bottom formations must be noted as indicated above and all key-rocks and oil and gas sands must be recorded under their proper geological names in the district as well as any local names commonly used in the district for such strata.

Plugged 2-20-32

Mingo-26

SHEET NO. 2.

UNITED FUEL GAS Company

Charleston, W. Va. Address

Well #4324.

COMPLETION DATA SHEET
NO. 2
FORMATION RECORD

Name	Color	Character	Oil, Gas or Water	Top	Bottom	Thickness	Total Depth	Remarks
quaw Sand				1705	1750	45		
late Lime	Shells			1750	1920	170		
ard Lime				1920	1975	55		
late				1975	2160	185		
rown Shale				2160	2186	22		
erea Grit				2182	2260	78		
rown Shale				2260	2380	120		
late				2380	2650	270		
rown Shale				2650	2720	70		
late				2720	2850	130		
rown Shale				2850	3135	285		
late				3135	3385	250		
rown Shale				3385	3490	105		
orniferous Lime				3490	4080	590		
as			3645-3650					
late				4080	4095	15		
Total Depth							4095	

shot

Well was not shot at.....feet; well was shot at.....feet.

Salt

Fresh water at.....feet; fresh water at.....feet.

producing
Well was hole.
dry

February 4, 1932. Approved
Date

UNITED FUEL GAS COMPANY
Owner

NOTE: All bottom formations must be noted as indicated above and all key-rocks and oil and gas sands must be recorded under their proper geological names in the district as well as any local names commonly used in the district for such strata.