

# EQT PRODUCTION COMPANY (POCA-CARNEGIE/BRIAR MT.) WELL NO. WV 512579

UTM-NA083  
N 4163365.45  
E 411028.61

WELL NO. WV 512579  
STATE PLANE COORDINATES  
(SOUTH ZONE)

N. 224,791  
E. 1,707,947

LAT=(N) 37.61298  
LONG=(W) 82.00824

EXISTING WELL 47-059-1474  
STATE PLANE COORDINATES  
(SOUTH ZONE)

N. 224,823  
E. 1,707,926

LAT=(N) 37.61307  
LONG=(W) 82.00831

BOTTOM HOLE  
WELL NO. WV 512579  
STATE PLANE COORDINATES  
(SOUTH ZONE)

N. 218,612  
E. 1,711,237

LAT=(N) 37.59611  
LONG=(W) 81.99666

**NOTES ON SURVEY**

1. TIES TO WELLS AND CORNERS ARE BASED ON GRID NORTH FOR THE WV STATE PLANE COORDINATE SYSTEM SOUTH ZONE NAD '27.
2. TIES TO REFERENCES ARE BASED ON MAGNETIC NORTH 05-21-09.
3. LEASE BOUNDARY SHOWN HEREON TAKEN FROM POCAHONTAS LAND CORPORATION MAPPING PROPERTY MAPS (SHEET 12).
4. SURFACE OWNER AND ADJOINER INFORMATION TAKEN FROM THE ASSESSOR AND COUNTY CLERK RECORDS OF MINGO COUNTY IN MARCH, 2009.
5. WELL LAT./LONG. (NAD'27) ESTABLISHED BY DGPS(SUBMETER MAPPING GRADE).
6. ORIGINAL PLAT DATED 06/22/09 REVISED 12/29/09 TO ROTATE & EXTEND HORIZONTAL LEG & CHANGE BOTTOM HOLE COORDINATES, ETC.
7. HORIZONTAL LEG EXTENDED TO 7,000' 01/08/10.

**REFERENCES**

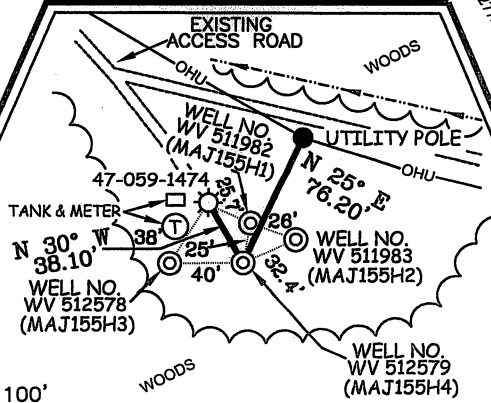

I THE UNDERSIGNED, HEREBY CERTIFY THAT THIS PLAT IS CORRECT TO THE BEST OF MY KNOWLEDGE AND BELIEF AND SHOWS ALL THE INFORMATION REQUIRED BY LAW AND THE REGULATIONS ISSUED AND PRESCRIBED BY THE DIVISION OF ENVIRONMENTAL PROTECTION.

P.S. 677  
*Gregory A. Smith*

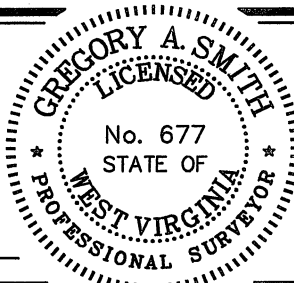

(+) DENOTES LOCATION OF WELL ON UNITED STATES TOPOGRAPHIC MAPS.  
DATE JANUARY 08, 20 10  
OPERATORS WELL NO. WV 512579  
API WELL NO. 47-059-02079H  
COUNTY MINGO PERMIT REVISED

MINIMUM DEGREE OF ACCURACY 1/2500 FILE NO. 4672P512579R2 (276-68)  
PROVEN SOURCE OF ELEVATION DGPS (SUBMETER MAPPING GRADE) SCALE 1" = 1000'

STATE OF WEST VIRGINIA  
DIVISION OF ENVIRONMENTAL PROTECTION  
OFFICE OF OIL AND GAS

WELL TYPE: OIL  GAS  LIQUID INJECTION  WASTE DISPOSAL  IF "GAS" PRODUCTION  STORAGE  DEEP  SHALLOW

LOCATION: ELEVATION 1,337' WATERSHED TRIBUTARY OF BEECH CREEK  
DISTRICT MAGNOLIA COUNTY MINGO QUADRANGLE MAJESTIC 7.5'

SURFACE OWNER POCAHONTAS LAND CORPORATION ACREAGE 158.80±  
ROYALTY OWNER PENN VIRGINIA OIL & GAS CORPORATION (38,753.36 AC.±) / LARRY ADDINGTON, ET AL (200 OF 1,044.58 AC.±)

PROPOSED WORK: LEASE NO. 717459 / 70726  
DRILL  CONVERT  DRILL DEEPER  REDRILL  FRACTURE OR STIMULATE  PLUG OFF OLD   
FORMATION  PERFORATE NEW FORMATION  PLUG AND ABANDON  CLEAN OUT AND REPLUG  OTHER   
PHYSICAL CHANGE IN WELL (SPECIFY) \_\_\_\_\_ TARGET FORMATION LOWER HURON/SILTSTONE  
ESTIMATED DEPTH 4,740' (TOTAL VERTICAL DEPTH)

WELL OPERATOR EQT PRODUCTION COMPANY DESIGNATED AGENT REX C. RAY  
ADDRESS 1710 PENNSYLVANIA AVENUE CHARLESTON, WV 25302 ADDRESS 1710 PENNSYLVANIA AVENUE CHARLESTON, WV 25302