

Latitude

+
.17s
2.12w

Longitude

Topo Location

7.5' Loc. _____ 15' Loc. _____
 (calc.) _____

Company Davis Lynch

Farm MR Davis I

15' Quad _____
(sec.)

7.5' Quad Morgantown North

District Morgan

WELL LOCATION PLAT

County 061 Permit 219

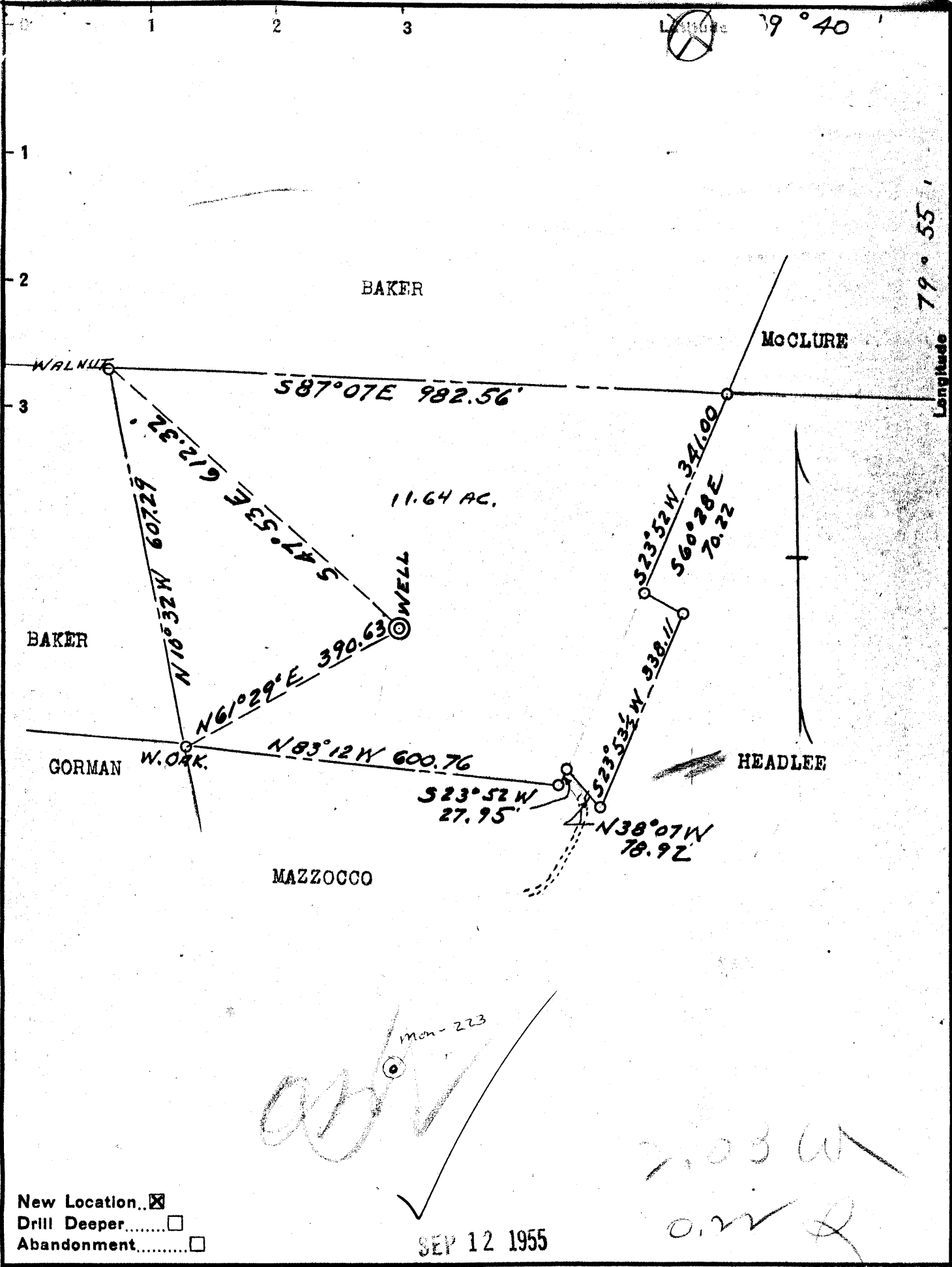

New Location...
 Drill Deeper.....
 Abandonment.....

Company M.R. DAVIS & RENNETT LYNCH
 Address STAR CITY WEST VA.
 Farm M.R. DAVIS
 Tract _____ Acres 11.64 Lease No. _____
 Well (Farm) No. 1 Serial No. _____
 Elevation (Spirit Level) 1143.5
 Quadrangle MORGANTOWN
 County MONONGALIA District MORGAN
 Engineer RALPH E. BAKER
 Engineer's Registration No. 441
 File No. 2-190-203 Drawing No. 8490
 Date AUG. 16-1955 Scale 1" = 200'

STATE OF WEST VIRGINIA
 DEPARTMENT OF MINES
 OIL AND GAS DIVISION
 CHARLESTON

WELL LOCATION MAP
 FILE NO. MON-219

+ Denotes location of well on United States Topographic Maps, scale 1 to 62,500, latitude and longitude lines being represented by border lines as shown.

- Denotes one inch spaces on border lines of original map.

M. R. DAVIS



STATE OF WEST VIRGINIA
DEPARTMENT OF MINES
OIL AND GAS DIVISION 7

Quadrangle Morgantown

Permit No. Mon. 219

WELL RECORD

Oil or Gas Well Gas

(KIND)

Company M. R. Davis & R. Emmett Lynch
Address Box 182, Star City, W. Va.
Farm M. R. Davis Acres 13
Location (waters) West Run
Well No. 1 Elev. 1143-5
District Morgan County Monongalis
The surface of tract is owned in fee by M. R. Davis
Address Same
Mineral rights are owned by M. R. Davis
Address Same
Drilling commenced 8/31/55
Drilling completed 11/12/55
Date Shot 10/23 From 1375 To 1380
With Nitroglycerine
Open Flow 3/10ths Water in one Inch
1/10ths Merc. in Inch
Volume 23,000 Cu. Ft.
Rock Pressure 440 lbs. 48 hrs.
Oil bbls., 1st 24 hrs.
Fresh water 174,387,837 feet feet
Salt water none feet none feet

Casing and Tubing	Used in Drilling	Left in Well	Packers
Size			
16	None		Kind of Packer <u>none</u>
13	None		
10 20	20	20	Size of <u>none</u>
8 1/2	None		
6 1/2	1289-3"	1289-3"	Depth set <u>none</u>
5 3/16	none		
3	none		Perf. top <u>none</u>
2	none		Perf. bottom <u>none</u>
Liners Used	none	none	Perf. top <u>none</u>
			Perf. bottom <u>none</u>

CASING CEMENTED none SIZE No. Ft. Date

COAL WAS ENCOUNTERED AT 534 FEET INCHES
 FEET INCHES FEET INCHES
 FEET INCHES FEET INCHES

Formation	Color	Hard or Soft	Top	Bottom	Oil, Gas or Water	Depth Found	Remarks
Clay			0	8			
Slate			8	28			
Lime			28	40			
Slate			40	55			
Lime			55	80			
Slate			80	120			
Lime			120	150			
Sand Murphy			150	210	Broken (Water 174)		
Slate			210	220			
Red Rock			220	225			
Slate			225	385			
Sand			385	410	Water (387-1 bailer per hour)		
Slate			410	435			
Sand			435	462	(Hard)		
Slate			462	470			
Sand			470	495			
Slate			495	534			
Coal			534	540			
Slate			540	619			
Lime			619	640			
Sand			640	688			
Slate			688	695			
Sand			695	715			
Slate			715	720	Dark		
Sand			720	732			
Slate			732	790			
Sand			790	892			
Bottom 10" hole 837							
Water (837-842)							
Slate			892	906			
Sand			906	932			
Slate			932	974			
Sand			974	1014			
Slate			1014	1060	(white)		
Sand			1060	1115	Medium		

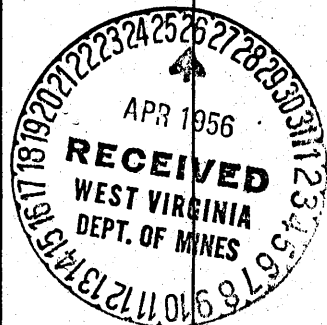

MAY 16 1956

(Over)

M. R. DAVIS (No.) - M. R. DAVIS & R. EMMETT LYNCH - MON-219

Formation	Color	Hard or Soft	Top ⁷	Bottom	Oil, Gas or Water	Depth Found	Remarks
Slate & Shells			1115	1144			
Lime			1144	1163			
Slate			1163	1170 (Pink)			
Lime			1170	1190			
Red Rock			1190	1195			
Slate			1195	1205			
Lime			1205	1295 (Hard)			
Sand			1295	1300			
Lime			1300	1305			
Red Rock			1305	1317			
Sand			1317				
Steel line measure		1322					
Gas		1375					
Total depth	1446 S.L.M.	10/18/55		Bridged to	1380		
Sand			1500	1510			
Sand (Injun)			1317	1438			
Lime			1438	1445			
Sand (Injun)			1445	1610			
Slate			1610	1756			
Sand			1756	1767			
Slate & Shells			1767	1850			
Sand			1850	1868			
Slate			1868	1878			
Sand			1878	1897			
Slate			1897	1901			
Sand			1901	1972			
Gas			1910	1912			
Total Depth	1991						
6" casing in hole	1289'3"						

1438
1144
- 294

Date _____, 19____
APPROVED MP Davis Co-Owner
By B Emmett Lynch
(Title)